

# **PORTFOLIO 2**

**Rebecca Joyner**

**IDSN 2102**





# ❖ Music as Design Inspiration

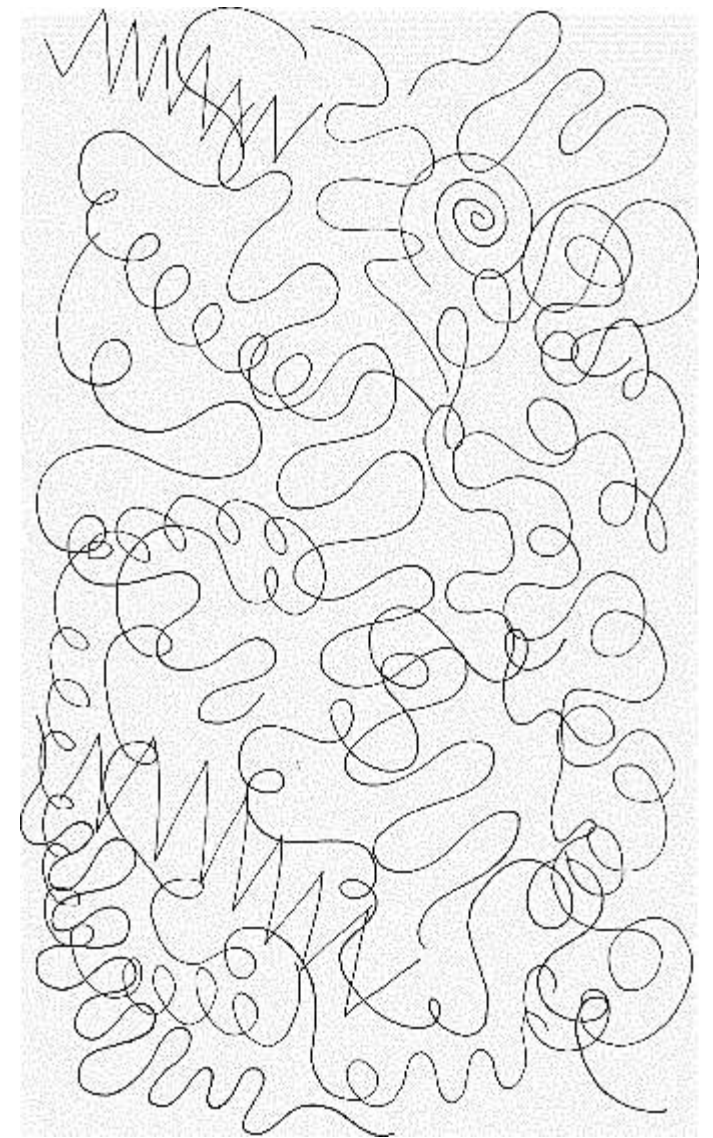
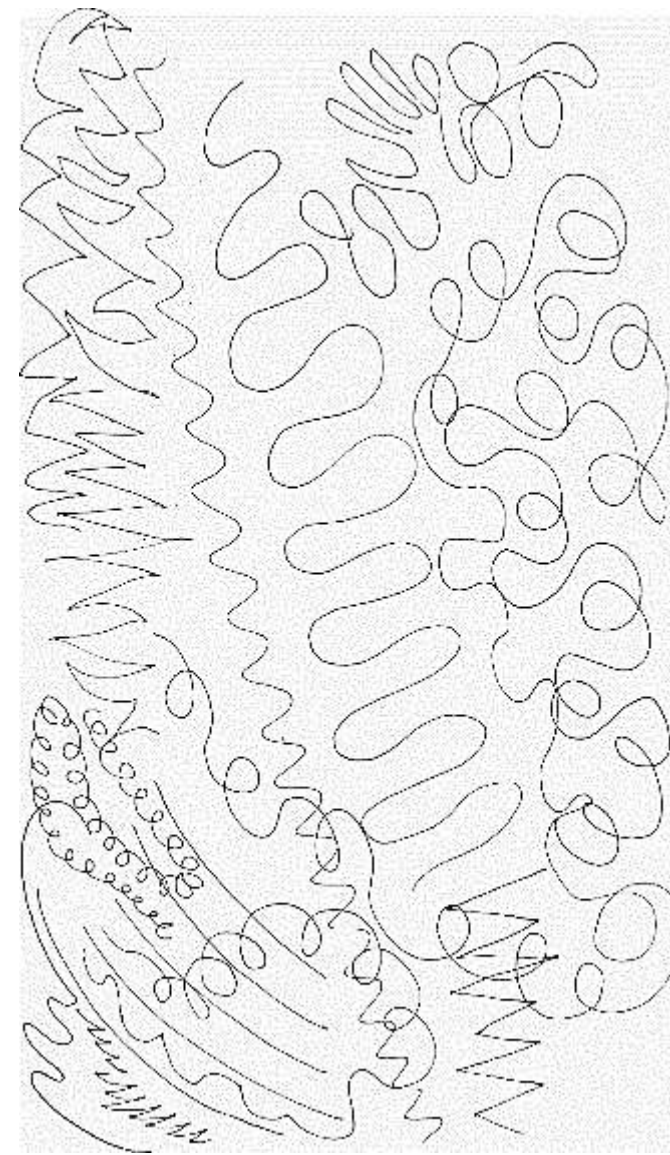
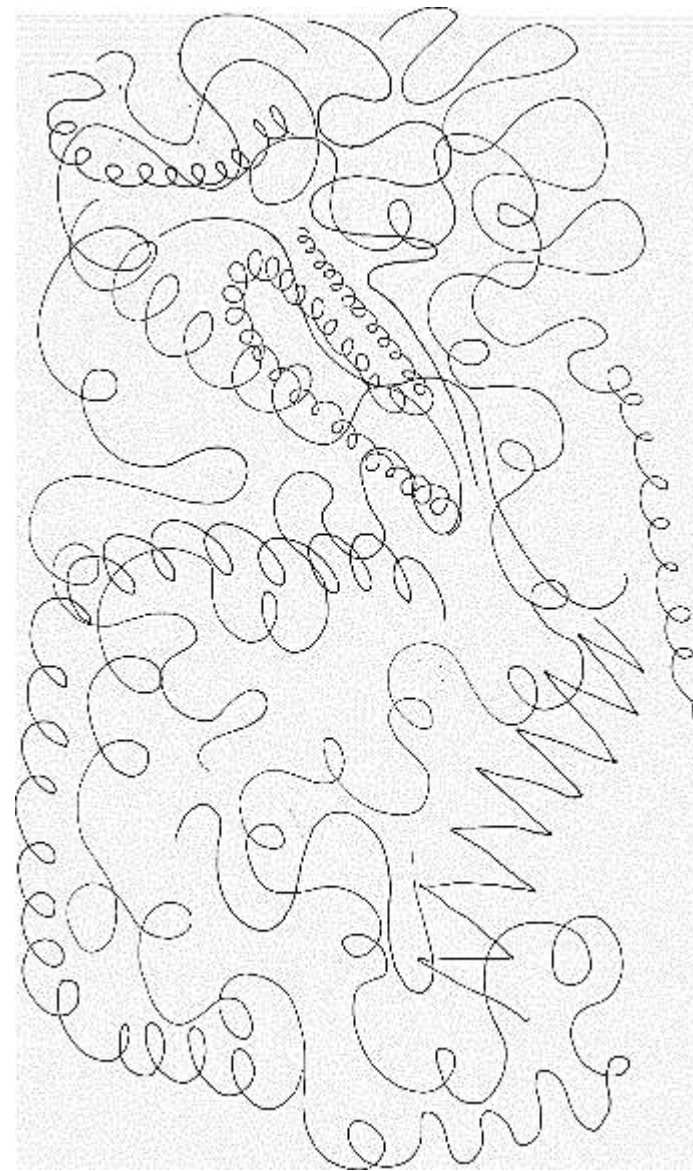
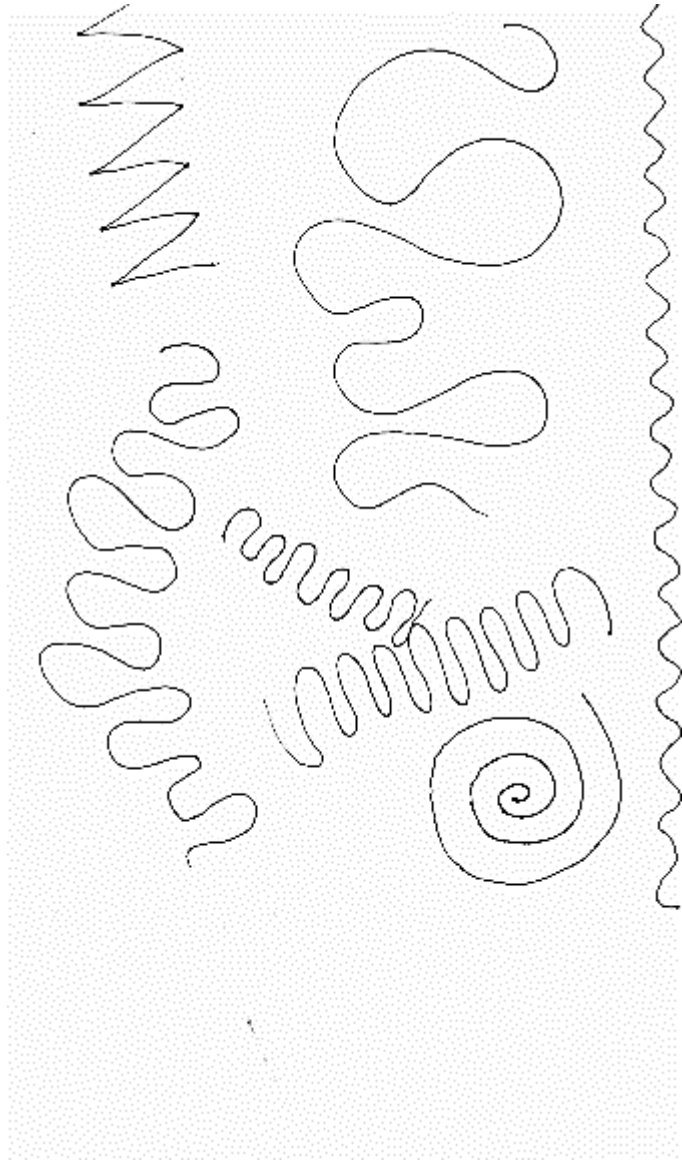



# ❖ Modeling to Music





# ❖ Problem Resolution Sketches

## Wayfinding & Stairs

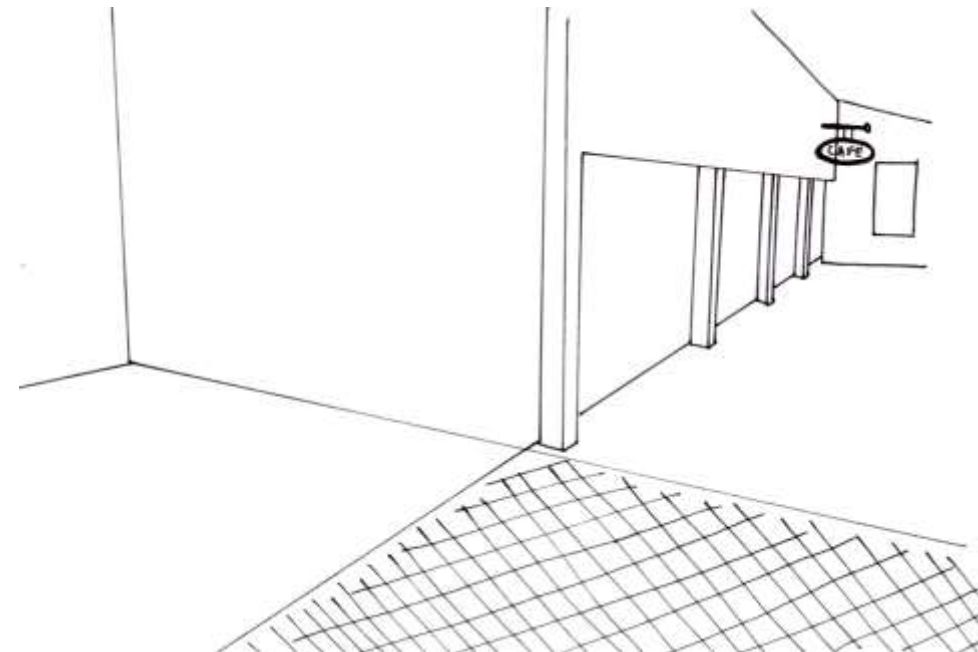
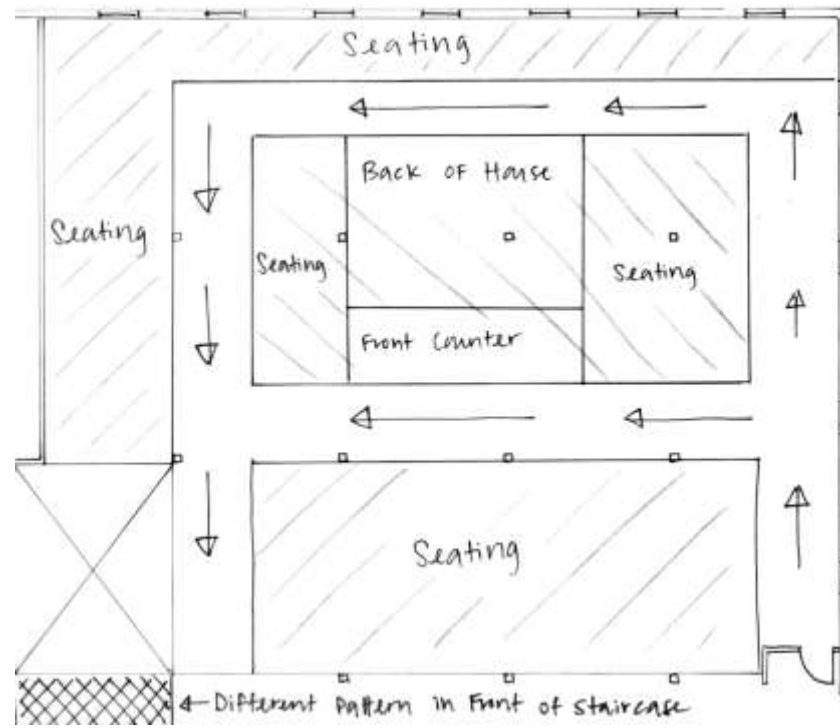

## Back of House

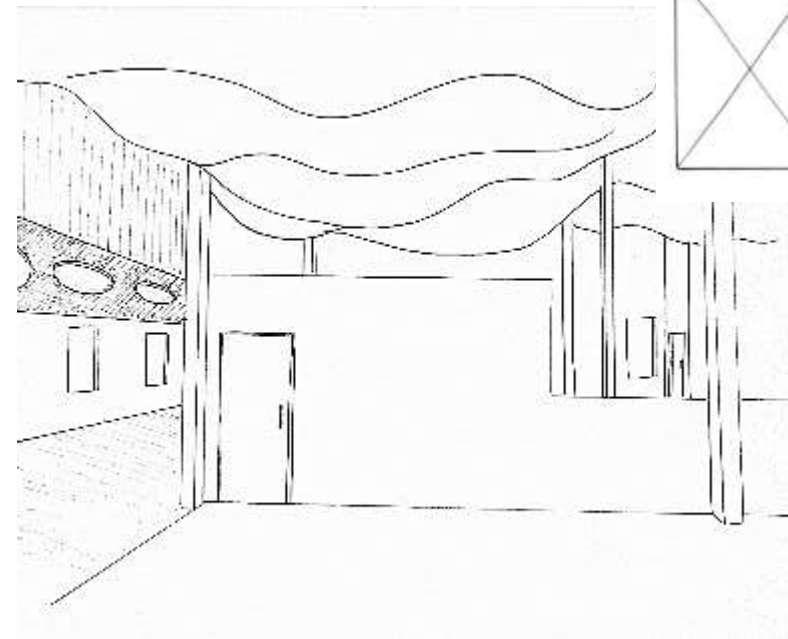
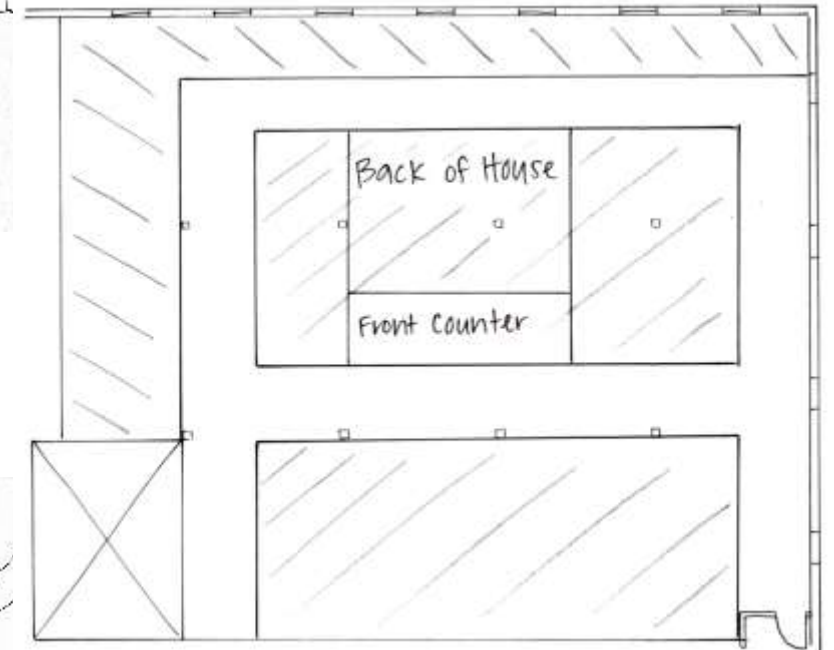
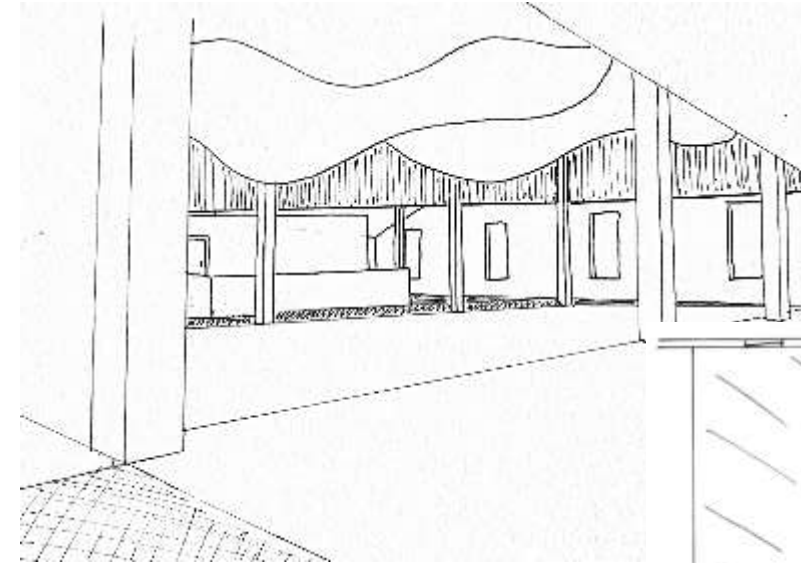

# ❖ Problem Resolution Sketches

## Ceiling & Lighting

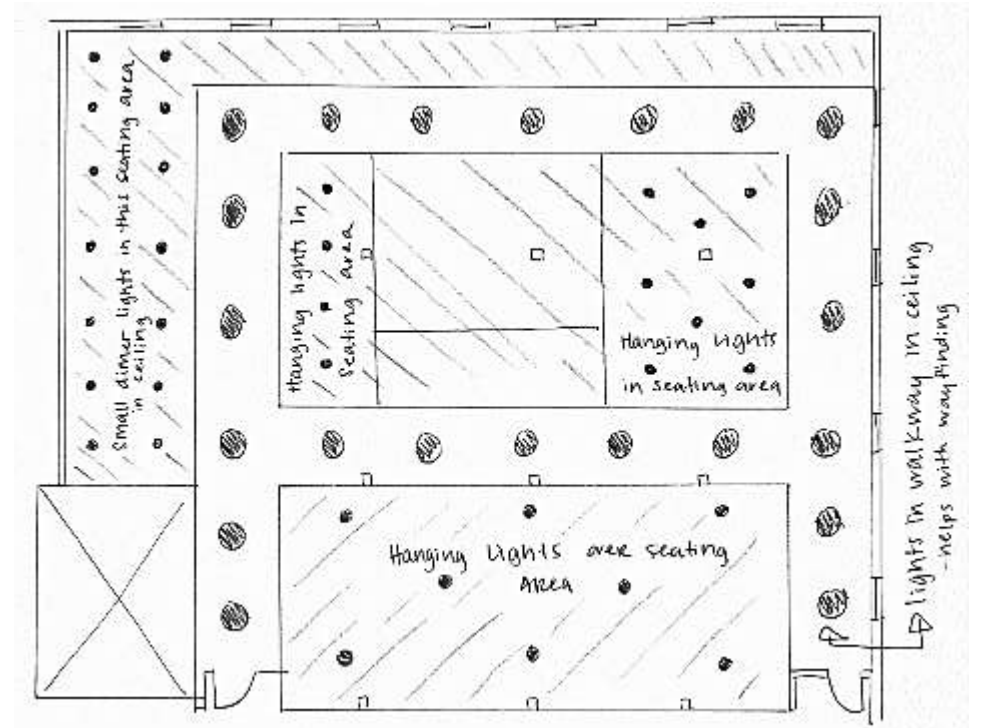
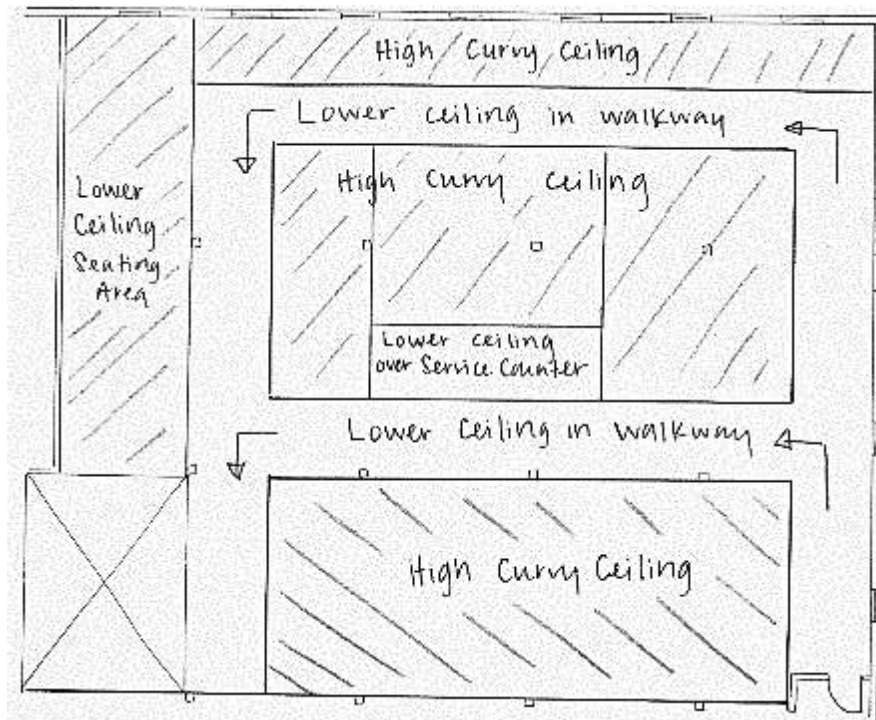
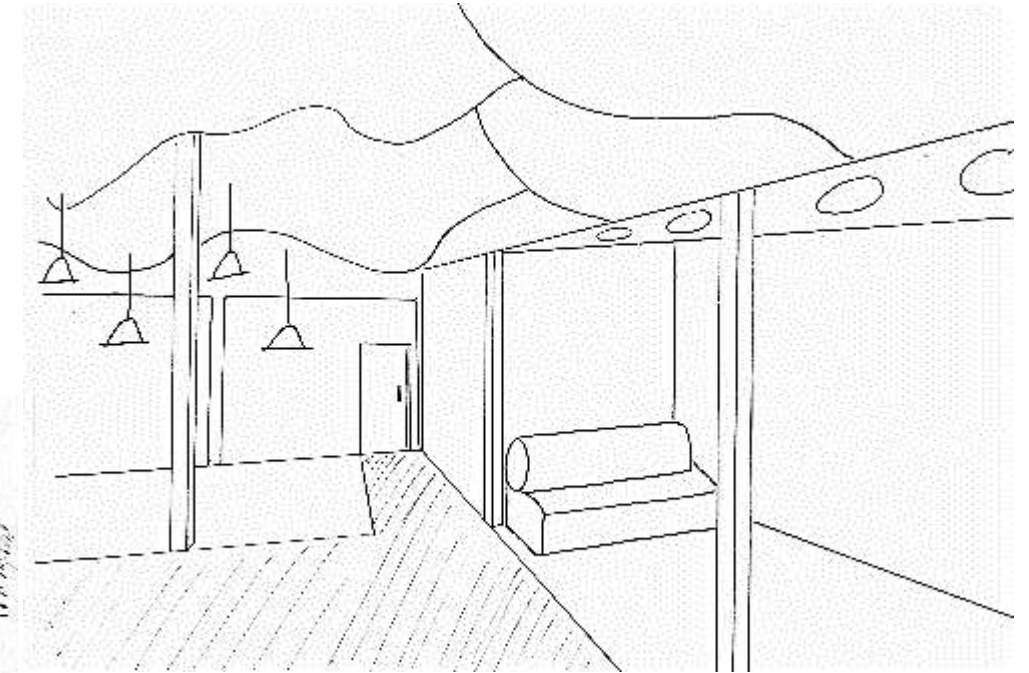
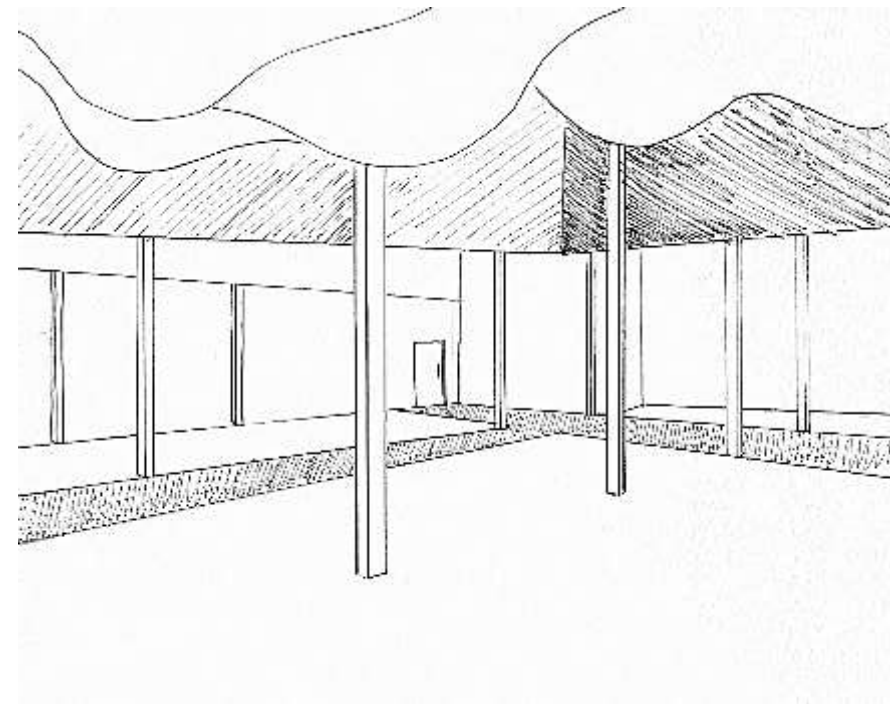
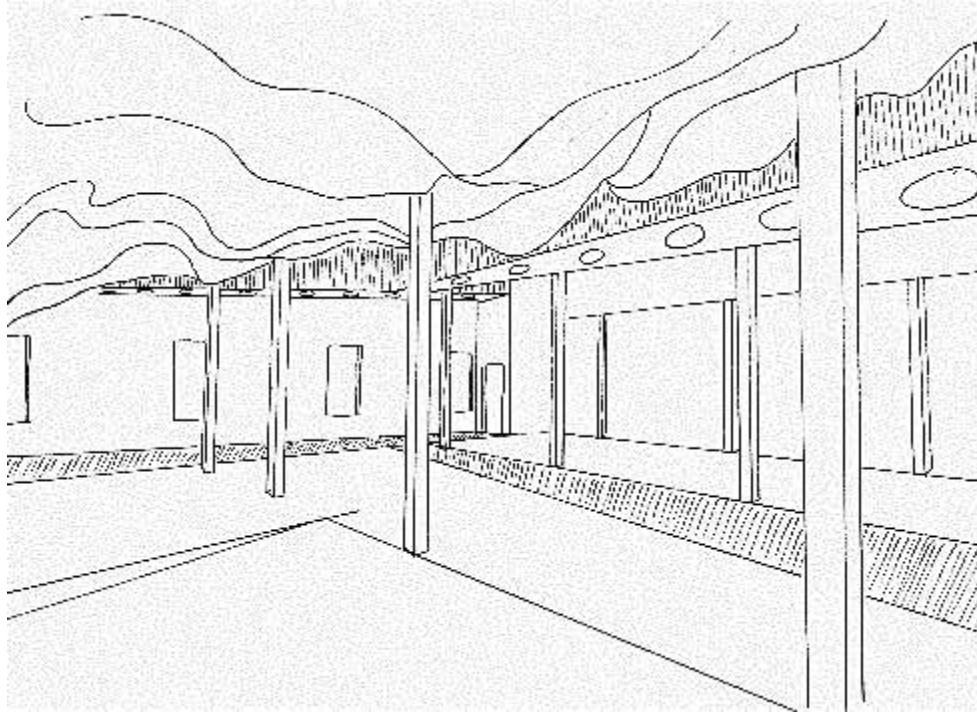



# ❖ Activity Space Studies

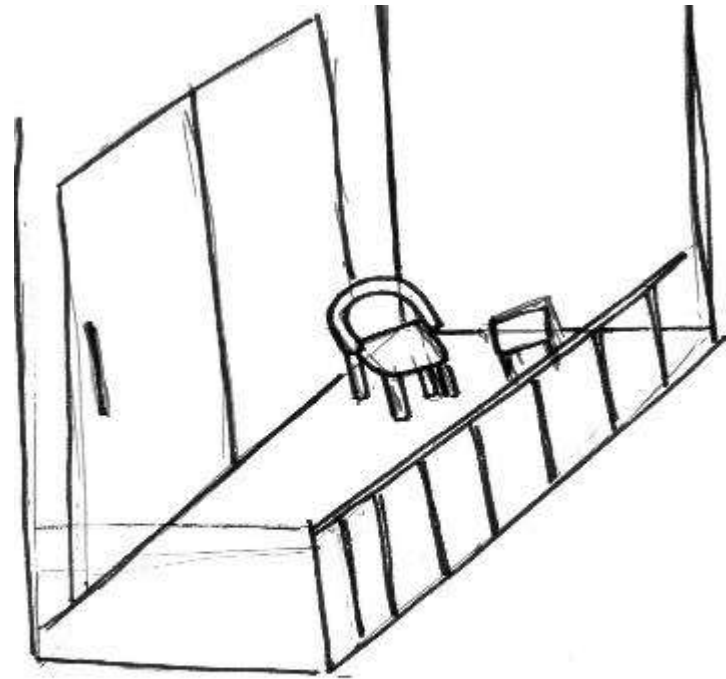

Sketching / journaling  
on back porch

## Sketching/Journaling

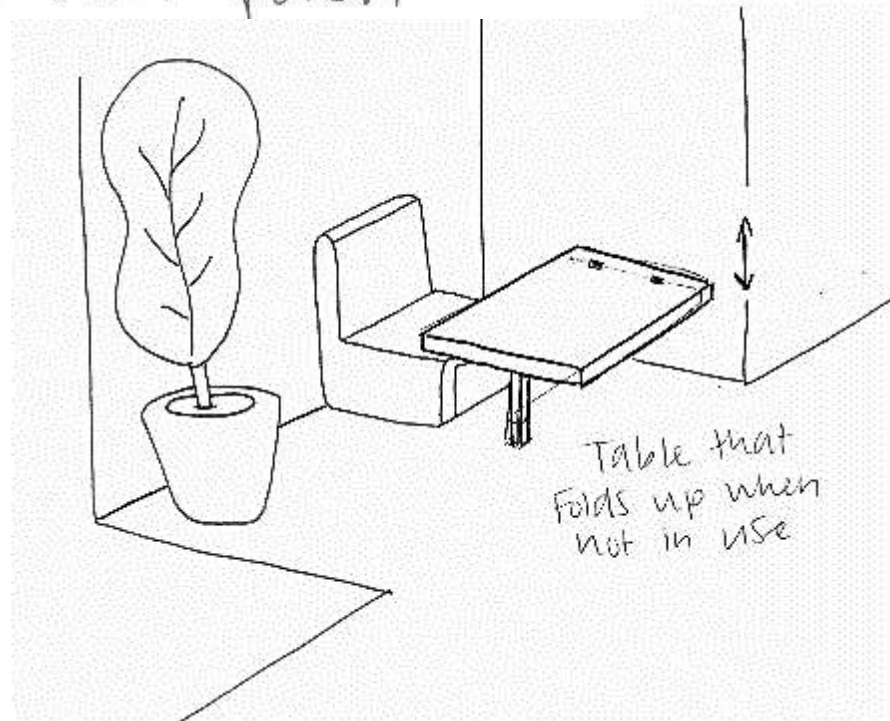
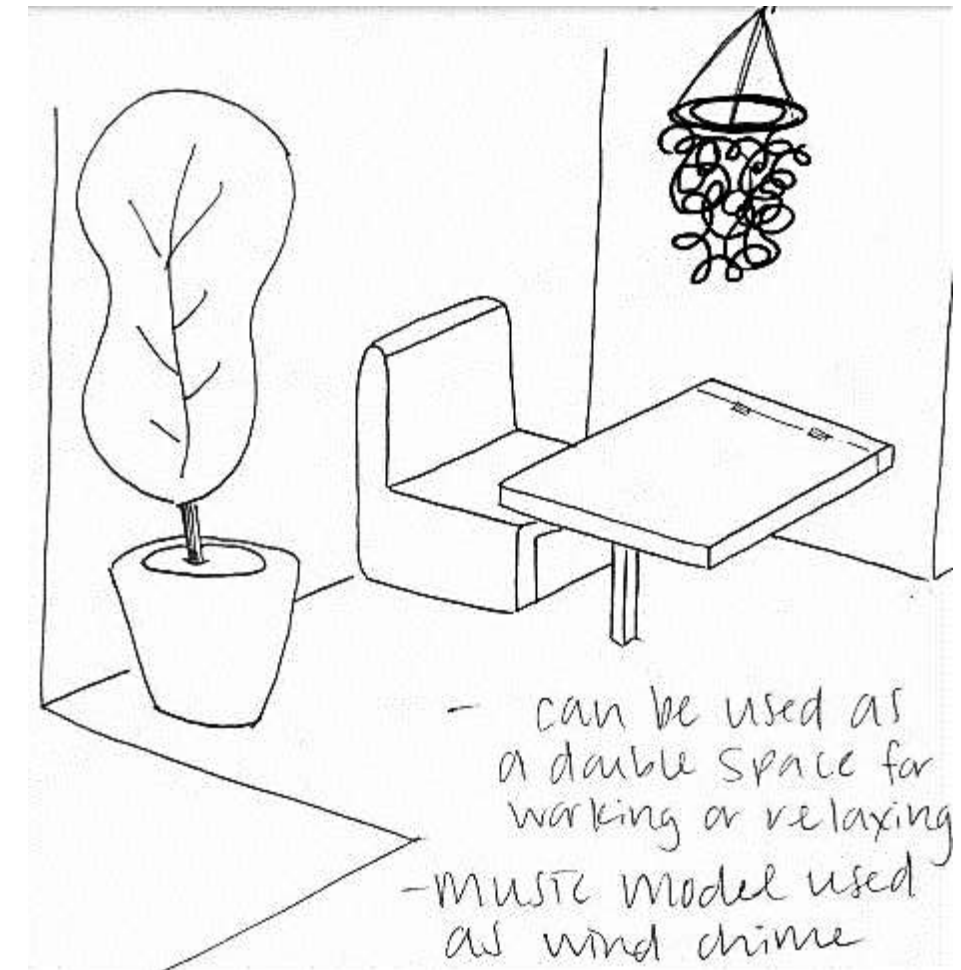
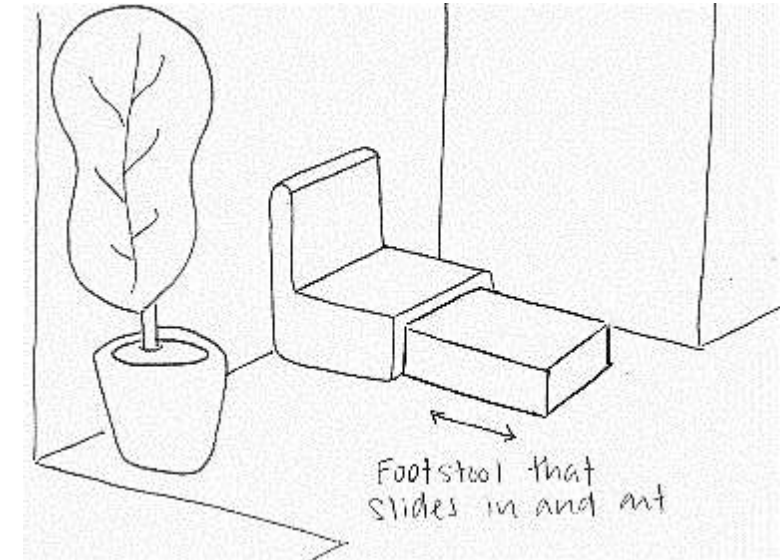



# ❖ Activity Space Studies



o Daydreaming  
in Bedroom

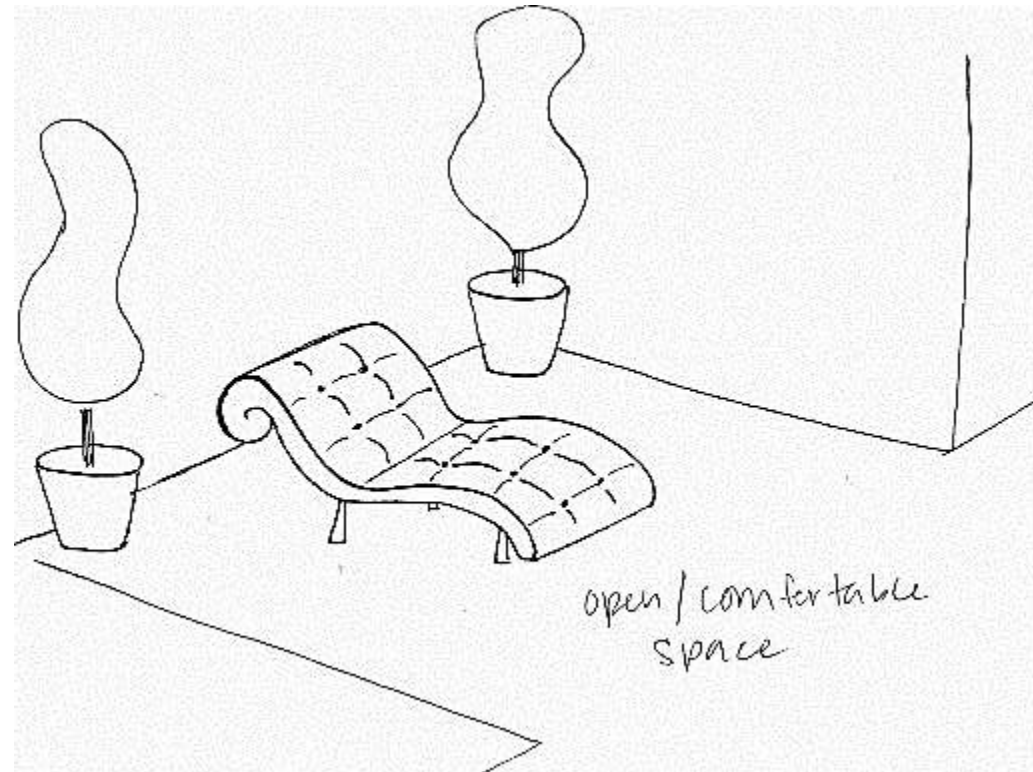

open / com for table  
space

## Daydreaming



music model  
used as canopy

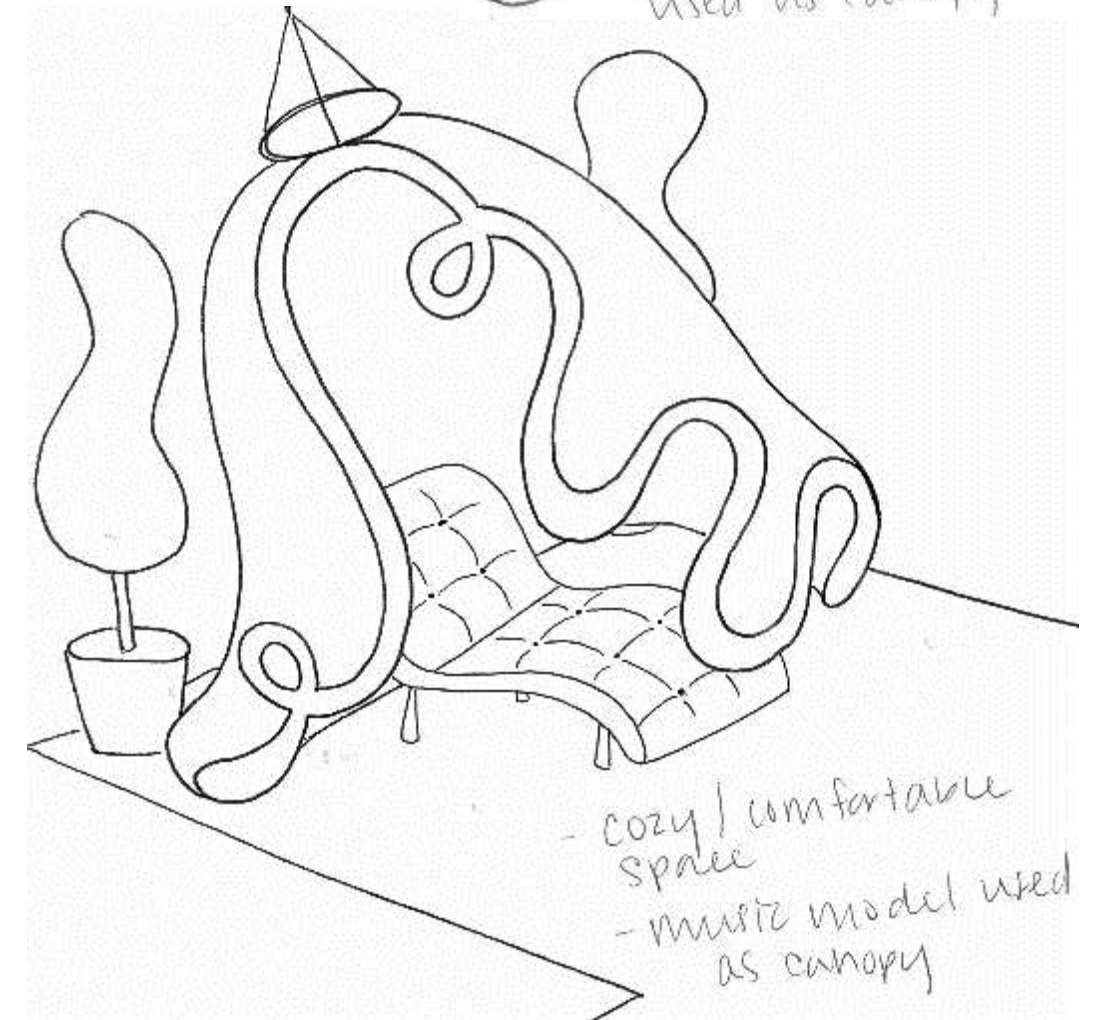

- cozy / comfortable  
space  
- music model used  
as canopy



# ❖ Activity Space Studies

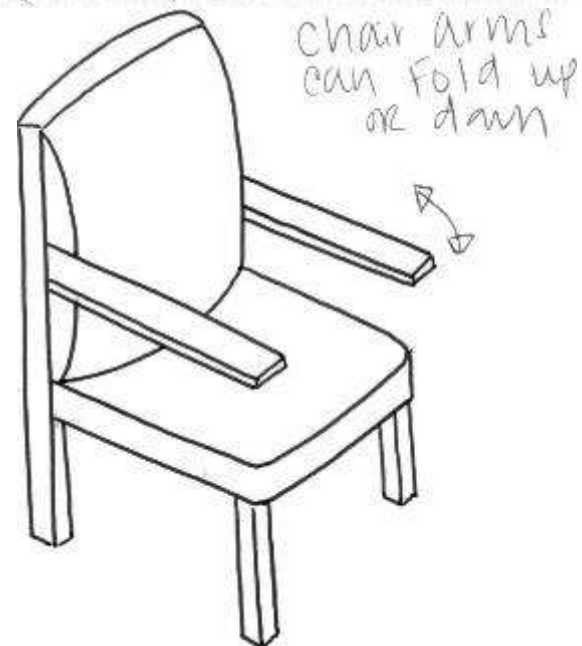
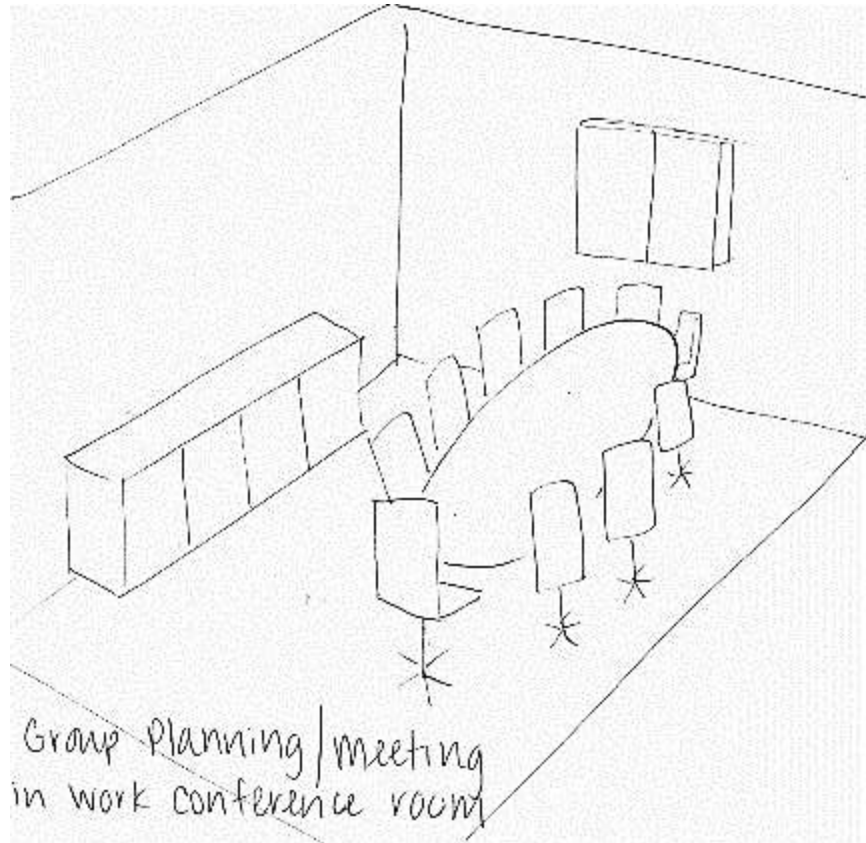

## Group Planning/ Meeting

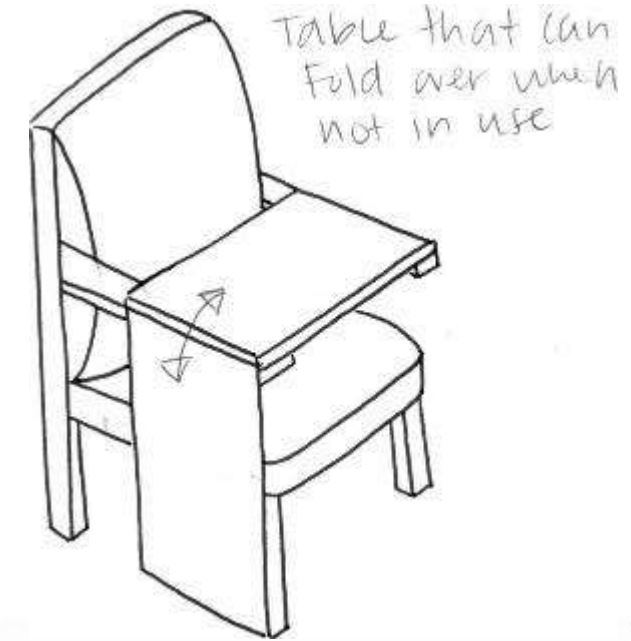

- More comfortable/  
versatile seating
- Eliminate big table  
for more open space

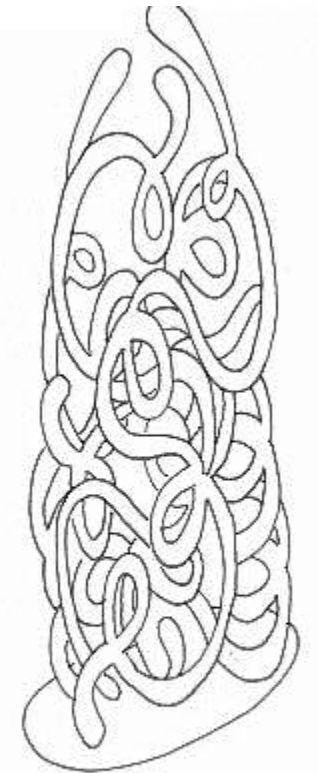
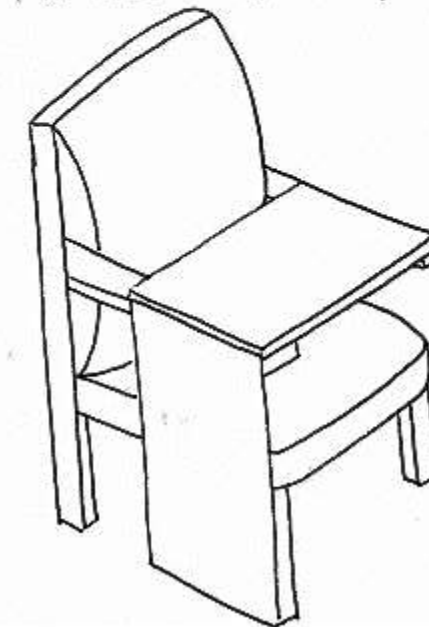

music model  
Used as Floor  
Lamp



# ❖ Activity Space Studies

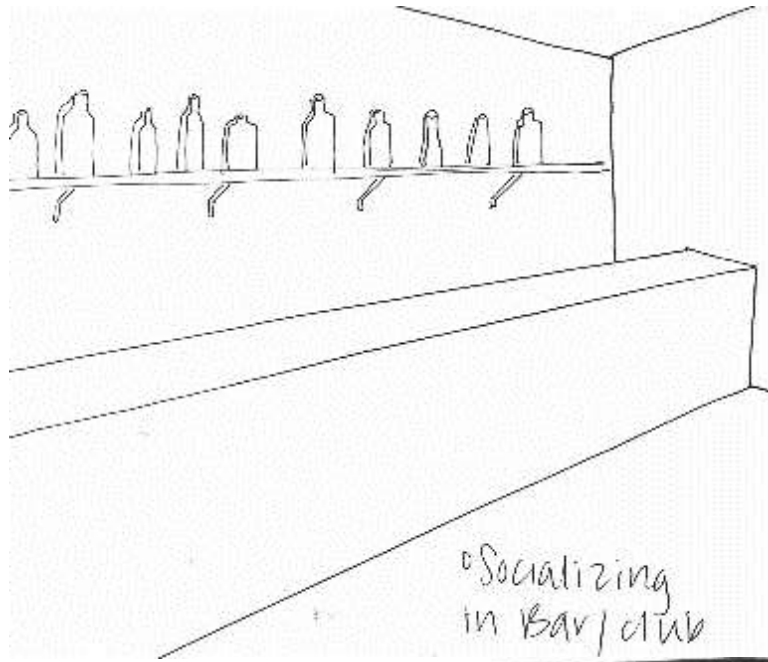

° Socializing  
in Bar/club



- Pod Seating For more  
Private Area

## Socializing

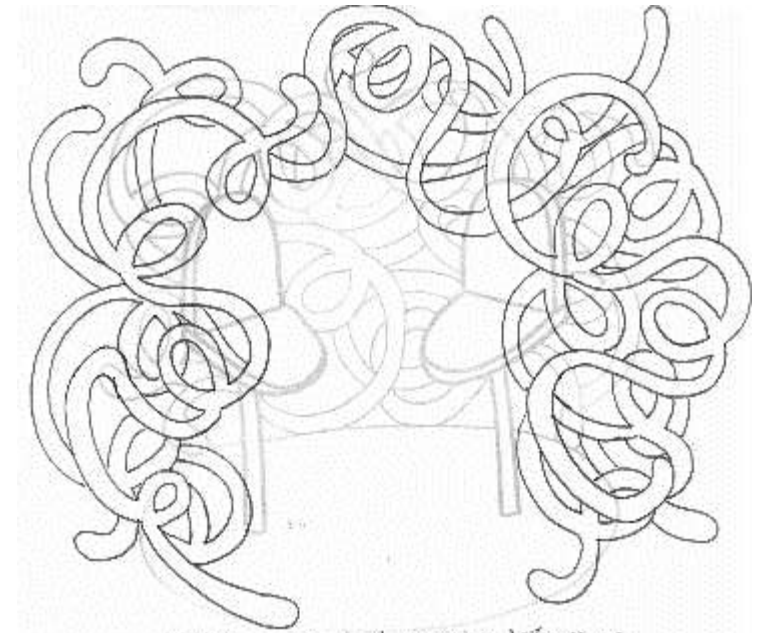

- music model made lifesize  
- middle int out to create  
"Pod-like" structure  
- Structure lights up

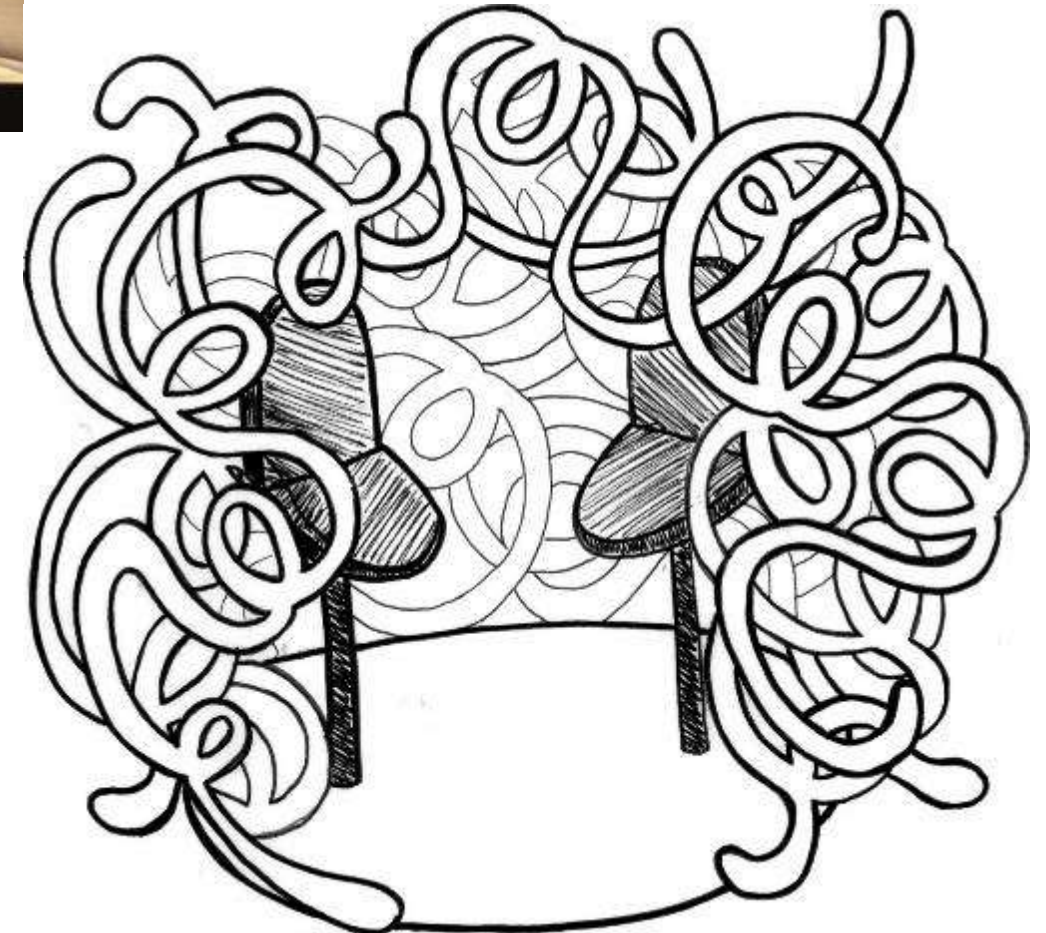



## ❖ **Concept**

- **Cappuccino**

- **Warm and Cozy Feeling**

- **Makes User Want to Come Back**





## ❖ **Color Rationale**

- **Monochromatic Color Scheme**
- **Helps the Eye Make Sense of a Room**
- **Different Shades of Brown**
- **Pale Browns for Calm, Purity, and Elegance**
- **Darker Browns for Stability and Comfort**
- **Warm Colors Make Space Feel Cozy**

