

PORTFOLIO II

Marisa Reins

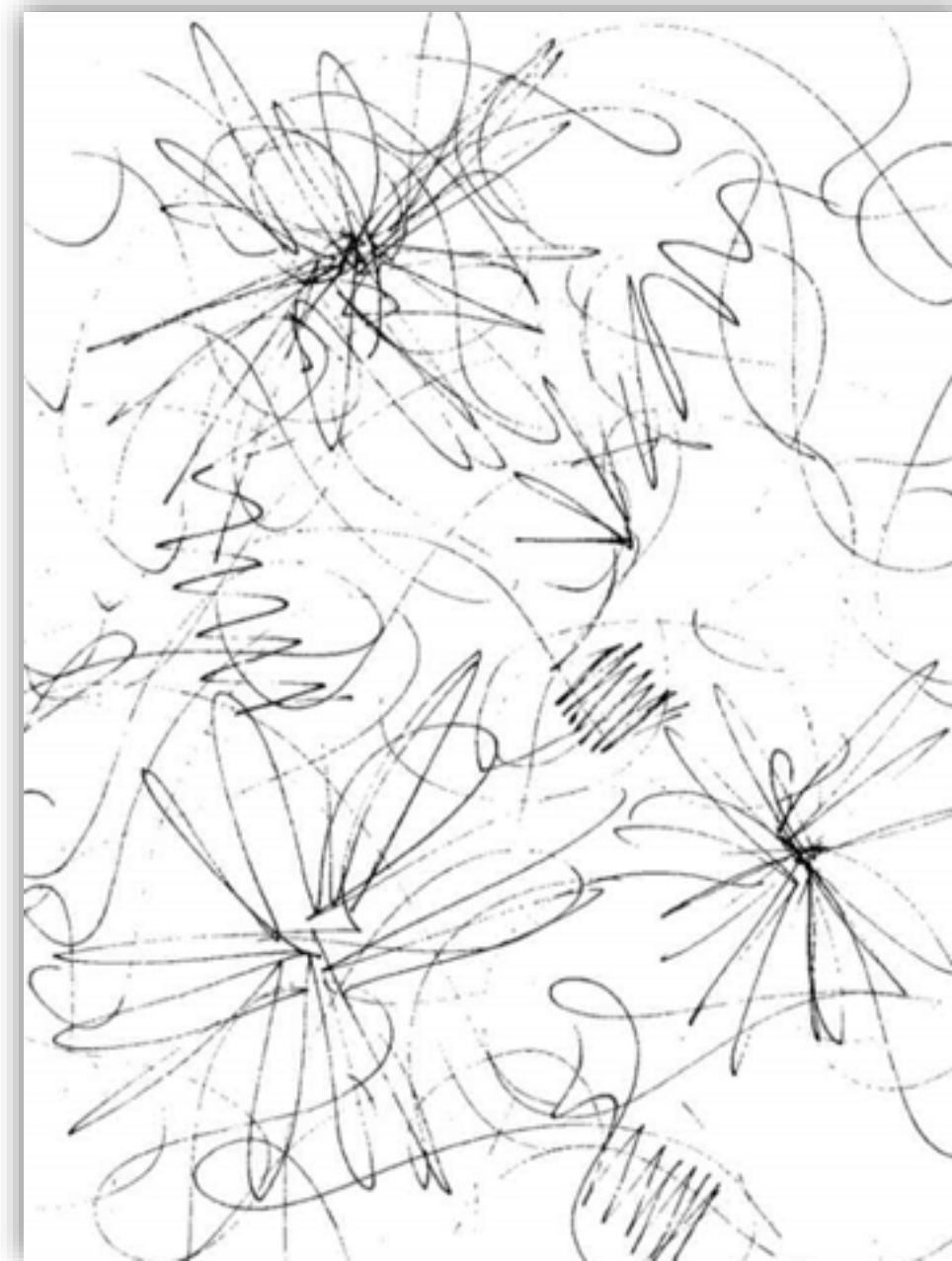

DRAWING TO MUSIC



DRAWING TO MUSIC

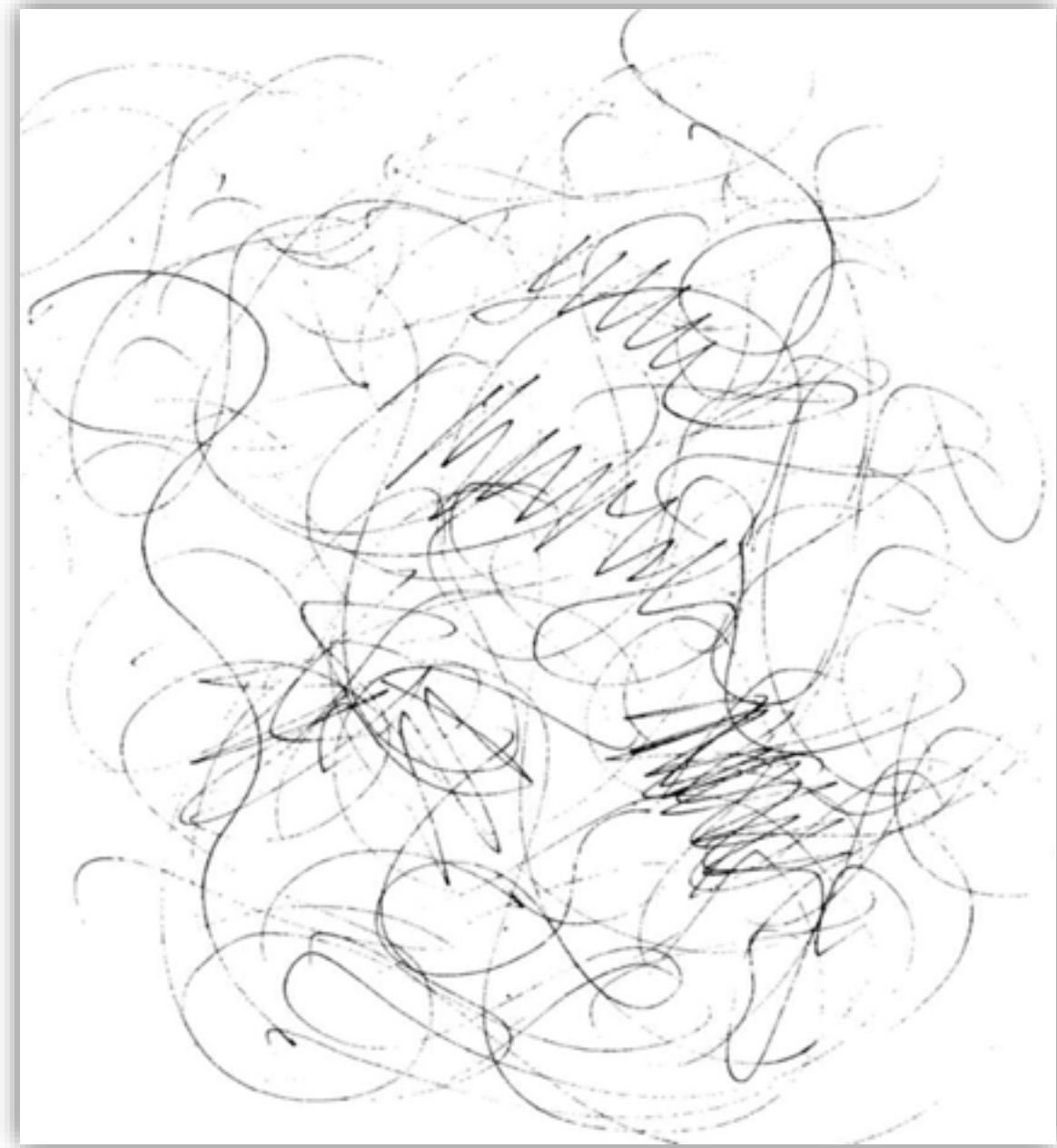
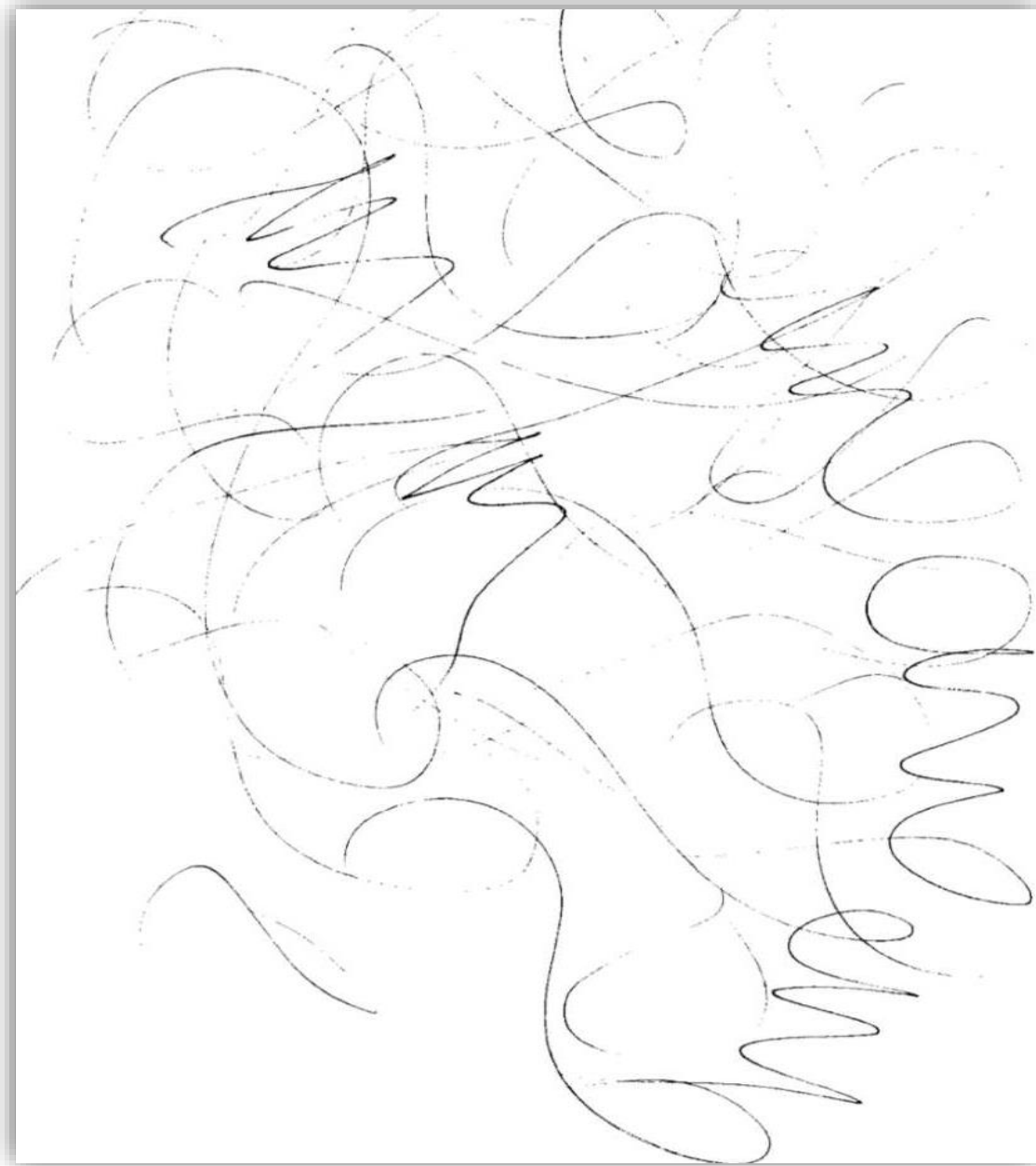

MODEL OF MUSIC

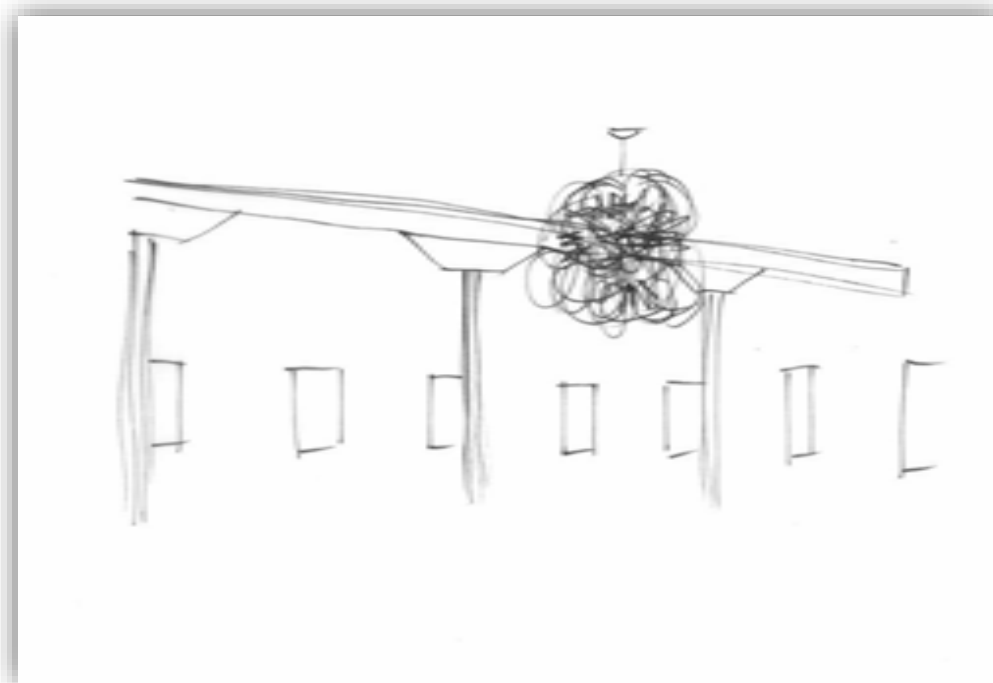

MODEL OF MUSIC (FIGURES)



WAYFINDING

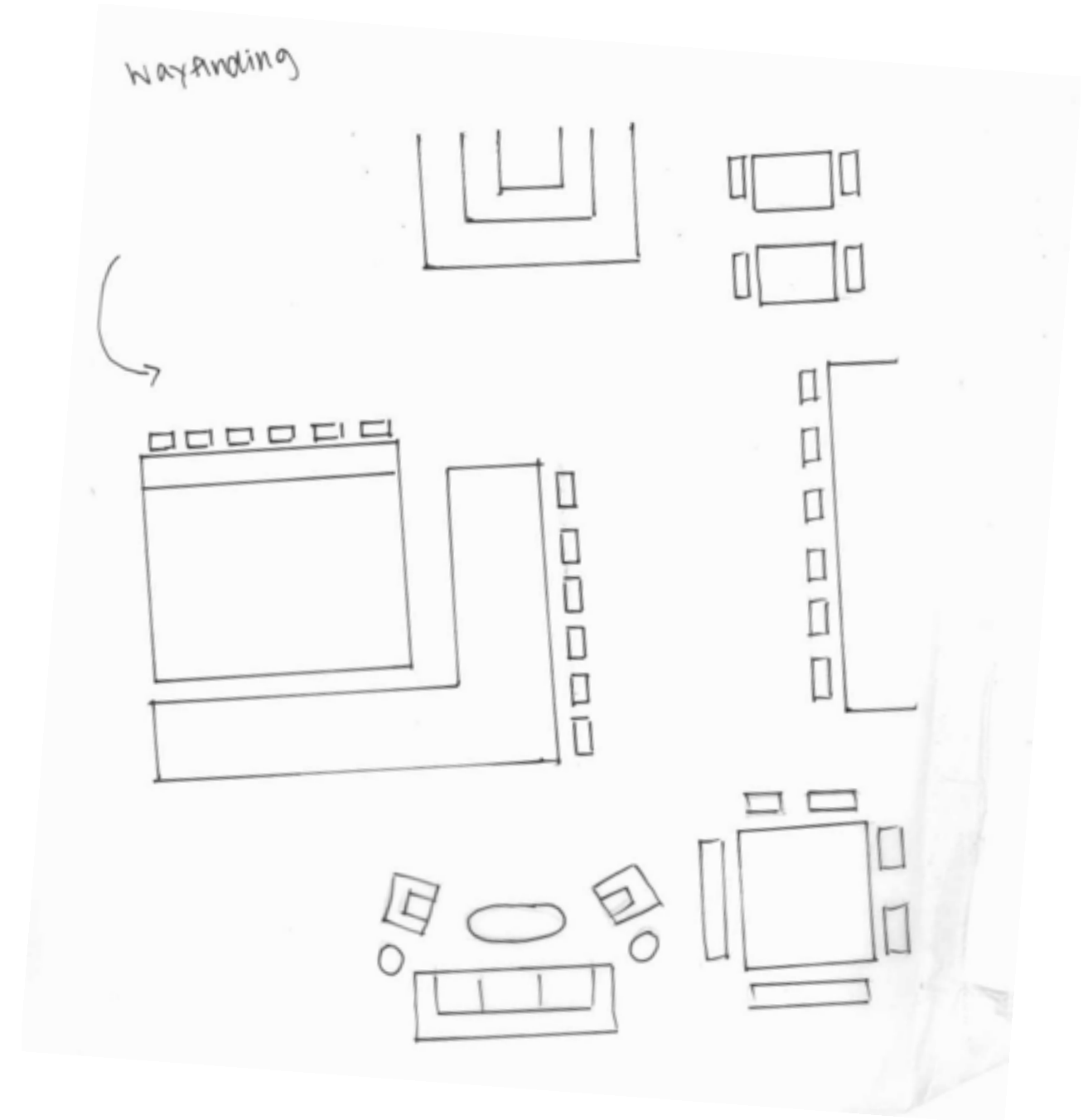
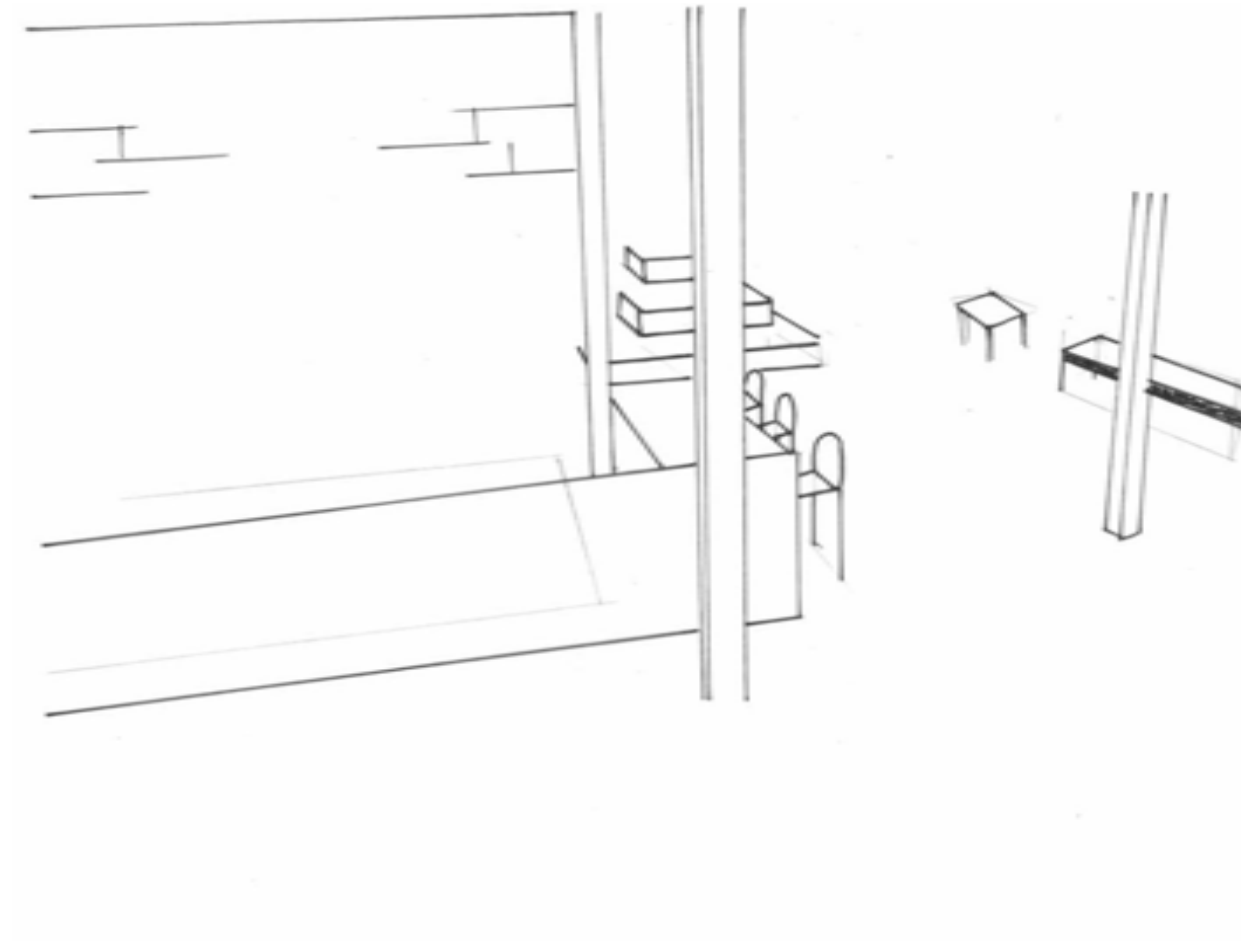

STAIRS

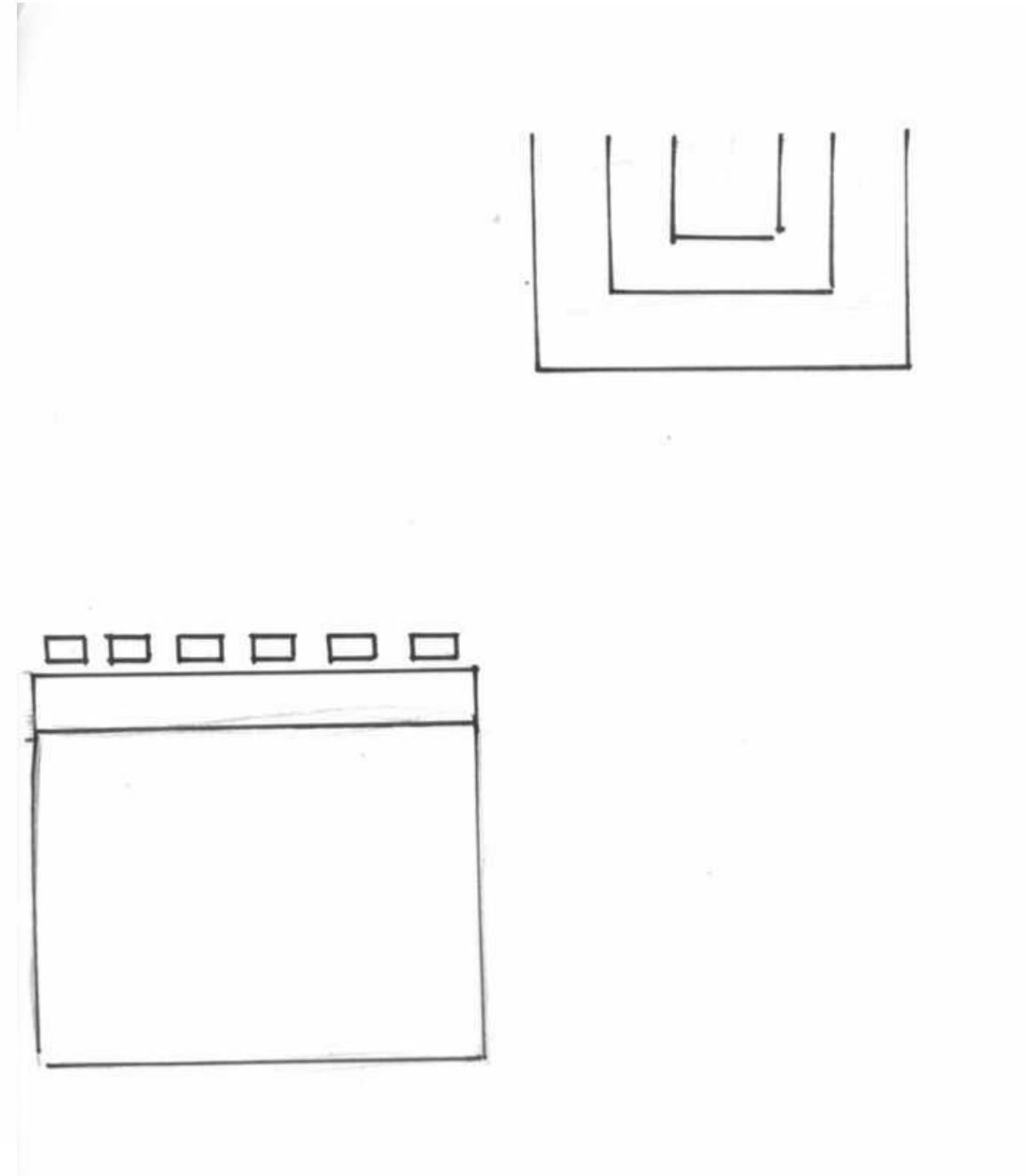
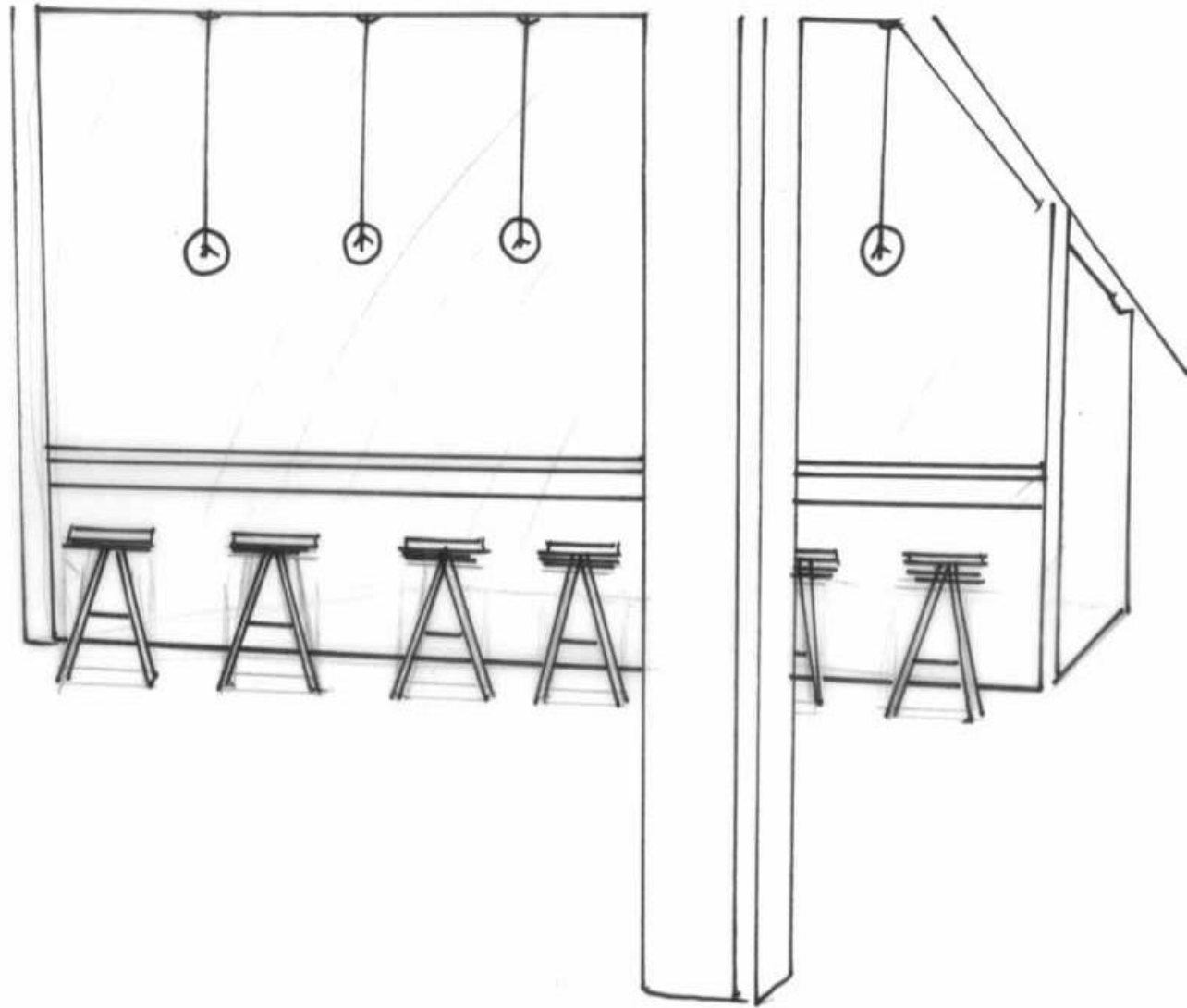

CEILING/DAYLIGHTING

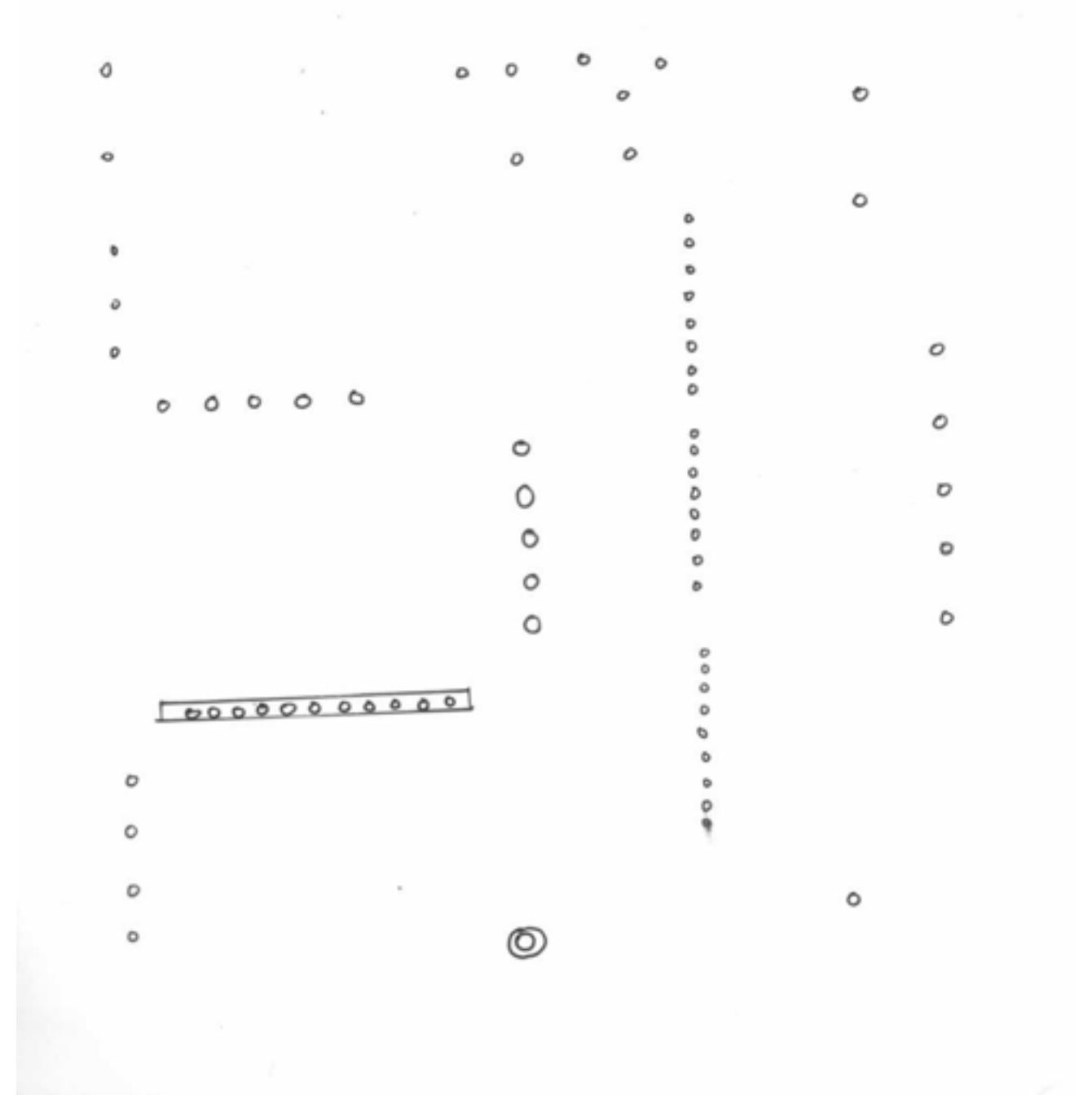
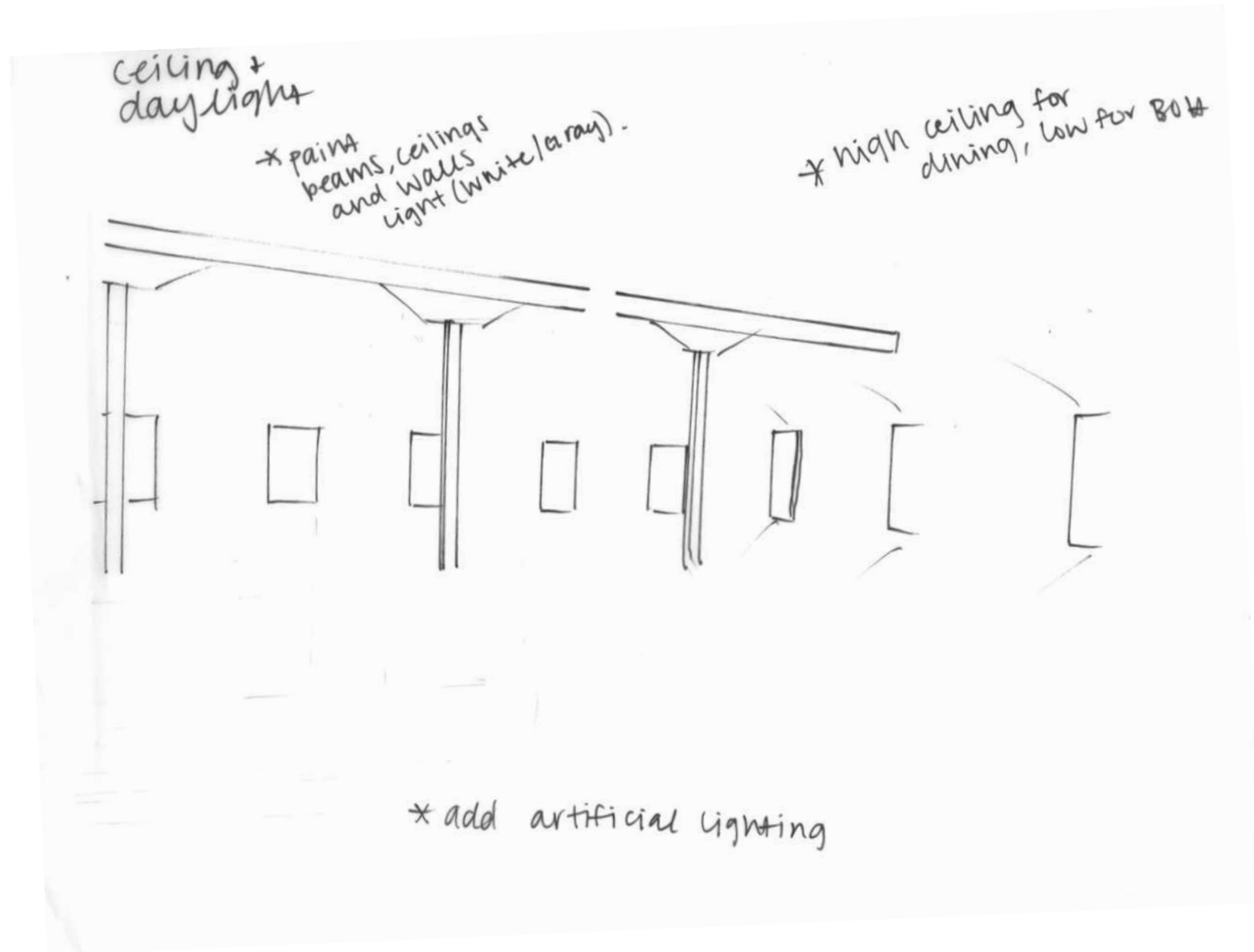

BACK OF HOUSE

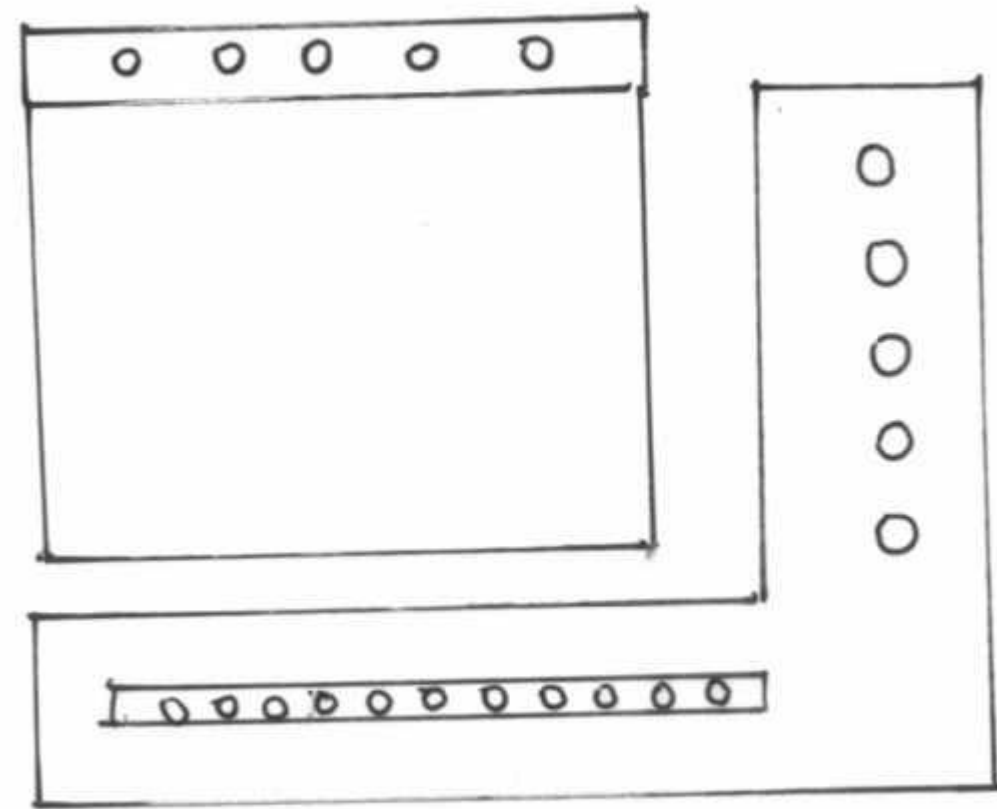
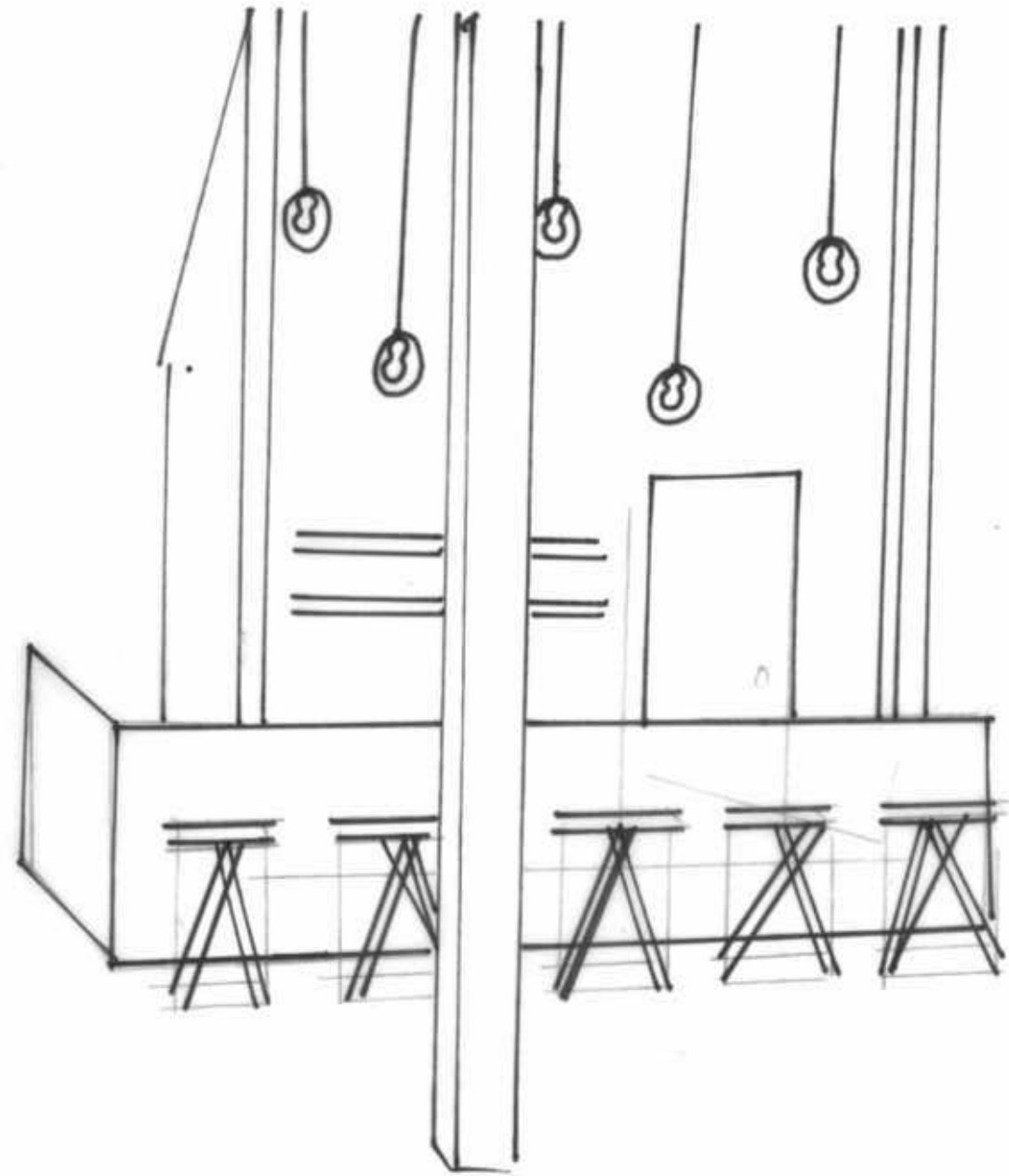

SOCIALIZING

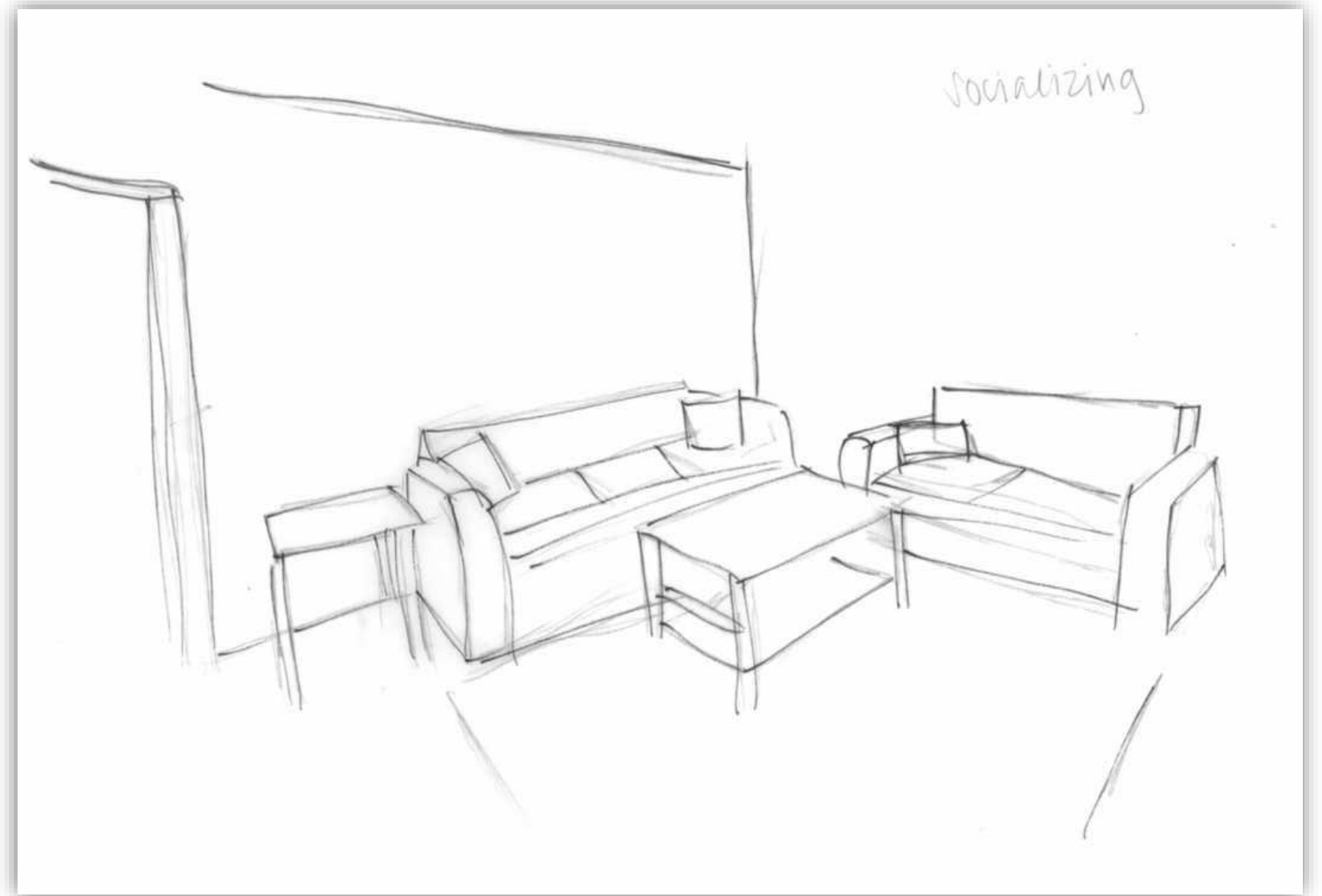

GROUP PLANNING/MEETING

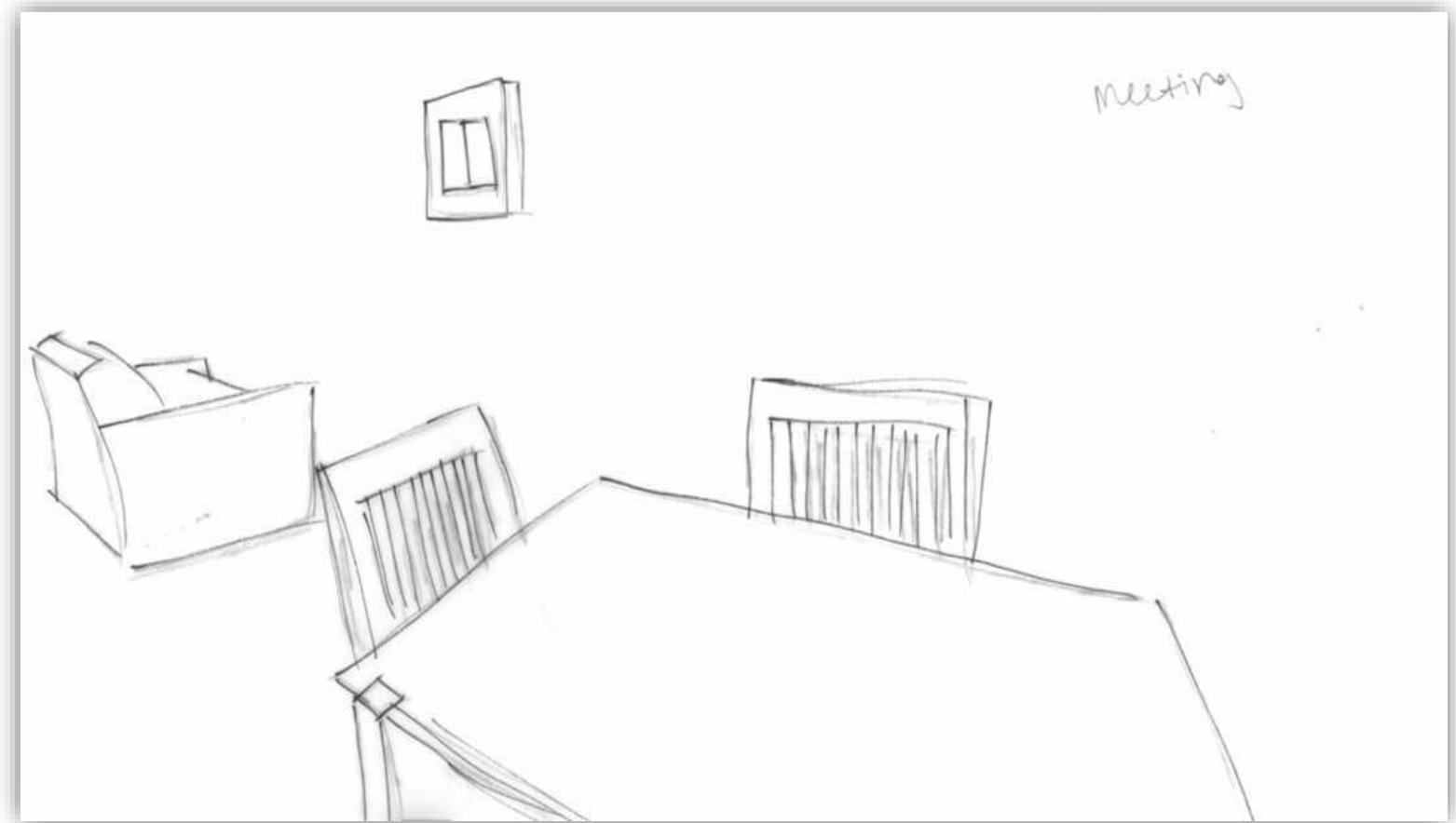

DAYDREAMING

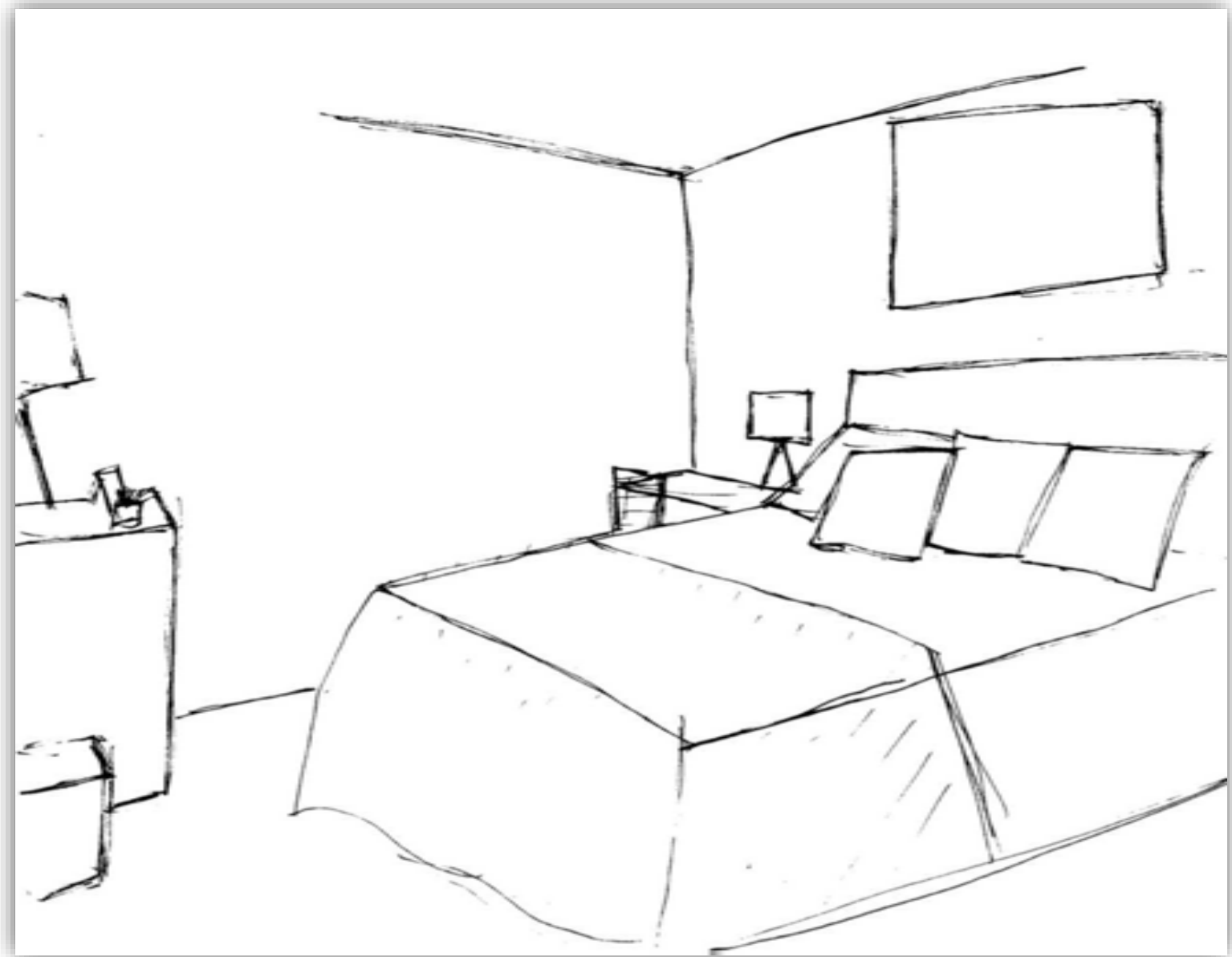

DIFFUSE FOCUS WORK

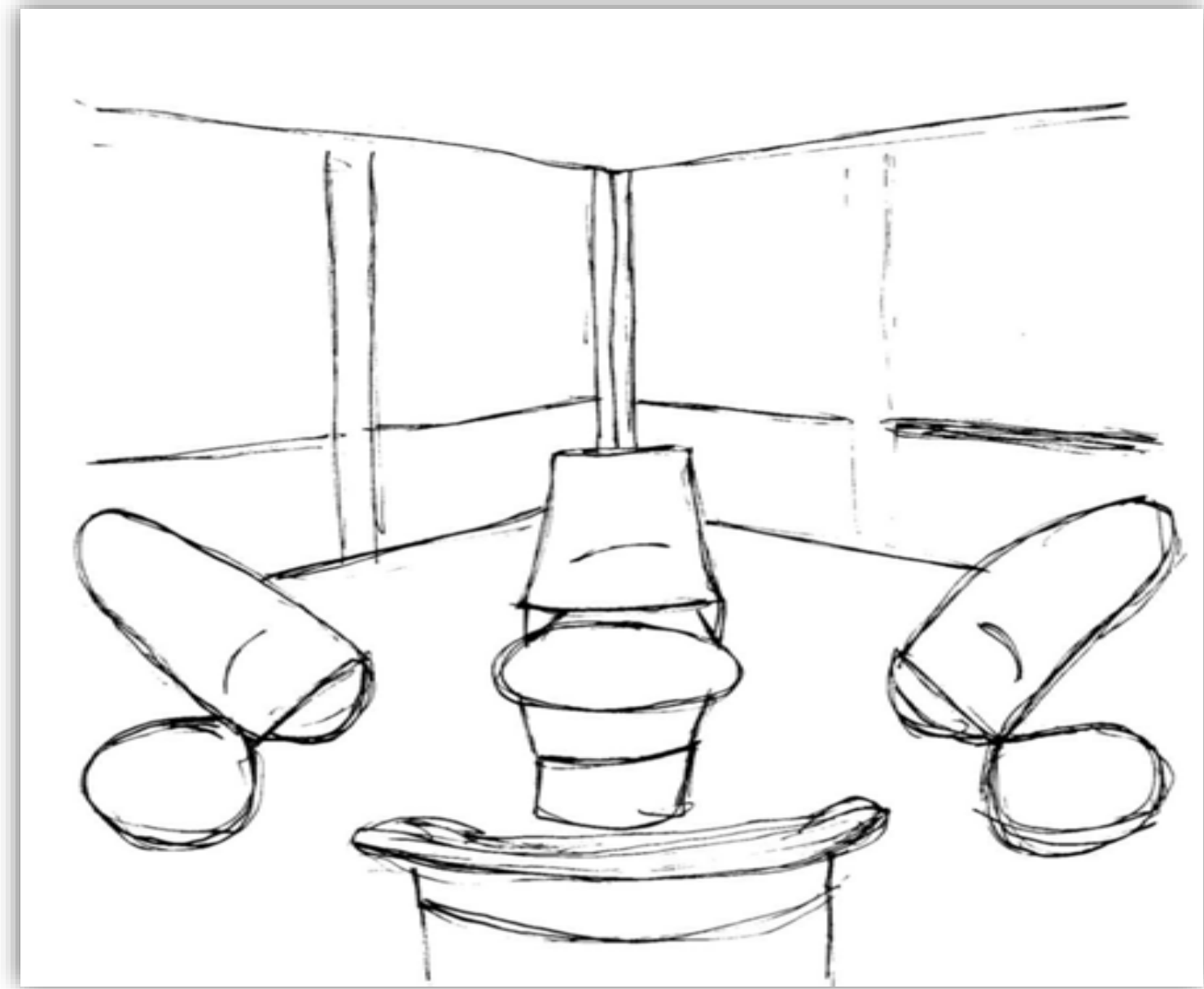

DESIGN CONCEPT

- PAIRING OLD WITH NEW;
RESTORED
- WOODDED; EARTH TONES
- HIGH CONTRAST; CLEAN
- BLENDING MODERN WITH
RUSTIC FOR A FRESH
FEEL



COLOR RATIONALE

- COMPLEMENTARY COLOR SCHEME
- INCOPERATING AN ORGANIZED, REFINISHED ENVIRONMENT
- HIGH CONTRAST
- BLACKS & WHITE, BRONZE, BROWNS, BLUES, ACCENTS OF GREENS
- ENVOIRNMENTAL, CALMING, WARM; TOBACCO WAREHOUSE

