

IDEATION

PORTFOLIO 2

FALL INTERIOR DESIGN STUDIO 001

JULIEN WOHLGEMUTH

DRAWING TO MUSIC

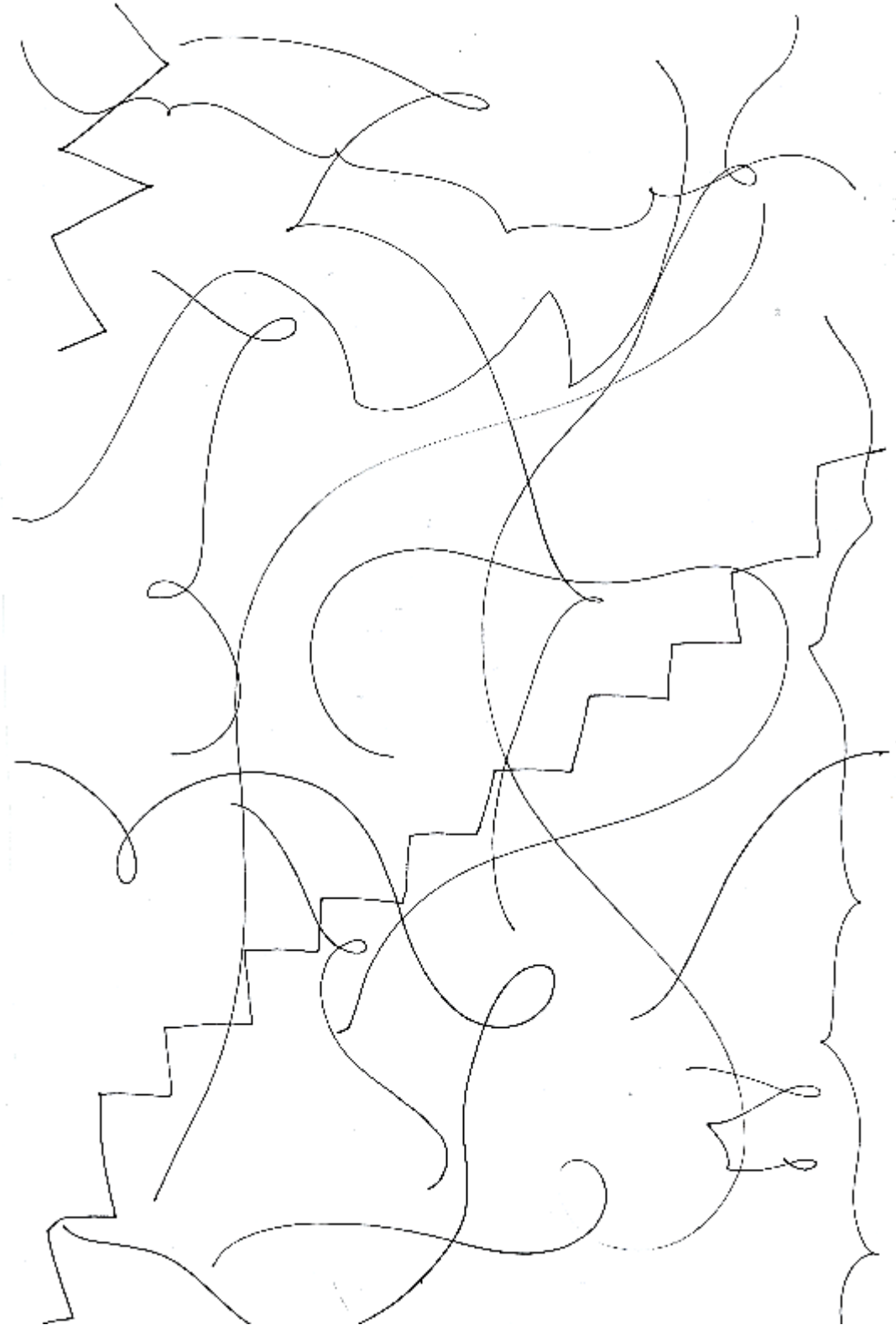
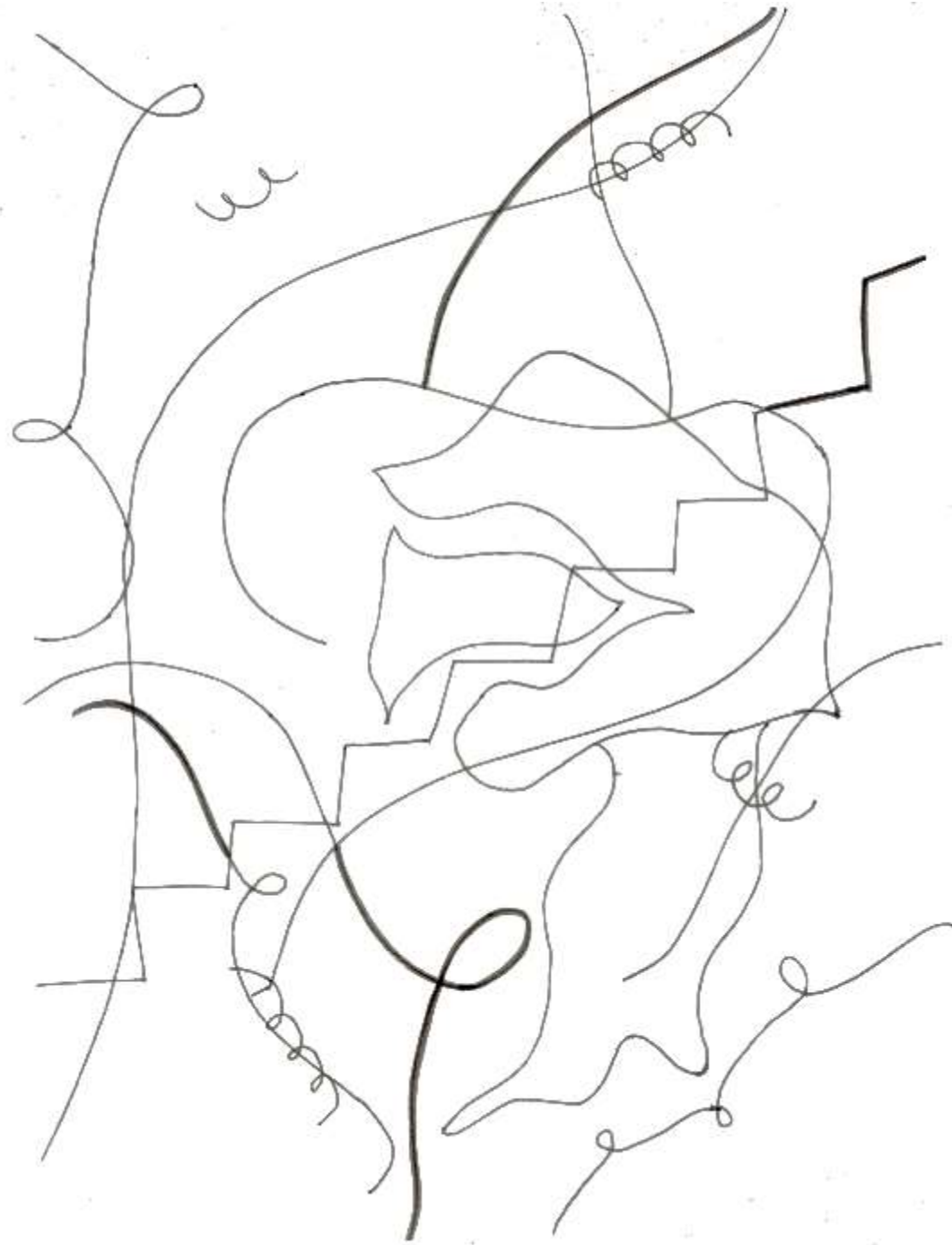

DRAWING TO MUSIC

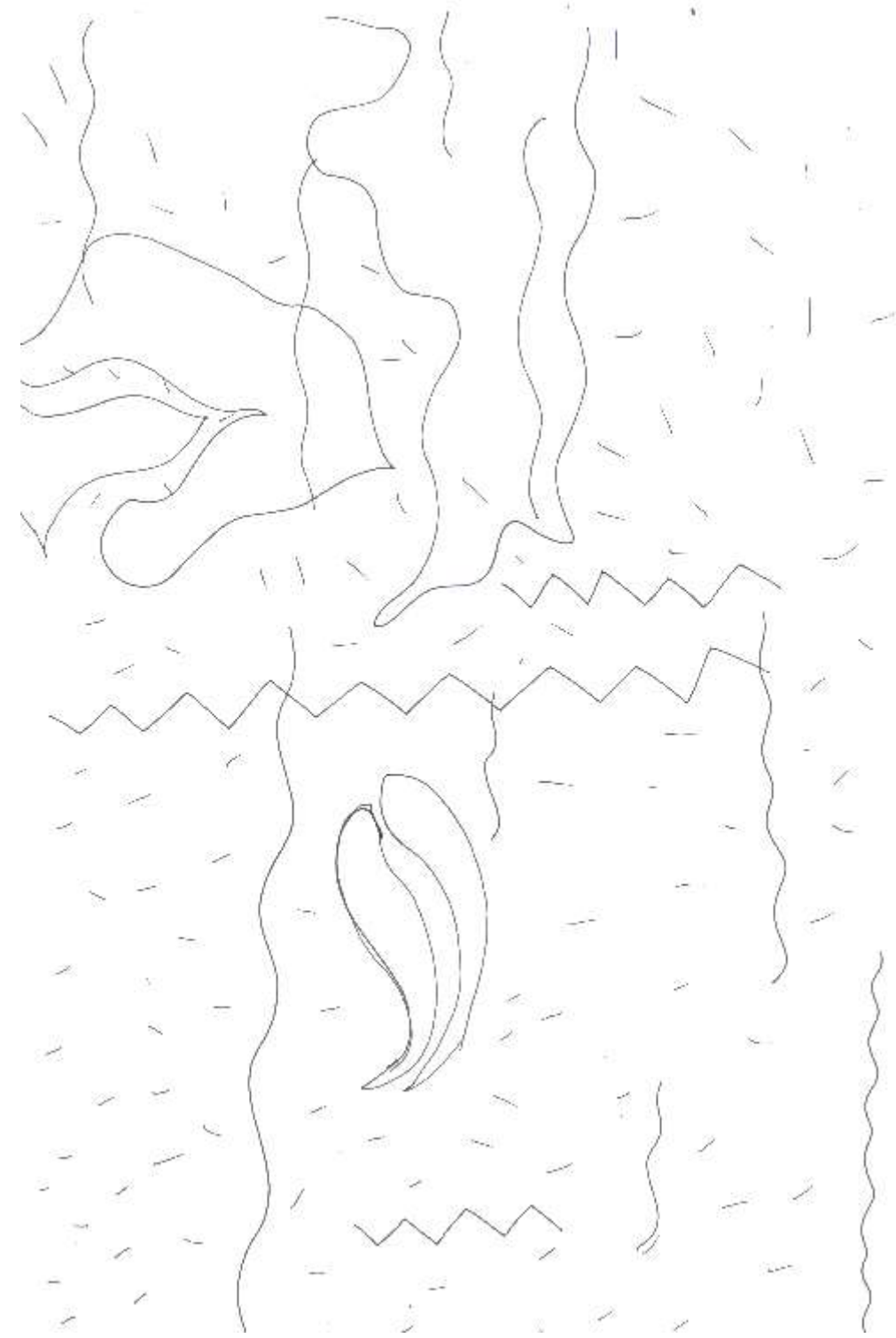
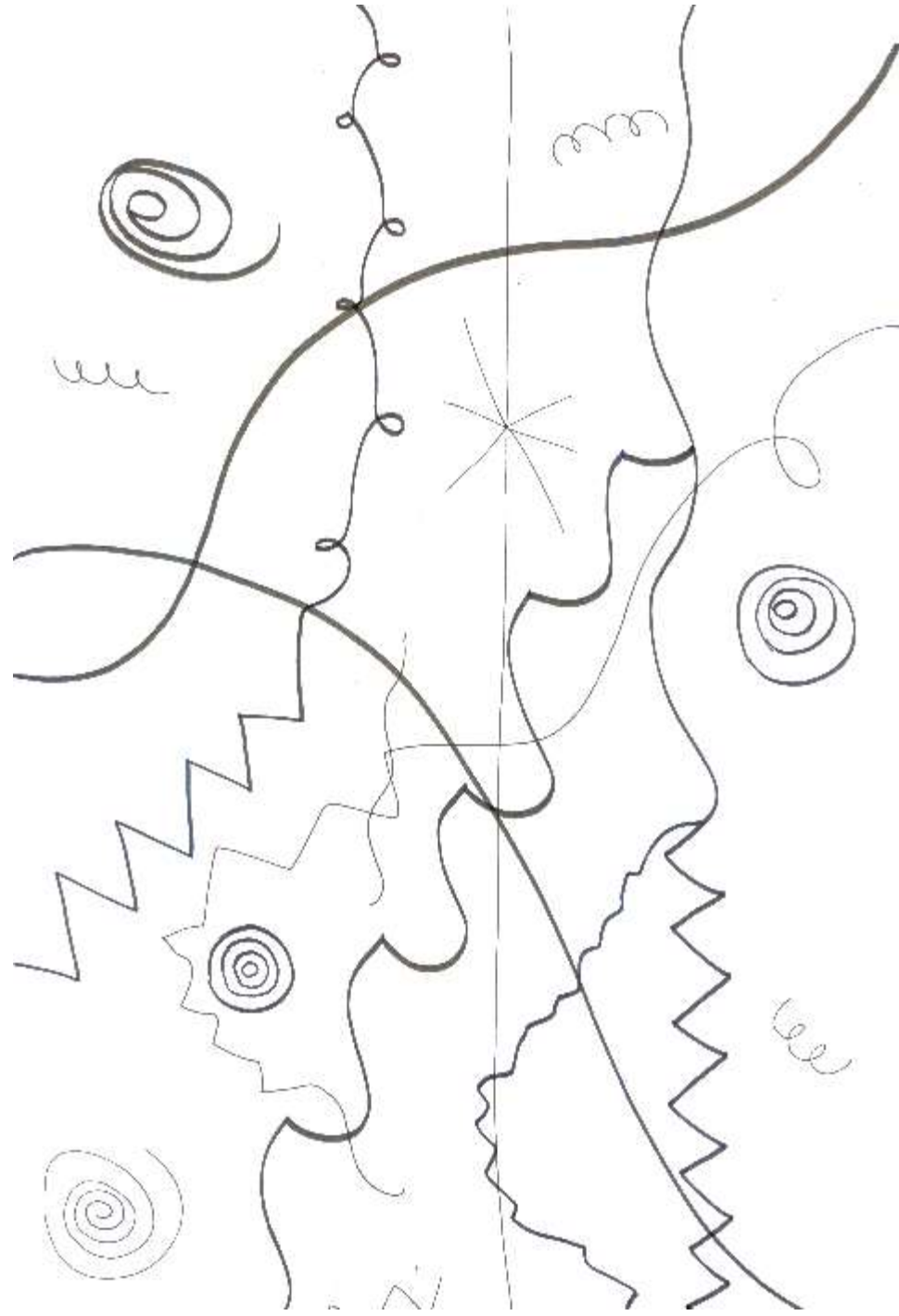

MUSIC MODEL



MUSIC MODEL



- Spindles emerge over & through ceiling beams
- triangles in base are warmly illuminated



WAYFINDING

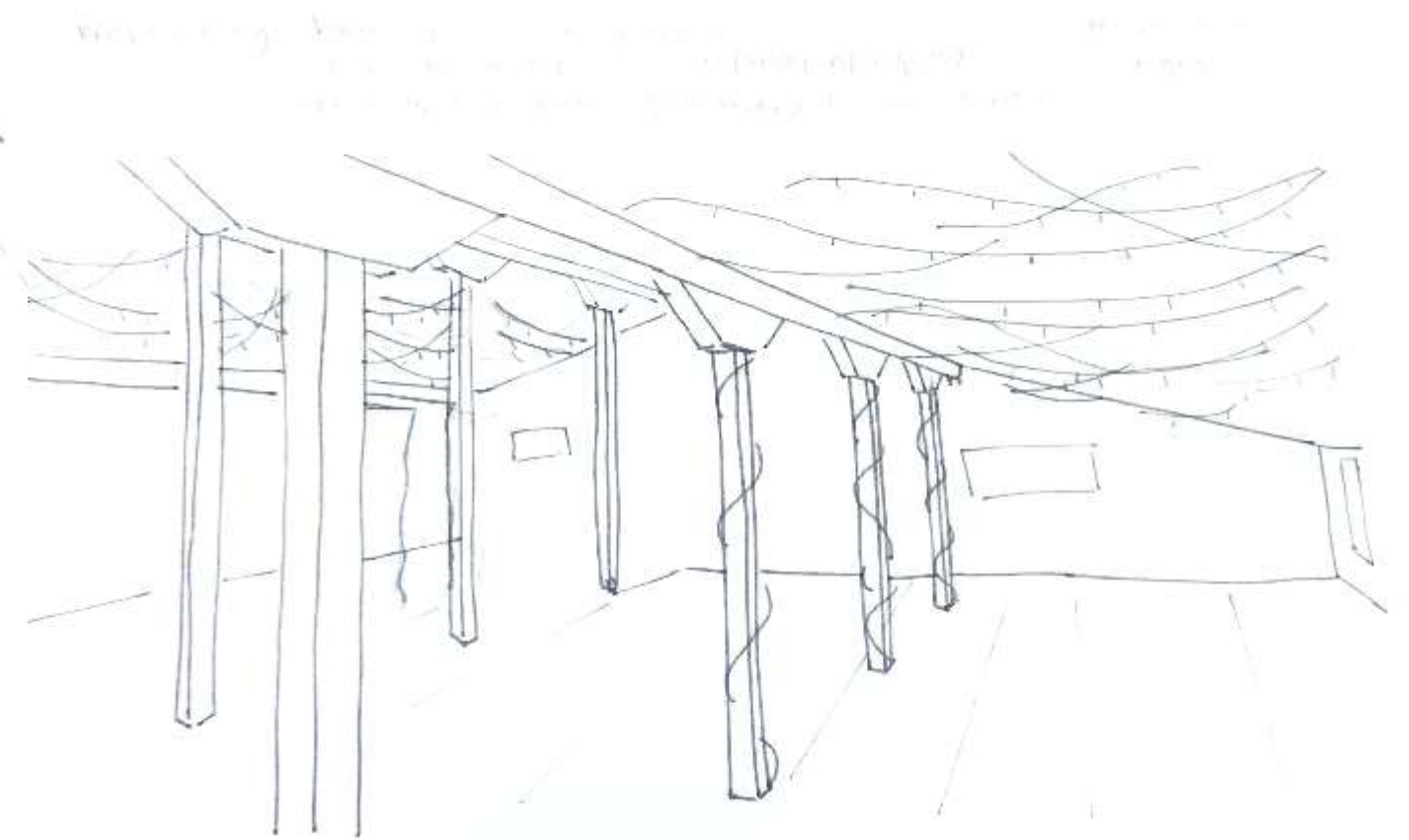
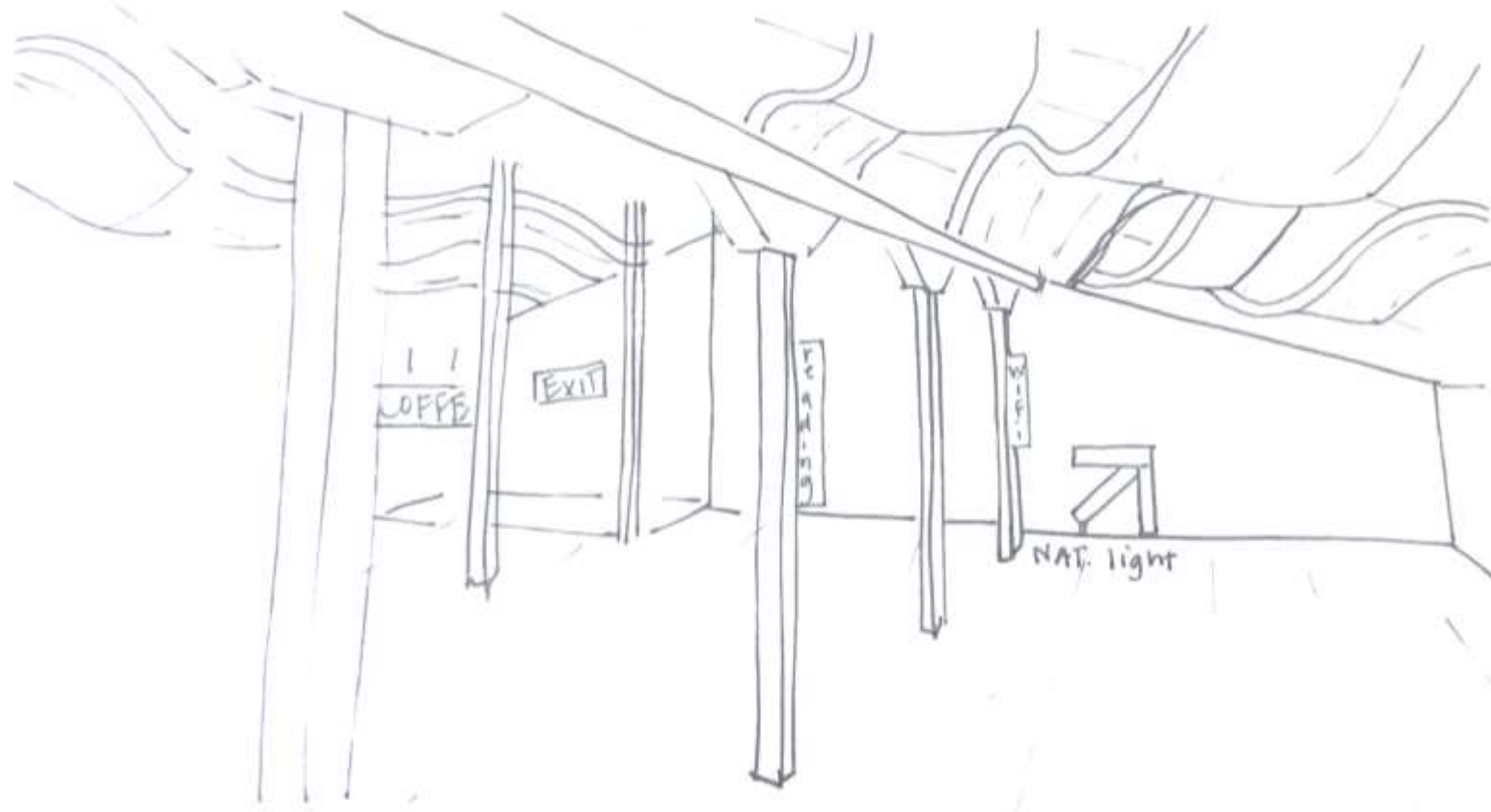

STAIRS

~~2102 9/18~~ Stairs
2102 9/18

- sign behind the door a.
- eating coffee
- enclosed common area
- w/ doors & curtains



- added glass window door for entrance
- diff flooring on stairs & entry
- lots of signage
- sheer curtains from common area

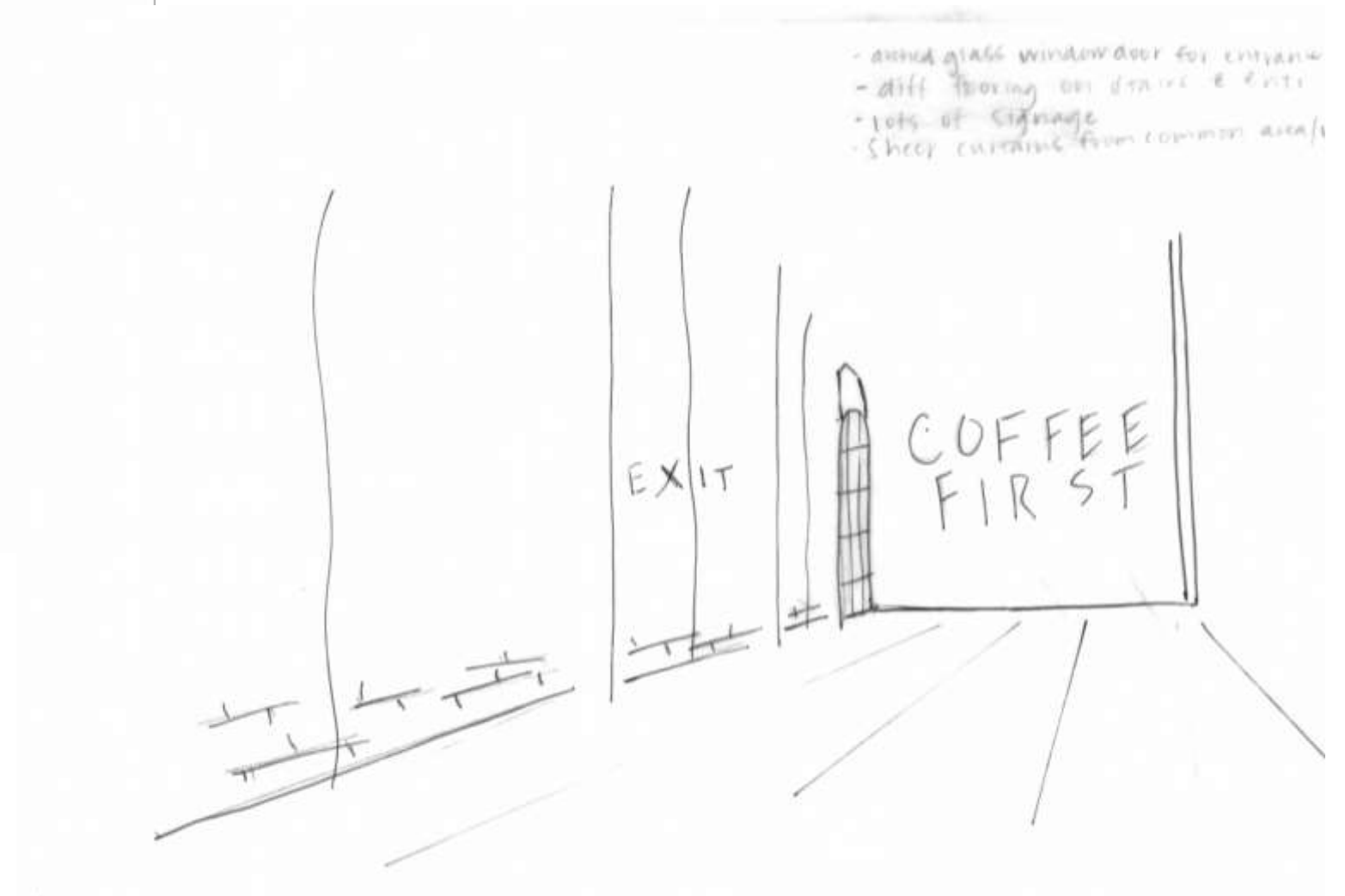

CEILING/DAYLIGHTING

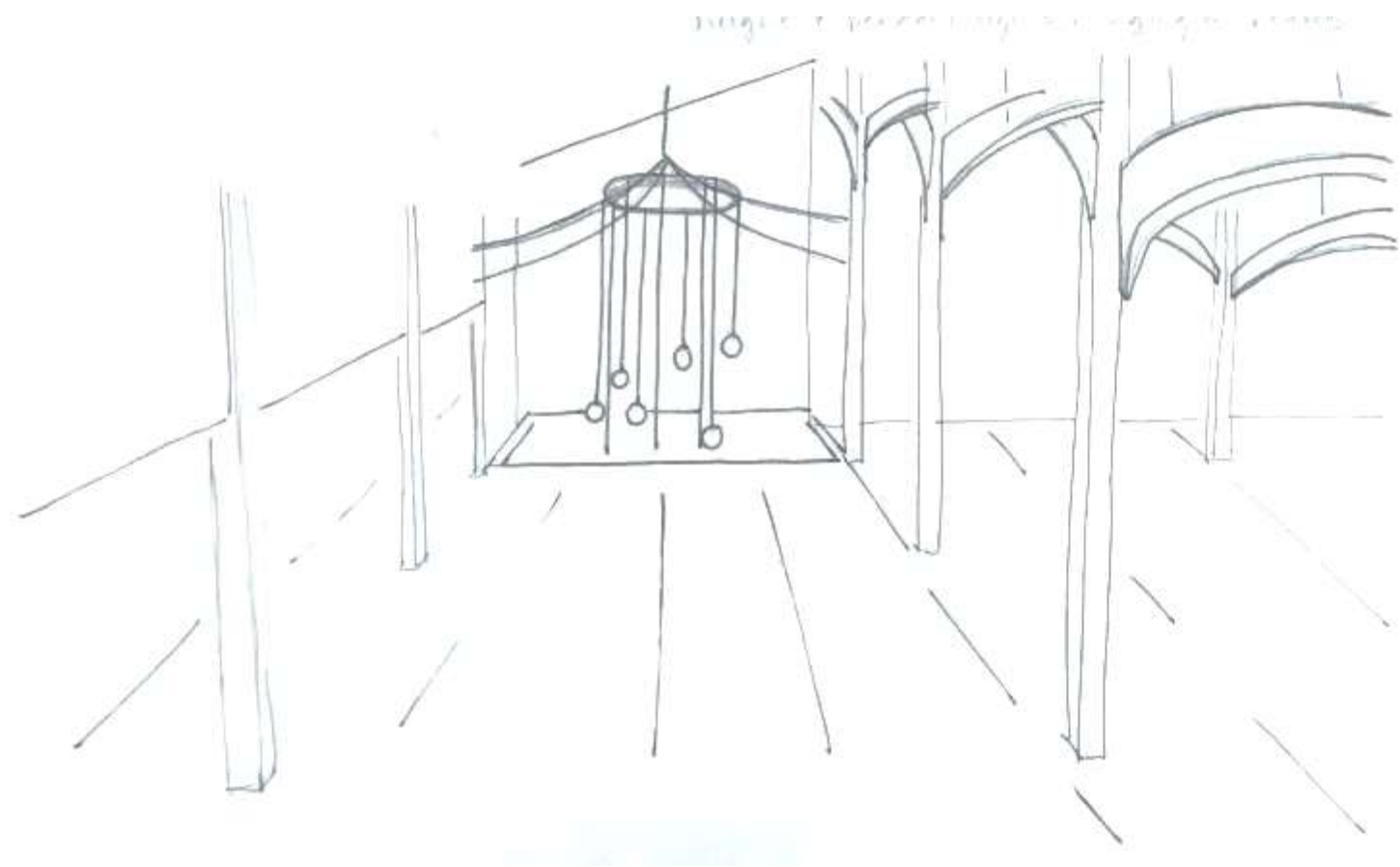

ceiling/daylighting
2102 9618

ceiling → built lights in recessed
panels → daylight bulbs
at 1100 height

② daylight for reading
areas @ near sides of
building

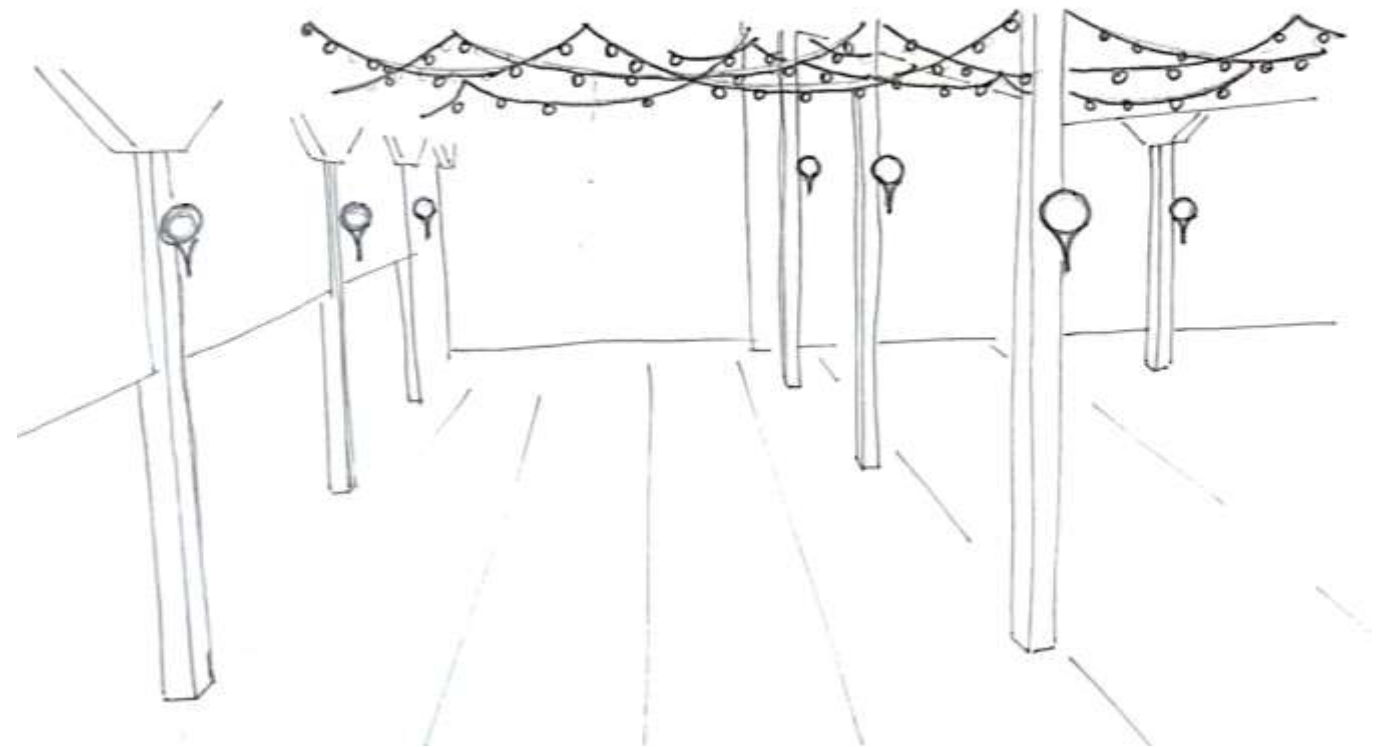

BACK OF HOUSE SPACE

Back of House Space
with kitchen area
and walk-in cooler

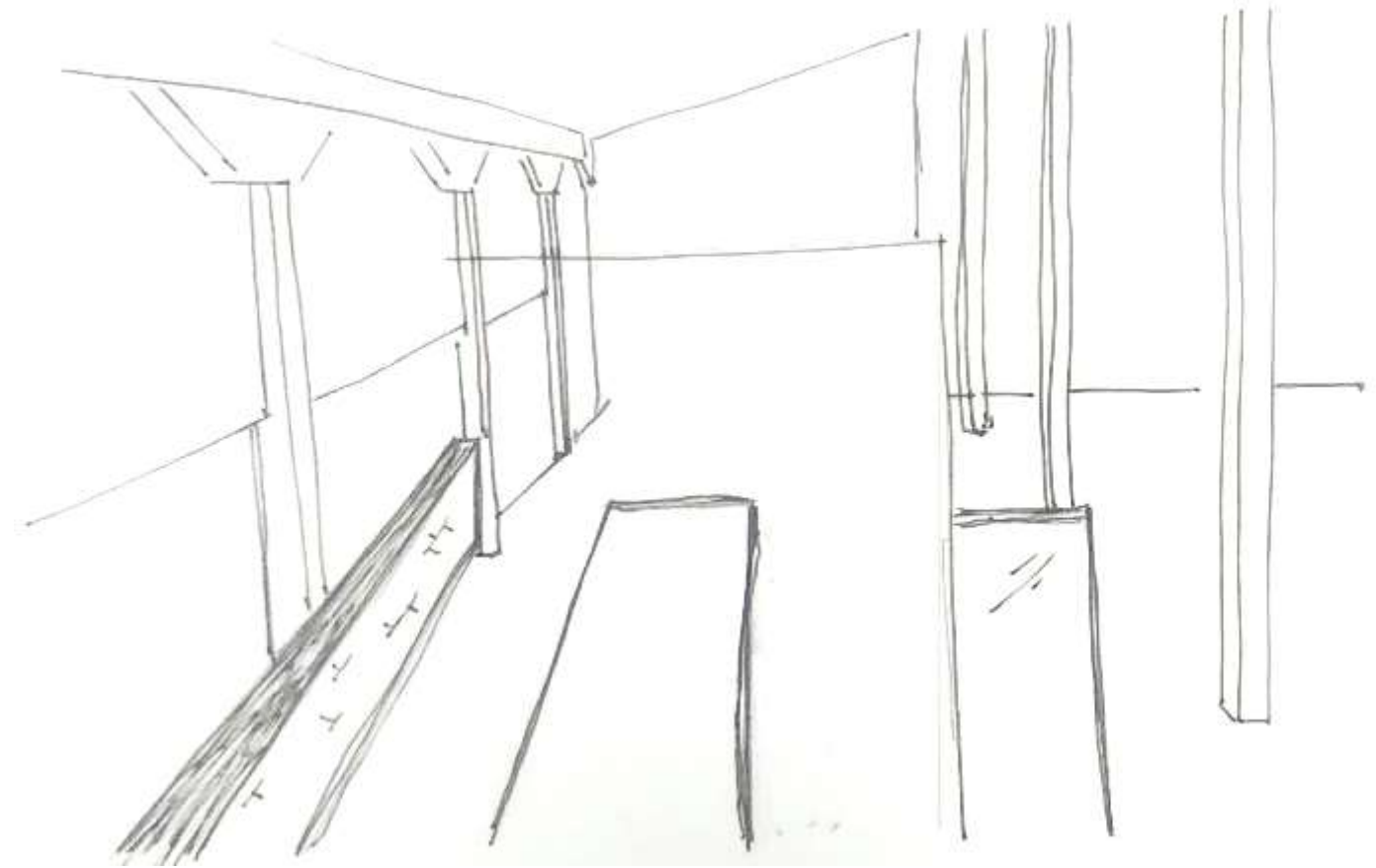
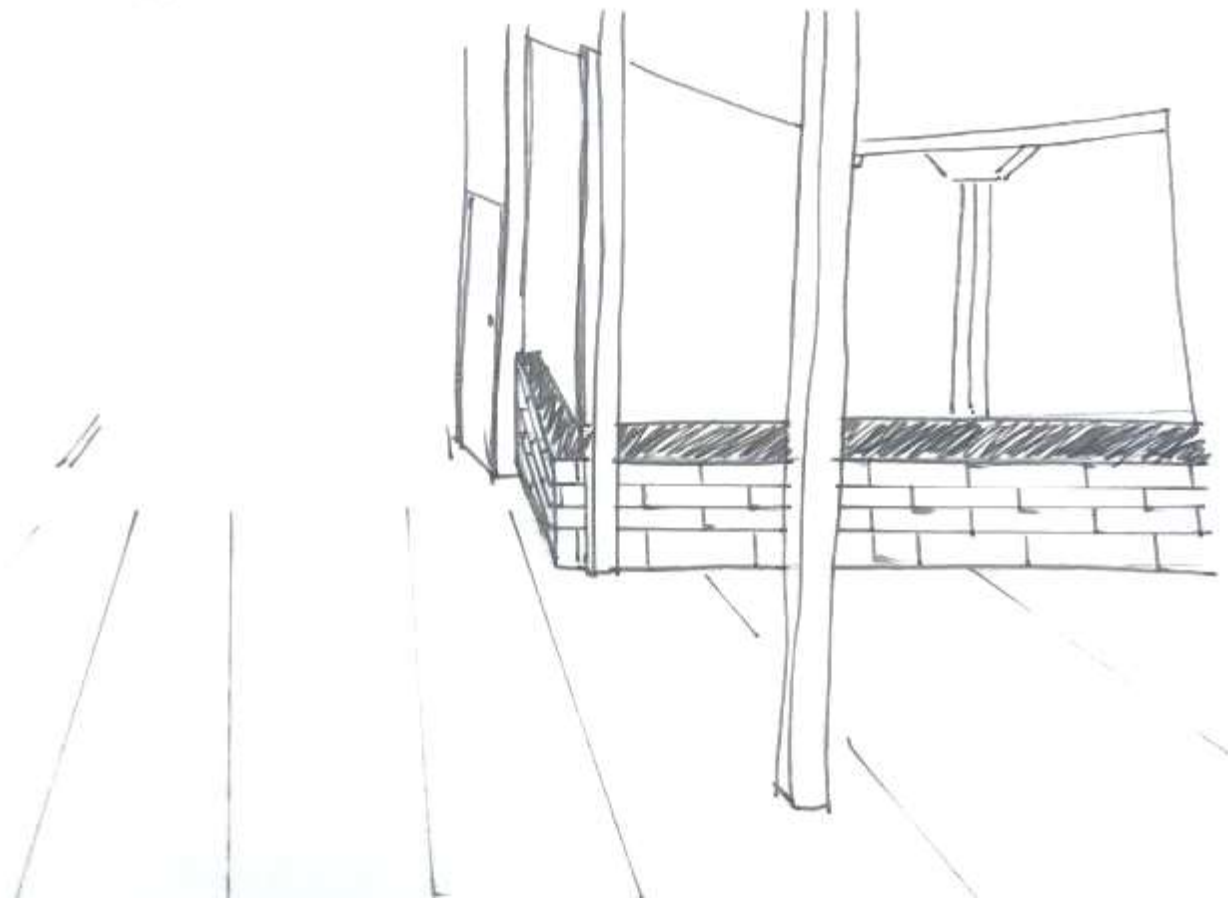

DIFFUSE FOCUS WORK

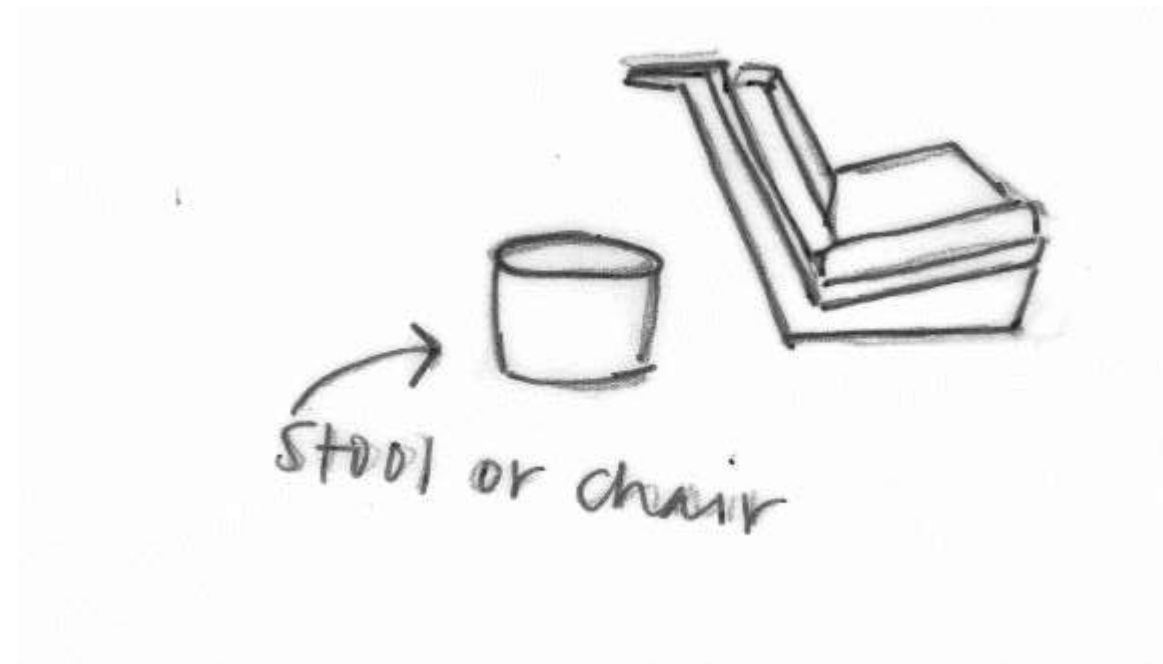
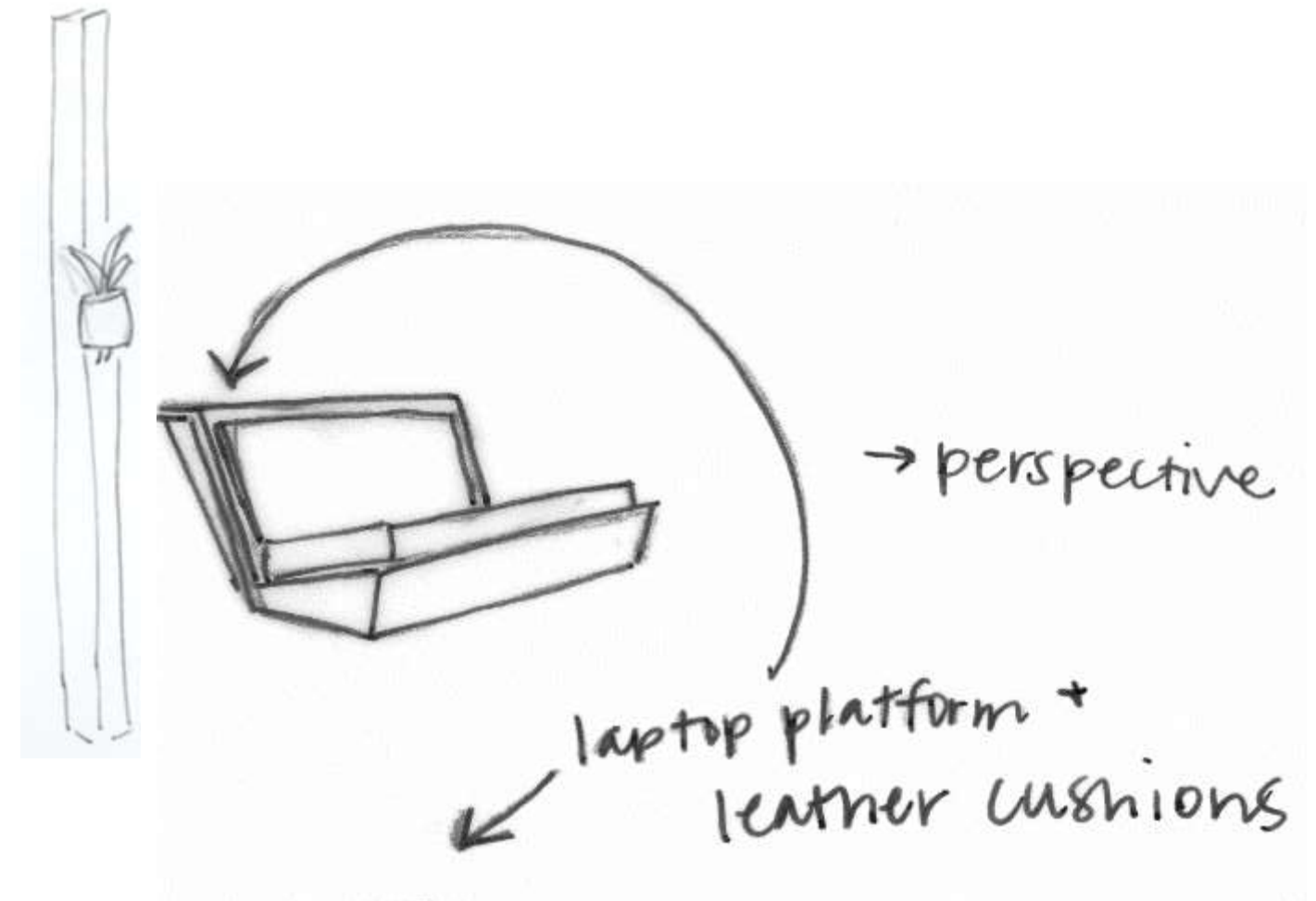
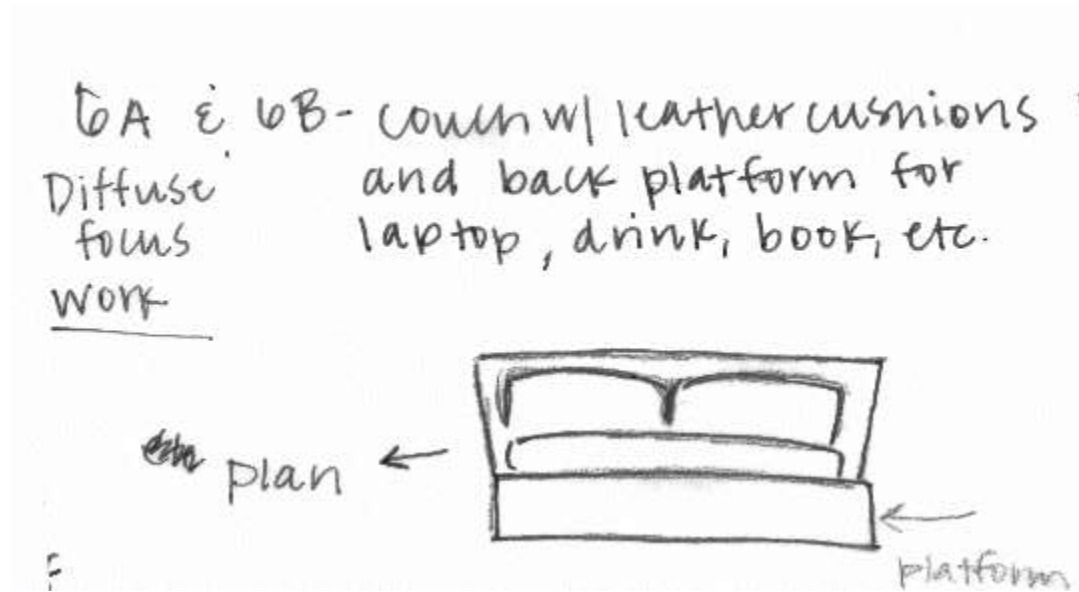

DAYDREAMING

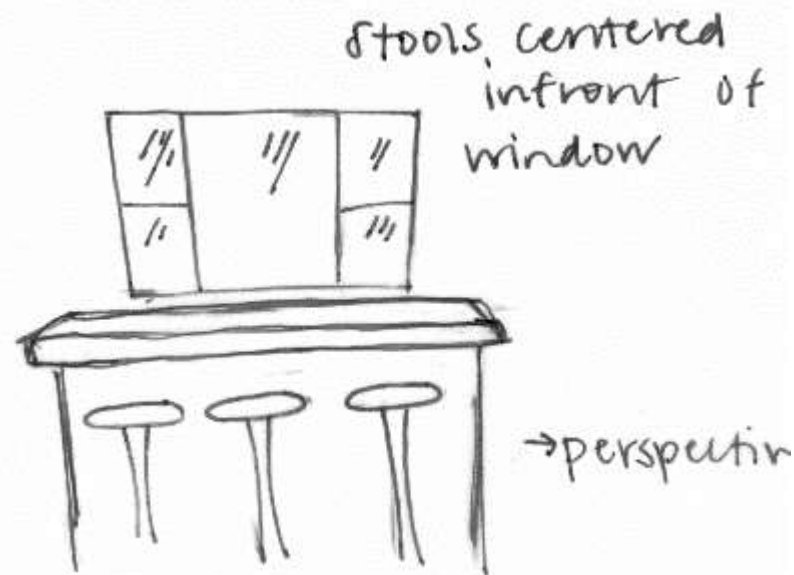
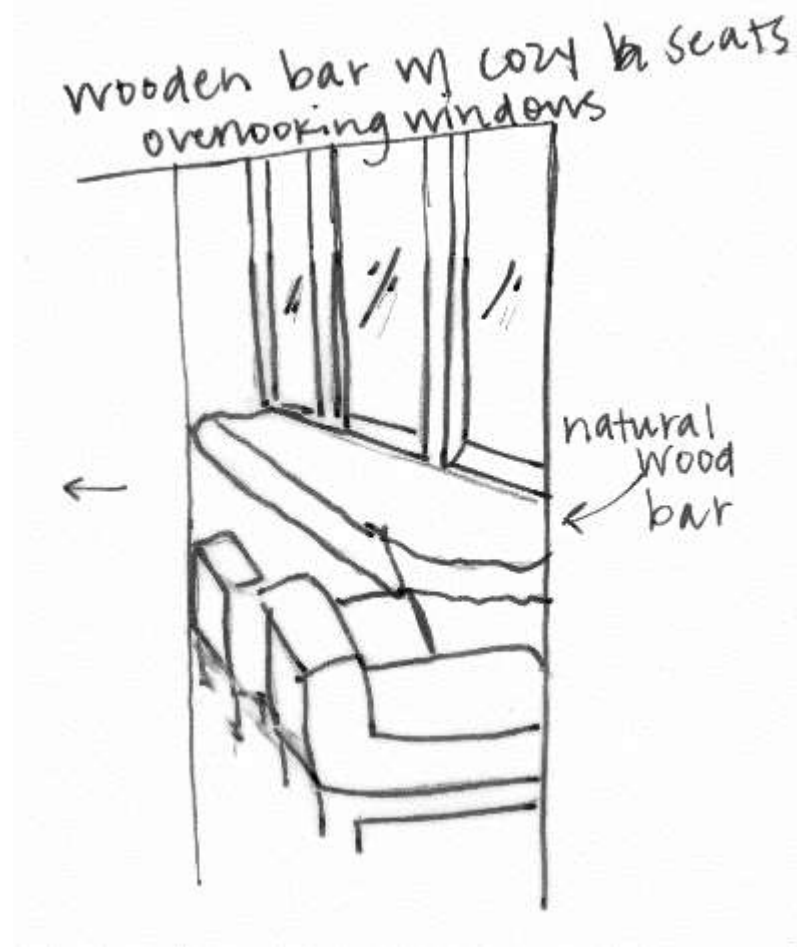
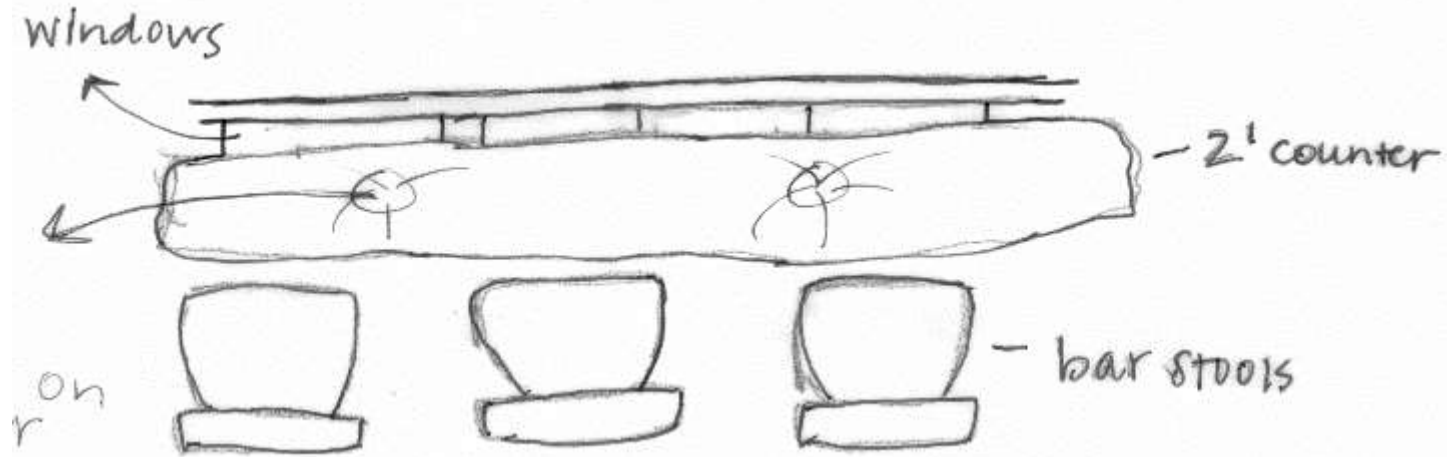

GROUP PLANNING/MEETING

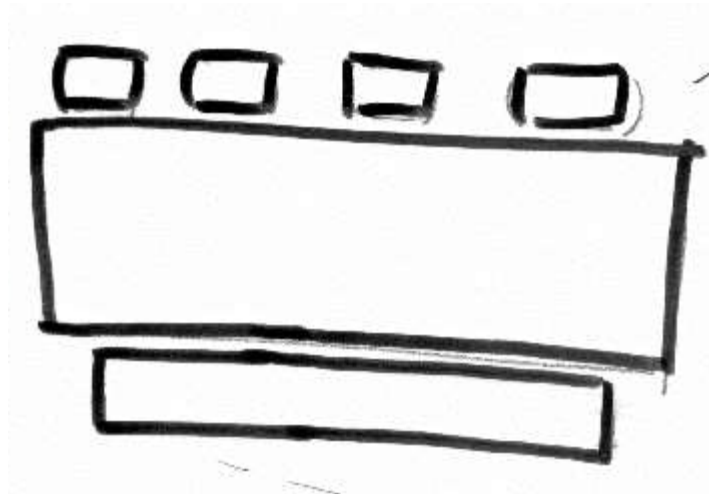
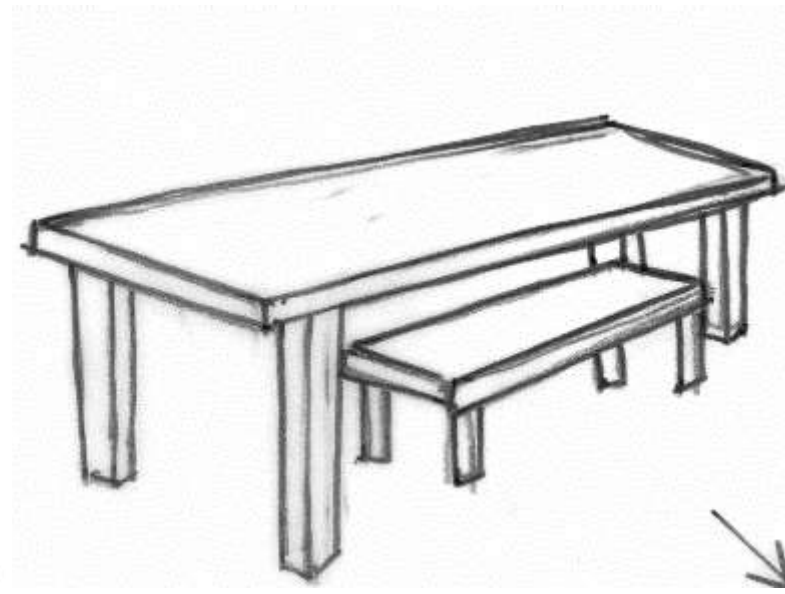
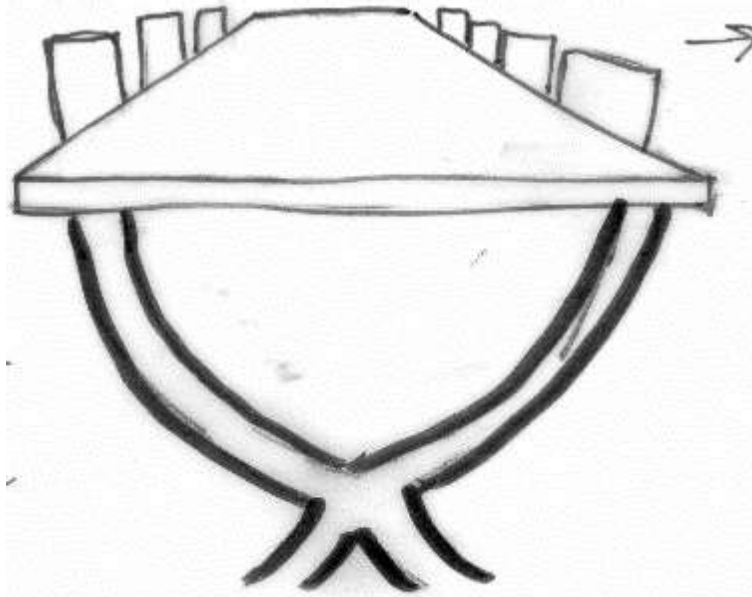

SOCIALIZING

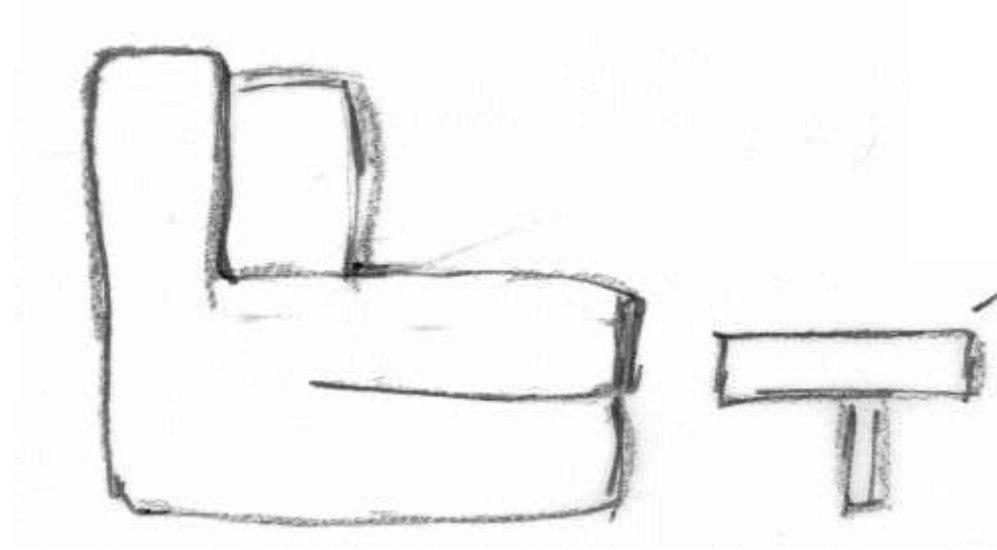
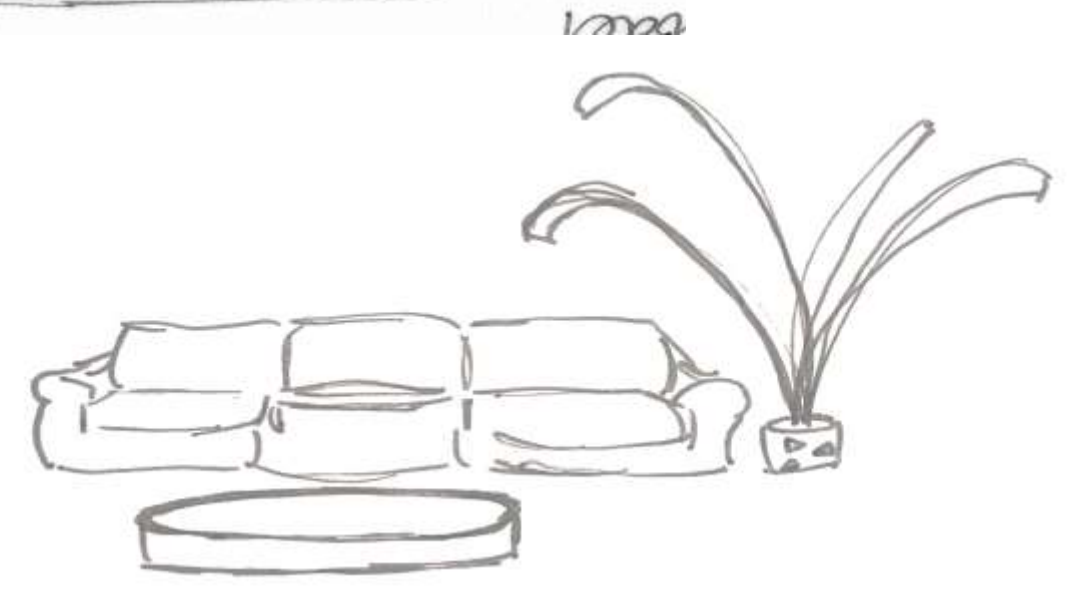
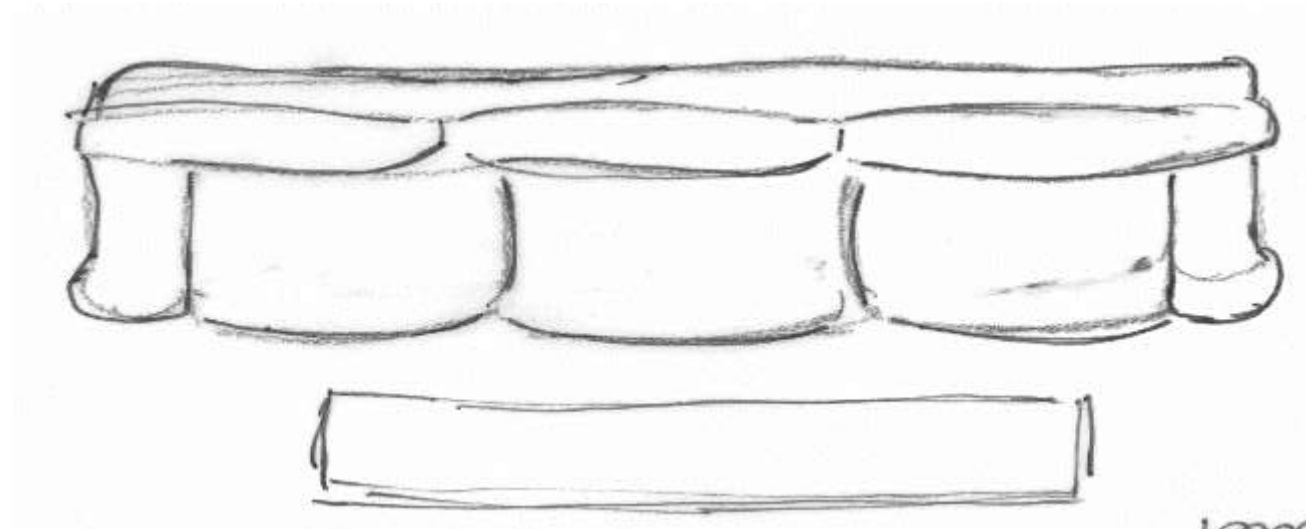

DESIGN CONCEPT

- CRISP/CLEAN- HIGH CONTRAST; ORGANIZED
- ORGANIC- PLANT/NATURAL LIFE
- RUSTIC- REFINISHED/RESTORED ORIGINAL WOOD
- INVITING
- CONNECTED- TECH FRIENDLY

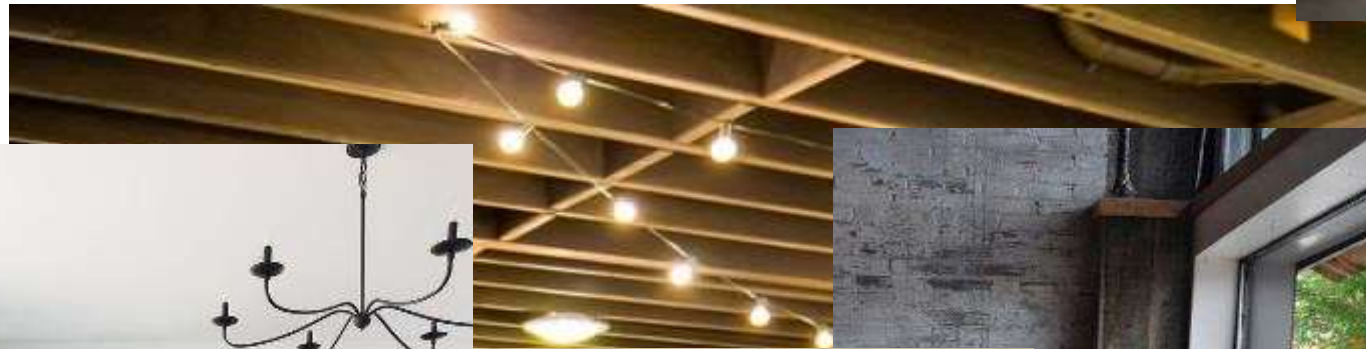

COLOR RATIONALE

- HIGH CONTRAST- BLACK AND WHITE
- ACCENTS OF GOLD, GREY, GREEN AND BROWN
- INCORPORATING A CLEAN, NEAT WORKSPACE-LIKE ENVIRONMENT INTO A WARM, FRIENDLY ATMOSPHERE TO MAKE THE WORKER FEEL AT HOME

