



# *Portfolio 3*

Corey Eads

14 November 2019

IDSN 2102



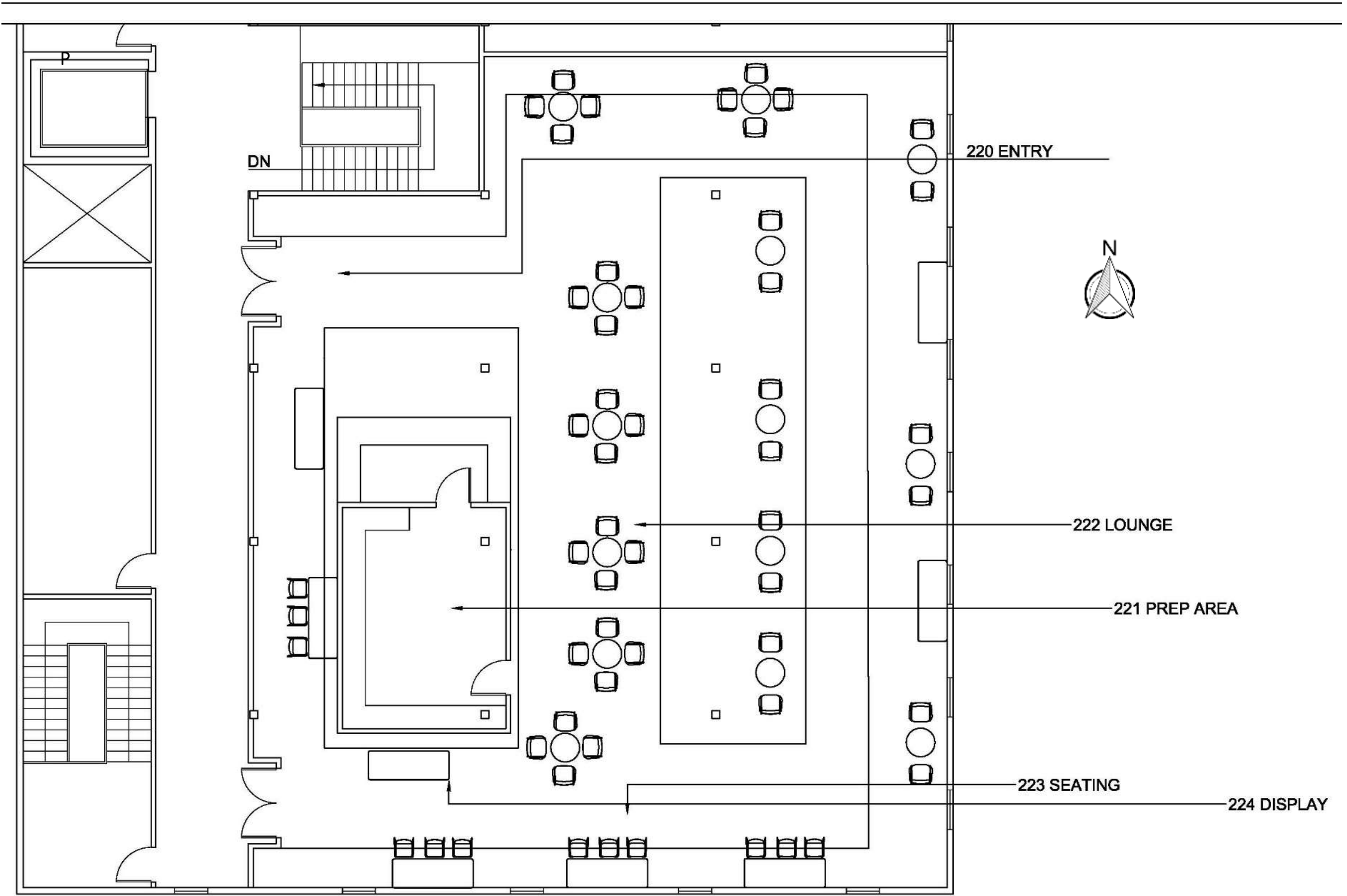

# Corey Eads IDSN 2102 F19

# Assignment 13

# *Relaxing under the Sea*

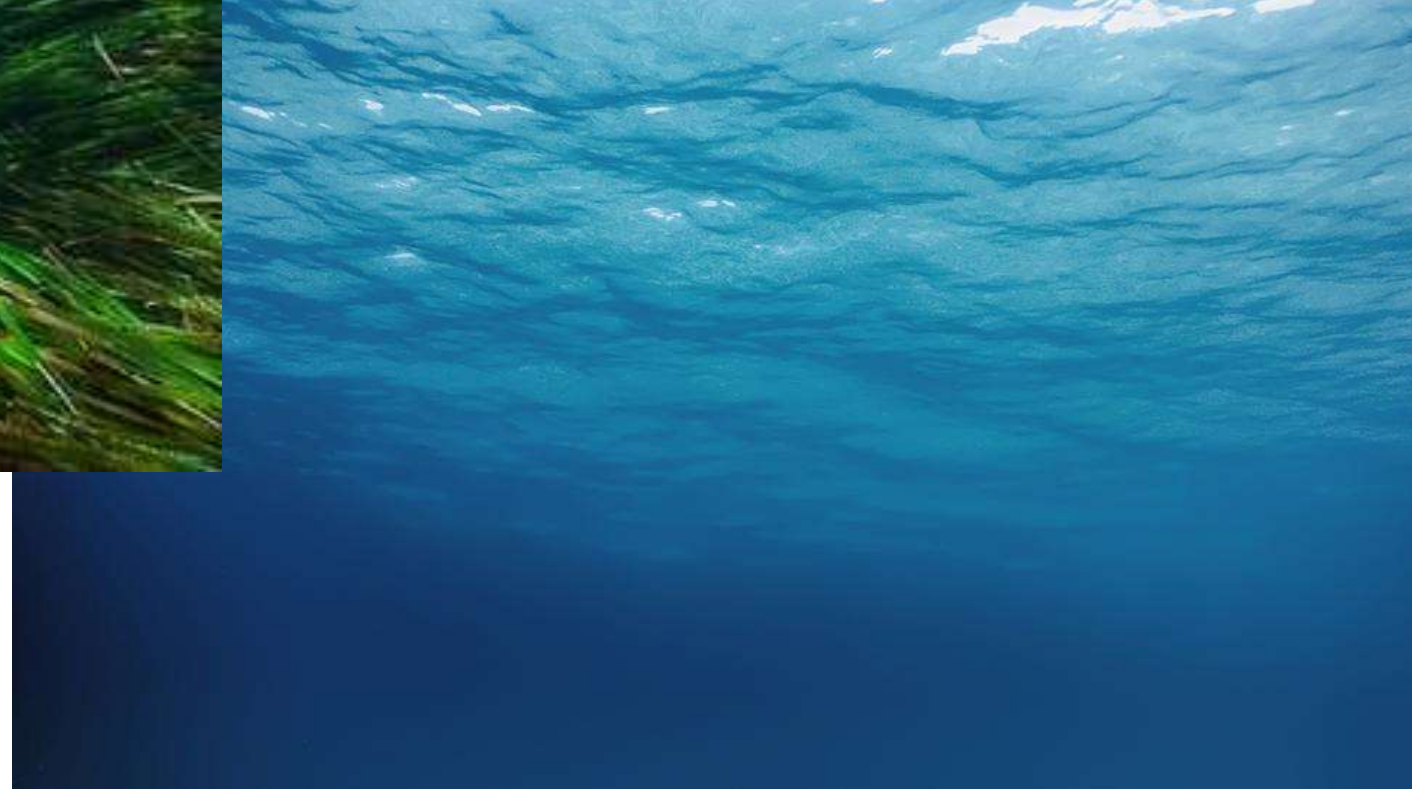

**Corey Eads IDSN 2102 F19**

**Assignment 13**

# *Color Rationale*

- ***Darker Blue***: This color will represent how the mood is throughout the whole environment. A dark blue color will give a feeling to make the client feel as if they are actually under the sea as it is offered on most of the walls and some furniture.
- ***Lighter Blue***: Light blue offers a calm tone and gives a relaxing vibe. Light blue is also offered in the lighting which will have the client feel calm and comfort.
- ***Darker Green***: The green is a warmer color that represents the type of energy flow used throughout the lighting and color of the furniture.

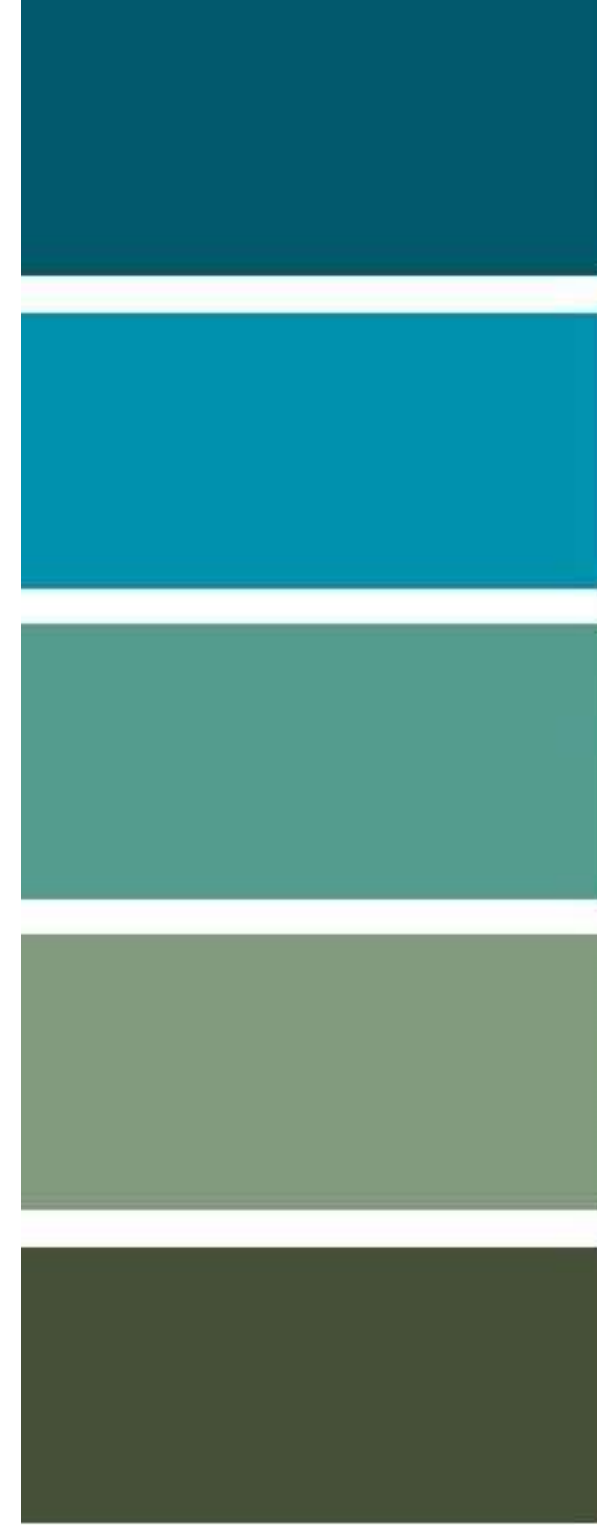

**Corey Eads IDSN 2102 F19**

**Assignment 13**

# *Inspiration Images*



**Corey Eads IDSN 2102 F19**

**Assignment 13**



<https://youtu.be/Z3ztwLK9-ek>

**Corey Eads IDSN 2102 F19**

**Assignment 17**