

Cassidy Grace

Portfolio 1

IDSN2102

Assignment 1 demonstrates the differences between architectural and engineering scales

Engineering scale

1" = 10.0'



1" = 40.0'



1" = 200.0'

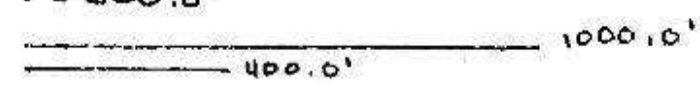

1" = 20.0'

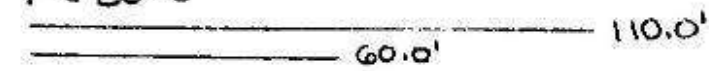

Architectural scale

Full

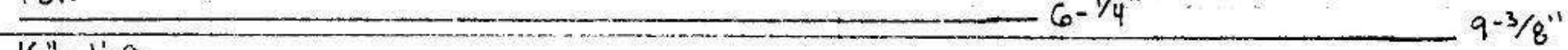

1/4" = 1'-0"

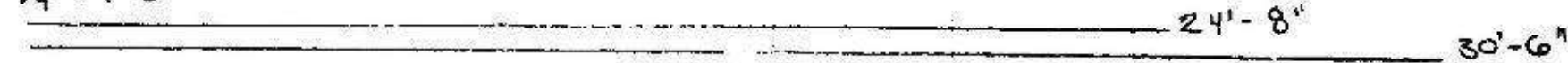

1/8" = 1'-0"



1" = 1'-0"



3/4" = 1'-0"



Assignment 2 shows the four different types of projections on one object. These projection drawings include: orthographic, isometric, oblique drawing, and perspective drawings

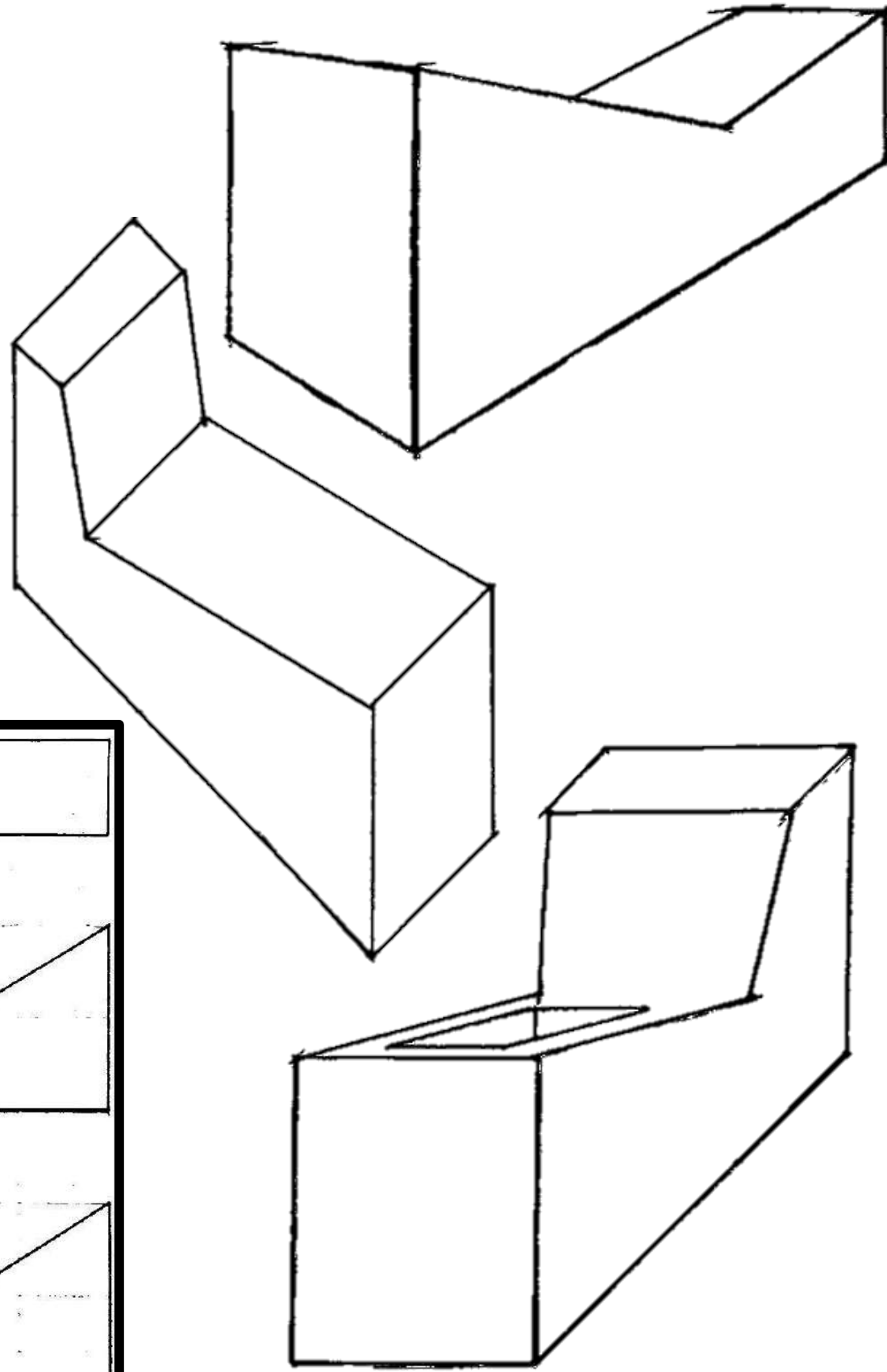
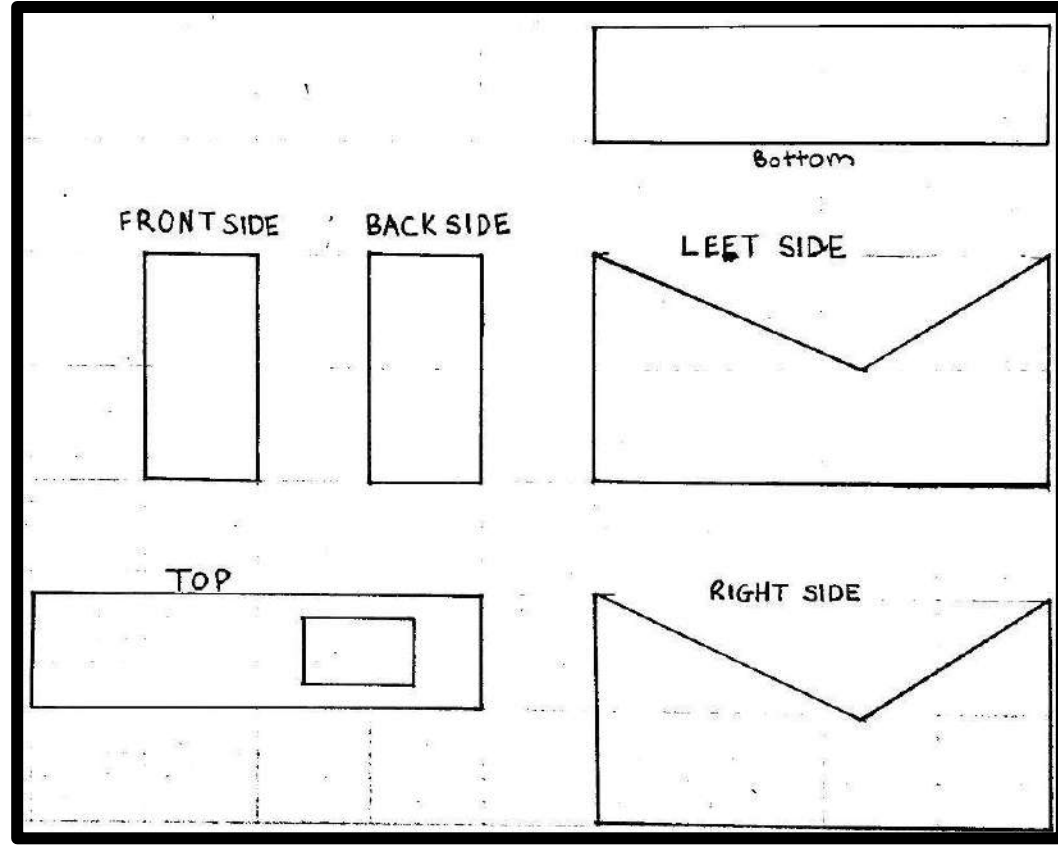

Assignment 3A asks for photographs and sketches of three different spaces. These spaces convey comfortability in: shopping alone in a boutique, having coffee while shopping, and shopping with friends in a boutique.

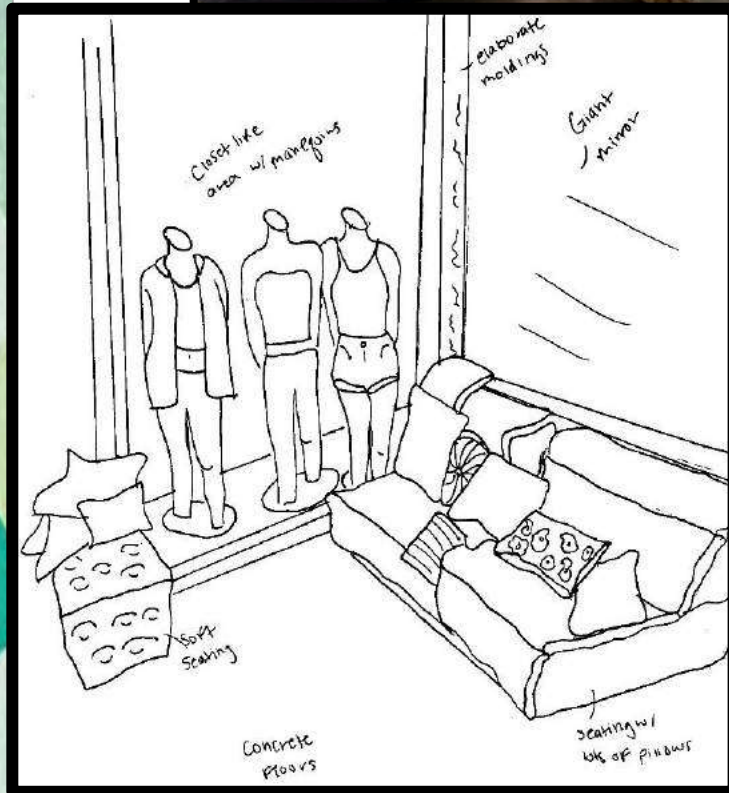

Shopping Alone

Shopping with Friends

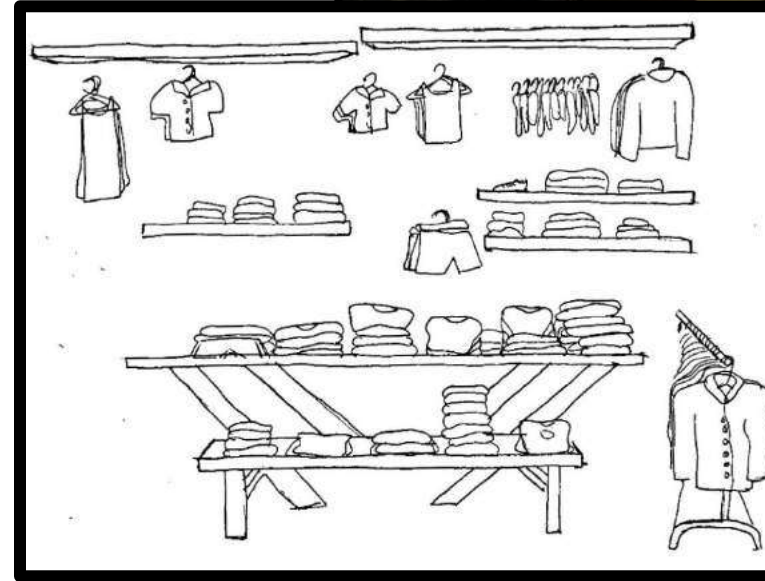

Getting Coffee

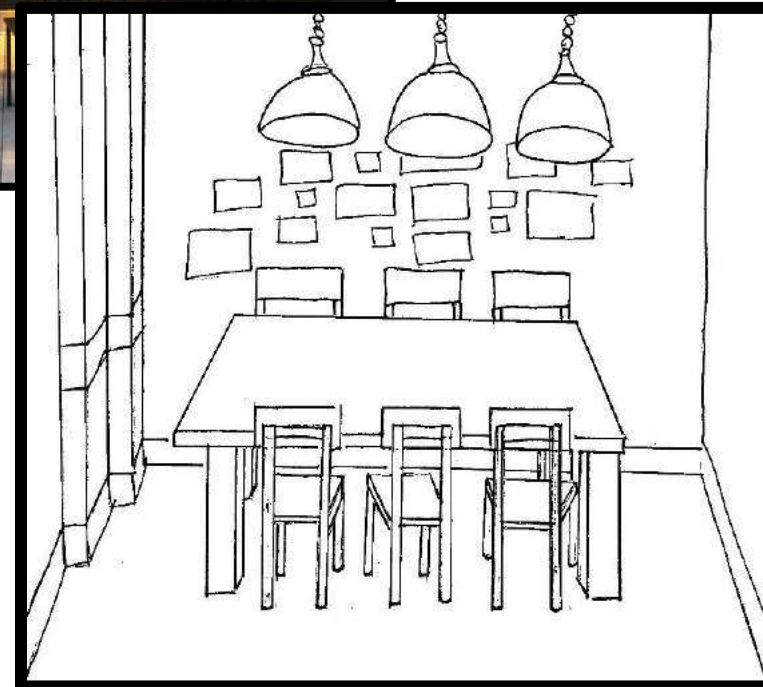

Assignment 3B expands on assignment 3A by taking the original space and transforming it to reflect our ideal space for each activity. Each sketch includes a floor plan and a section drawing.

Shopping alone

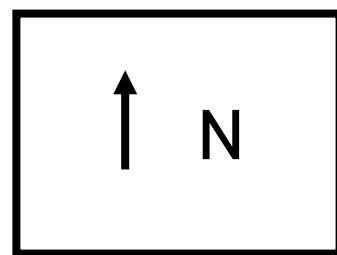
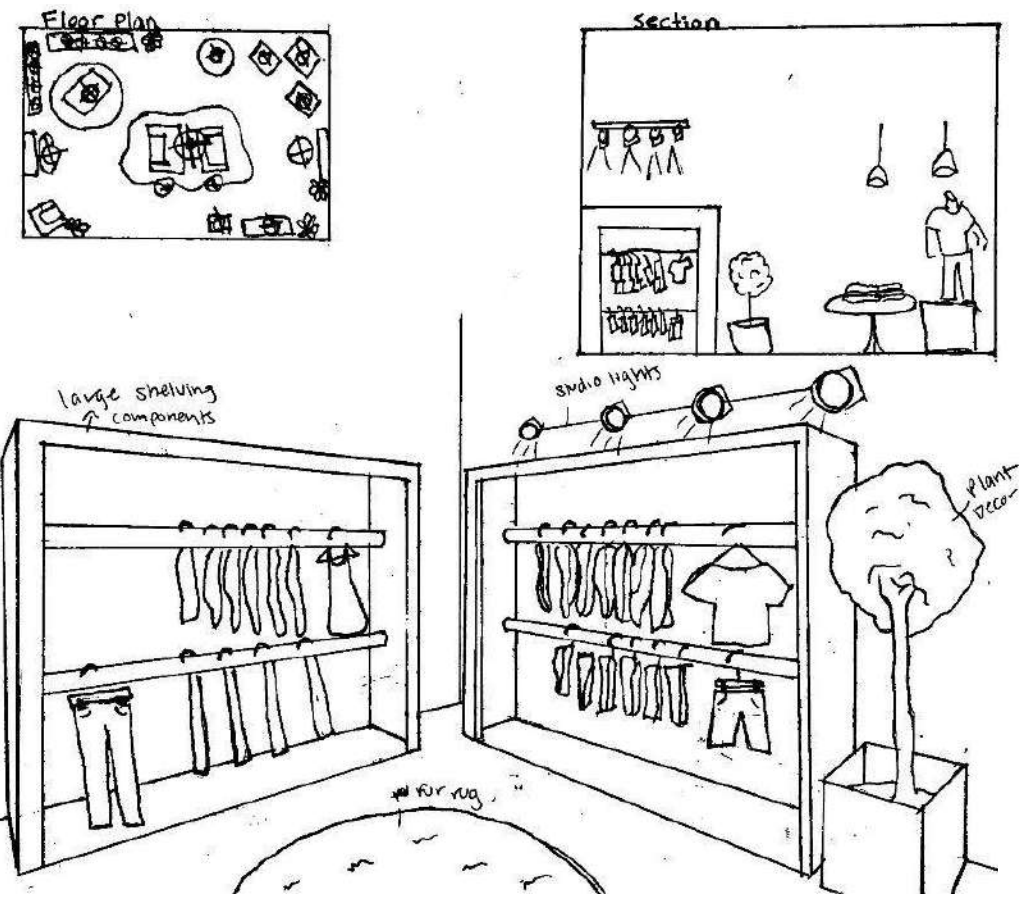

Getting Coffee

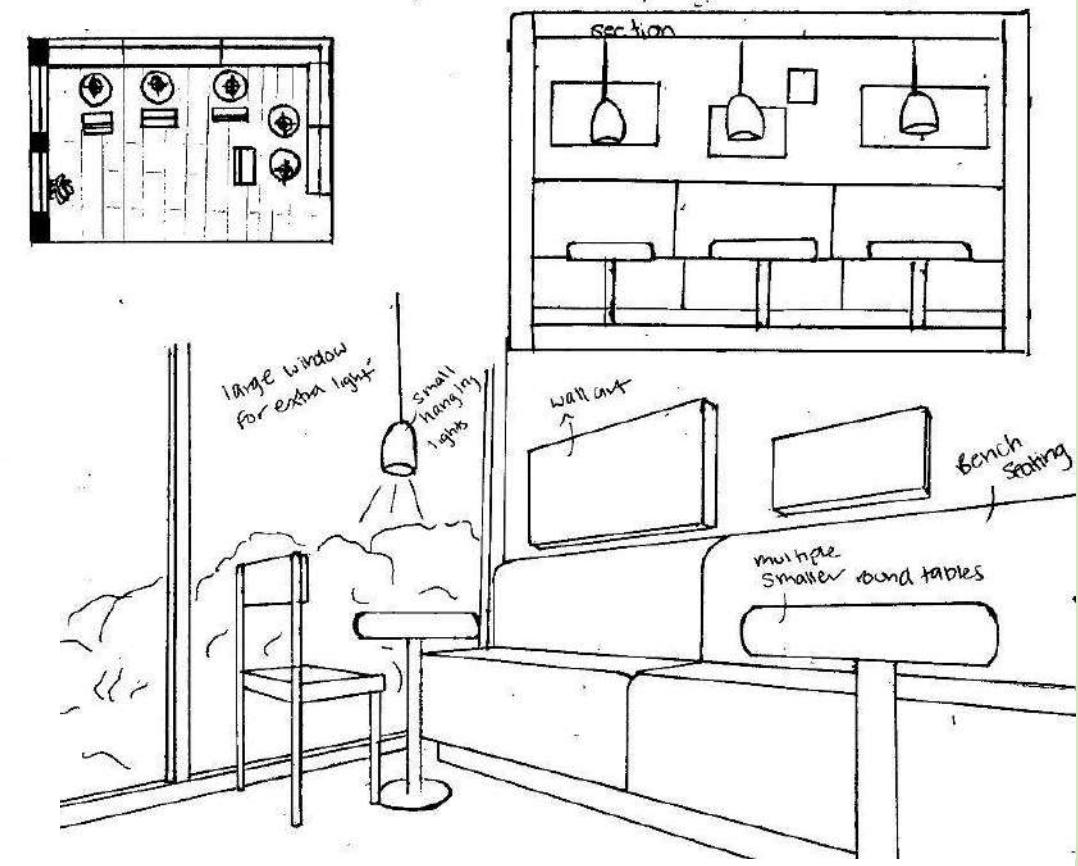

Shopping with friends

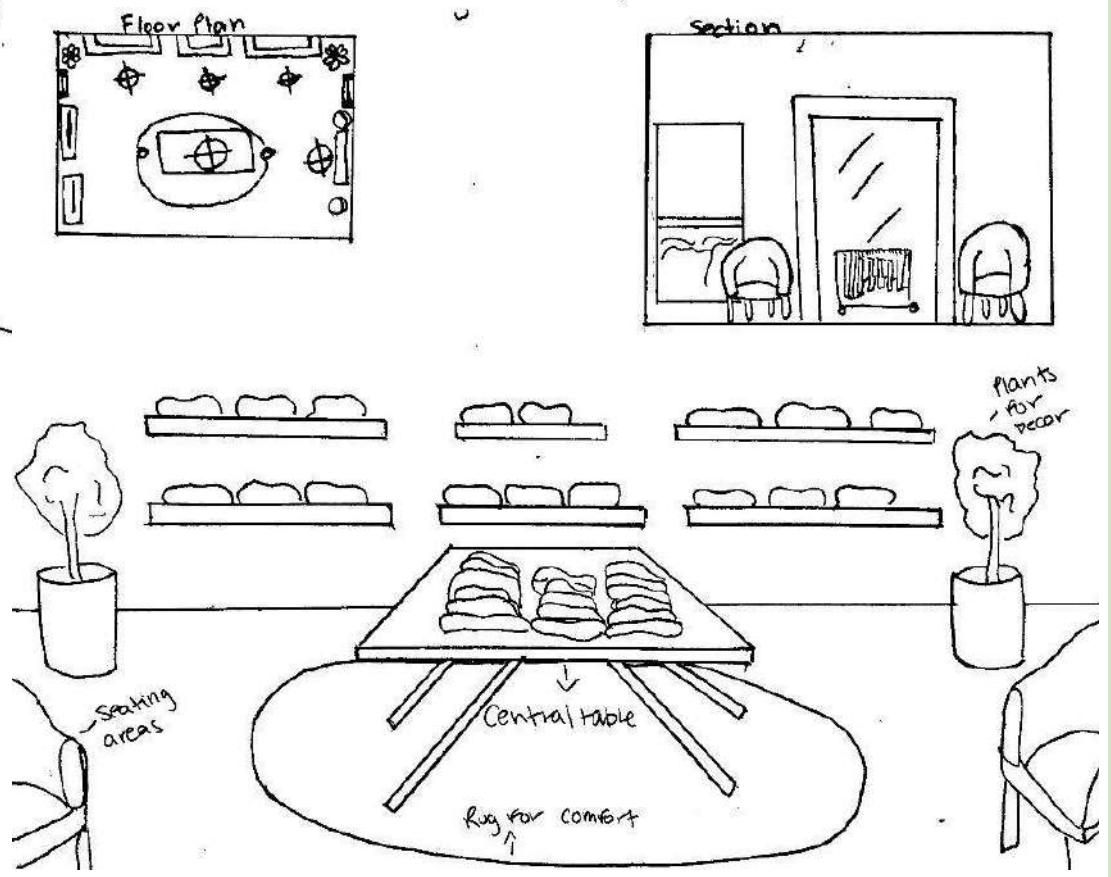

Assignment 3C takes future assignments 4 and 5 and incorporates the model into the sketches in 3B

Getting Coffee

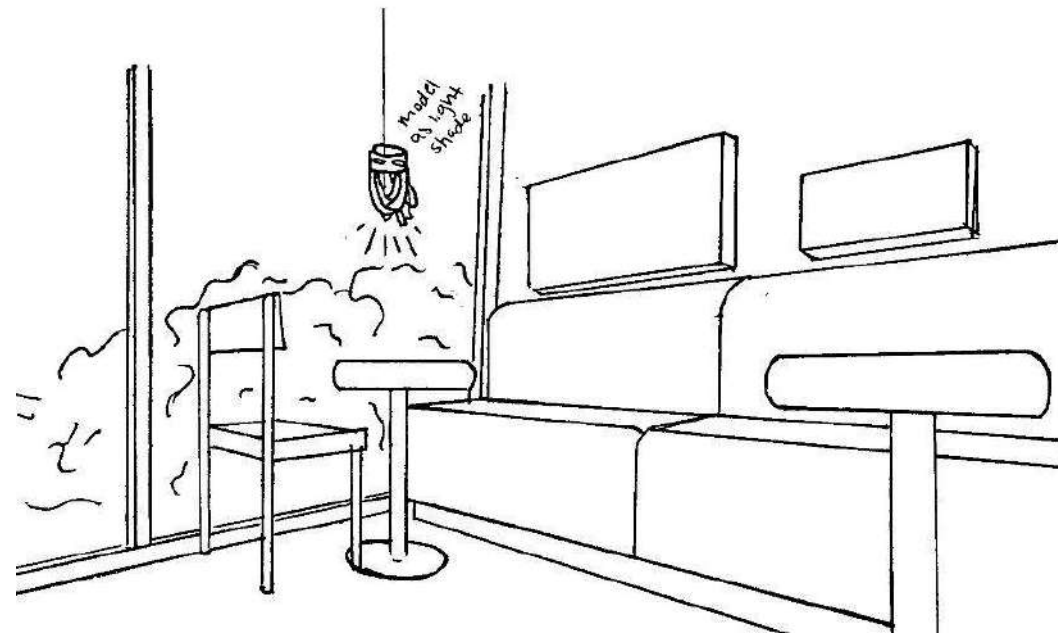

Shopping with Friends

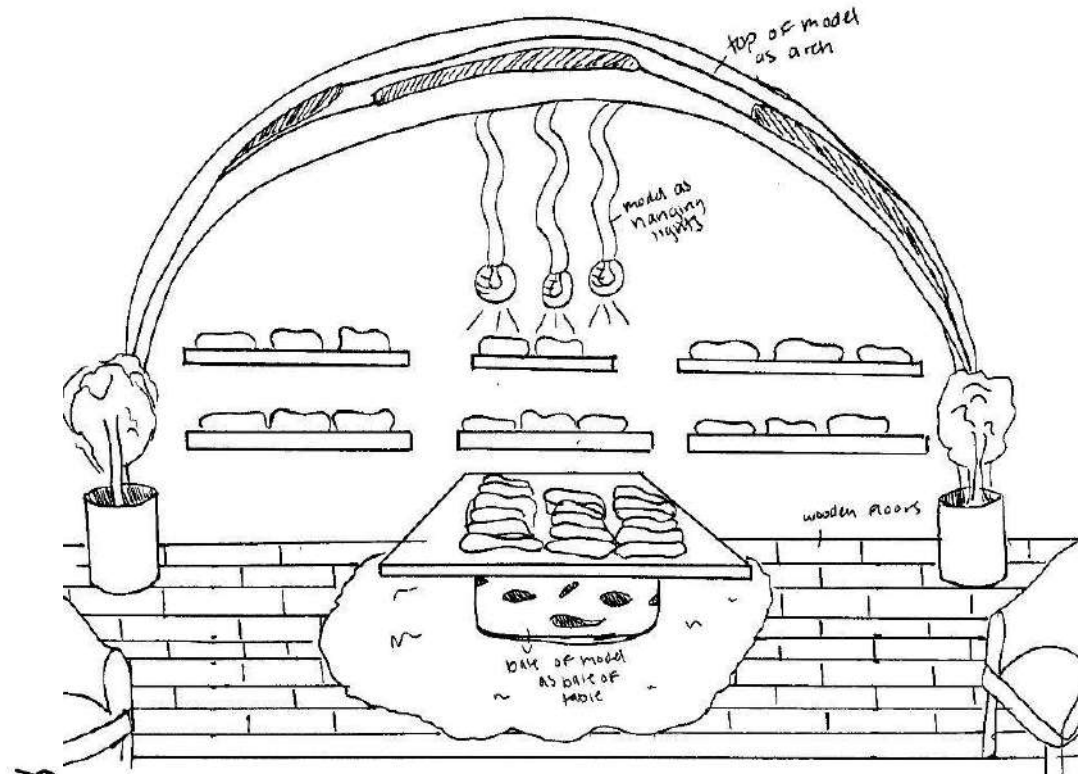

Shopping alone

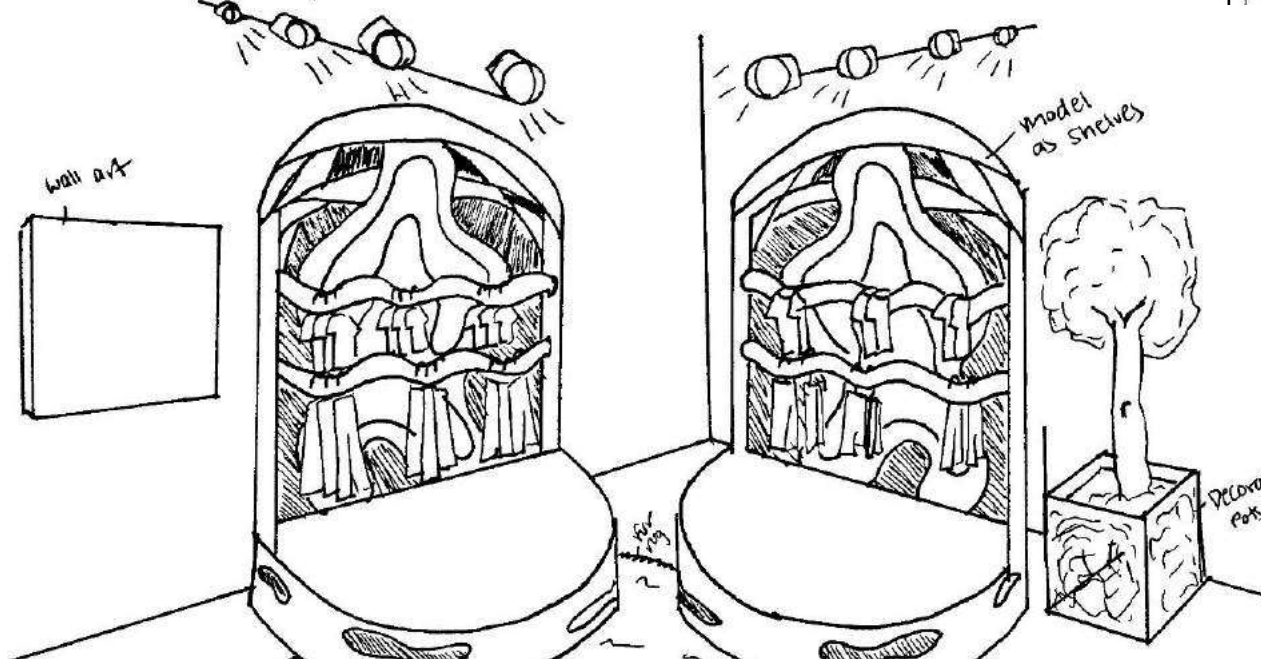

Assignment 4A is composed of three abstract sketches that reflect a song played in class. Assignment 4B takes the best elements of all three sketches and incorporates them into one final sketch.

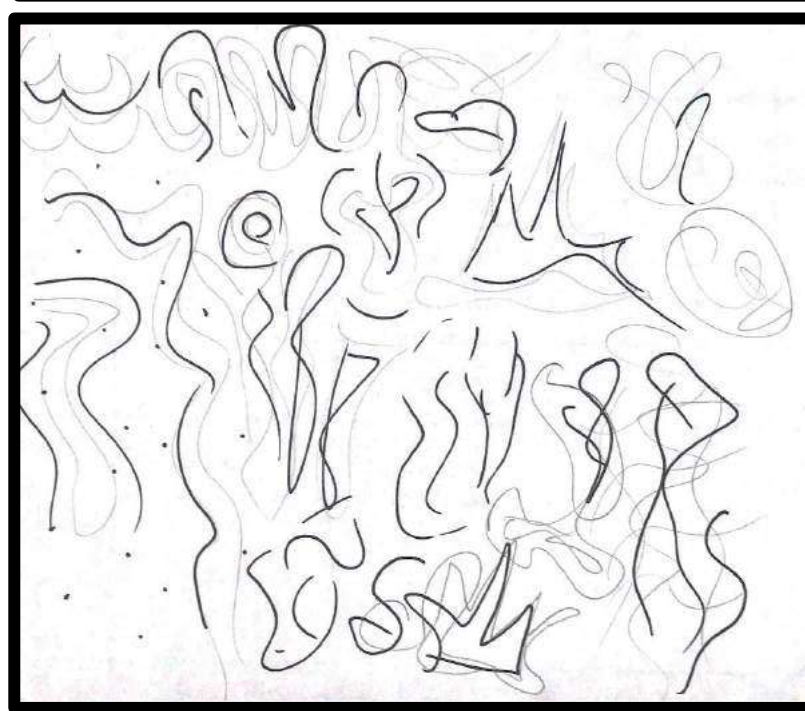
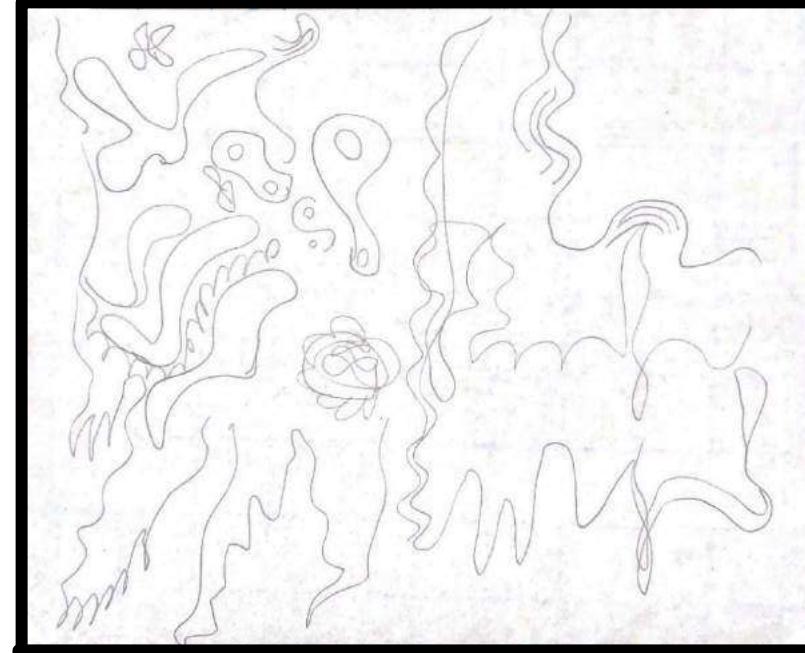
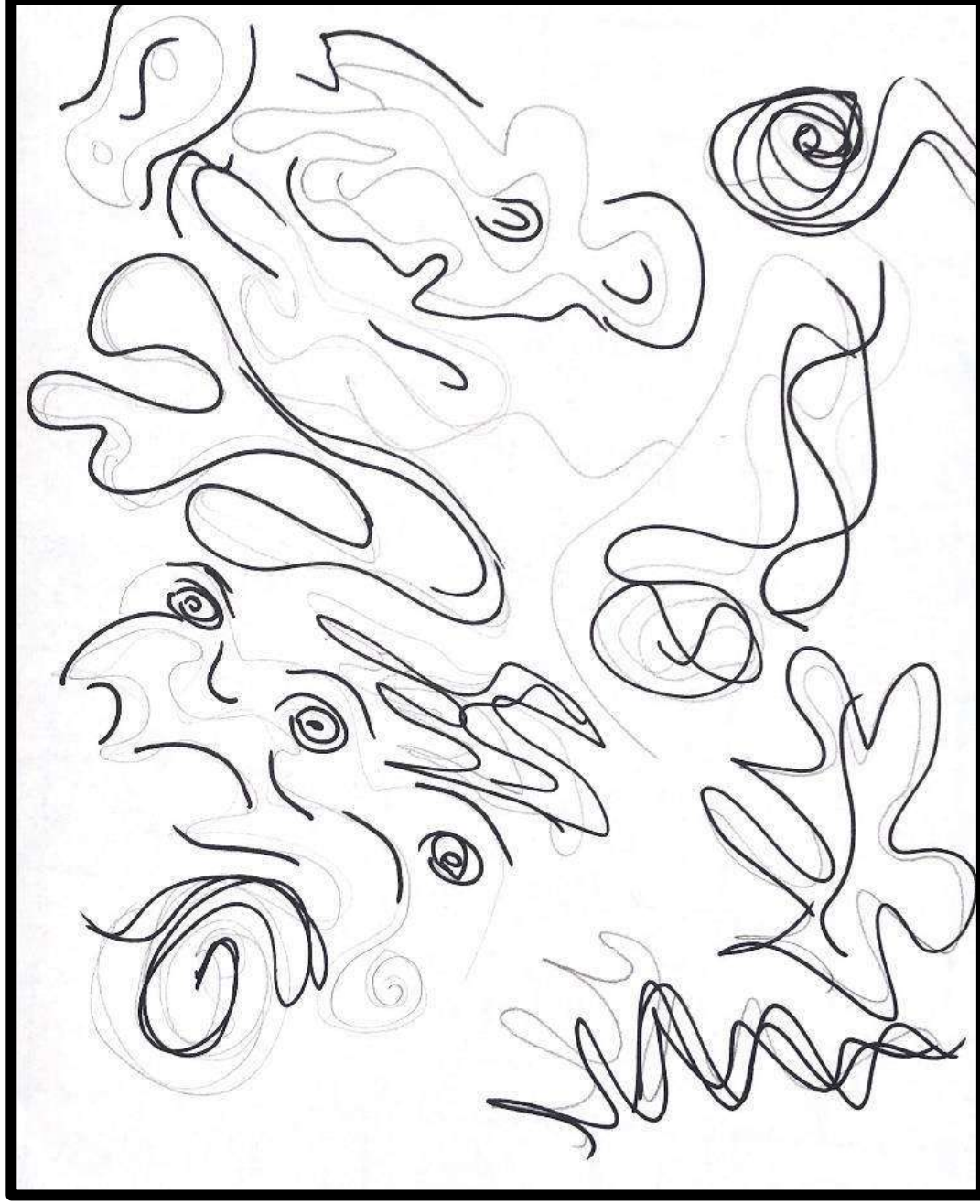

Portfolio 1

Assignment 5

Assignment 5 takes assignment 4B's final sketch and translates it into a 3D model.



Cassidy Grace

IDSN2102 F19

Assignment 6 is two space plans showing the rough location of circulation paths and selling areas.

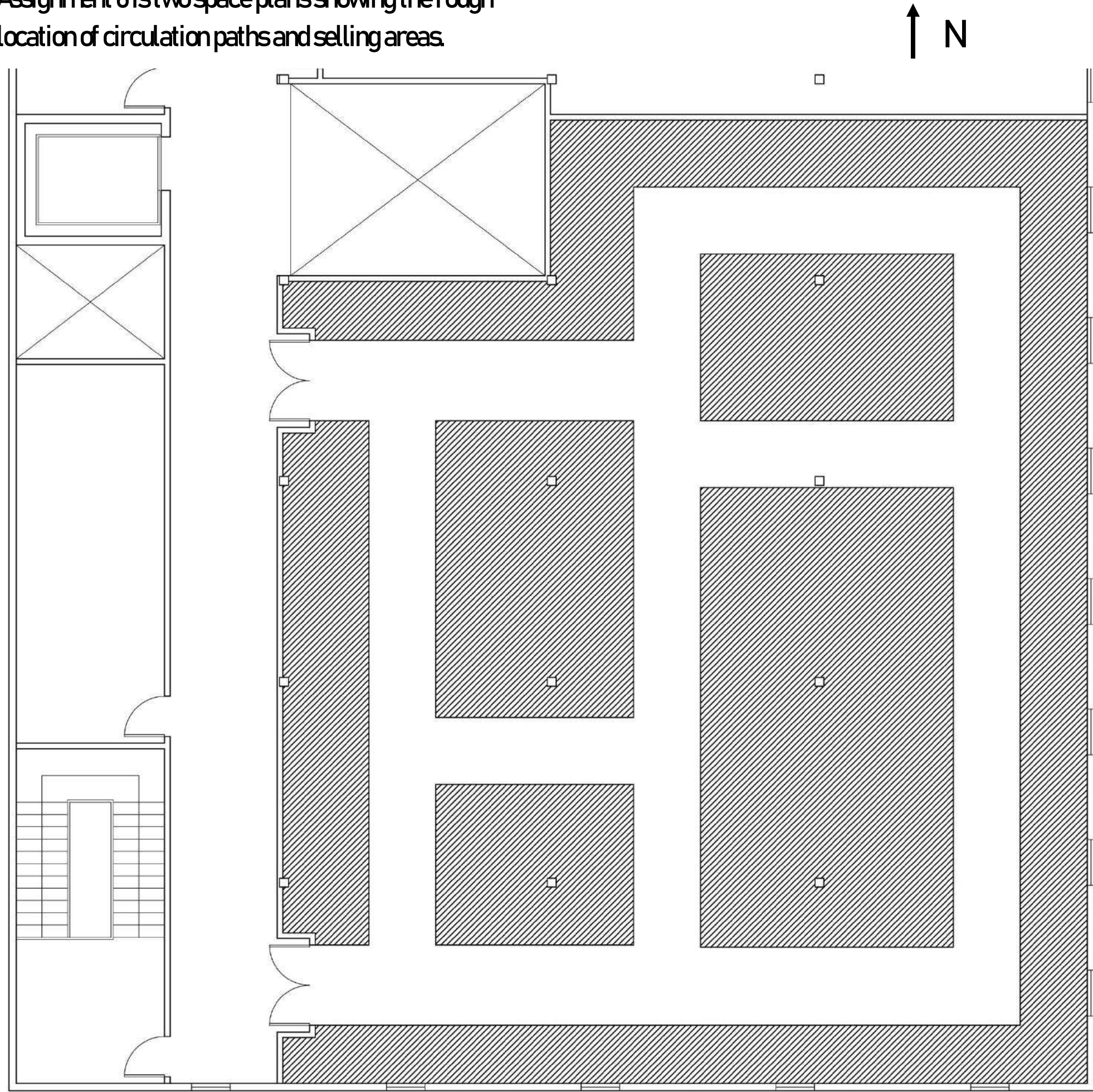

Portfolio 1

Assignment 6

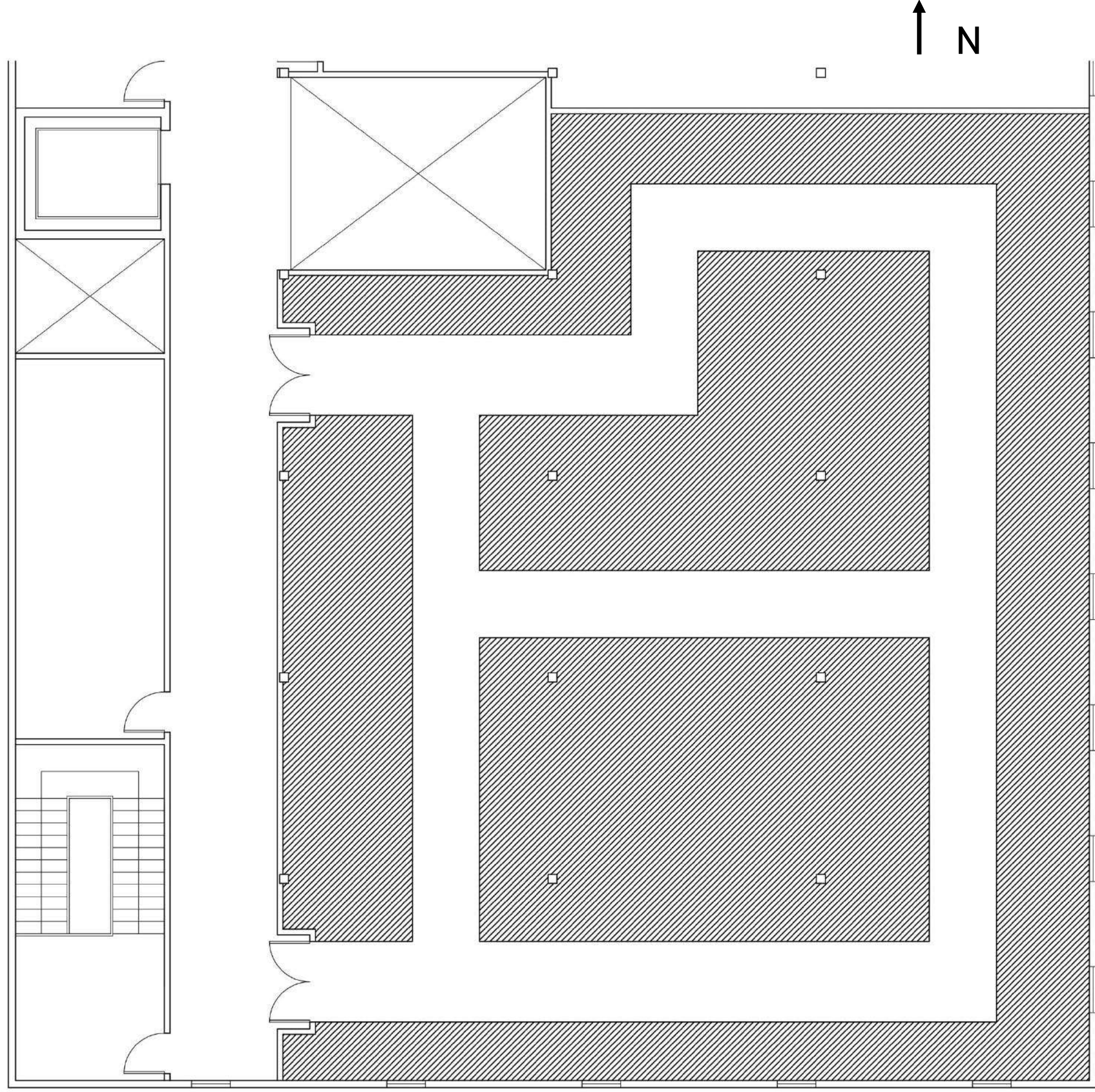

Cassidy Grace

IDS N2102 F19