



Cassidy Grace

IDSN 2102 F19

Cassidy Grace

IDSN 2102 F19

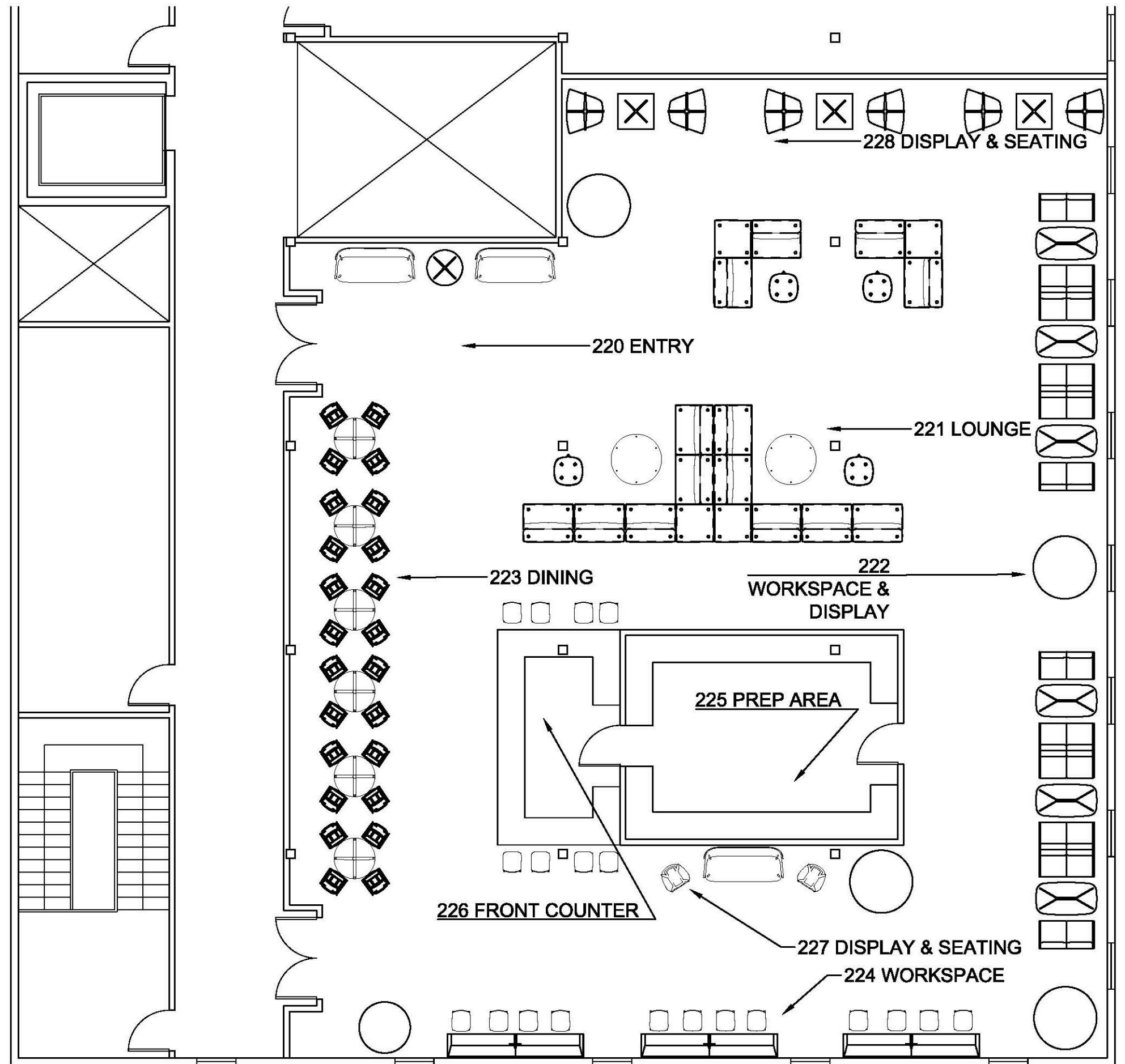

Cassidy Grace

IDSN 2102 F19

- The intent of this design is to mirror the characteristics of the Tar River
- Contrasting with the buildings industrial & geometric exterior, the interior will be free flowing and organic.
- Additional natural light will be employed
- Curvilinear furniture
- Mixture of textures and materials will be utilized along with the heavy usage of glass
- Design will promote a sense of community by providing
- opportunities to interact with other students and view their work.
- Furniture arranged in a way that leads the viewer to other areas of the warehouse
- The space is designed as an extension to the city's past in tobacco production and transportation



- Cool color scheme which embodies the Tar River
- White and browns will be the main colors throughout to give a clean and simple atmosphere
- Different shades of blue and green will accent and give a pop of color to the area while also creating a modern twist
- The blues, greens, and wood will symbolize the water and greenery around and within the Tar River
- The color scheme will create a space that encourages knowledge and growth

Cassidy Grace

IDSN 2102 F19

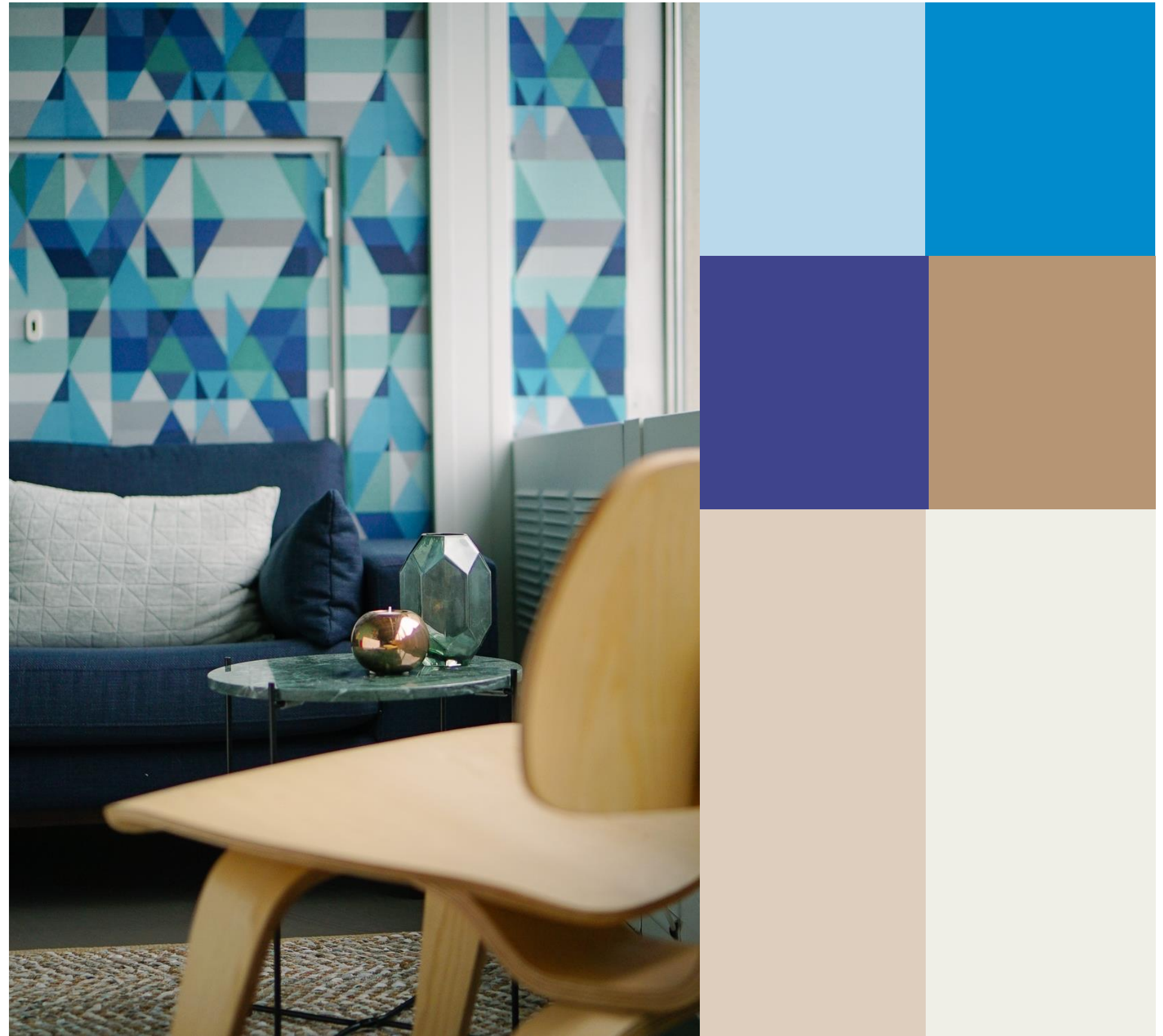

Cassidy Grace
IDSN 2102 F19

