



PORTFOLIO ONE

Julianne Hughes



SEPTEMBER 24, 2018

IDSN 2102

Professor Gustina

ASSIGNMENT 1- Quick Sketches & Competencies

This assignment was designed to help comprehend the different uses of both an architecture scale and an engineering scale.

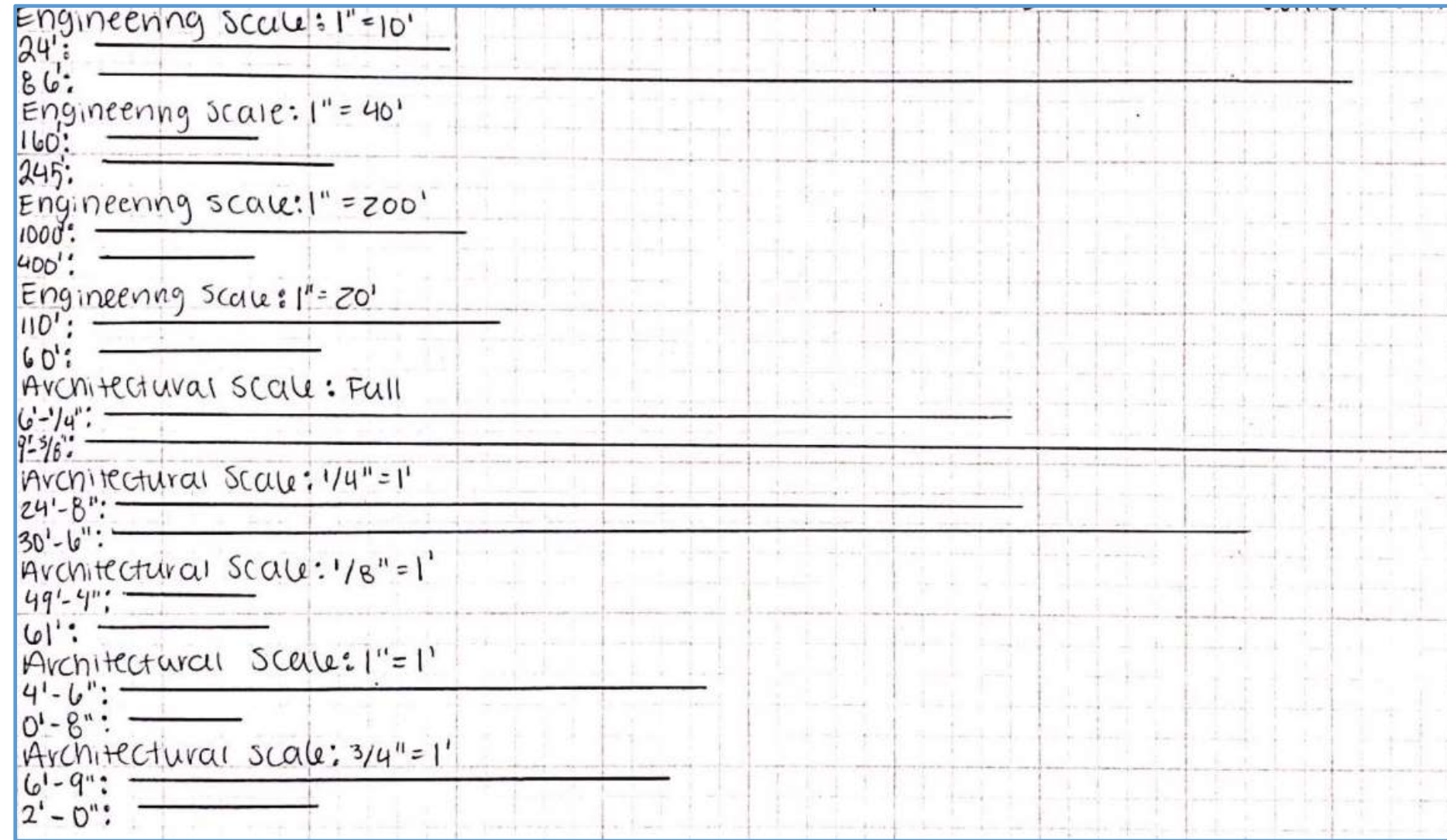

ASSIGNMENT 2- Quick Sketches & Competencies

The photographs to the right depict the drawing techniques of isometric, orthographic, perspective, & oblique.

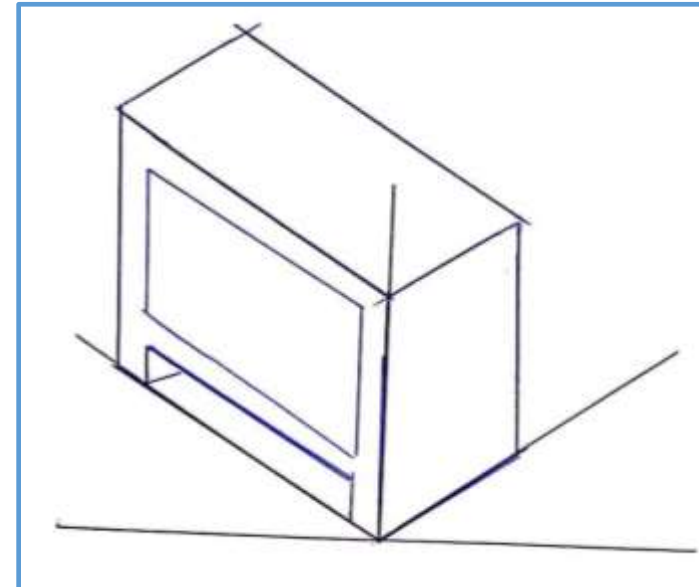
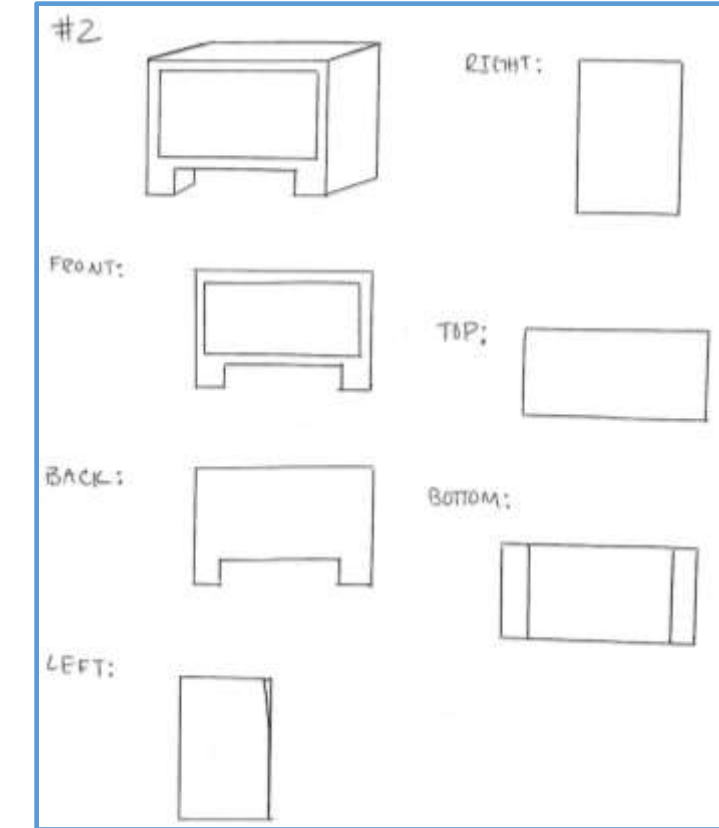
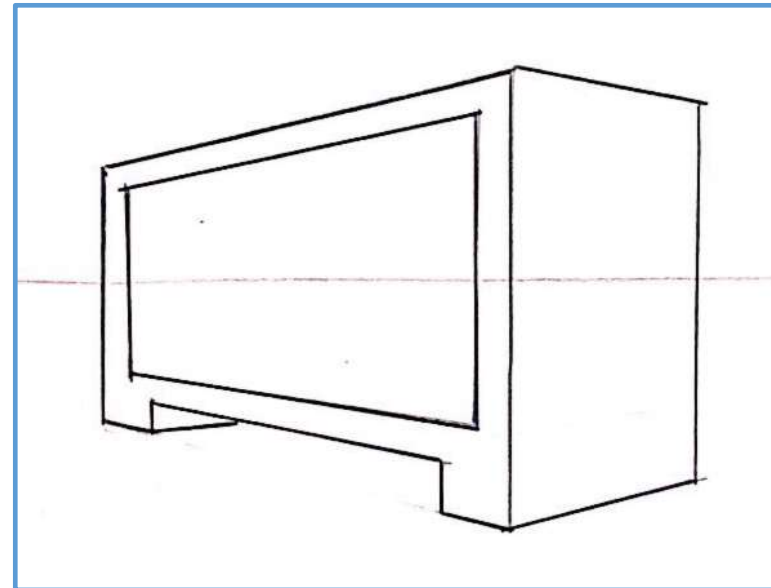
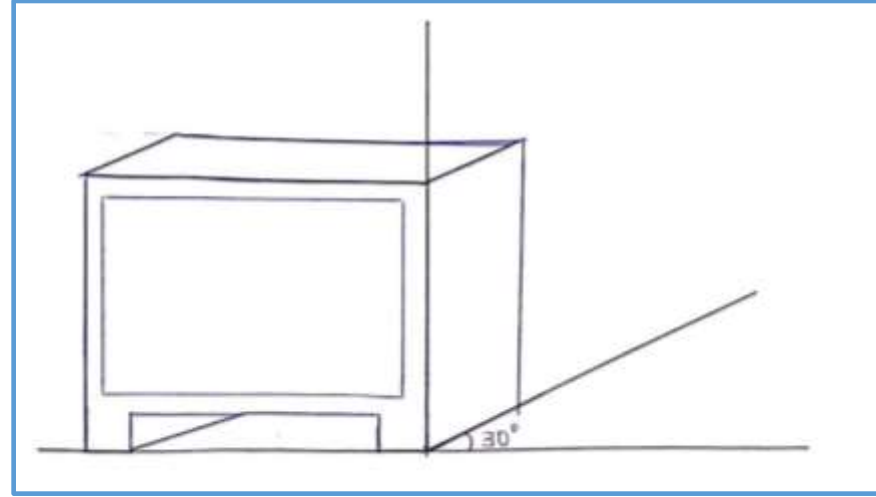

ASSIGNMENT 3- Photographing Interiors

The first part of this assignment involved taking photographs of shop interiors that we feel comfortable shopping in alone, feel comfortable shopping in with friends, & feel comfortable shopping alone with food or drink.



ASSIGNMENT 3- Activity Space Studies

Original interior perspective, remodeled plan, section, & perspective, and remodeled perspective with added feature of a place comforting to shop at alone.

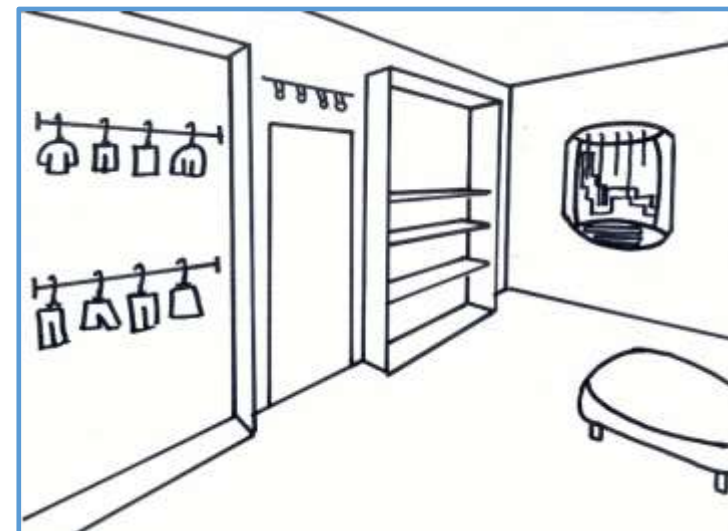
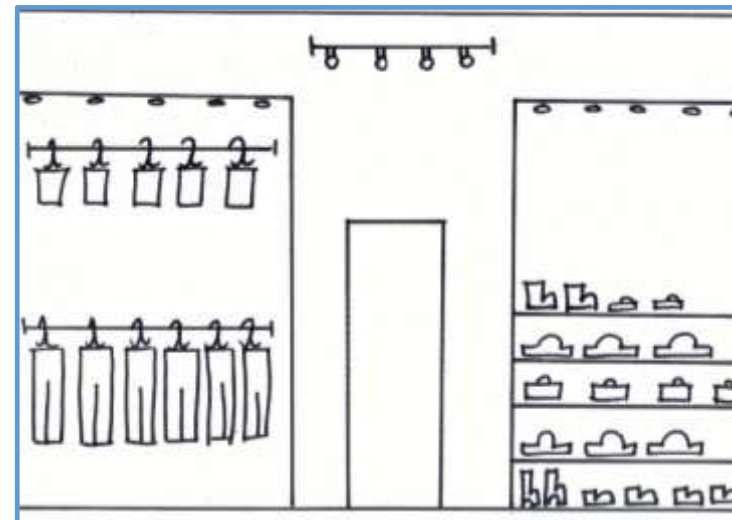
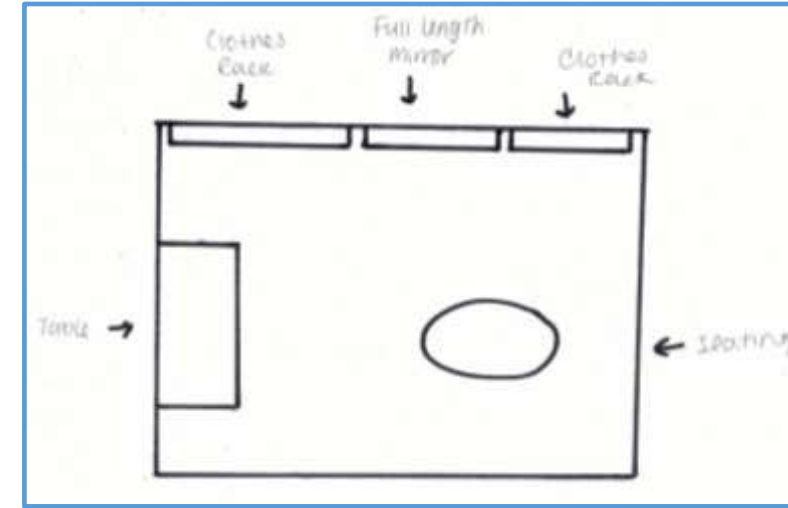
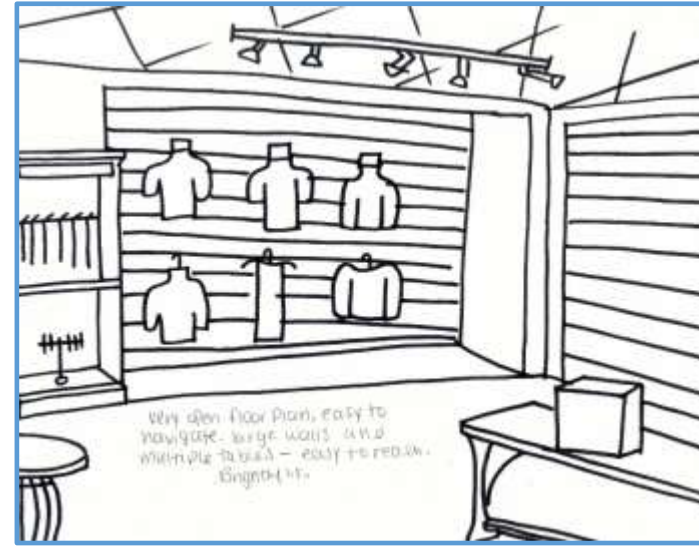

ASSIGNMENT 3- Activity Space Studies

Original interior perspective, remodeled plan, section, & perspective, and remodeled perspective with added feature of a place comforting to shop at with food or drink.

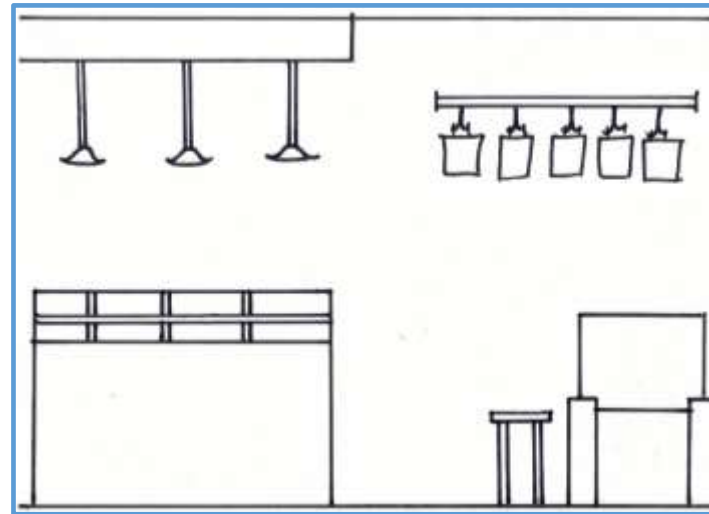
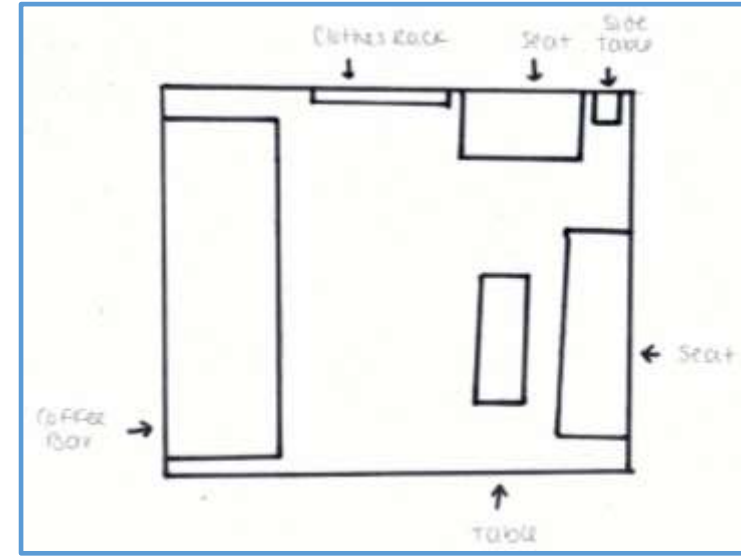
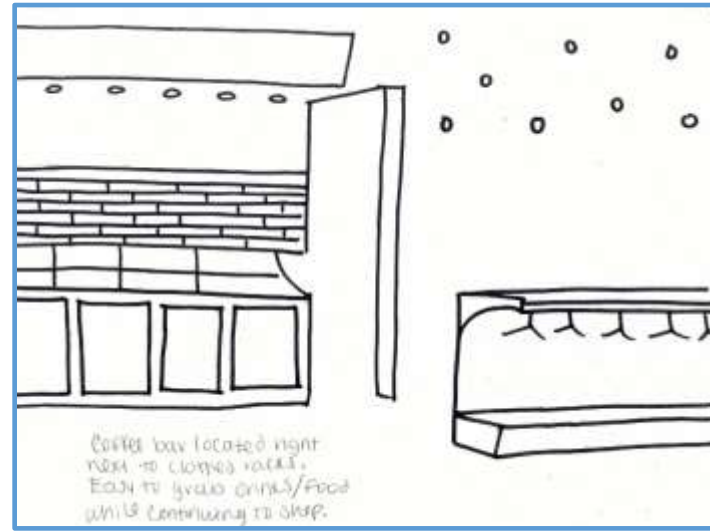

ASSIGNMENT 3- Activity Space Studies

Original interior perspective, remodeled plan, section, & perspective, and remodeled perspective with added feature of a place comforting to shop at with friends.

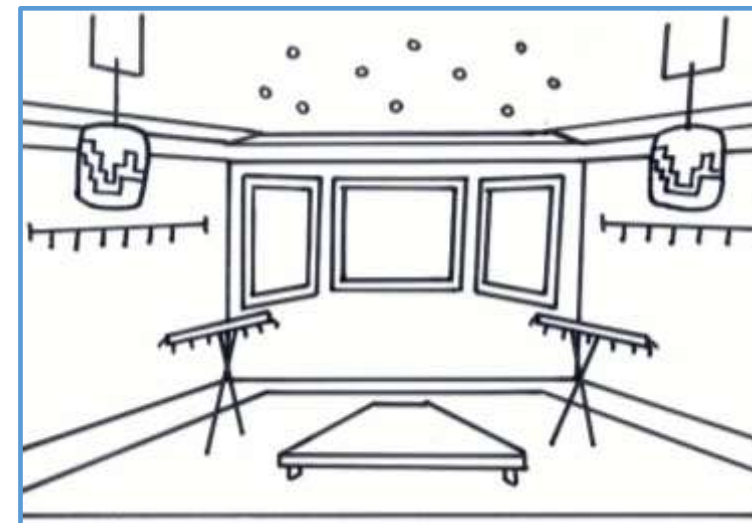
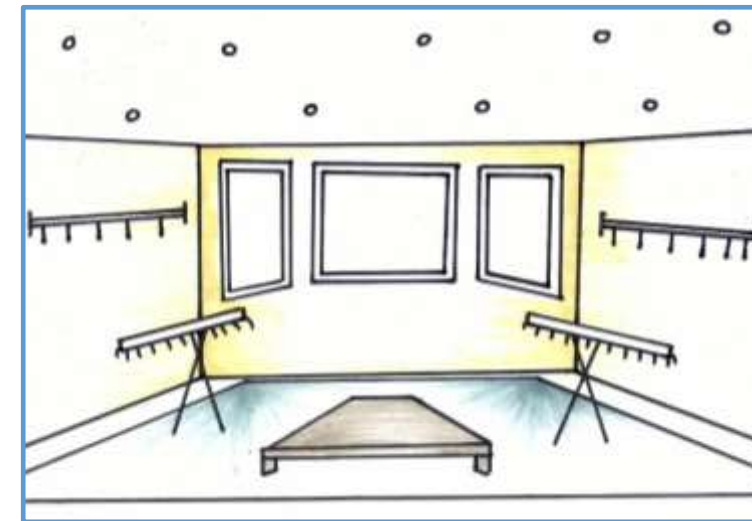
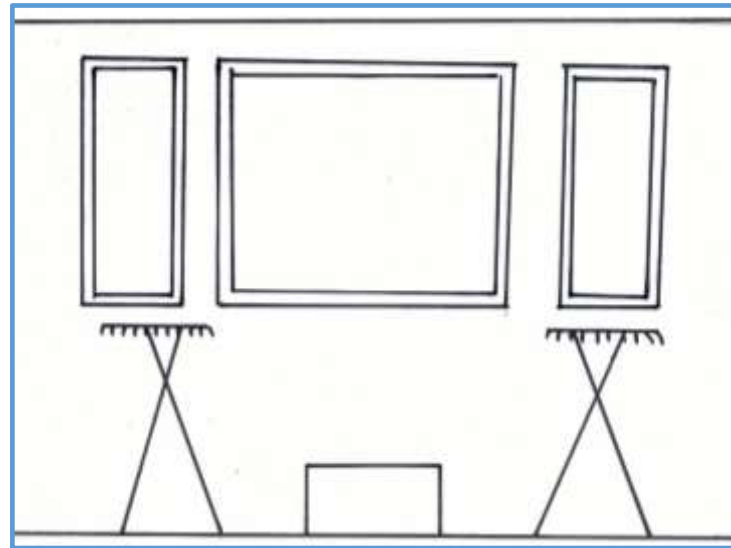
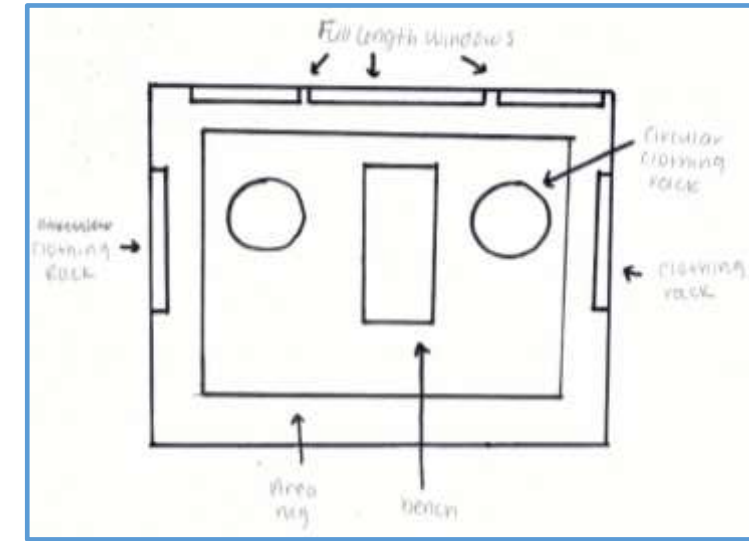
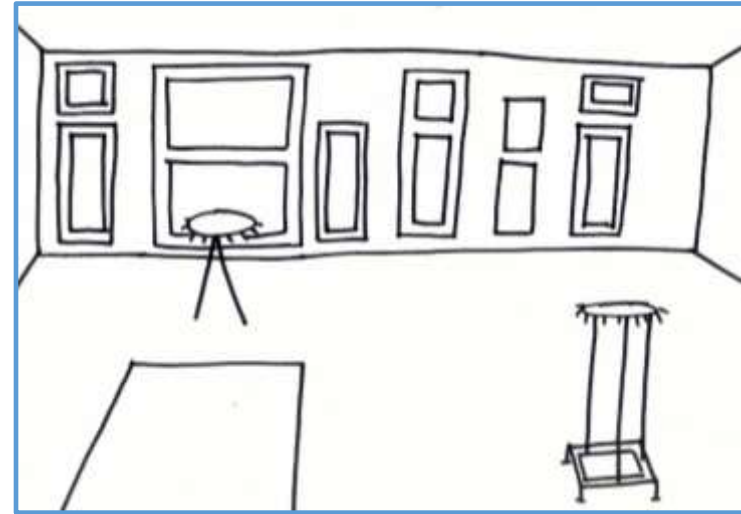

ASSIGNMENT 4- Drawing to Music
Using variations of lines, a song was played and analyzed through a drawing.

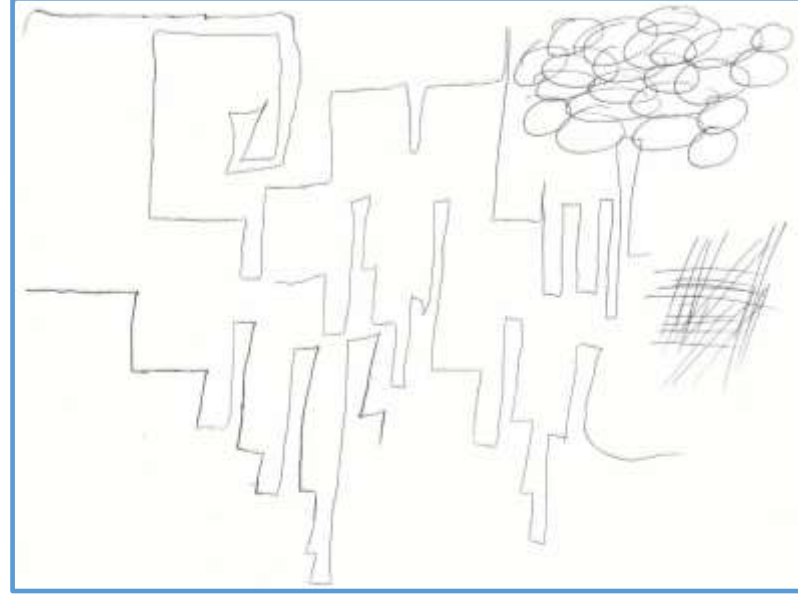

ASSIGNMENT 5- Modeling to Music

After producing the abstract line drawings, a 3-D model was comprised out of all of the drawings.

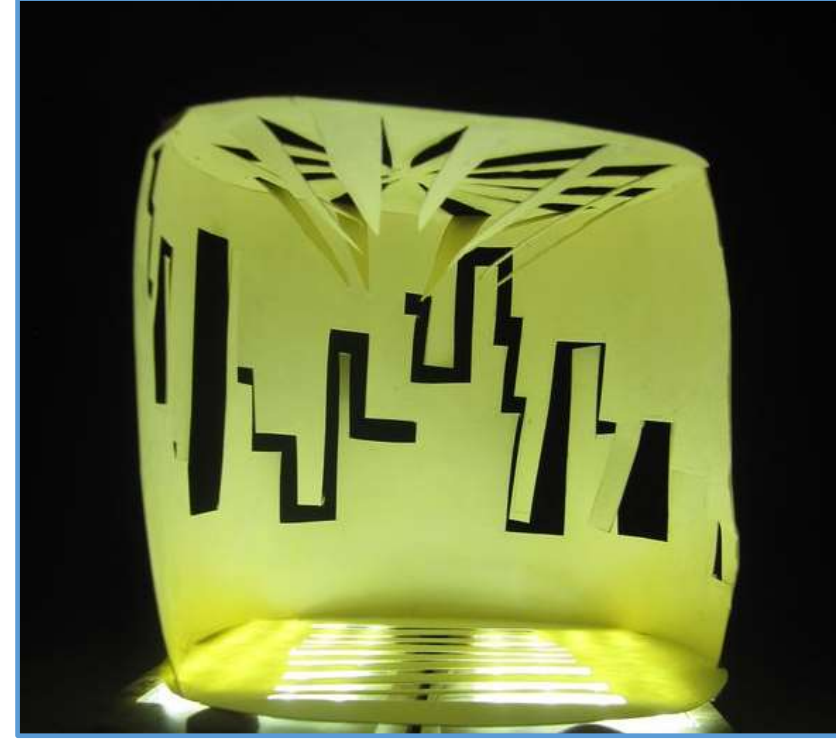

ASSIGNMENT 6- AutoCAD Circulation Plans

Circulation plans were created in AutoCAD to show the wayfinding routes customers will take.

