



# Portfolio 3

Anna Overton



**Assignment 12:  
AutoCAD - Final  
Furniture Plan**

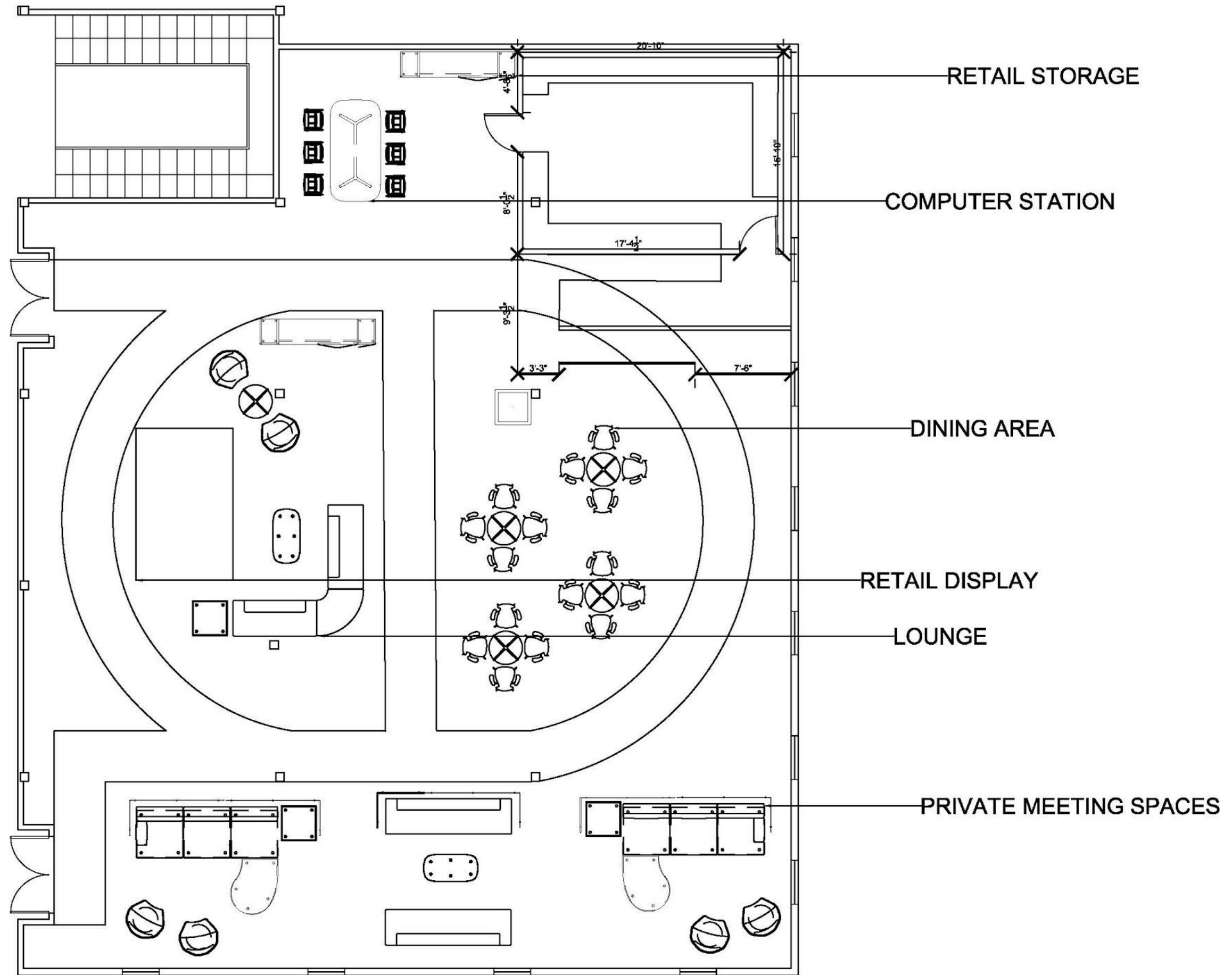



## Assignment 13: Concept

This space is meant to be utilized for students and the public alike.

- ❑ It can be used to network and exchange ideas in a comfortable, inviting and inspiring setting.
- ❑ The importance of this retail space is to encourage students to grow in their career prospects and also succeed in school.
- ❑ The style of the space is inspired by mid century modern design that became popular post World War II when the economy was growing. In the 1950's mid century modern furniture became affordable for everyone, extending beautiful design to a lower class. This same general idea of how design is meant for anyone emphasizes the goal to allow students of all backgrounds to use the space to their career and academic goals.





Assignment 13:  
Inspiration Images





## Assignment 13: Color Rationale

### Color Rationale

- Shades of greens, blues and tans will be incorporated in the space with the intent to surround the student with soothing, relaxing colors.
- It will help them feel more comfortable in the space and make it easier for them to network and connect with others.
- The wood will be a light color.

