

**Portfolio 3**  
**Carrie Thompson**  
**IDSN 2102 F19**

**Assignment 12:**

AutoCAD- Final  
Furniture Plan

**Carrie Thompson**

**IDSN 2102 F19**

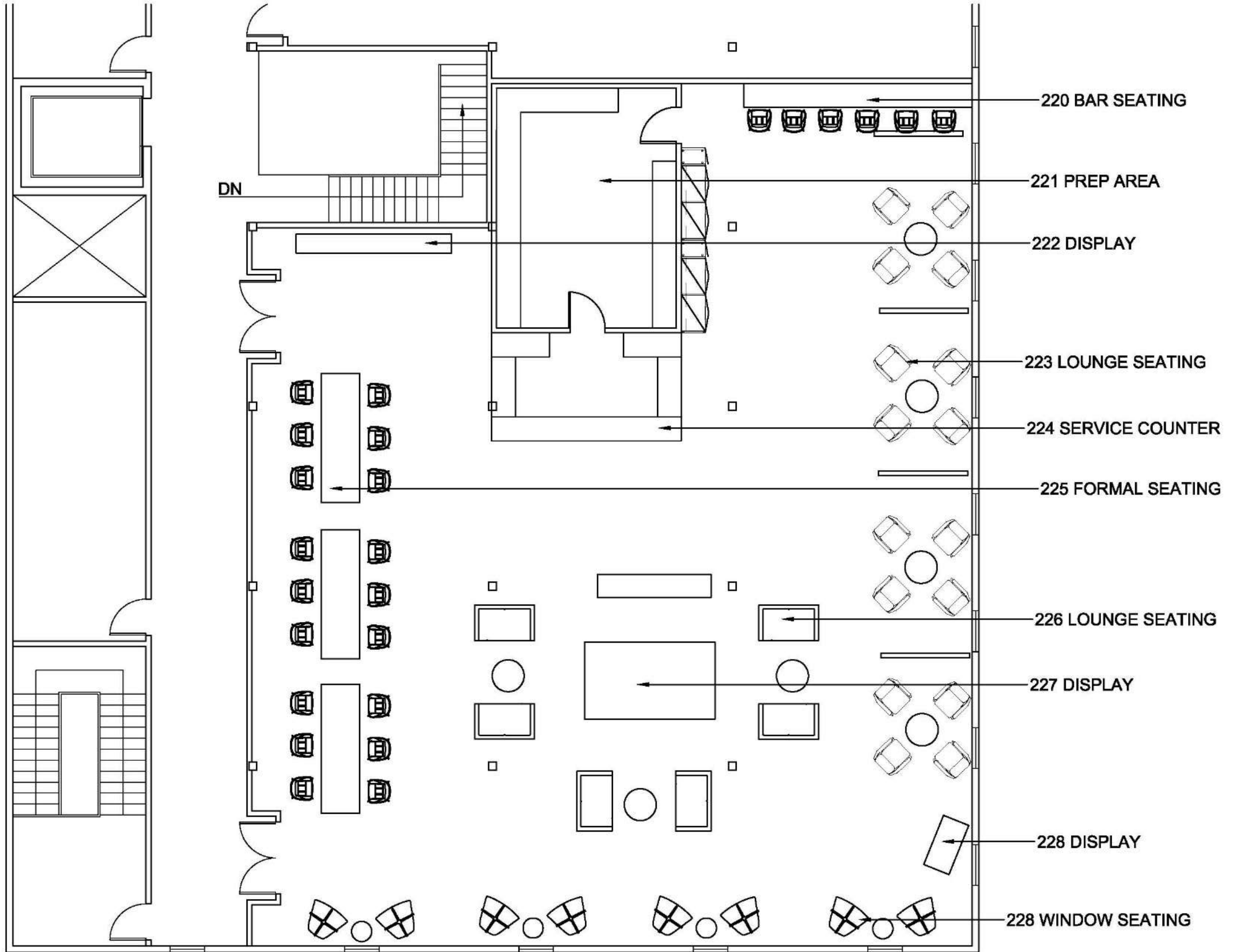

## Assignment 13:

Concept

# Leaves in Transition

The concept of the Hughes Tobacco Warehouse is a space for East Carolina students and business people of the surrounding community to have a place to come together and bring innovation alive. Leaves in Transition refers to the deep history of the building and once hustling and bustling tobacco industry that kept Greenville alive. The design mixes modern and rustic elements to give a fresh feel to the loved and worn in building. The space will incorporate a coffee counter, a platform in the middle of the room for guest speakers, several display options around the room, and plenty of seating for people visiting the building.

Carrie Thompson

IDSN 2102 F19



## Assignment 13:

### Color Rationale

Carrie Thompson

IDSN 2102 F19

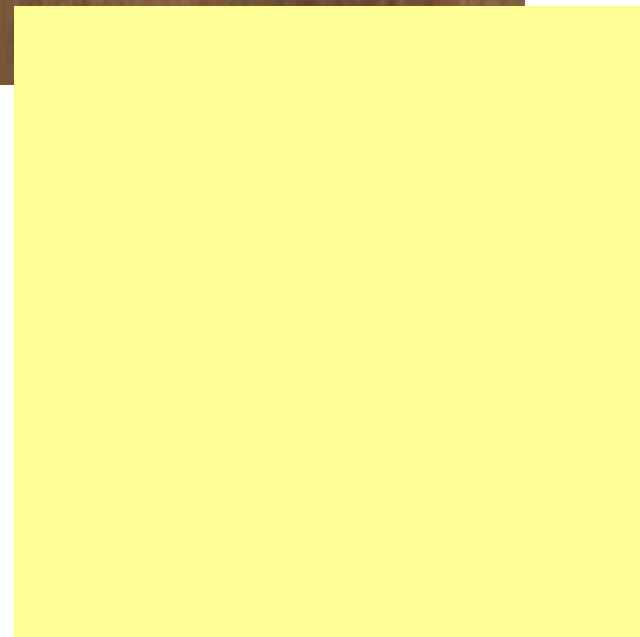

- The final color scheme consists of primarily warm tones with an addition of the cool toned green.
- Neutral colors like white and tan are used throughout to give the space a sense of balance.
- Wood is incorporated into many features of the room to play off of the history and old time feel of the warehouse.
- The colors chosen make the space feel cozy and inviting, but bright and open at the same time.
- Each color is used throughout the space in different textures and scale to create depth and interest.

**Assignment 13:**

Inspiration  
Images



Carrie Thompson

IDSN 2102 F19



## Assignment 17:

SketchUp Model  
Walkthrough

Carrie Thompson

IDSN 2102 F19



<https://www.youtube.com/watch?v=CgKKogiKawA>