

2015

PORTFOLIO ONE

IDSN 3600



Molina, Rosendo Alberto

East Carolina University

9/24/2015

CONCEPT:

The world today has become more aware of the global warming epidemic. Which bring the topic of using recycled materials to a new place important and beneficial. Making a space useful is what the main idea when it comes to designing a space. Establishing areas where people can work together and still have that comfort of privacy is what people want. Creating a space with recycled materials will give the space a very unique look in which clients would love to spend their long work days. The idea behind this proposal is what many firms are using since they are going with the “Green” design. The workplace is becoming an environment that is more appealing to workers and exchange they produce better outcomes.



SUMMARY

Summary										
Personnel Totals Per Department	Personnel Totals		Personnel	Computer	Printer	Fax	Support	Total	Circulation	Carpetable
	Current	Future	Sq. Feet				Sq. Feet	Sq. Feet		Sq. Feet
Executive	2	5	500	5	1	-	480	980	154	1,509
Administration	2	1	100	4	1	-	-	100	154	154
Account Admin	5	6	480	24	3	3	174	654	154	1,007
Creative Services	4	84	2,880	7	1	-	1,000	3,880	154	5,975
Support	-	-	-	-	-	-	1,030	1,030	154	1,586
Totals:	13	96	3,960	40	6	3	2,684			10,232

EXECUTIVE

Position	Personnel Totals		Unit Square Ft.		Extended Sq. Feet	Equipment			Notes
	Current	Future	Office	Workstation		PC	Printer	Fax	
					0				
					0				
					0				
					0				
Director	1	0	120		0	0			Locate near Reception
					0				
					0				
Administrative Assistant	1	5		100	500	5	1		Locate directly outside Mgr office
					0				
					0				
					0				
					0				
Personnel Totals:	2	5			500	5	1	0	

Space	Support/Equipment		Unit Square Feet	Extended Sq. Feet	Location	Notes
	Current	Future				
				0		
Waiting Area	0	0	0	0	Visible from Admin Asst	Seating for 4 guests
				0		
Pantry	0	1	80	80	Near Admin Assts	
				0		
Fax/Copy	0	1	78	78	Near Admin Assts	
				0		
Storage	1	1	100	100		Shelving
				0		
	50	60		0		3-Hi cabinets
				0		
Executive Conference Room	1	1	200	200	Adjacent to Waiting Area	Full AV
				0		
				0		
Support Totals:				458		

Department Summary Information:		
Personnel	500	Square Ft.
Equipment	458	Square Ft.
Sub Total:	958	Square Ft.
Circulation	1.54	
Total Carpetable:	1475	Square Ft.

Interviews:
 Interview Date:
 Revision Submitted:
 Sign Off:

Department Notes:
 Entire company is progressive
 Space is attractive

ADMINISTRATION

PERSONNEL									
Position	Personnel Totals		Unit Square Ft.		Extended Sq. Feet	Equipment			Notes
	Current	Future	Office	Workstation		PC	Printer	Fax	
Finance					0				
Manager	0	1		100	100	1			
Clerical	2	0		0	0	3	1		
					0				
					0				
					0				
					0				
					0				
					0				
					0				
					0				
Personnel Totals:	2	1			100	4	1	0	

SUPPORT/EQUIPMENT SPACES									
Space	Support/Equipment		Unit Square Feet	Extended Sq. Feet	Location	Notes			
	Current	Future							
				0					
				0					
	50	50		0	Lockable room	5-Hi cabinets			
Equipment	1	1		0	Next to work area	3 Printers, shredder, work counter			
				0					
				0					
				0					
				0					
				0					
				0					
				0					
Support Totals:				0					

Department Summary Information:	
Personnel	100 Square Ft
Equipment	0 Square Ft
Sub Total:	100 Square Ft
Circulation	154
Total Carpetable	154 Square Ft

Interviewee:
Interview Date:
Revision Submitted:
Sign Off:

Department Notes:	

ACCOUNT ADMINISTRATION

Position	Personnel Totals		Unit Square Ft.		Extended Sg. Feet	Equipment			Notes
	Current	Future	Office	Workstation		PC	Printer	Fax	
Account Executive	4	2	100		200	3			
Account Manager	0	1	100		100	12			
Administrative Assistant	1	3		60	180	3	3	3	Shared by entire Production staff
Account Assistant	0			0	0	0			
					0				
					0				
					0				
					0				
					0				
					0				
Personnel Totals:	5	6			480	24	3	3	

SUPPORT/EQUIPMENT SPACES									
Space	Support/Equipment		Unit Square Feet	Extended Sg. Feet	Location	Notes			
	Current	Future							
File Drawers	10	10		30	Near Admin Assts	3-Hi cabinets			
Equipment	0	4	36	144	Near Admin Assts	Copier, work counter			
Digital Storage	0	0	0	0		Shelving; can be spread throughout			
Storage	0	0	0	0		Lockable room; shelving			
				0					
				0					
				0					
				0					
Support Totals:				174					

Department Summary Information:	
Personnel	480 Square Ft.
Equipment	174 Square Ft.
Sub Total:	654 Square Ft.
Circulation	1.54
Total Carpetable:	1007 Square Ft.

Interviewee:	
Interview Date:	
Revision Submitted:	
Sign Off:	

Department Notes:	

Summary	Executive	Administration	Account Admin	Creative Services	Support	+	:	←
---------	-----------	----------------	----------------------	-------------------	---------	---	---	---

CREATIVE SERVICES

PERSONNEL									
Position	Personnel Totals		Unit Square Ft.		Extended Sq. Feet	Equipment			Notes
	Current	Future	Office	Workstation		PC	Printer	Fax	
					0				
Team Manager	1	4	0		0	2	1		
Team Assistant	3	80		36	2880	1			
					0	2			
					0	2			
					0				
					0				
					0				
					0				
					0				
					0				
					0				
Personnel Totals:	4	84			2880	7	1	0	

SUPPORT/EQUIPMENT SPACES									
Space	Support/Equipment		Unit Square Feet		Extended Sq. Feet	Location	Notes	Department Notes:	
	Current	Future							
					0				
					0				
					0				
Concept Lounge	0	1		200	200				
Work Area	0	1		500	500	Adjacent to Teams		Work counters	
Storage	0	1		300	300	Next to Work Area		Shelving	
					0				
					0				
					0				
					0				
					0				
Support Totals:					1000				

Department Summary Information:		
Personnel	2880	Square Ft
Equipment	1000	Square Ft
Sub Total:	3880	Square Ft
Circulation	1.54	
Total Carpetable	5375	Square Ft

Interviewee:	
Interview Date:	
Revision Submitted:	
Sign Off:	

SUPPORT

Position	Support/Equipment		Unit Square Ft.	Extended Sq. Feet	Location	Notes	Department Summary	
	Current	Future					Information:	
				0			Personnel	0 Square Ft.
				0			Equipment	1030 Square Ft.
				0			Sub Total:	1030 Square Ft.
				0			Circulation	154
				0			Total Carpetable:	1586.2 Square Ft.
				0				
				0				
				0				
				0				
				0				
				0				
				0				
				0				
				0				
				0				
				0				
				0				
Personnel Total:	0	0		0				

Interviews:
 Interview Date:
 Revision Submitted:
 Sign Off:

SUPPORT/EQUIPMENT SPACES

Space	Support/Equipment		Unit Square Feet	Extended Sq. Feet	Location	Notes	Department Notes:	
	Current	Future						
Reception	1	1	0	0	Direct access to Broadcast, Executive, Mktg	Waiting for 6, TVs		
Conference Room	1	2	200	400	Shared by all areas	Full AV		
Computer Service Area	0	0	0	0		Work counter, outlets		
Computer Server Room	1	1	80	80	Near Account Admin	Raised floor, secure, 3 racks		
Copy/Fax Station	0	0	0	0	Spread throughout	Work counter		
Pantry	1	2.5	100	250	Spread throughout	Coffee, sink, refrigerator, cabinets		
Lunch Room	0	0	0	0		Full kitchen, seating		
Coatr	0	0	0	0	Spread throughout			
Mechanical Room	0	1	300	300	Near Base Building air supply	Supplemental Air		
				0				
Support Totals:				1030				

2015

PORTFOLIO TWO

IDSN 3600



Molina, Rosendo Alberto

East Carolina University

11/5/2015

BUBBLE DIAGRAMS

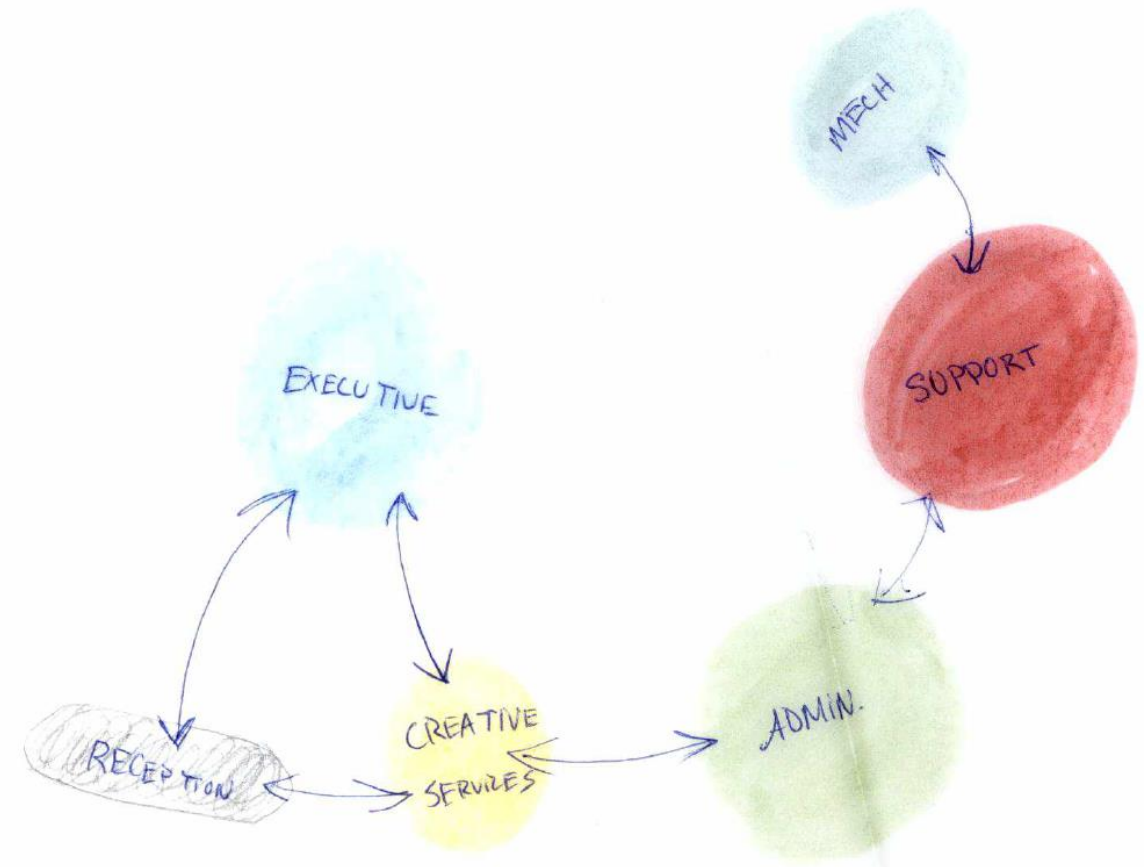
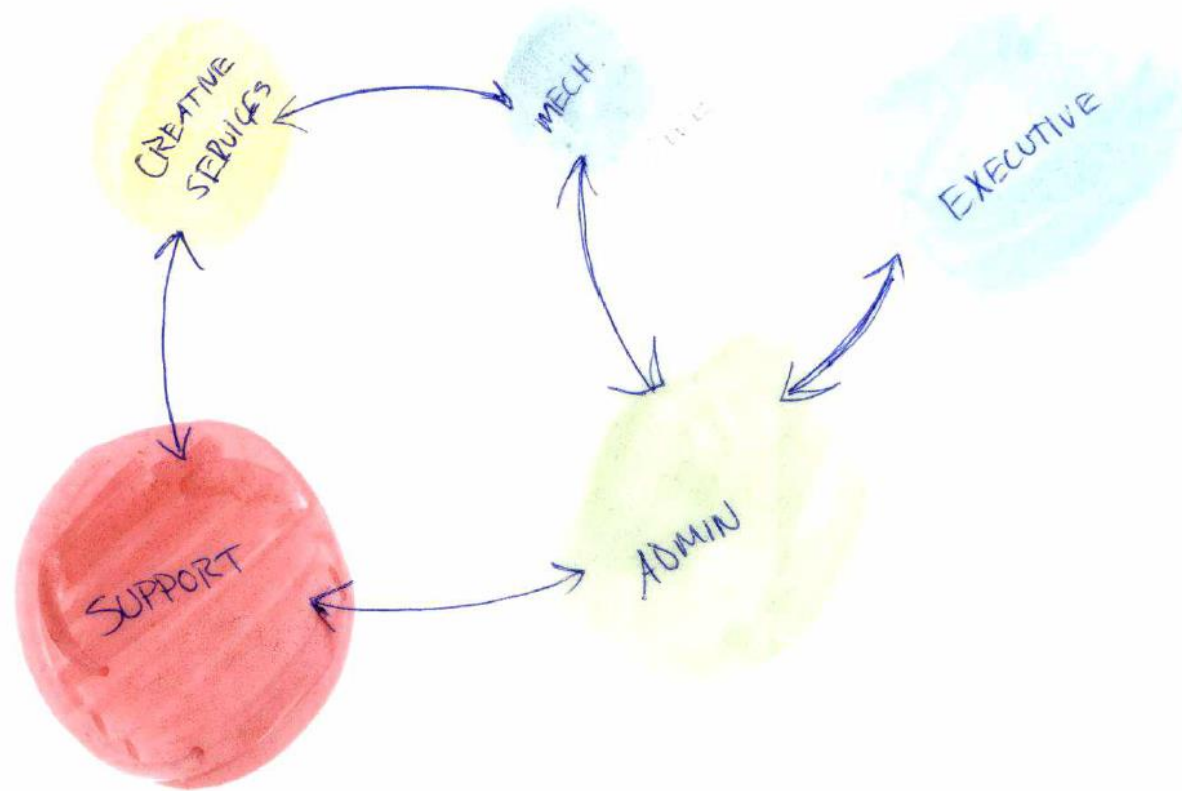

BLOCKING DIAGRAMS

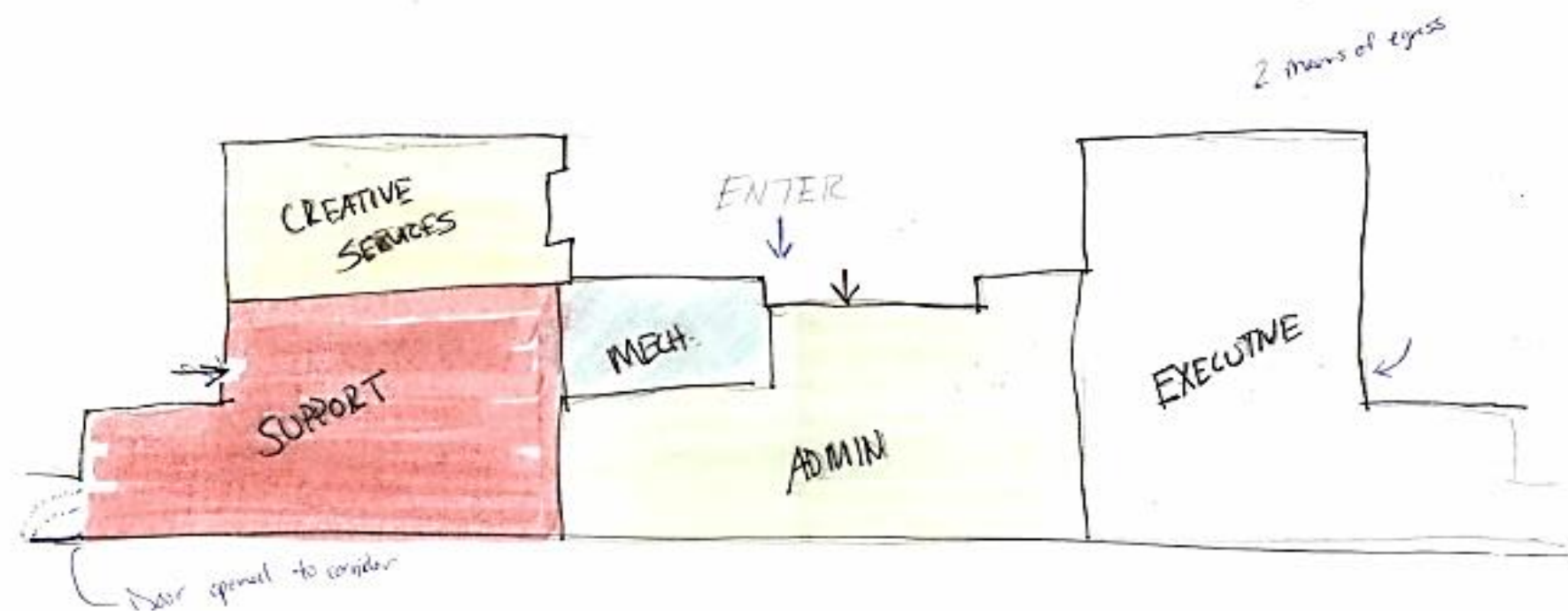
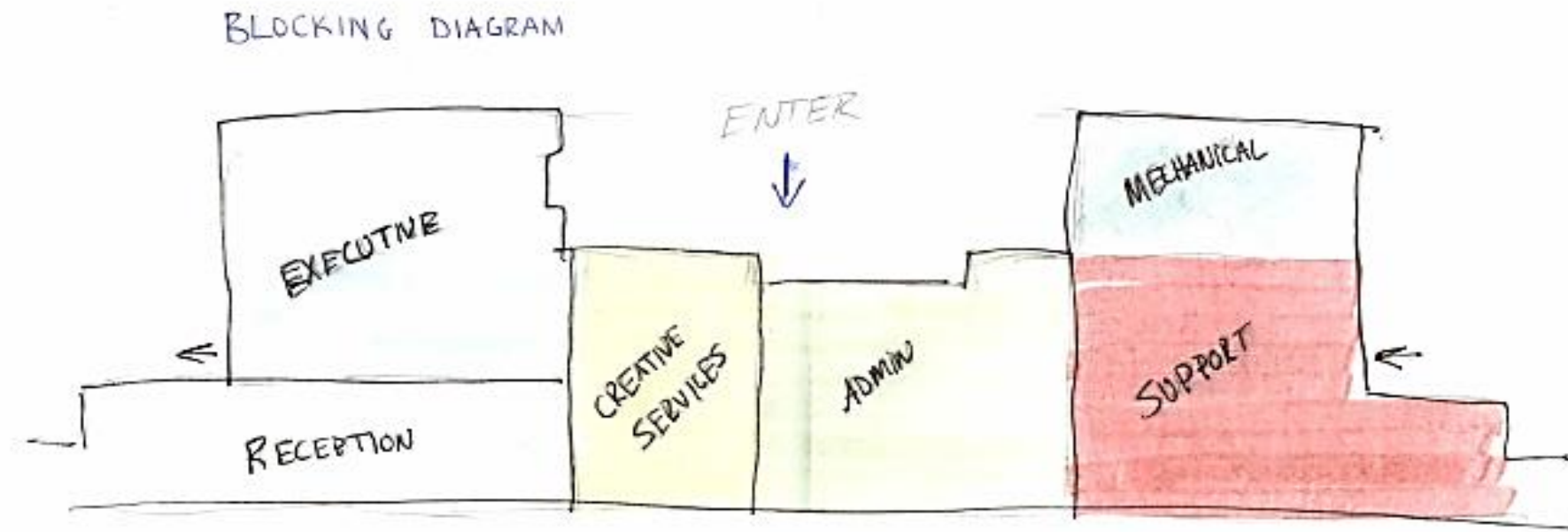

WORKSTATION SKETCHES

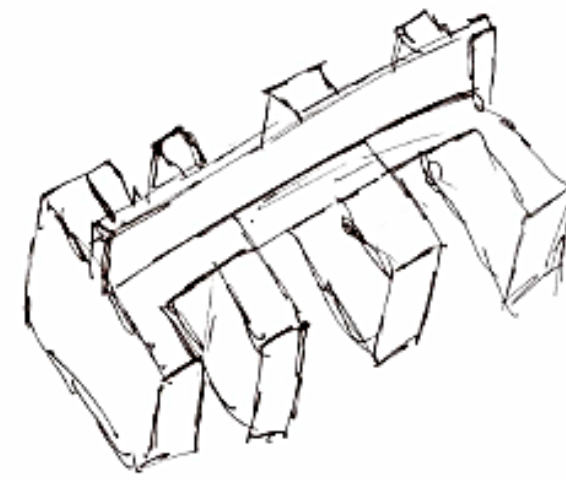
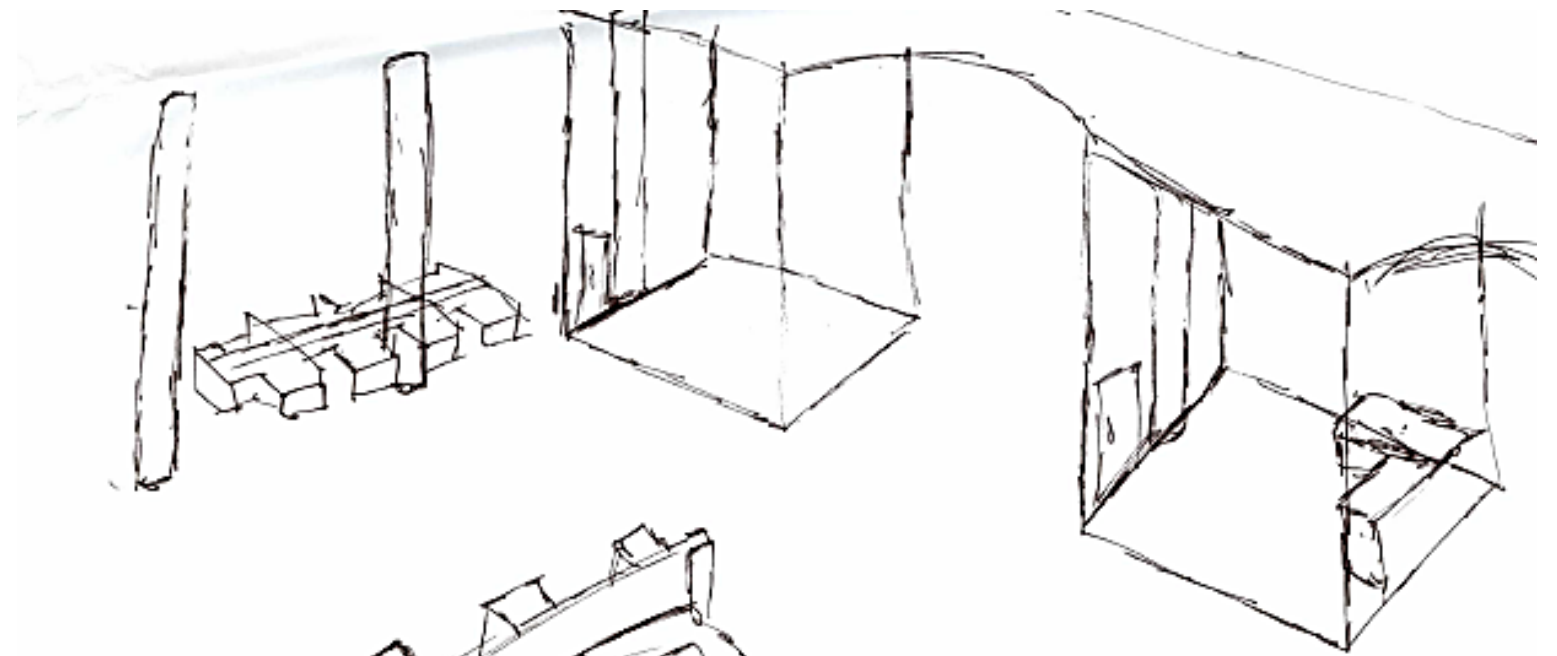
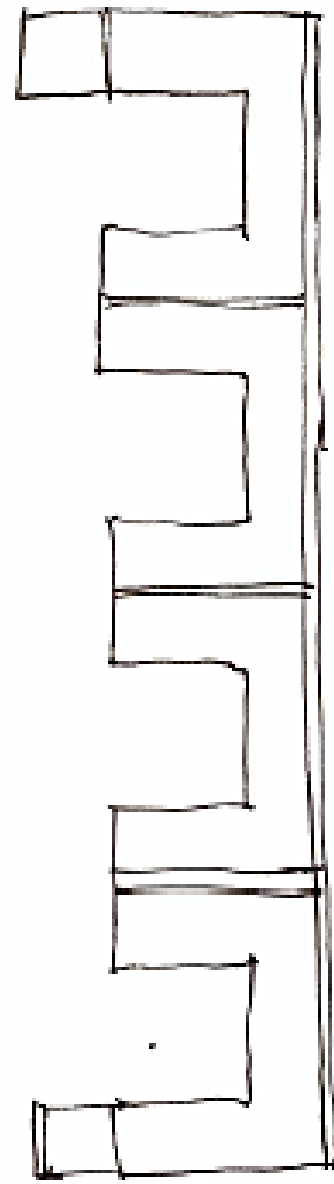
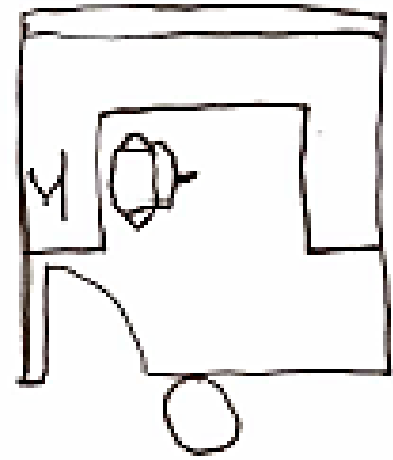
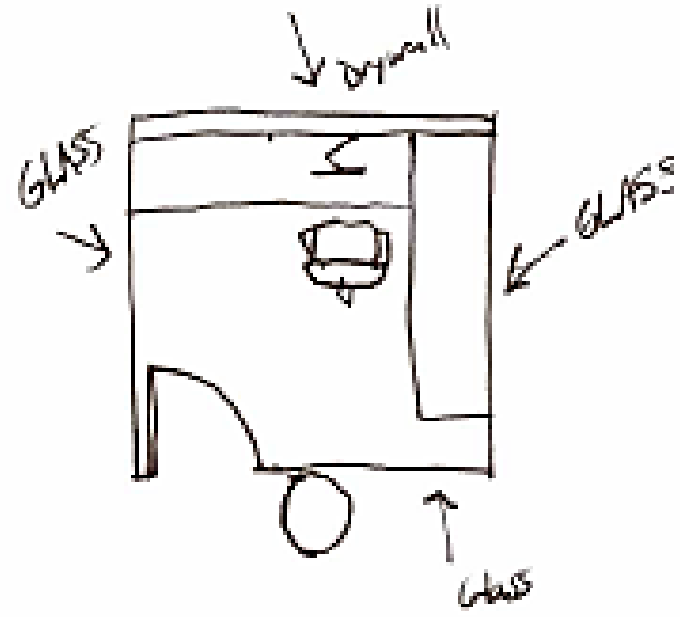

WS1

SPATIAL CONCEPT SKETCHES

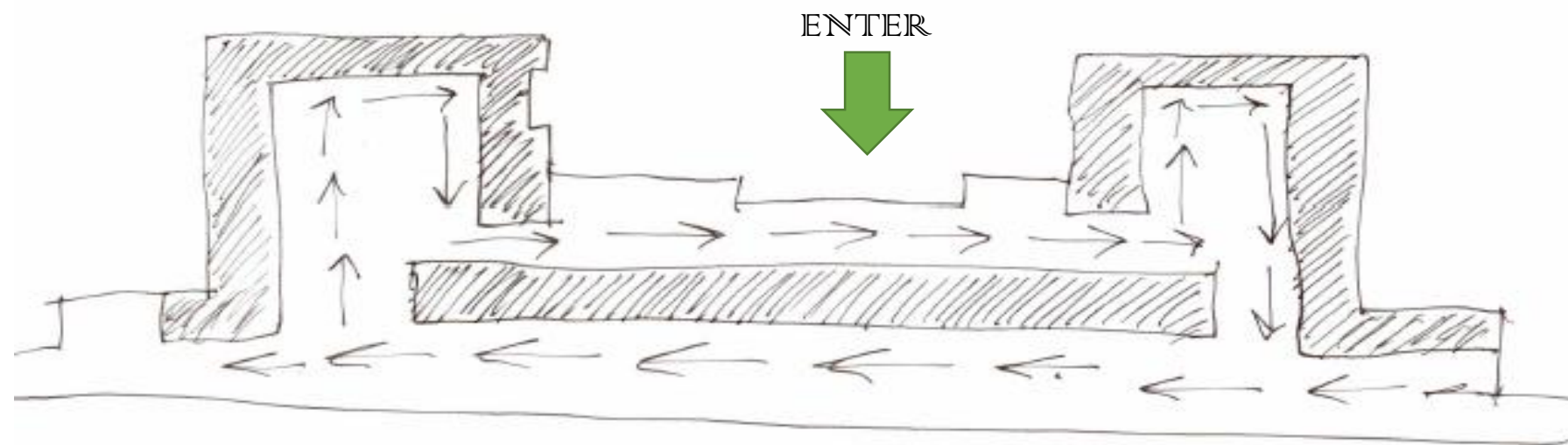
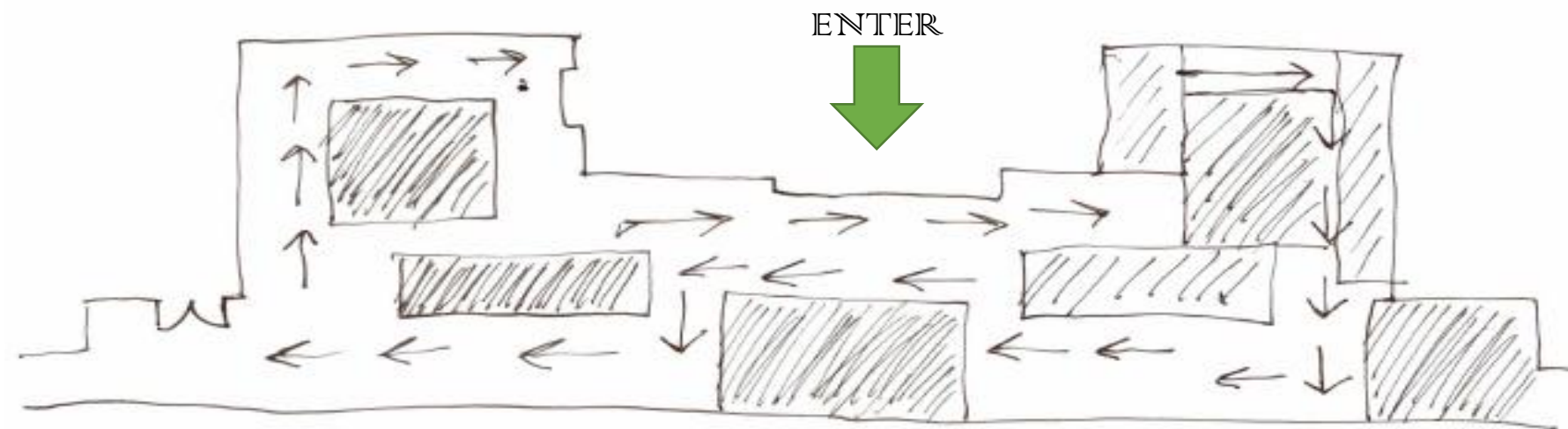

BUILDING SITE ORIENTATION

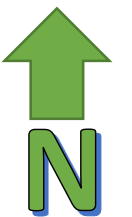
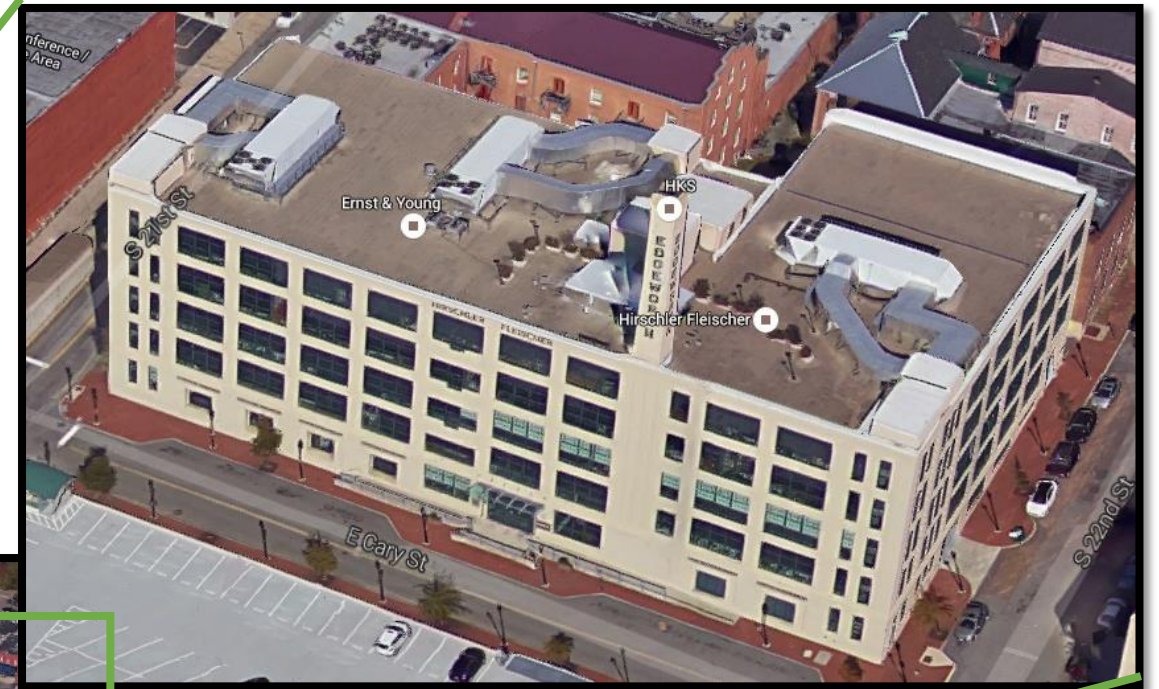

SPACE PLANNING

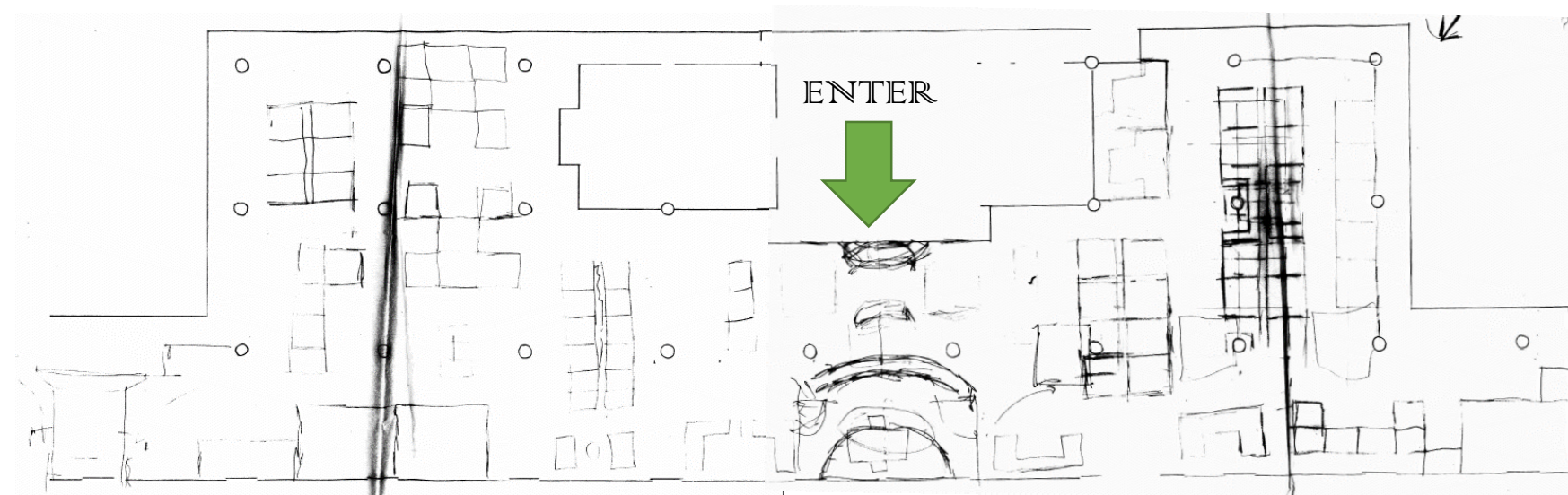
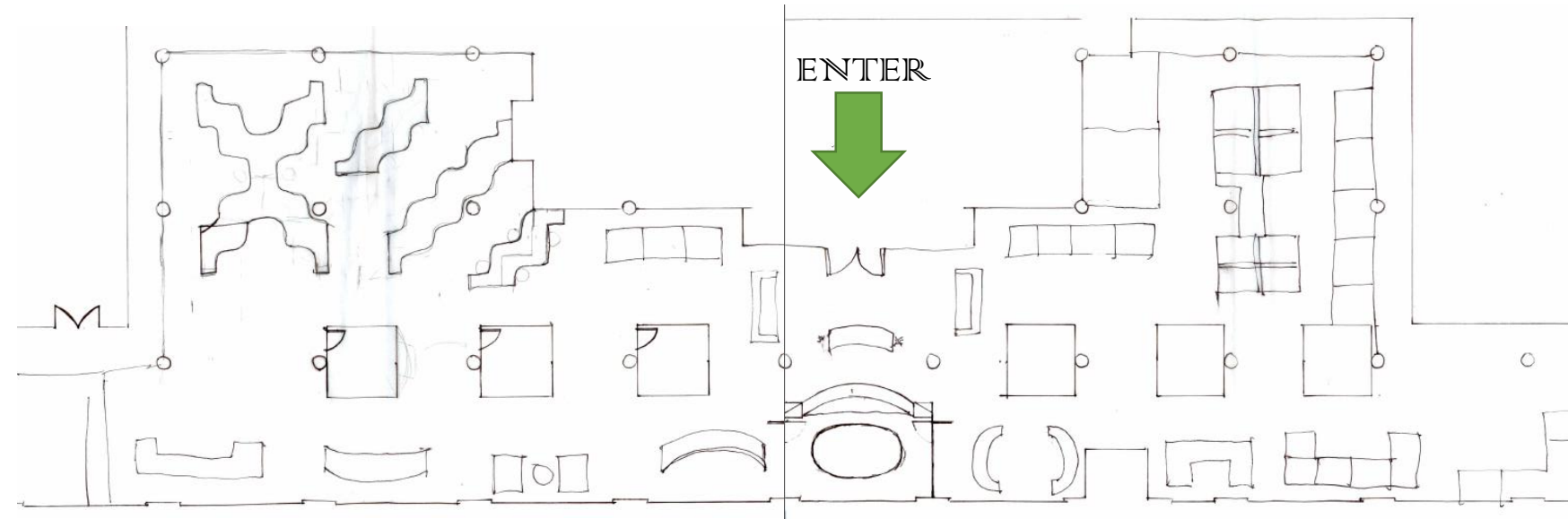

ENTRY SKETCHES

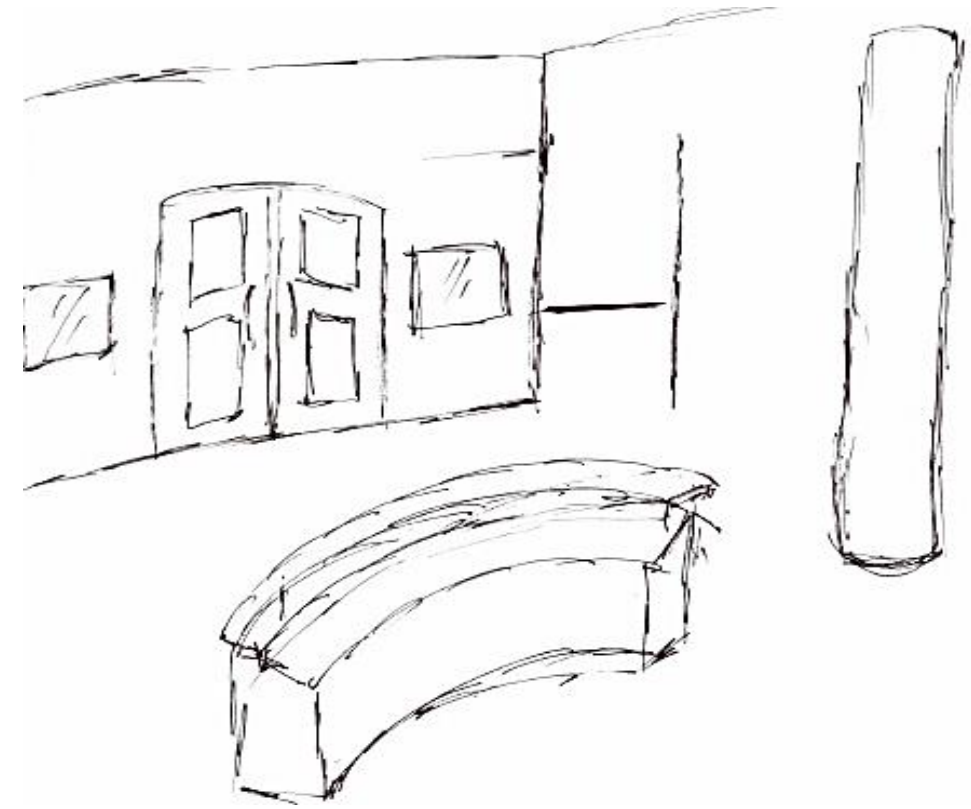
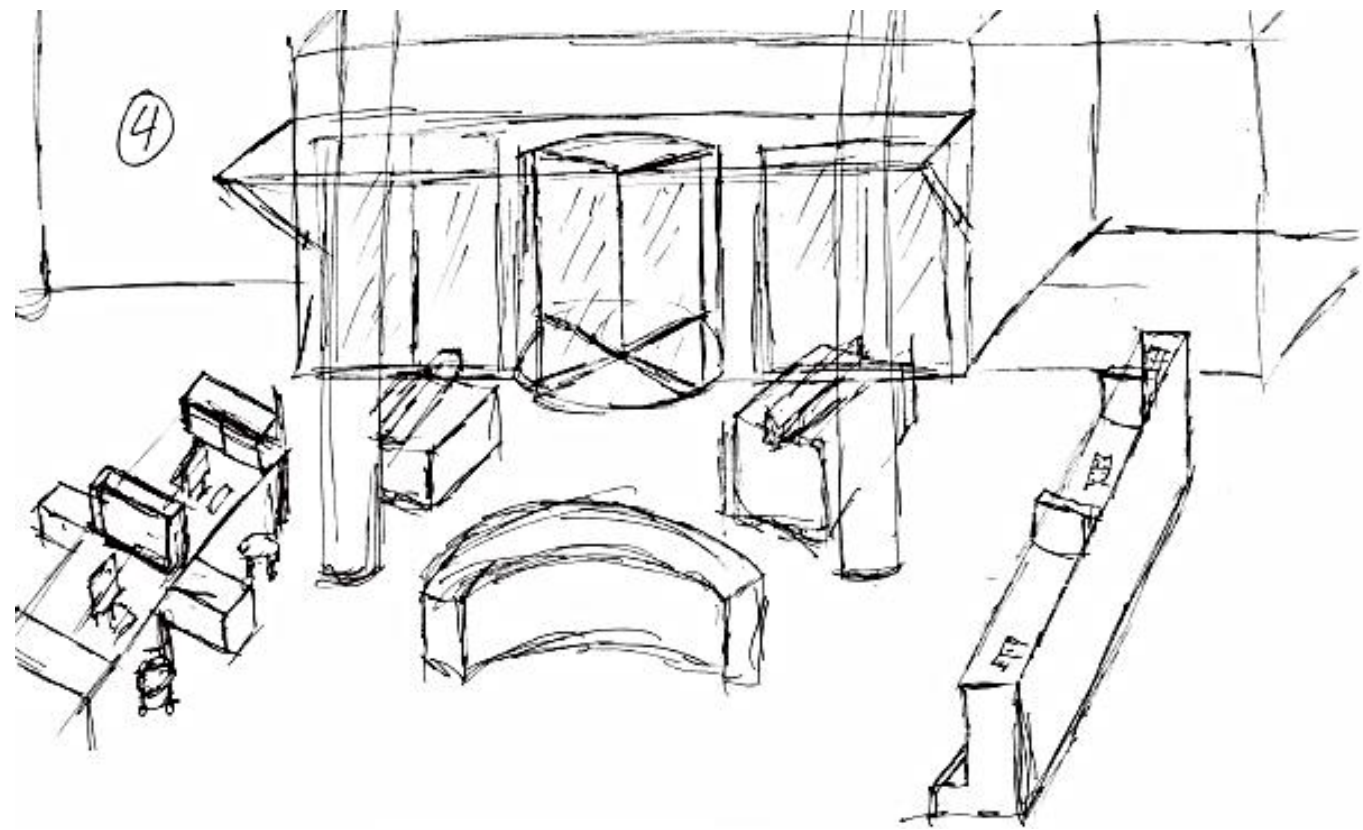

CORRIDOR SKETCHES

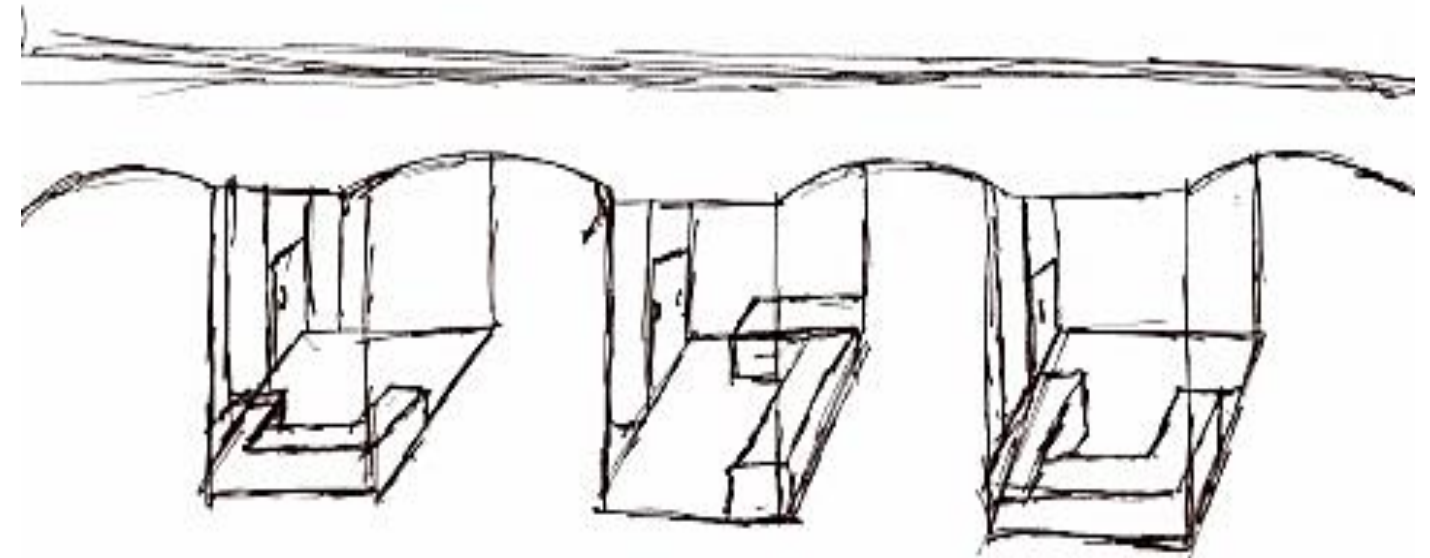
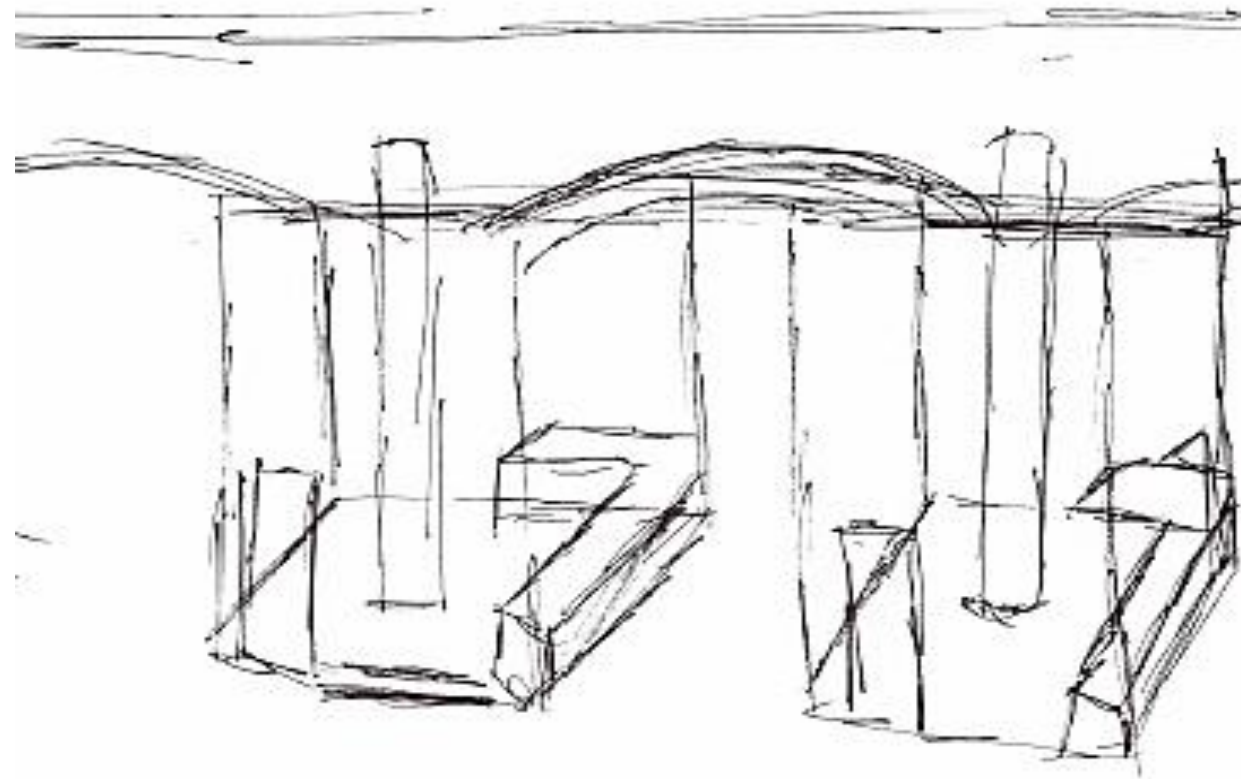

LOUNGE AREA SKETCHES

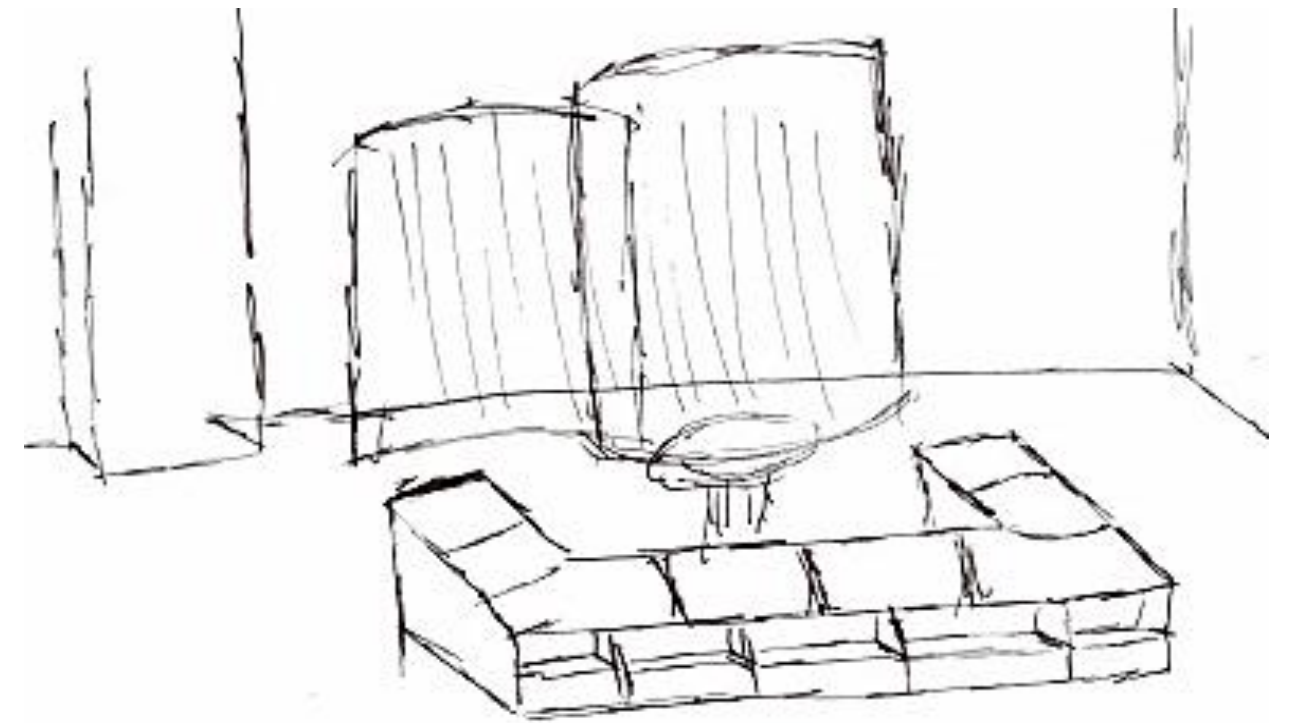
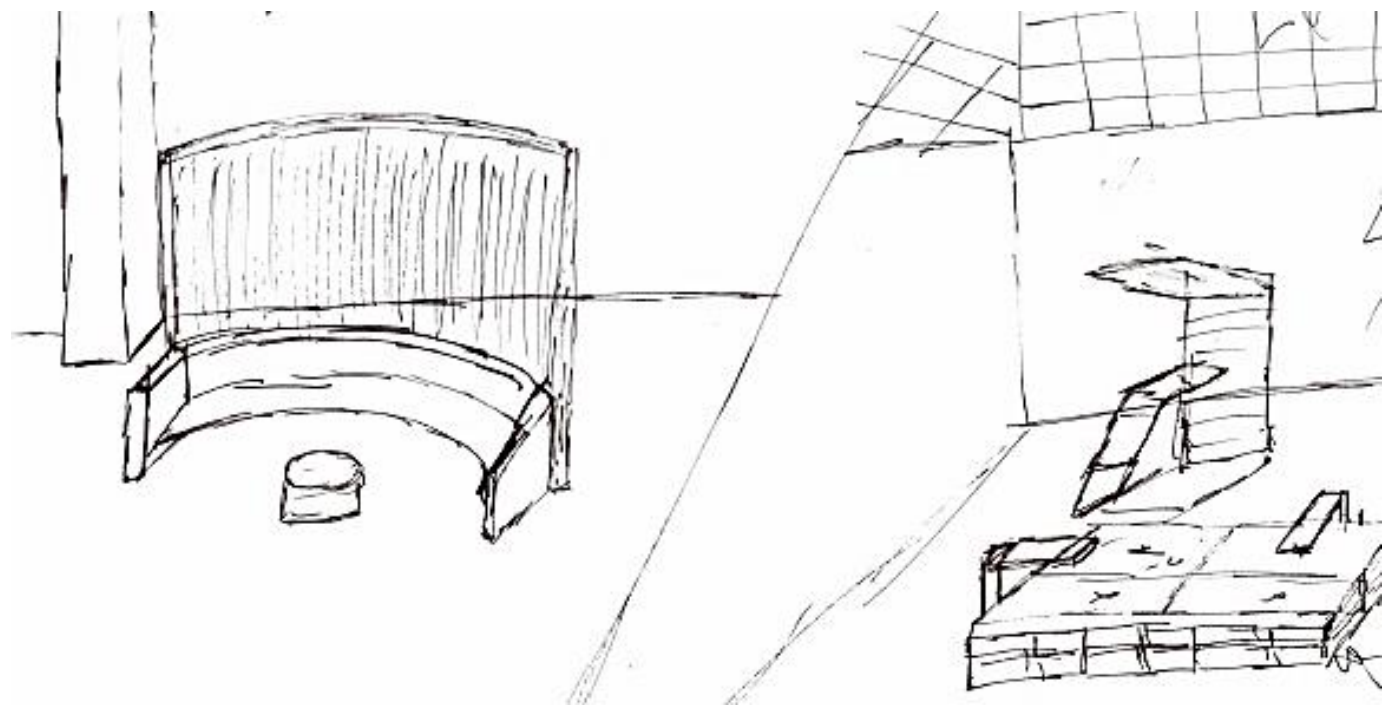

LOUNGE AREA SKETCHES

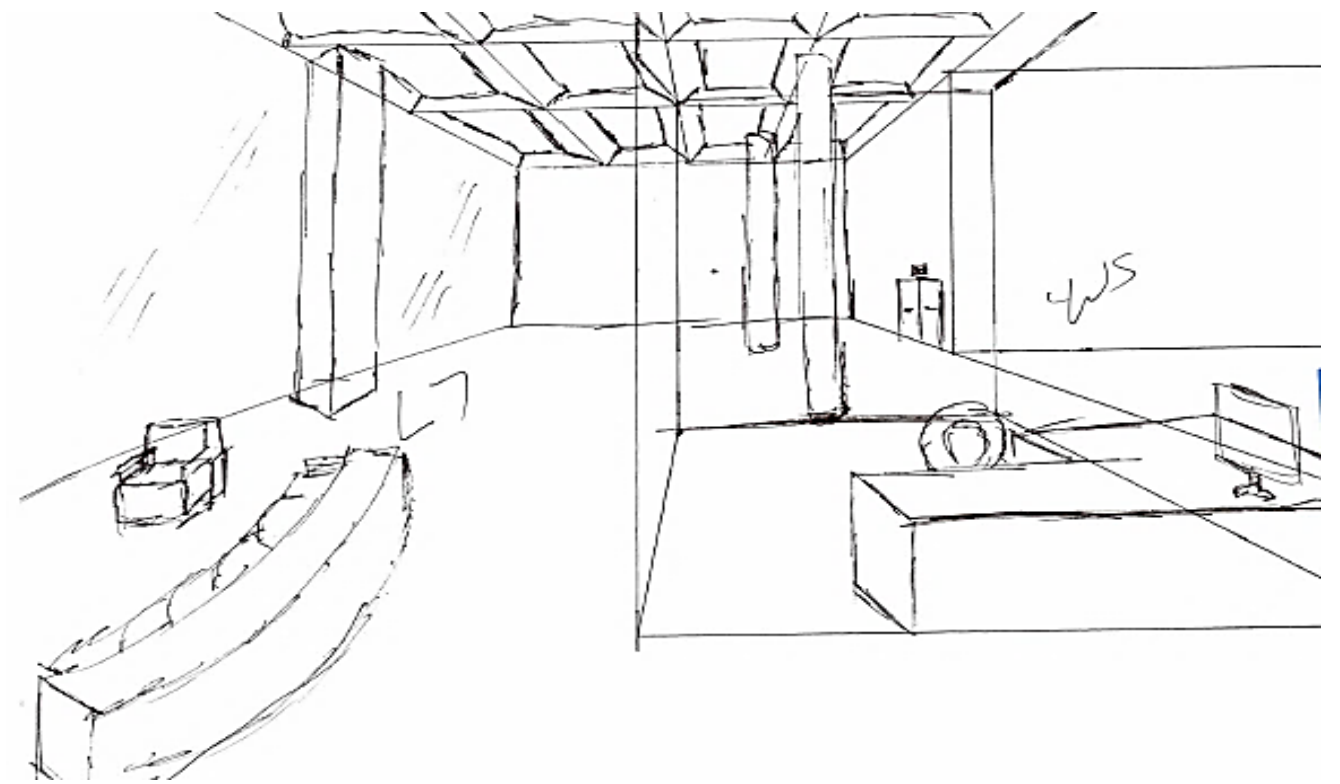
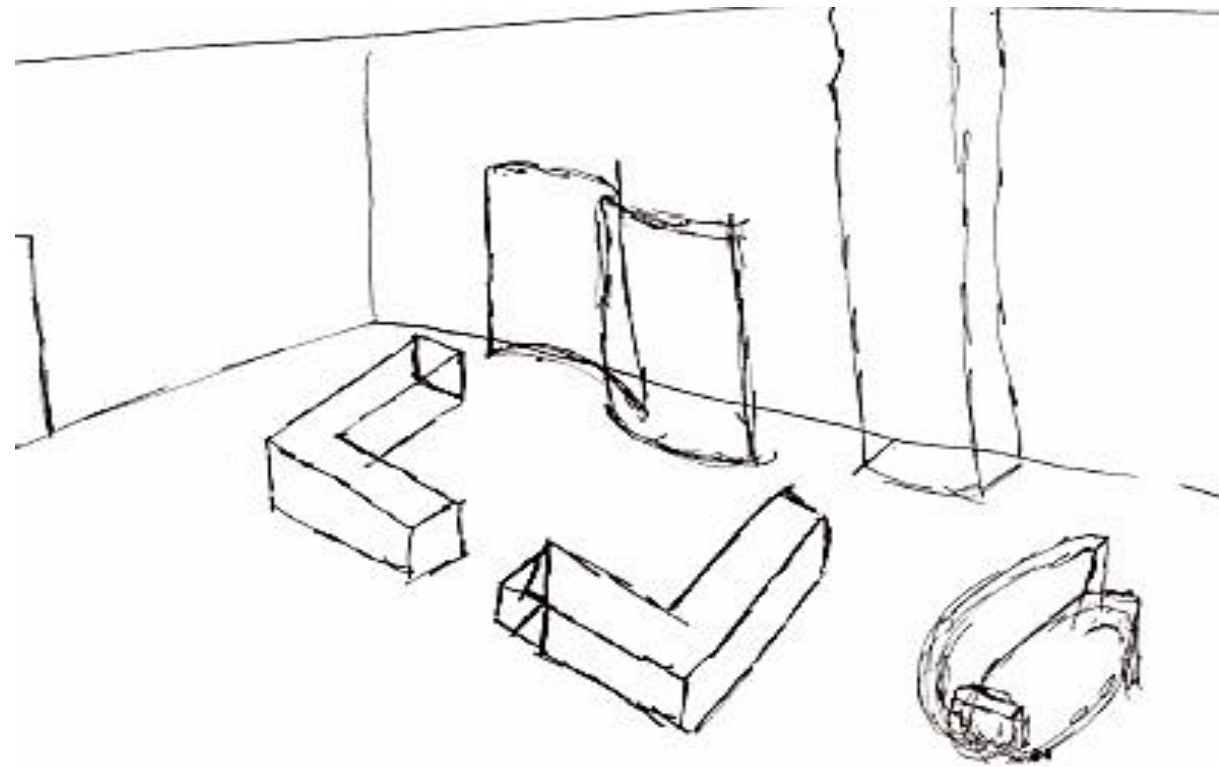

OPEN WORK AREA SKETCHES

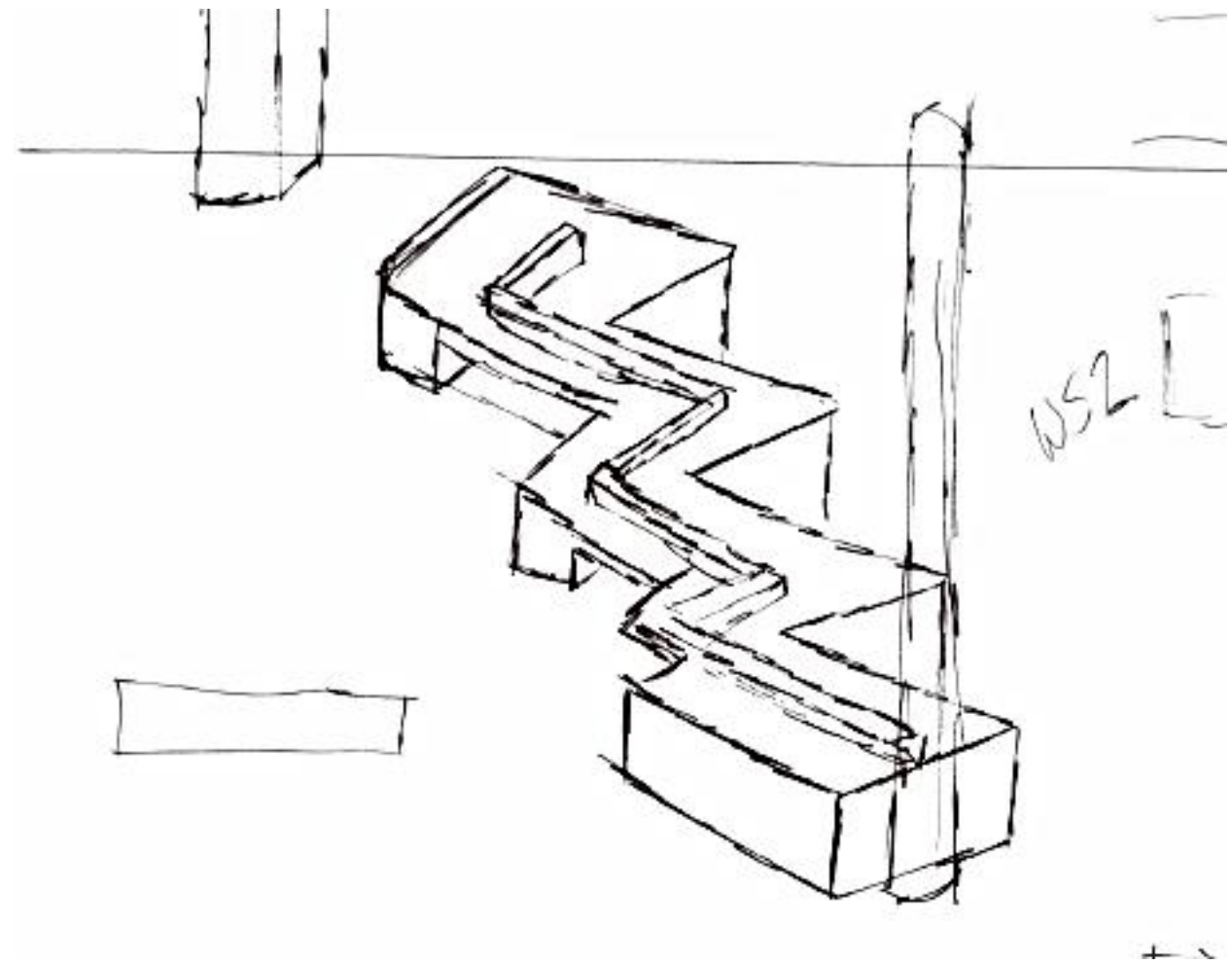
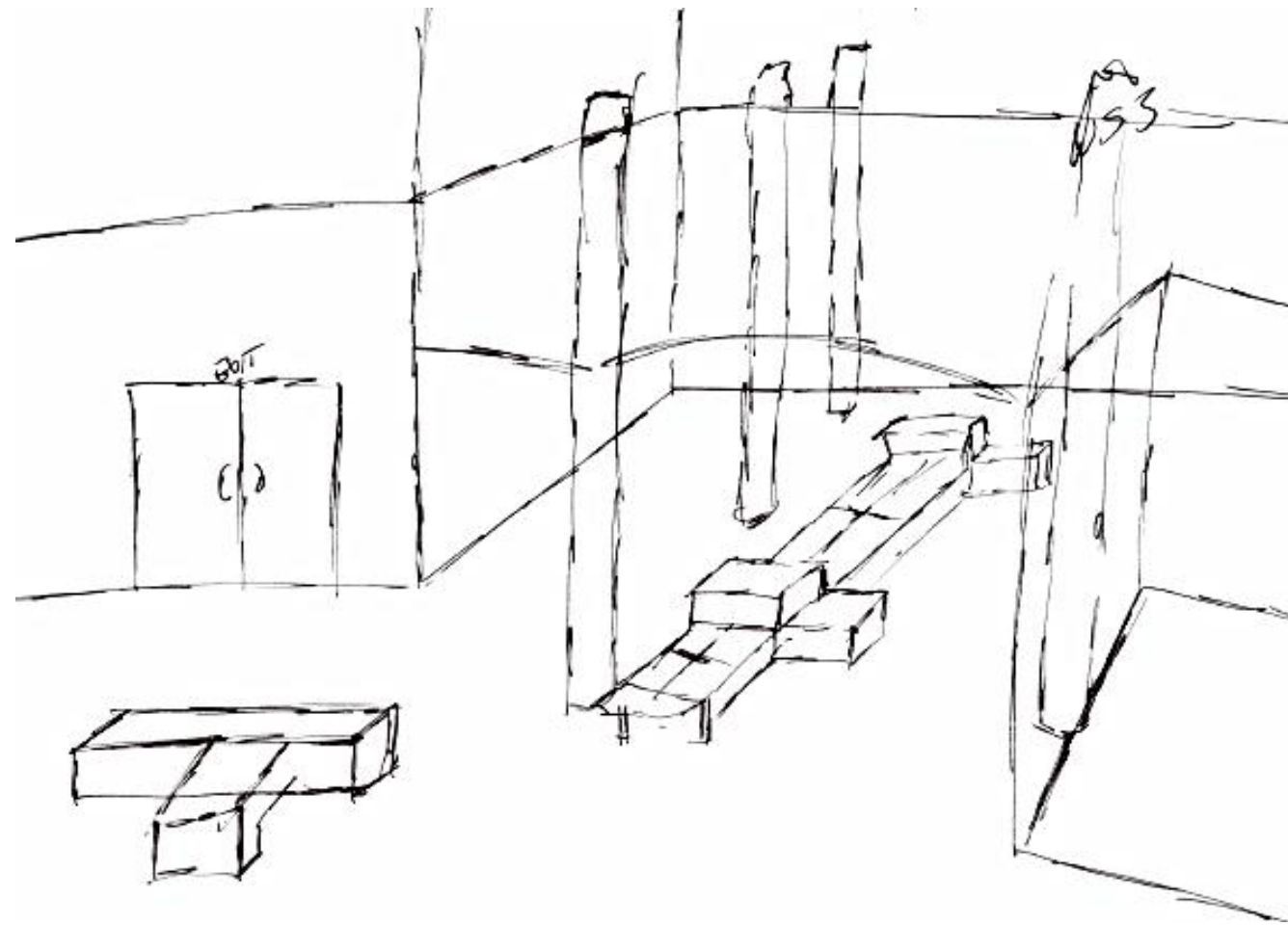

LIGHT SKETCHES

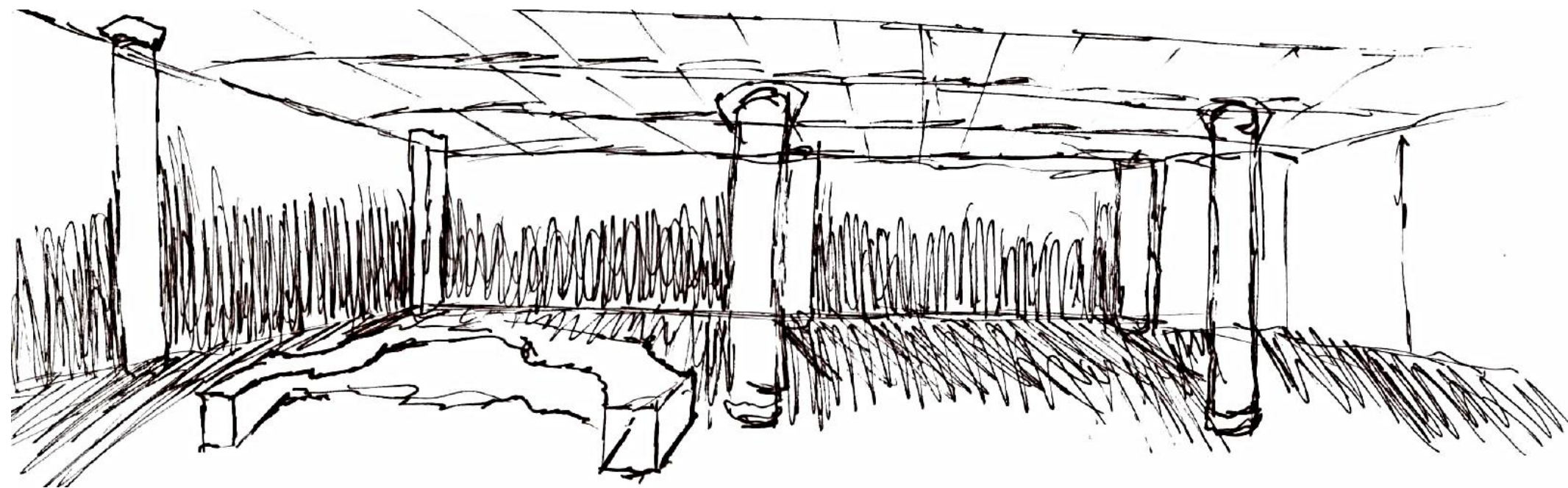
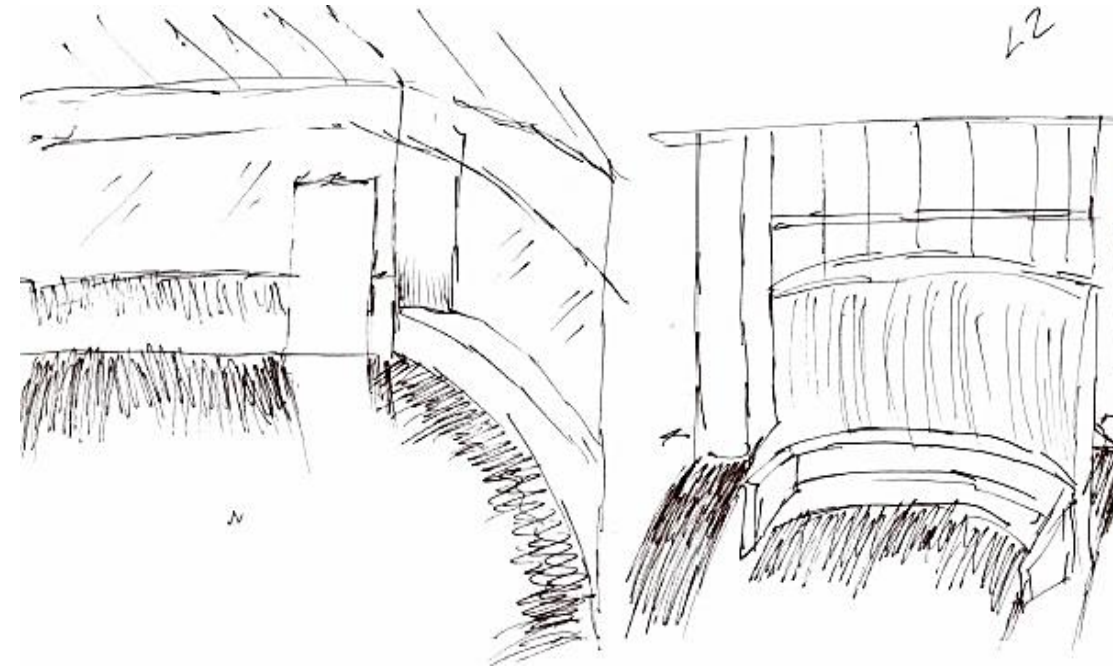

LIGHT SKETCHES

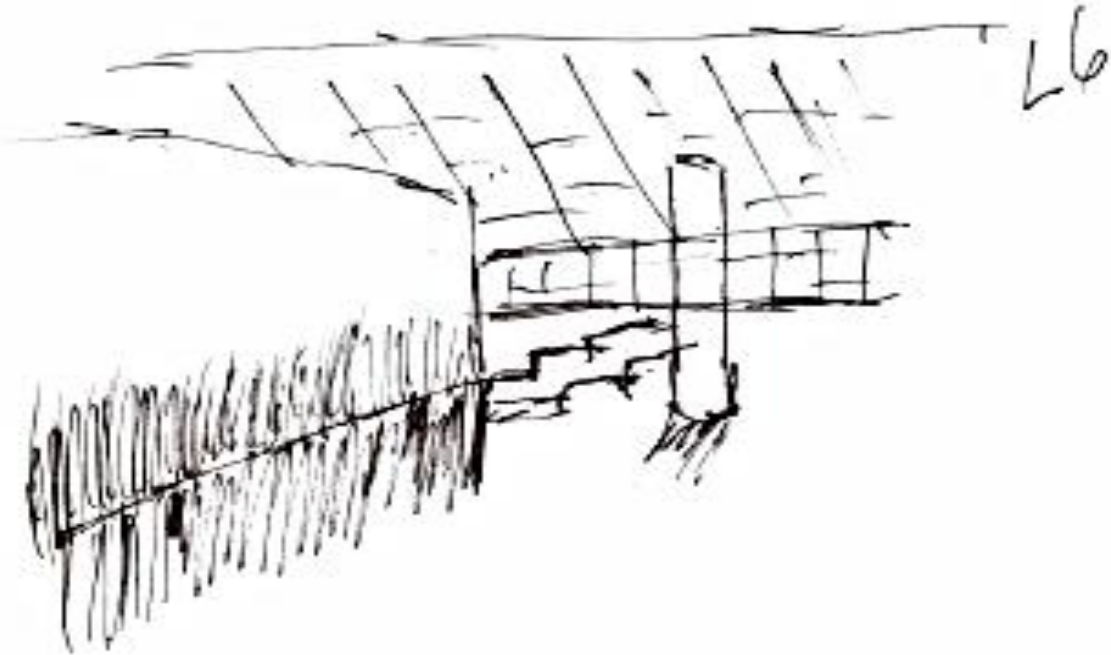
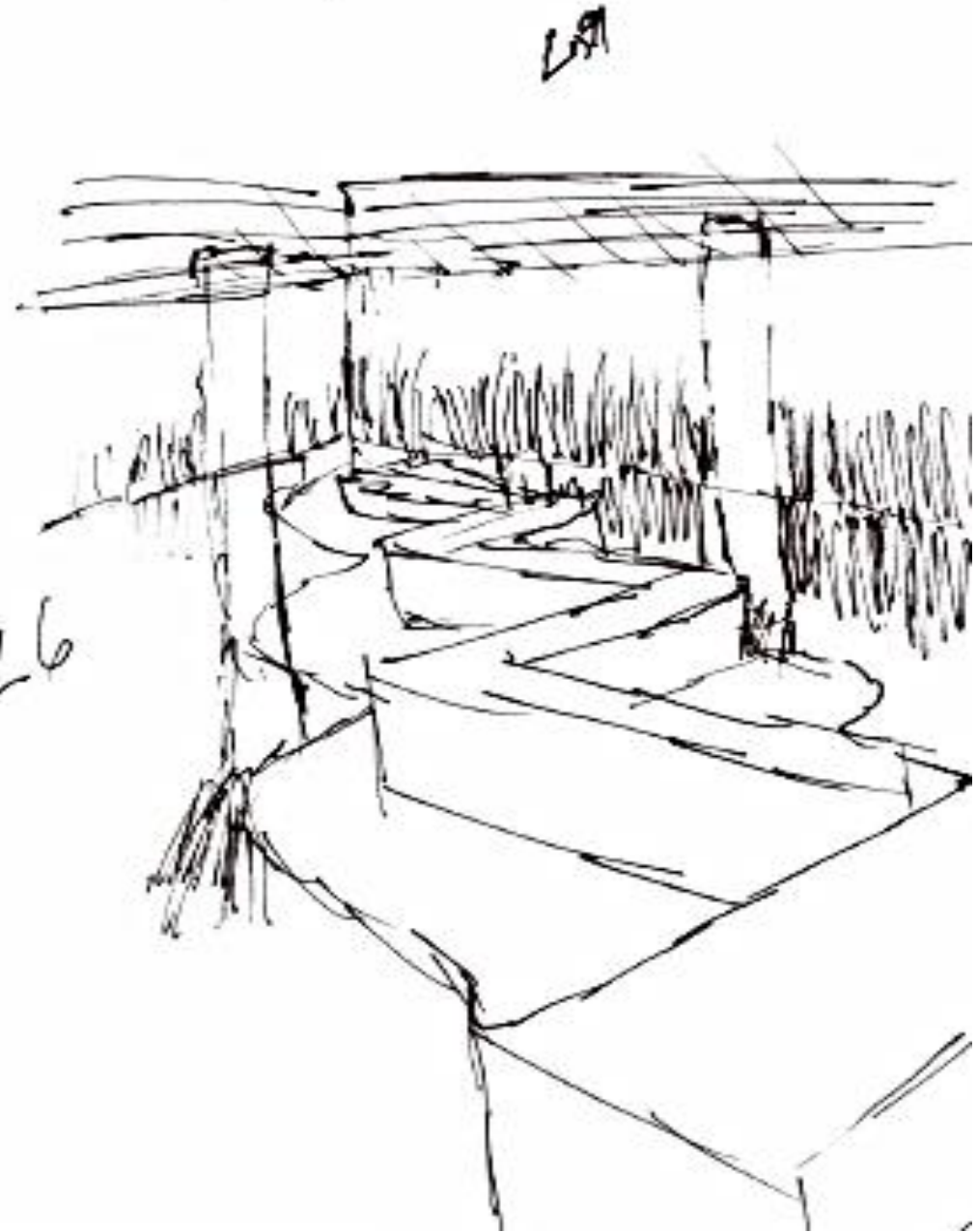

SYSTEMS R/CP

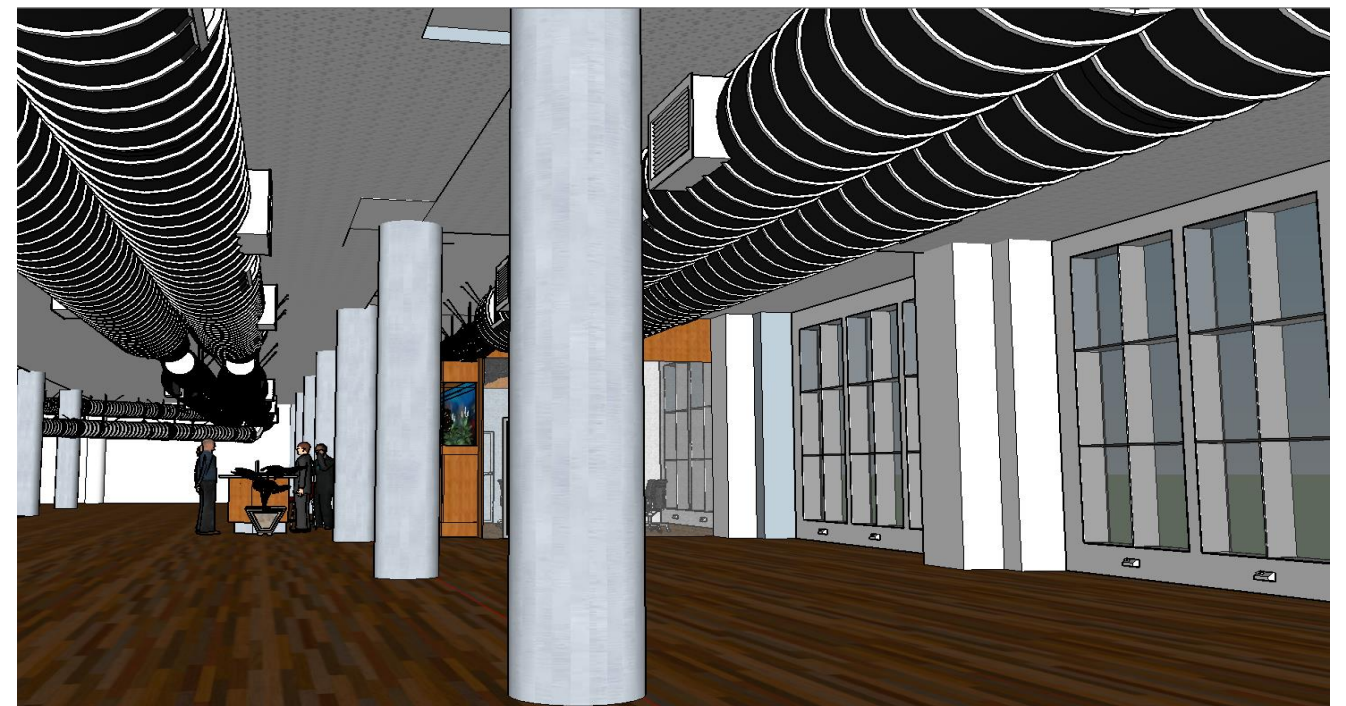
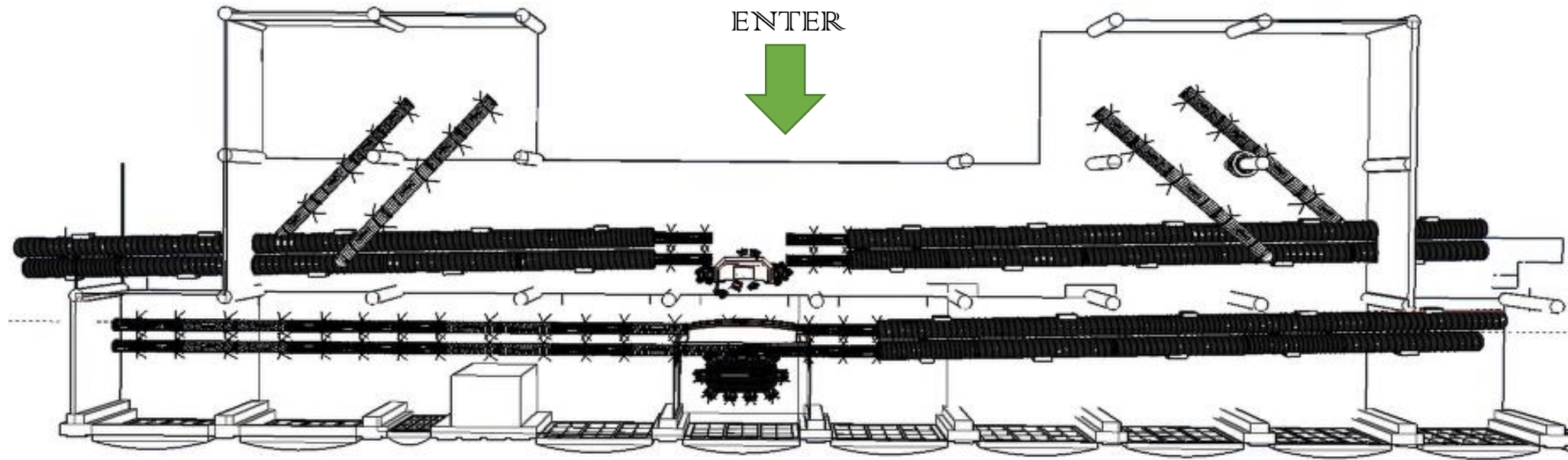

LIGHTING MODEL



LIGHTING MODEL





LIGHTING ANALYSIS

$$\text{RCR} = \frac{5(H)(L+W)}{L \times W}$$

$$\text{RCR} = \frac{5(11.5)(10+10)}{10 \times 10}$$

$$\text{RCR} = .775$$

$$\text{LLF} = \text{LDD} \times \text{LDD}$$

$$\text{LLF} = .9 \times .85$$

$$\text{LLF} = .775$$

MAINTAINED FC = # OF LAMPS x INITIAL LAMP LUMENS x LLF x CU AREA

$$\text{MAINTAINED FC} = 2 \times 100 \times .775 \times 26/130$$

$$\text{MAINTAINED FC} = 31$$

PHOTOMETRIC DATA CHART



Photometric Data: Lumination™ 2' x 2' Recessed Luminaire BT 22 Series

BT-22-0-A3-A-V-WHTE-X .IES

RC	COEFFICIENTS OF UTILIZATION																						
	80%				70%				50%				30%				10%				0%		
RW	70%	50%	30%	10%	70%	50%	30%	10%	50%	30%	10%	50%	30%	10%	50%	30%	10%	50%	30%	10%	0%		
0	119	119	119	119	116	116	116	116	111	111	111	106	106	106	102	102	102	100	100	100	100		
1	108	103	99	95	106	101	97	93	97	93	90	93	90	87	89	87	85	83	83	83	83		
2	98	90	83	77	96	88	81	76	84	79	74	81	76	72	78	74	71	68	68	68	68		
3	89	79	70	64	87	77	69	63	74	67	62	71	65	61	69	64	60	57	57	57	57		
4	82	70	61	54	79	68	60	53	66	58	53	63	57	52	61	56	51	49	49	49	49		
5	75	62	53	46	73	61	52	46	59	51	45	57	50	45	55	49	44	42	42	42	42		
6	69	56	47	40	67	55	46	40	53	45	40	51	44	39	50	44	39	37	37	37	37		
7	64	51	42	35	63	50	41	35	48	41	35	47	40	35	45	39	34	32	32	32	32		
8	60	46	38	32	58	45	37	31	44	37	31	43	36	31	42	35	31	29	29	29	29		
9	56	42	34	28	54	42	34	28	41	33	28	39	33	28	38	32	28	26	26	26	26		
10	52	39	31	26	51	39	31	26	37	30	26	37	30	25	36	30	25	23	23	23	23		

ZONAL LUMEN SUMMARY	
Zone	Lumens
0-10	113.16
10-20	324.53
20-30	490.89
30-40	593.17
40-50	617.38
50-60	562.55
60-70	437.74
70-80	266.48
80-90	84.18
90-100	1.76
100-110	1.54
110-120	1.44
120-130	1.24
130-140	1.15
140-150	1.09
150-160	0.94
160-170	0.62
170-180	0.17

Effective Floor Cavity Reflectance 0.20

ZONAL LUMEN SUMMARY			
Zone	Lumens	% of Lamp	% of Fixture
0-20	437.69	N.A.	12.50
0-30	928.58	N.A.	26.50
0-40	1521.75	N.A.	43.50
0-60	2701.69	N.A.	77.20
0-80	3405.9	N.A.	97.30
0-90	3490.09	N.A.	99.70

LUMINANCE DATA (CD/SQ.M)			
Angle in Degrees	0°	45°	90°
45°	3414	3407	3405
55°	3307	3303	3303
65°	3150	3150	3154
75°	2932	2927	2928
85°	2628	2606	2639

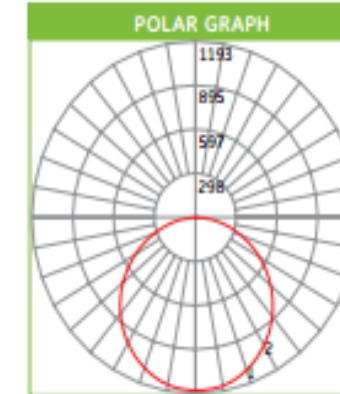

Total Luminaire Efficiency = N.A.%



HGTV HOME™ by Sherwin-Williams Ovation® Interior Latex Paint

LIFE SAFETY PLAN CHART

BUILDING CONSTRUCTION AND OCCUPANCY									
Construction Type	Sprinklers?	Occupancy Type							
Reinforced Concrete	Yes	B							
EXIT REQUIREMENTS: NUMBER AND ARRANGEMENTS OF EXITS									
Space Designation	# of Exits		Travel Distance		Arrangement: Means of Egress				
	Required	Shown on Plans	Allowable Distance	Actual Distance Shown on Plans	Req'd Distance Between Exits		Actual Distance Shown on Plans		
Suite 3100	2	3	300 feet	215 feet	122		227 feet		
Notes:									
Use Group or Space Designation	(A)	(B)	©		Exit Width (Inches)				
	Area = Sq. Ft.	Area per Occupant	Calculated Occupant Load = A/B	Egress per Occupant		Required Width = (A/B)xC		Actual Width	
				Stair	Level	Stair	Level	Stair	Level
Suite 3100	10,200	100	102	.3"	.2"	30.6"	20.4"	5' 5"	3

LIFE SAFETY PLAN

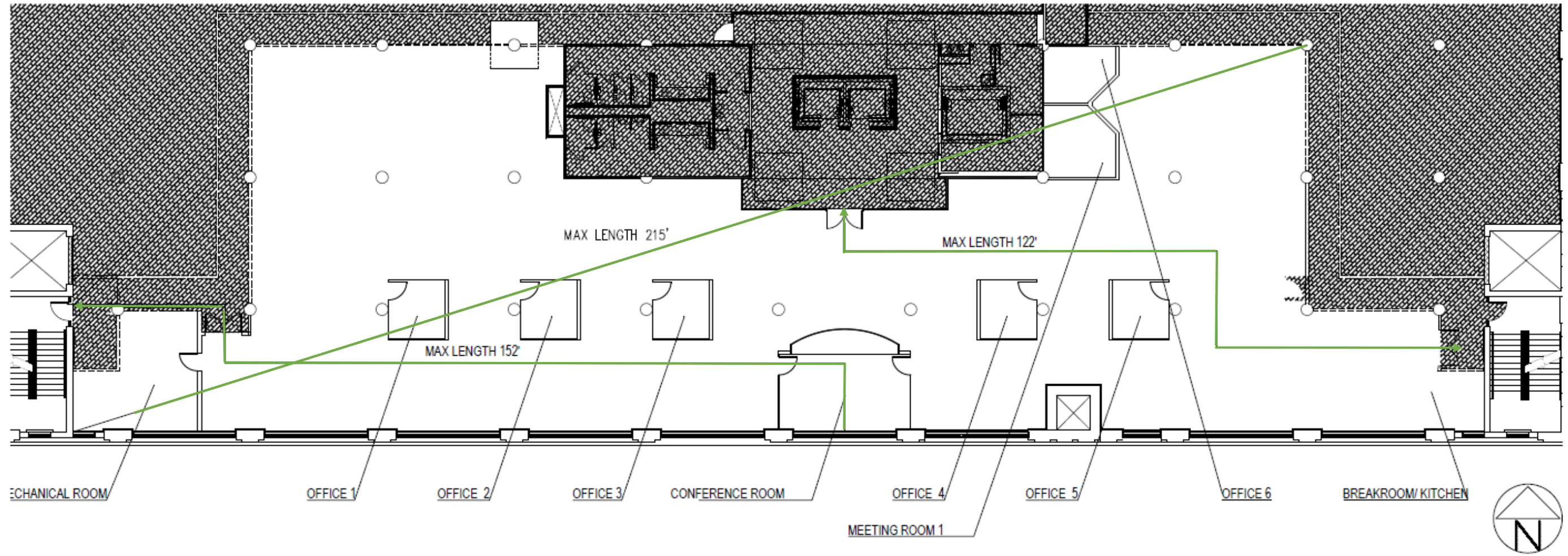

MECHANICAL ROOM

OFFICE 1

OFFICE 2

OFFICE 3

CONFERENCE ROOM

OFFICE 4

OFFICE 5

OFFICE 6

BREAKROOM/ KITCHEN

MEETING ROOM 1



OUTSIDE WORK AREA

BUSINESS OCCUPANCY 10,200

LIFE SAFETY PLAN
SCALE: 1/16"=1'-0"