



IDSN 3600 PORTFOLIO 3: INSPIRATION BOARD
MATTHEW BRACKET



Return to Instincts

Luray Caverns in Virginia provides inspiration for this office space. Like the structure of a cave, vast expanses of space incorporate enclosures providing a sense of safety, security and focus. Work and leisure are incorporated into one space much like how early humanity lived.

- Design will incorporate a variety of textures unified by clean minimalist lines and a neutral color pallet with accents of color and graphics.
- Office space planning encourages interaction between all members of the work team.



Statement of Sustainability

- Minimal alterations to existing structure captures embodied energy
- Re-purposed hardwood surfaces + steel structures
- Large shutters control sunlight to reduce dependence on central HVAC systems and artificial light
- LED + automatic dimming and shut-off lighting
- Utilization of LEED certified furnishings, lighting and finishes



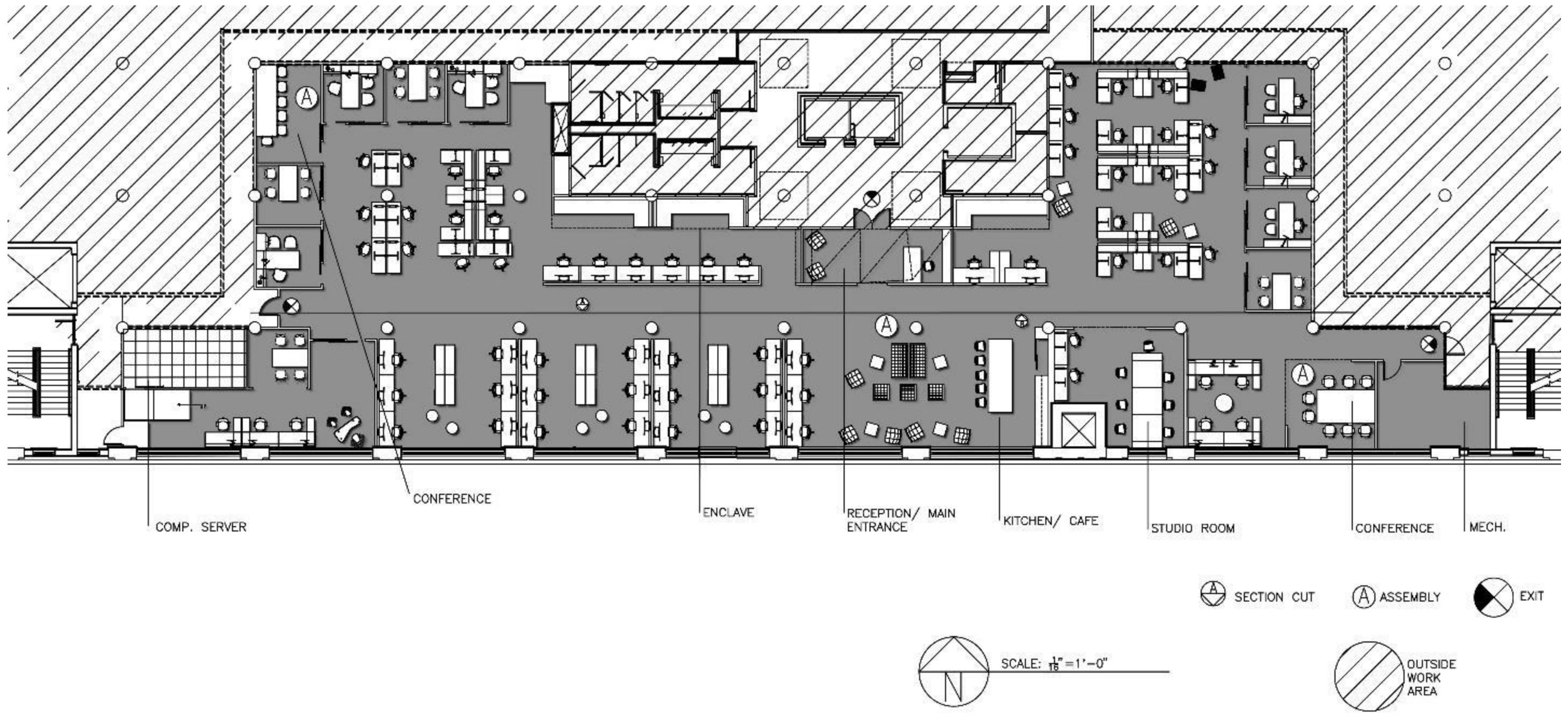

IDSN 3600 PORTFOLIO 3: FURNITURE PLAN

MATTHEW BRACKETT



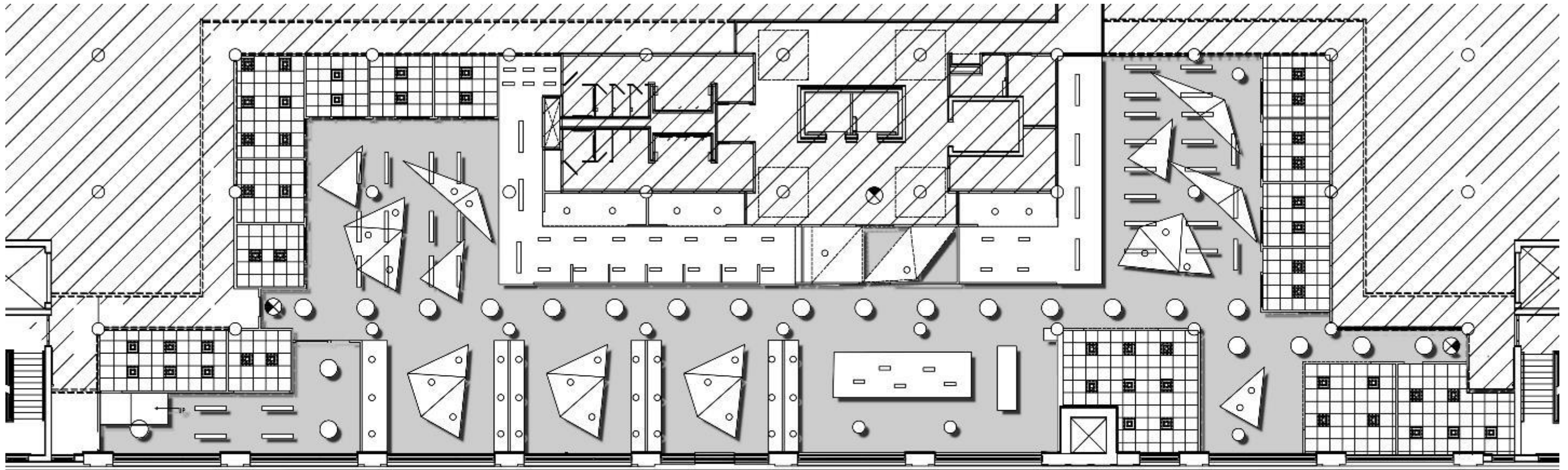

SYM.	DESCRIP.	DIM.
○	PENDANT	2'-10" D
▭	PENDANT	1'X5'
■	LED TILE	2'X2'
○	1 LIGHT CAN	12" D
▭	2 LIGHT CAN	1'X2'

CEILING HEIGHT: 13'-0"

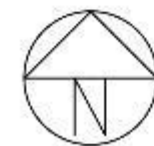

SCALE: 1/8" = 1'-0"



EXIT

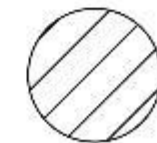

OUTSIDE
WORK
AREA

IDSN 3600 PORTFOLIO 3: REFLECTED CEILING PLAN

MATTHEW BRACKETT



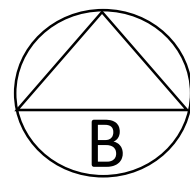
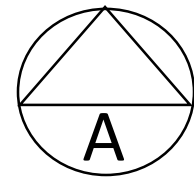
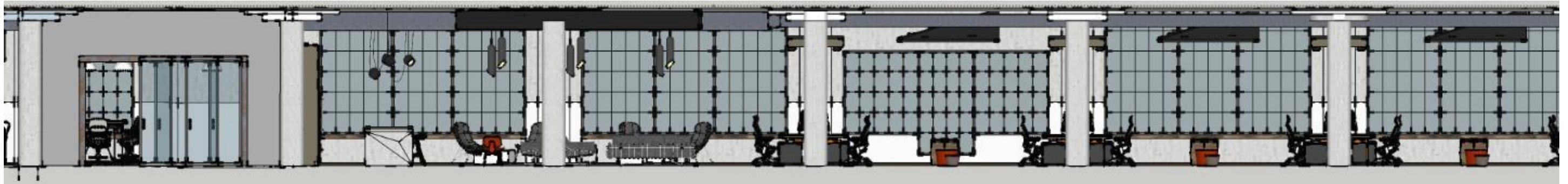

IDSN 3600 PORTFOLIO 3: ELEVATIONS
MATTHEW BRACKETT





IDSN 3600 PORTFOLIO 3: PERSPECTIVES: LOUNGE + KITCHEN
MATTHEW BRACKETT

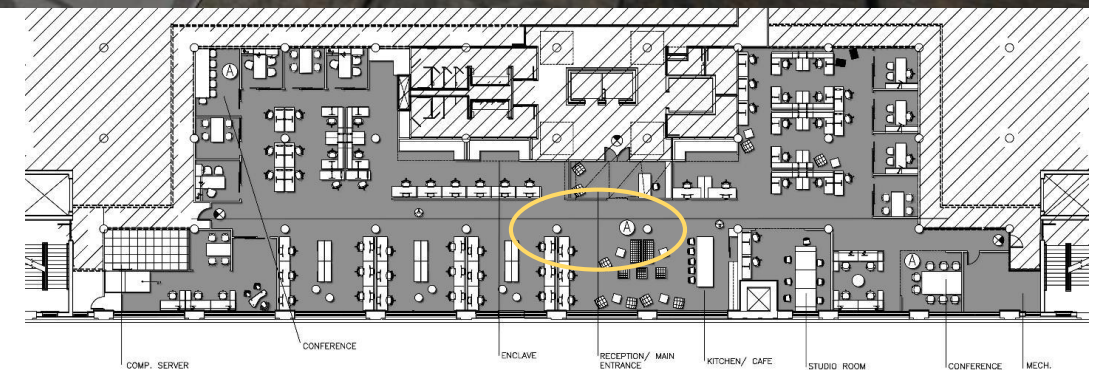



IDSN 3600 PORTFOLIO 3: PERSPECTIVES: OPEN WORK AREAS
MATTHEW BRACKETT

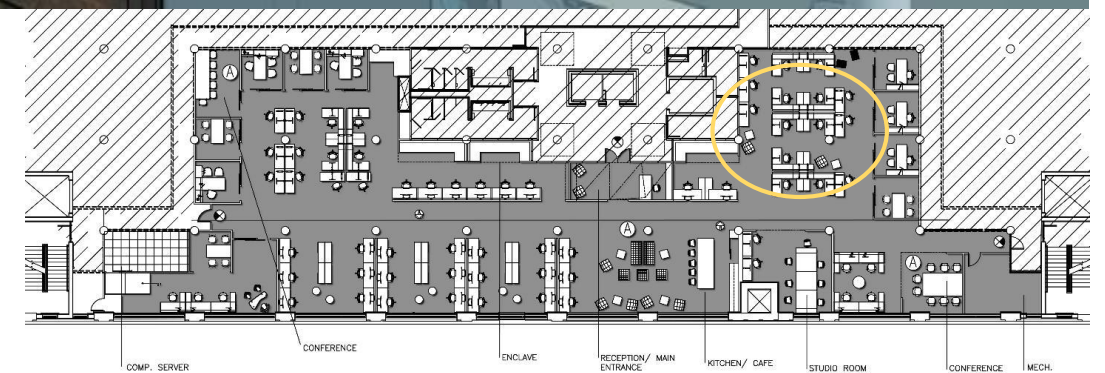



IDSN 3600 PORTFOLIO 3: PERSPECTIVES: RECEPTION
MATTHEW BRACKETT

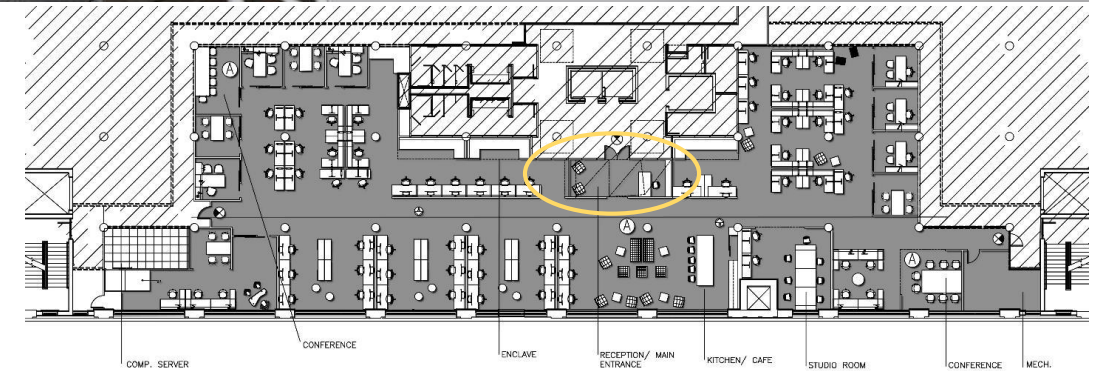



IDSN 3600 PORTFOLIO 3: PERSPECTIVES: MAIN CORRIDOR
MATTHEW BRACKETT

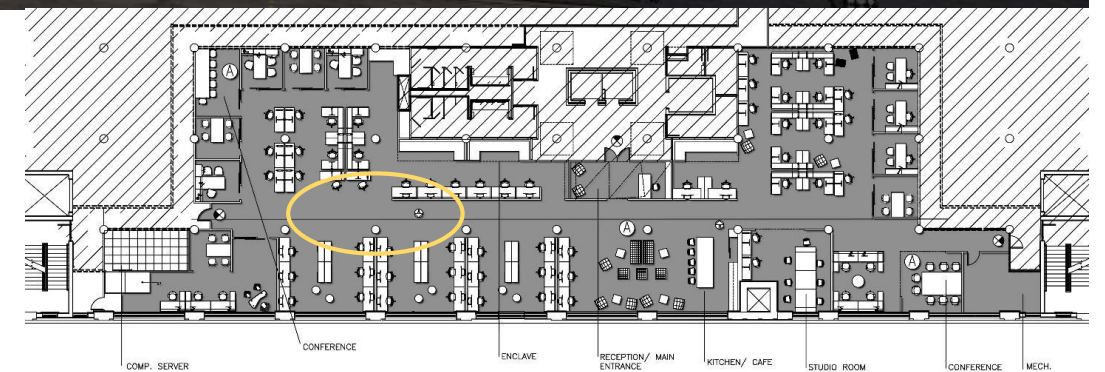

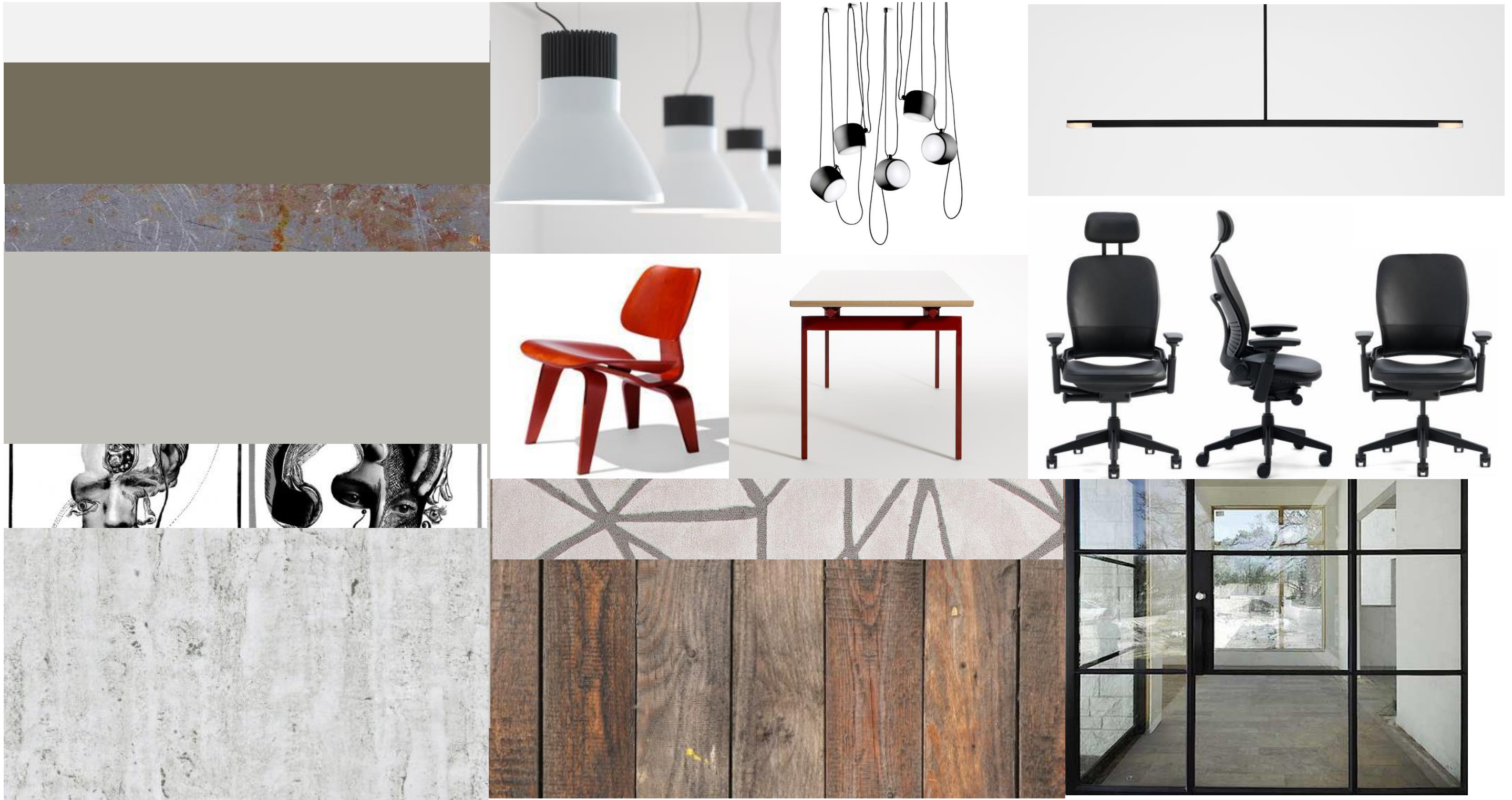

IDSN 3600 PORTFOLIO 3: FINISHES + MATERIALS

MATTHEW BRACKETT

