

A serene beach scene at sunset. The sun is low on the horizon, casting a warm, golden glow over the ocean and sky. Two lounge chairs are positioned on the sand in the foreground, facing the water. The overall atmosphere is peaceful and relaxing.

PORTFOLIO ONE  
PROGRAMMING  
ALEXIS ODETTTE  
IDSN 3102  
FALL 2019



# SENIOR PERCEPTION OF ADA IN SENIOR LIVING

As new developments arise, the interest of modern-day senior living is becoming more appealing to elders.

Designers and developers have a task of targeting this community by creating a functional, safe and appealing form of living for seniors.



## SENIOR PERCEPTIONS & OPINIONS

Many believe that not all accessible features are obvious in an ADA compliant space.

Seniors tend to want to live in a community, but still be independently living.

Reasonable accommodations such as elevators, ramps, grab bars, walk-in showers with benches, easy access, wall mounted sinks, and non-restrictive reach distances for the tenants.

Physically accessible to be mobile around their living space because of ADA requirements.

Many seniors believe that ADA makes Americans with disabilities feel welcome and not limited.

Elders want to feel included and a part of their community, so the building of these senior living housing complexes are starting to pop up in cities or suburban areas.

ADA accommodated buildings are more desirable to senior tenants, which attracts more potential residents.

<https://brailleworks.com/ada-makes-americans-disabilities-feel-welcome/>

## RESEARCH

Research has shown that the population is living longer which means more people will need assistance in their older years.

More than 30% of Americans over age 65 have some type of disability, and over 50% are over the age 75

Interior Design influences how seniors feel and can boost the morale of both residents and staff

ADA makes seniors feel more comfortable knowing that there are certain safety standards that have to be met

“People are experiencing more freedom, independence and dignity than their grandparents ever did” - [@Brailleworks](#)





# SENIOR LIVING CLIENT PROFILE

- The client is the developer
- The tenants of these condos will be the senior citizens
- Size range of the condo units will be between 1,500 and 3,000 square feet
- There will be 2 bedrooms and 2 bathrooms within these condo units
- At least one of the bathrooms are attached to a bedroom, and the other is potentially shared
- Special features with the condo units include a full kitchen, a walk-in closet, elevators, an outdoor space, a bath tub, washer and dryer units, a pantry, and a storage space, etc.
- There shall be one master suite with a master bathroom and a master closet – potentially a walk-in.
- The public spaces shall conclude one great room serving the purpose of a living room, dining room, and a kitchen.
- The preferred styles for the senior living market consists of traditional, contemporary, comfortable, and luxurious styles
- Other current trends consists of:
  - Whole complex- Gardens, gyms, pools, salons, dining spaces, and event rooms.
  - Individual units- Large kitchens, big windows, great rooms, gathering space/space for entertaining, outdoor space (patio, deck, etc.)

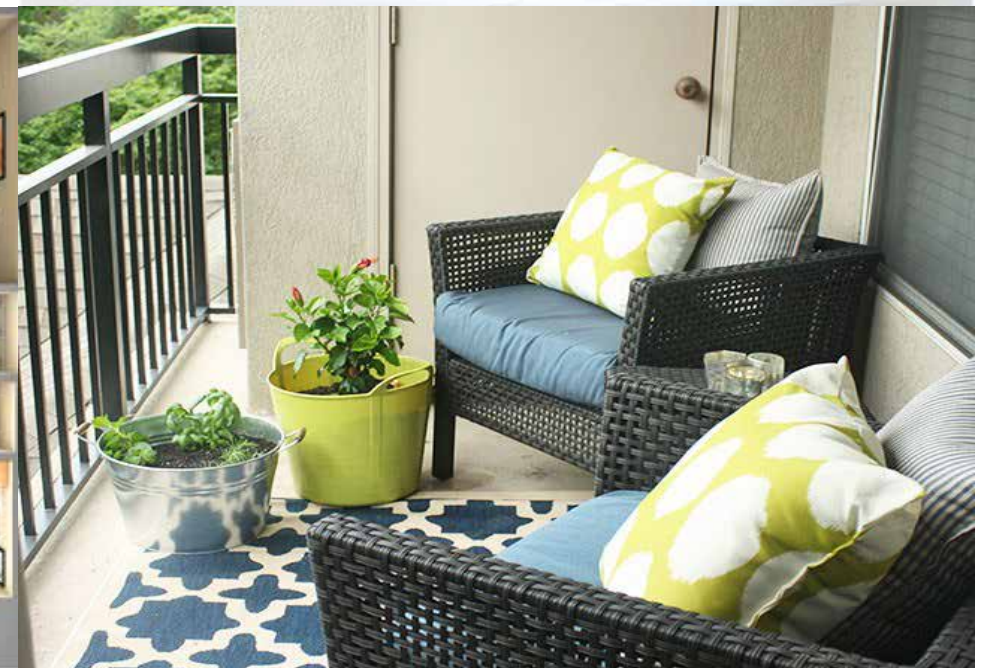



# Bubble Option

One



# Bubble Option

## Two



## SPACE STANDARDS

- This condo will be around **1530 SQ**
- 2 sleeping places at about 250 SQ each, totaling 500 SQ
- 2 places to cleanse and relief at about 120 SQ, totaling at 240 SQ Total
- 1 entertain at about 260 SQ
- 1 eat at about 180 SQ
- 1 cook at about 250 SQ
- 1 lounge at about 100 SQ

	All New Homes	By Home Size		
		Under 2,000 square feet	2,000-2,999 square feet	3,000 square feet plus
Master Bedroom	309	231	271	411
Other Bedrooms	481	261	416	713
Master Bathroom	160	115	144	210
Other Bathrooms	191	93	146	313
Laundry Room	102	67	87	145
Entry Foyer	101	65	89	138
Separate Kitchen	306	193	275	423
Separate Dining Room	216	148	196	281
Separate Living Room	330	256	319	393
Separate Family Room	404	311	355	503
Great Room	550	487	481	680
Other Finished Space	530	270	435	825
Closet Space	146	106	125	201
Walk-in Kitchen Pantry	37	17	31	51



# Block Option One

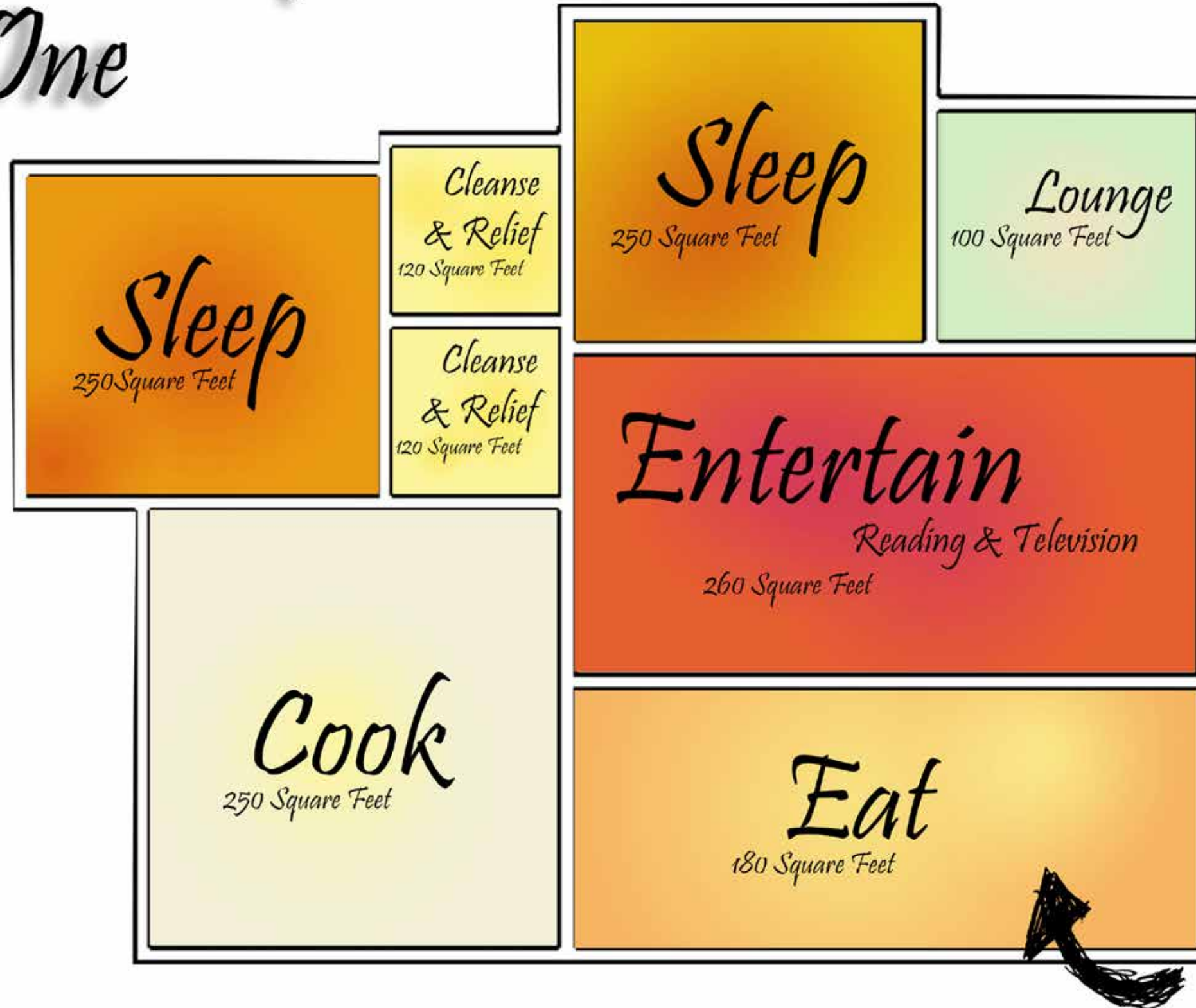

# Block Option Two

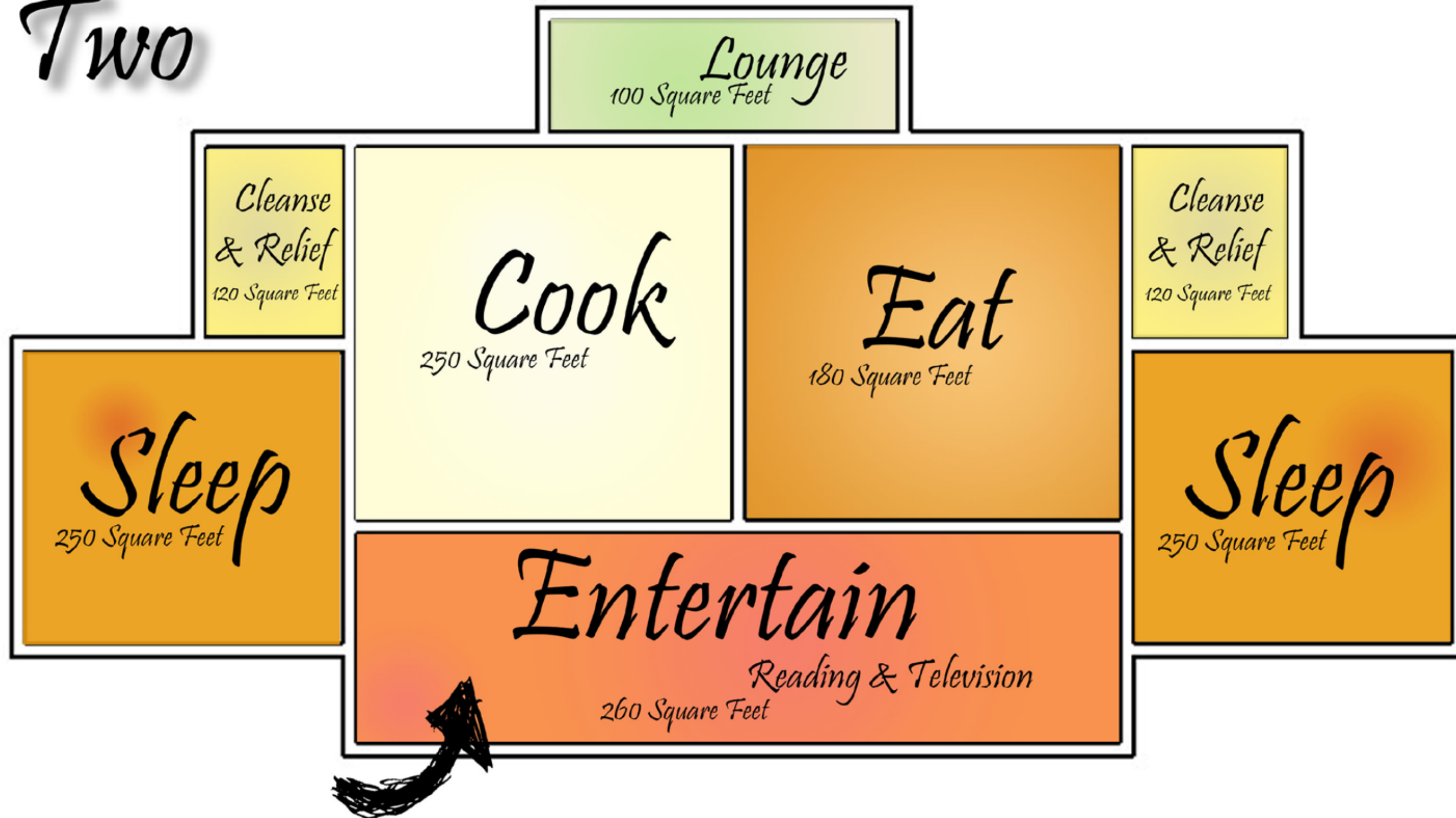



AFTER EVERY SUNSET, COMES A NEW SUNRISE



*Sunrise* • New beginnings  
• New experiences

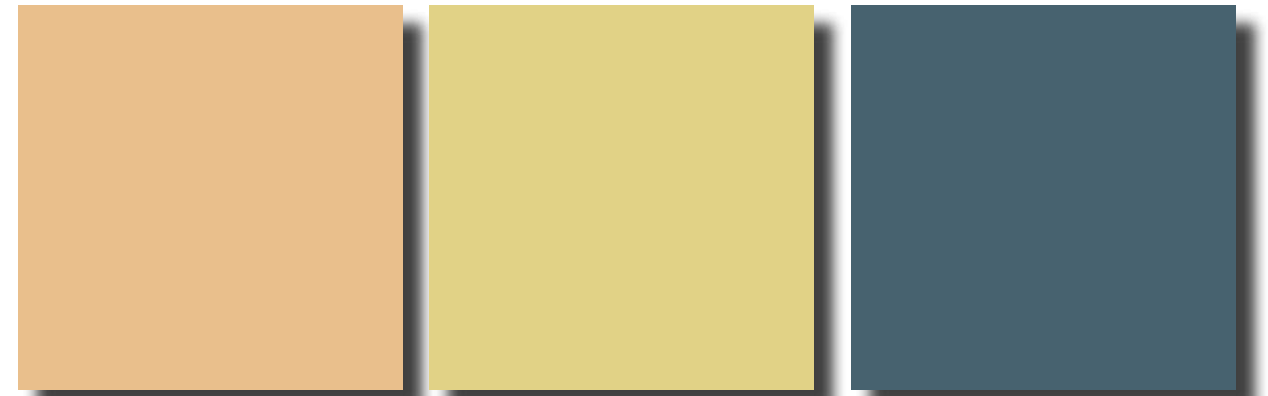

*&*

- Inviting
- Relaxing



*Sunset* • Ending of work/life balance  
• Reminiscence

