



PORTFOLIO III
FINAL SCHEMATICS

MARISA REINS
IDSN 3102

FURNITURE PLAN

APT 201



REFLECTED CEILING PLAN

APT 201

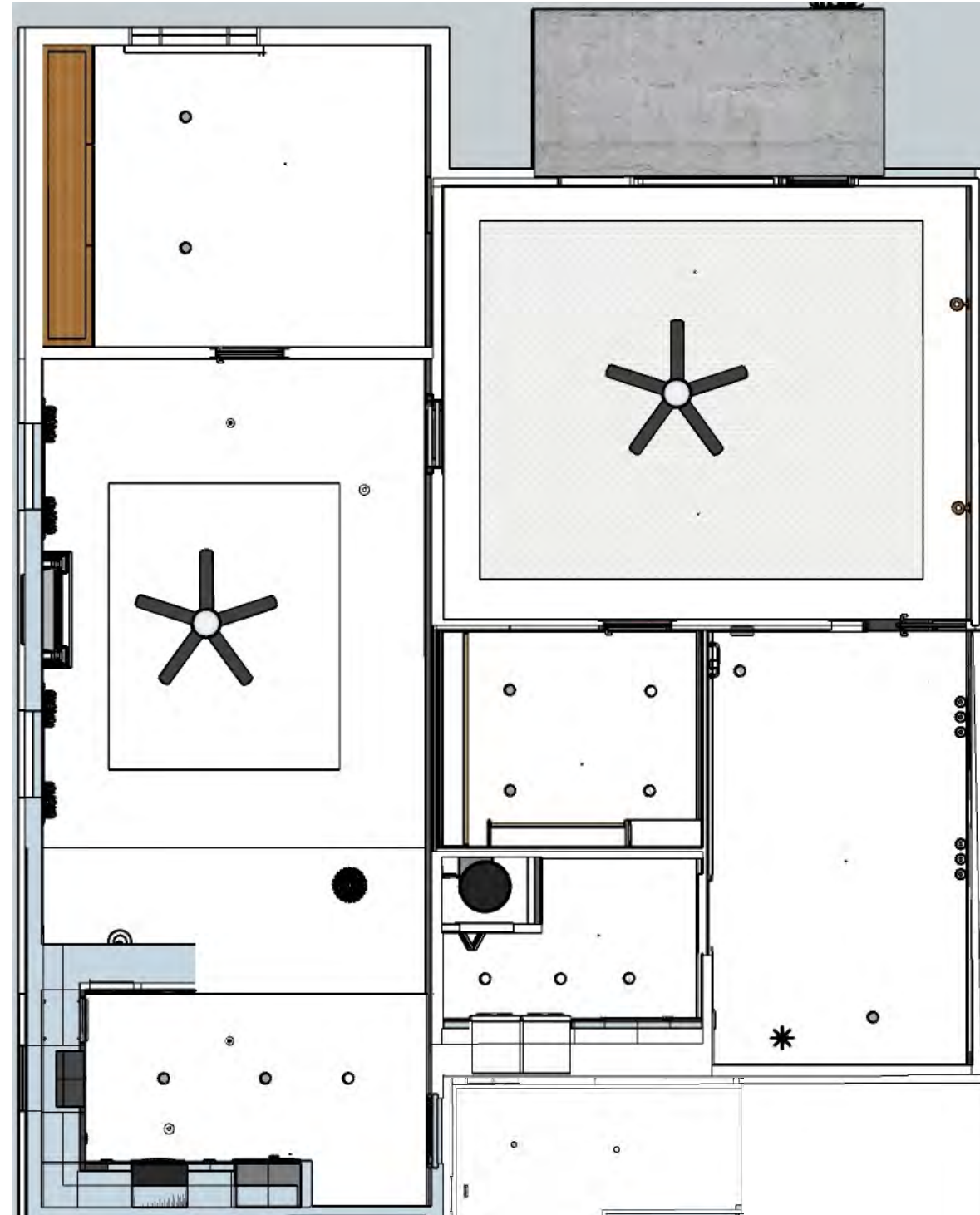

COLOR RATIONALE

VIENNA SECESSION

- Formal beginning of modern art in Austria
- Founded to promote innovation in contemporary art
- Focused on the introduction and use of purified and much simpler geometric forms, drawn by the neoclassical architecture
- Main use of three colors, specifically black, golden yellow, and red
- Emphasis on flat visual planes, high contrast, strong colors, patterned surfaces, and linear outlines

WALKTHROUGH

[HTTPS://VIMEO.COM/374664398](https://vimeo.com/374664398)



RENDERED PERSPECTIVES

ENTRY & DINING



FURNITURE AND FINISHES

ENTRY & DINING

OPTION 1

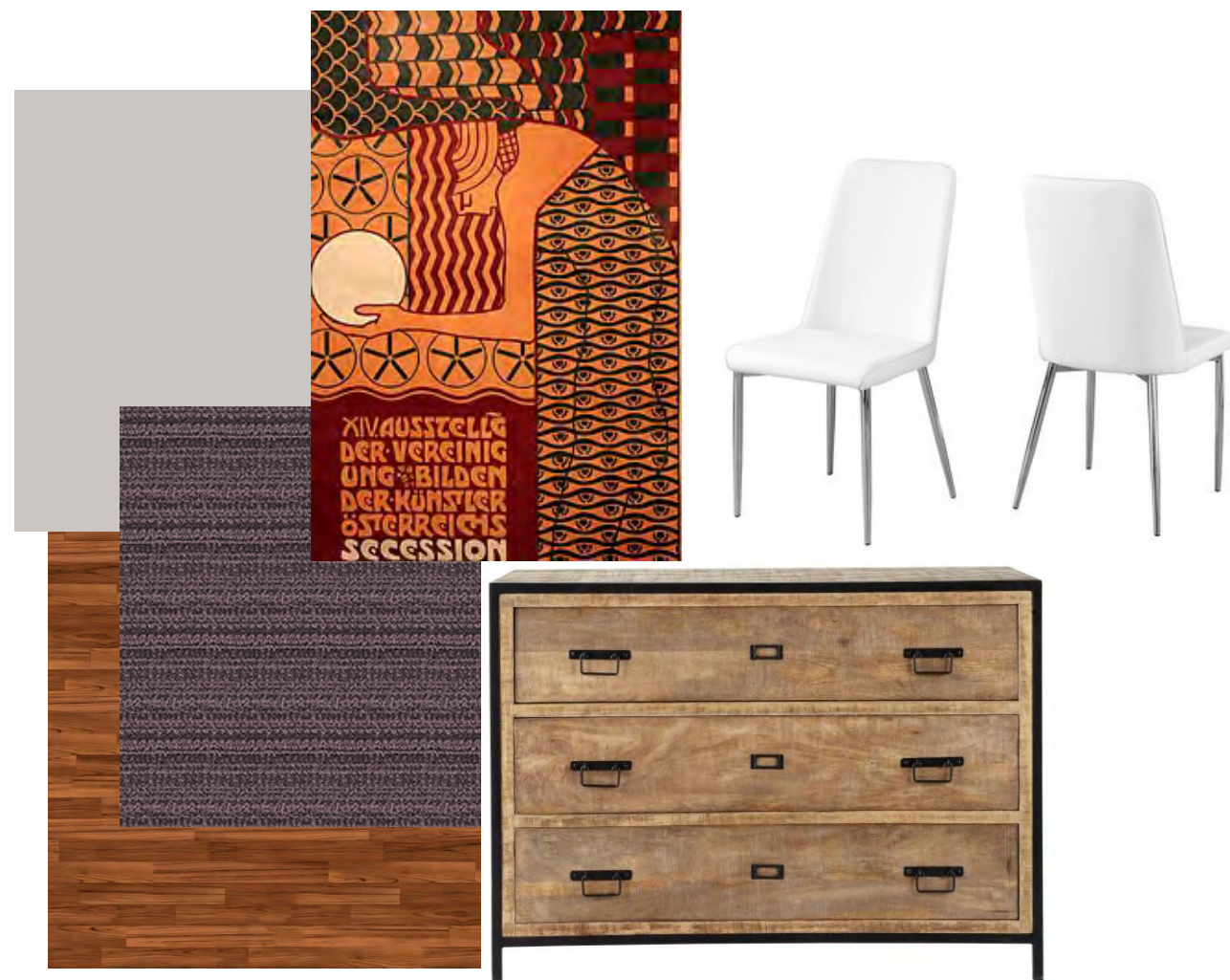

OPTION 2



RENDERED PERSPECTIVES

KITCHEN



FURNITURE AND FINISHES

KITCHEN

OPTION 1



OPTION 2



RENDERED PERSPECTIVES

LIVING ROOM



FURNITURE AND FINISHES

LIVING ROOM

OPTION 1



OPTION 2



RENDERED PERSPECTIVES

MASTER BEDROOM



FURNITURE AND FINISHES

MASTER BEDROOM

OPTION 1

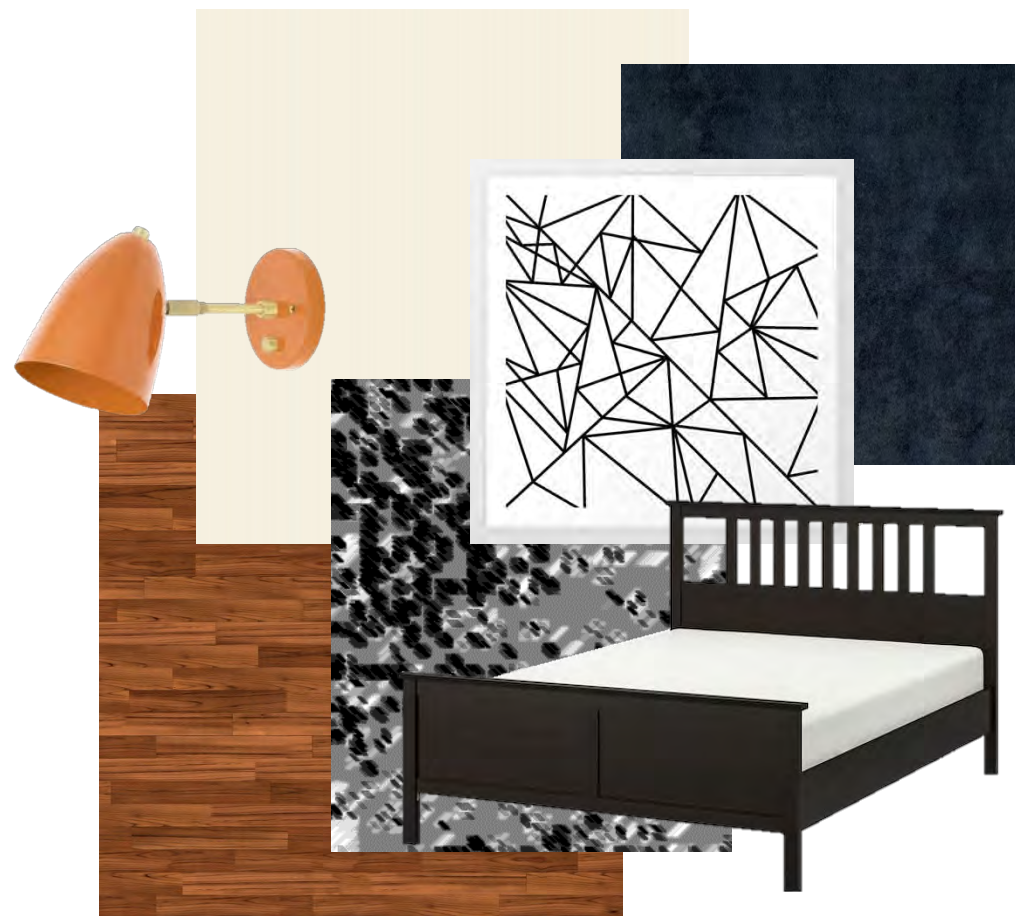

OPTION 2



ANTHROPOMETRIC & ERGONOMIC

Anthropometric was used all around the apartment but specifically in the Office. The Josef Hoffman chair has been modified to adjust to different heights for comfortability.



Monitor should be 16-29 inches away from your eyes and monitor's top line should be in line with your eyes



Drape your hand over the mouse and hold it lightly. Click as gently as possible. Keep your wrists straight and flat with your hands, wrists and forearm parallel to the floor

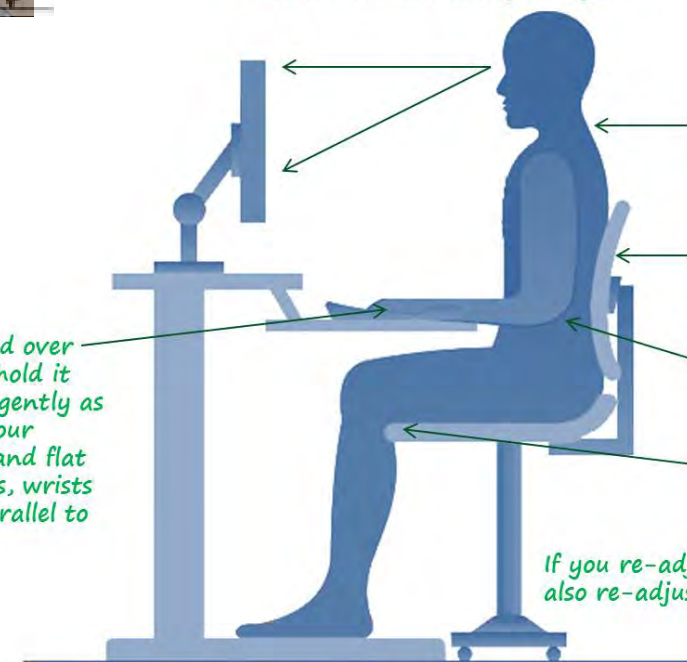

Keep your head and body straight with shoulders relaxed

Adjust your chair's backrest such that the curve of the chair matches with curve of your back

Keep elbows close to your sides

Exert only slight pressure at the end of the cushion

If you re-adjust height of your chair, also re-adjust your monitor

Keep your feet flat on the floor