



PORTFOLIO 1

IDSN 3102-1
JORDAN MCLEOD

RESEARCH: SOCIAL DISTANCING

- What is social distancing?
 - Maintaining 6 ft from anyone around you
 - Avoiding large gatherings
- What is the goal?
 - To flatten the curve of cases so as not to overwhelm health care systems
- How does it help?
 - Contagious diseases are often spread through coughing, sneezing, and being in close contact with others
- How do we know it works?
 - The Spanish flu
 - Philadelphia: Cases reported September 17, 1918. Social distancing implemented October 3rd. Peak weekly excess pneumonia and influenza (P&I) death rate of 257/100,000.
 - Saint Louis: Cases reported October 5th. Social distancing implemented October 7th. Peak P&I death rate of 31/100,000.
- How to implement?
 - Proper signage (6 ft stickers providing separation, arrows on ground)
 - Easy wayfinding (separate paths of entry and exit)
 - Wide corridors
 - Separated seating (6ft)
 - Reminders from employees/loudspeaker to remain 6 ft apart
 - Bonus: sanitizing stations





STAKEHOLDER PROFILES

- Owner/Client
 - The Overton Group/Teknion Furniture
 - A space that complies with suggestions made by the CDC in terms of disease control
 - A variety of options to switch up the space for the unpredictability we face in the future.
- User
 - Potential Teknion clientele, the Greenville community
 - A clean and safe location to view/buy furniture
 - A specific area designated for social or business events
 - Openness and easy navigation
 - Sanitizing stations

SITE PROFILE

◦ Location: 201 E. 5th street



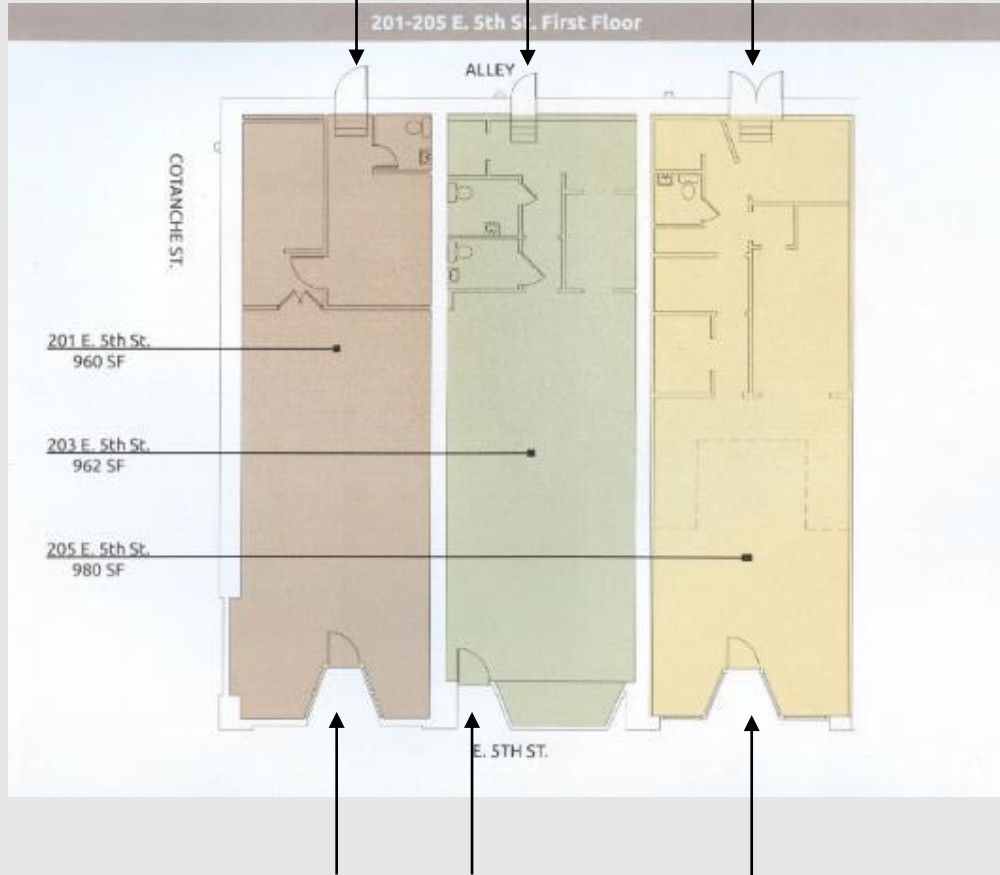

SITE ANALYSIS



- April-September = most daylight in Greenville, NC.
- The latest sunset: 8:30 pm
- Earliest sunset: 5-6 pm
- Most sunlight would come in at the front of the building through the entry doors and windows.
- Most sun would come in from Fifth Street and Cotanche Street.

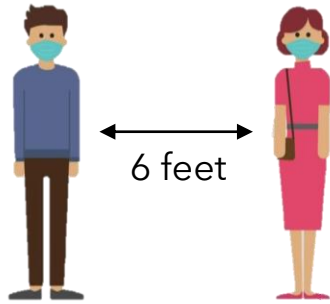

PROBLEM STATEMENT

1. Socially distancing concerns are a major issue faced with this design. Unpredictability in the USA calls for a space with variability and openness to combat pandemic related issues we face today and may face in the future.
2. Daylighting could be problematic due to the building's depth.

Citations

- [https://www.pnas.org/content/104/18/7582#:~:text=Louis%20faced.,period\)%20of%20719%2F100%2C000.&text=Louis%2C%20September%208%E2%80%93December%2028%2C%201918](https://www.pnas.org/content/104/18/7582#:~:text=Louis%20faced.,period)%20of%20719%2F100%2C000.&text=Louis%2C%20September%208%E2%80%93December%2028%2C%201918).
- <https://www.conehealth.com/services/primary-care/social-distancing-faq-how-it-helps-prevent-covid-19-coronavirus-/>