

SCARLETT SALTER
NICOLE THOMAS
LISA DUERR

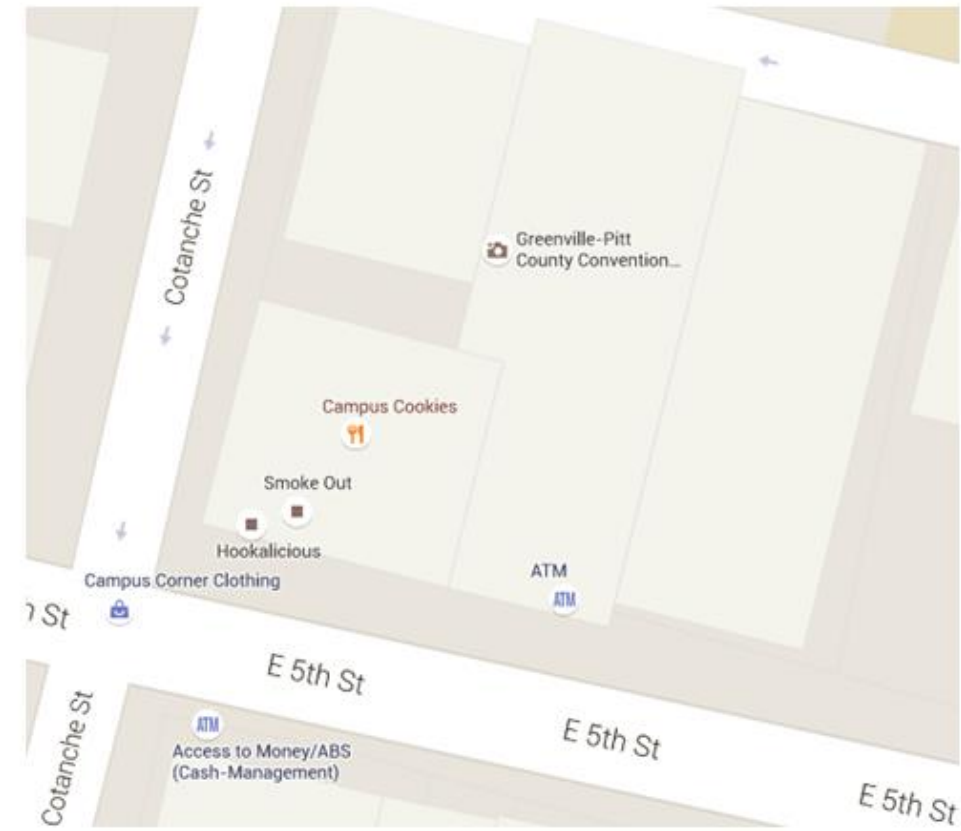

LOCATION

The proposed placing of the retail shops will provide an optimal location for the business. The high traffic area will generate interest and because of its location in uptown Greenville, it will attract members of the community of all ages and occupations.



URBAN CENTERS

-For large urban centers, there must be a lot of shops to attract enough activity in the area. These are places where people can spend an entire day shopping because there large variety of shops.

-There must be a clear shopping stroll for shoppers to have a path to walk on when they are not in the stores. It creates a better experience for the shoppers.

-Multiple store entries

-Create a center. It is good to have a meeting place, or a common area for people to gather and sit down or talk. This should be located in the center of the retail shops so that from each store there is easy accessibility to the center.

-Group food and entertainment together. If the space is large, it is good to have a food court of some sort to ensure that shoppers will stay longer.

<http://www.placemakers.com/2012/04/05/designing-regional-urban-retail-centers-lessons-from-the-mall-and-beyond/>



SMALL TOWN

-It is important to have good signage around the area, indicating the retail space.

-it must be easy to navigate. Critical for small, local stores; it should be easy for the shopper to read the store and quickly identify the separate product areas. The advantage of a small store is the simplicity of store layout. If customers immediately can find what they want, they feel familiar with and comfortable in the store.

-Wide shopping aisles along with attractive product displays were also important features of the store environment for small-town consumers. Having sufficient personal space is important to people.

-The right merchandise displayed in an attractive manner can draw customers into the store.

-Colorcoordinated groupings can draw the customer from one area of the store to another. The more merchandise the consumer is able to see and touch, the more likely they are to purchase.

-The community connectedness of the local store was important to small-town consumers when shopping at local stores. These consumers considered both a retailer's support for local community events as well as the retailer's financial or technical assistance to community organizations or schools.

-The check-out counter should be located where the store staff can see customers and customers can see the staff in order to increase the staff's ability to watch and help customers.

http://rs.informedesign.org/_news/jun_v05r-p.pdf



FIXTURES

“Products should be displayed at comfortable heights and viewing angles with adequate lighting. Consumers should be able to see the entire product, not just stacks of inventory or ‘sleeves and shoulders’.”

<http://kelley.iu.edu/CERR/files/shoppability.pdf>

In today’s society, mannequins have stayed the same, with a woman’s size 2 being the industry standard, although the average American woman’s body size gotten larger through the years (Kim & Damhorst, 2010). These size 2 mannequins are based on a typical fashion model in today’s society who usually wears a size 0 -2 and weighs 23% less than the average woman.

<http://scholarcommons.sc.edu/cgi/viewcontent.cgi?article=3601&context=etd>

Most advances in cash register technology come from the POS end of the industry, where large users such as giant chain retailers can take advantage of economies of scale and employ sophisticated new software or hardware. Much of this technology eventually trickles down into ECR manufacturing. Communications between registers was once an advanced feature, but it is becoming standard even on mid-level machines. Cash register software is constantly evolving in response to pressure from customers.

http://www.encyclopedia.com/topic/Cash_Register.aspx



Fixtures:

<http://buyersguide.designretailonline.com/category/fixtures>

Fixtures in Display Cases:

-xenon, microfluorescent fixtures, LED light bars, downlights, and light strips.

SYSTEM SKETCH AND FINAL

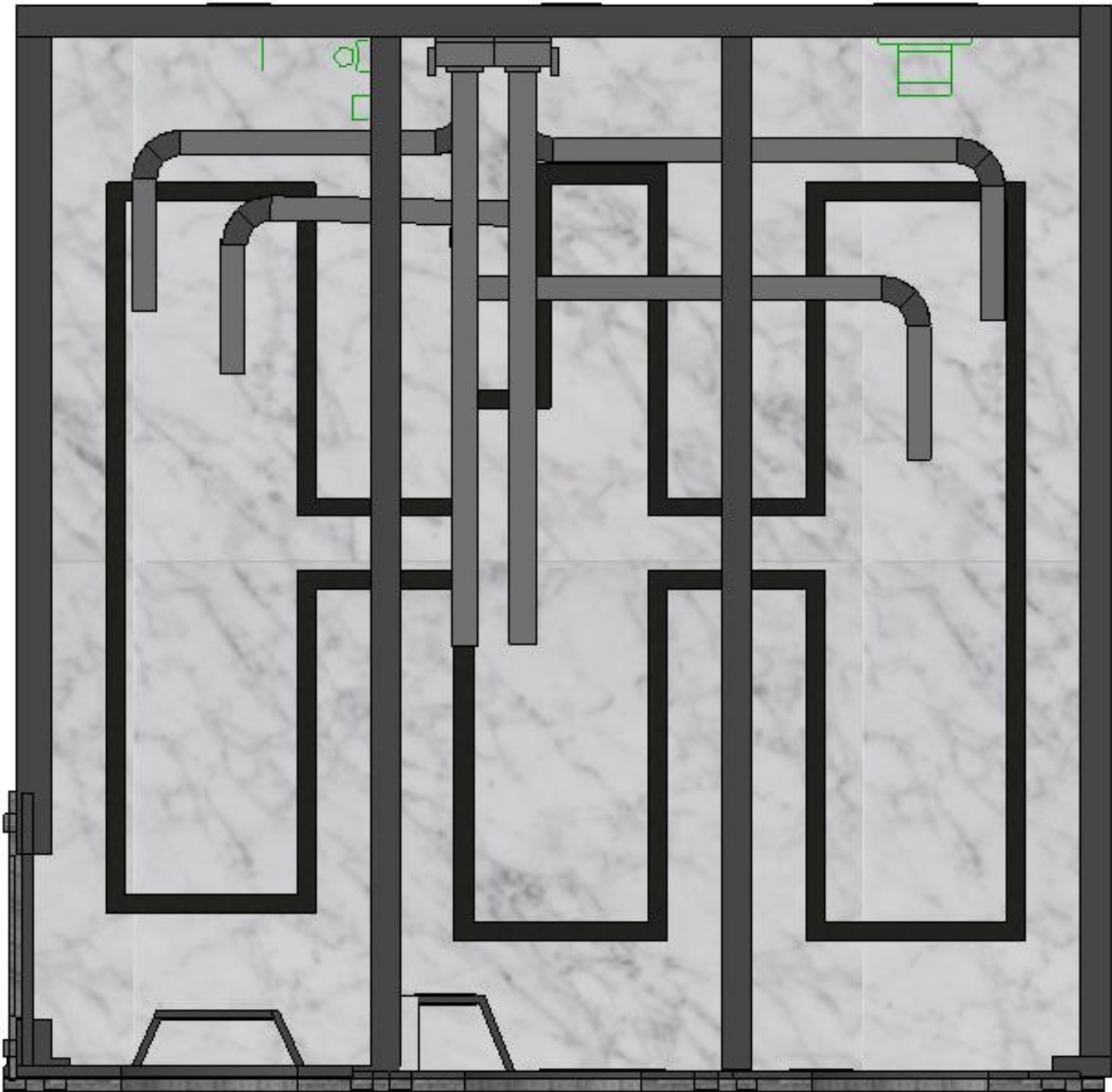

CONCEPT STATEMENT FOR PURPLE AND GOLD STORE

- Targeting females in the search of upper end apparel and dorm room supplies.
- Apparel, jewelry, room décor, room furnishings, and accessories.
- More on the higher end side; rather than jerseys and sportswear.
- Similar to a boutique.
- Bright and modern design.



SKETCHES

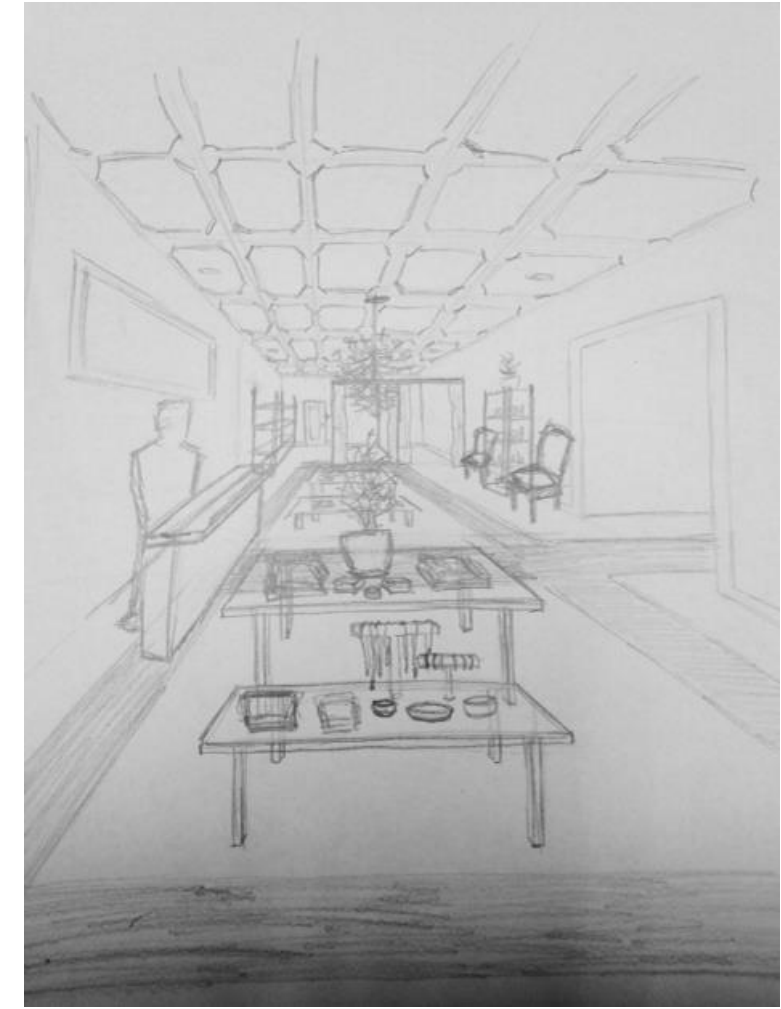
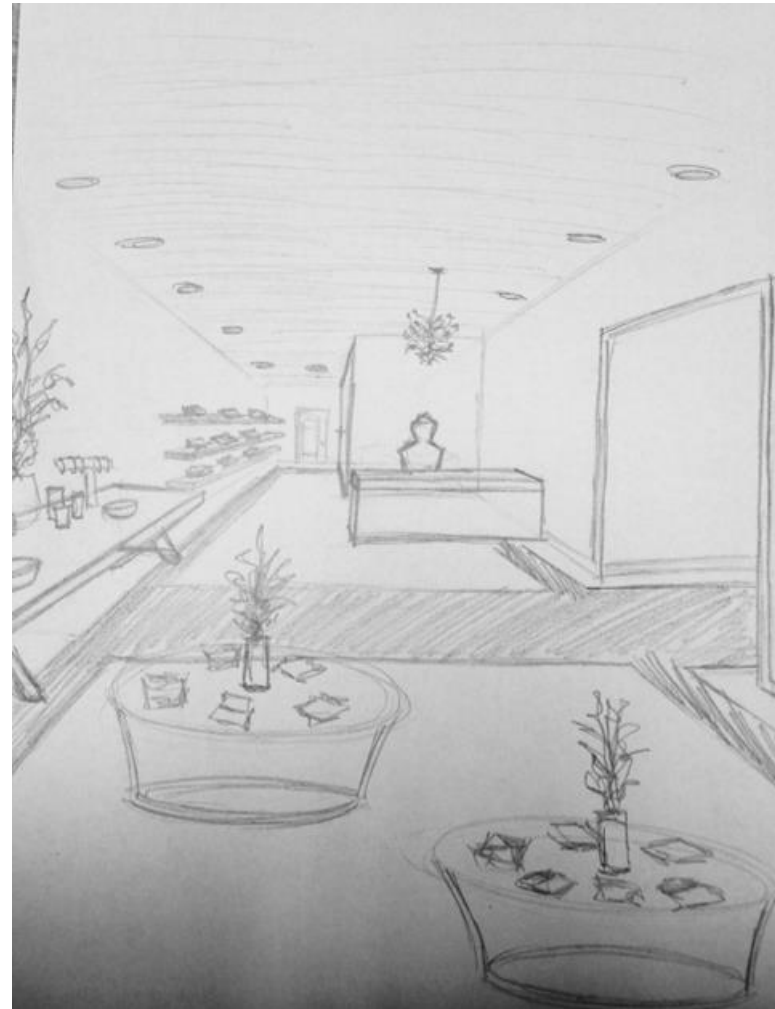
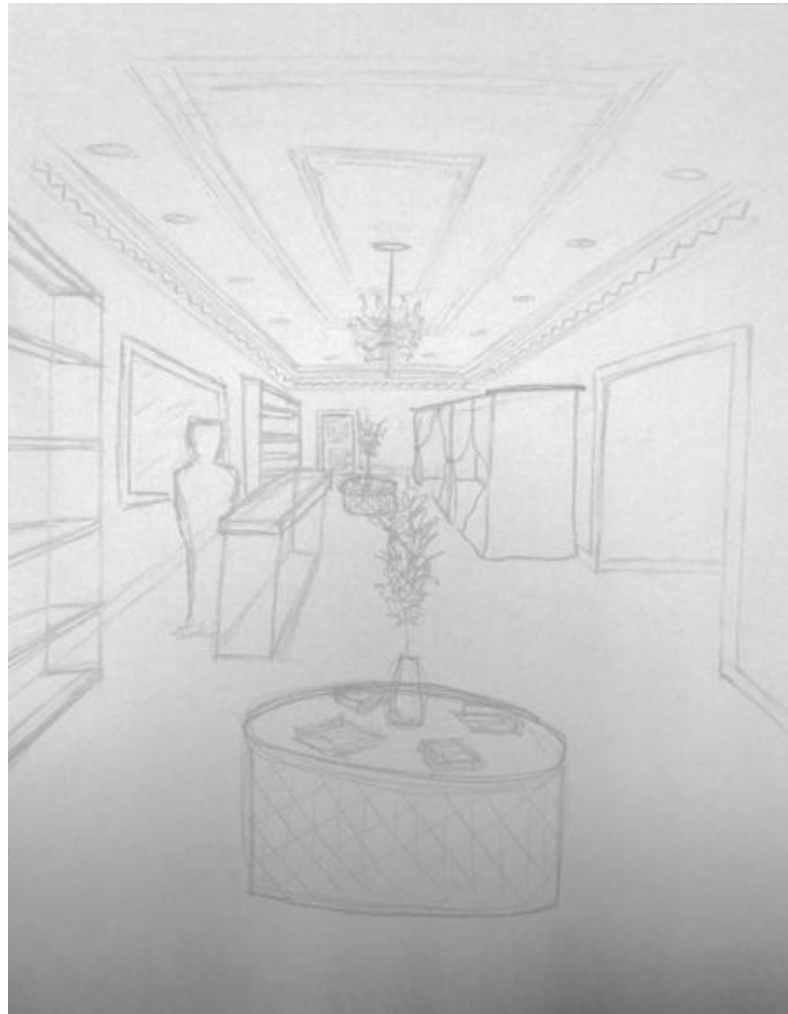

FINISHES AND FIXTURES

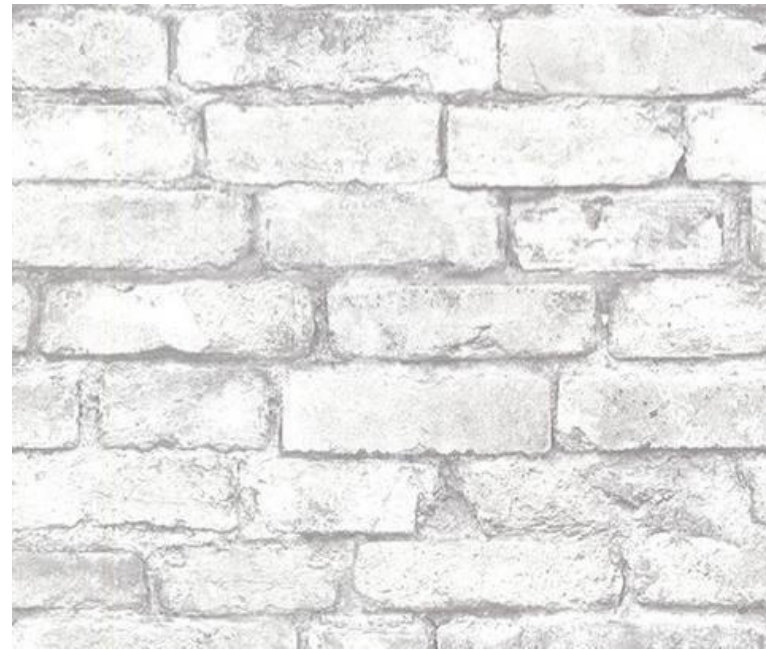

LIGHTING

Mason Glass Globe Filament Pendant

Dimensions

- Overall: 11" diam., 13¼"H
- Chain: 74¾"L
- Ceiling plate: 6" diam., 4"H
- Weight: 6 lbs.
- Cast of clear glass
- Blackened iron fittings have a matte finish
- Uses one 40W max. incandescent Edison bulb, such as our Exposition Quad Loop Small Bulb (included)
- Dry UL listed: suitable for use indoors in dry locations not directly exposed to excessive moisture and water
- Hardwire
- Chain included
- Imported



Product dimensions

Diameter: 22 "
Cord length: 4 ' 7 "

Diameter: 55 cm
Cord length: 1.4 m

This product requires assembly

Instructions & other documents

Downloads for this product:
[Assembly instructions](#)

Key features

- Projects decorative patterns onto the ceiling and on the wall.

Designer:

Marcus Arvonen

Package measurements and weight

Article Number: 701.904.50
Package: 1

Width: 9 ¼ " (25 cm)
Height: 5 " (13 cm)
Length: 19 ¼ " (49 cm)
Weight: 2 lb 14 oz (1.31 kg)

People & Planet

Special waste handling may be required. Please contact your local authorities for more information.

Good to know

Can be connected to the IKEA 365+ SANDA track system.
Use a clear light bulb if you have a lamp shade or lamp with a perforated or cut-out pattern or other airy, open design and want the pattern to cast effects on the wall and ceiling.
Use an opal light bulb if you have an ordinary lamp shade or lamp and want an even, diffused distribution of light.

Care instructions

Wipe clean with a dry cloth.

Product description

Ceiling cup: Polypropylene
Tube: Steel, Nickel plated
Clips: ABS plastic
Shade: Polyethylene
Arm: Stainless steel



LIGHTING

- LED spotlight with stabilized color temperature.
- Optimized for efficient and high-performance accent lighting in shops and salesrooms
- Passive cooling achieved by innovative thermal design
- Includes converter in separate polycarbonate trackbox adapter
- Spotlight head rotates through 360°, pivots through 90°
- Die-cast aluminum spotlight housing.
- Finish: matte black or white microtextured paint.
- Black polycarbonate front ring provides excellent glare control
- Front ring serves for accommodation of accessories
- Specular reflector of aluminized PC, highly specular, iridescence-free.
- 50000 h service life at 80 % luminous flux
- 3000K and 4000K available
- 90+ CRI
- Luminaire luminous flux: 1600-3200 lm.
- Luminaire efficiency: 80-90 lm/w
- Installed load: 27 W
- Must only be installed horizontally on the wall
- Not suitable for point outlets
- Trackhead for use with EUTRAC track system. See separate EUTRAC spec sheet for more information. FIF1176, FIF11 and FIF1178

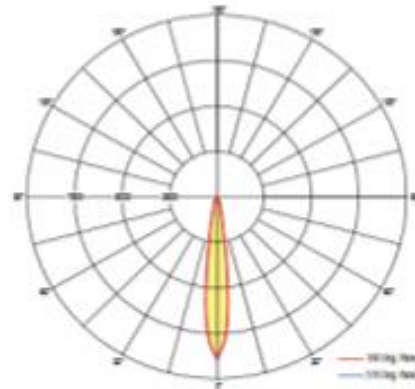

LUMINANCE DATA (cd/m²)				
Horizontal plane				
Beam angle	0°	30°	60°	90°
0°	1800	1800	1800	1800
5°	1800	1800	1800	1800
10°	1800	1800	1800	1800
15°	1800	1800	1800	1800
20°	1800	1800	1800	1800
25°	1800	1800	1800	1800
30°	1800	1800	1800	1800
35°	1800	1800	1800	1800
40°	1800	1800	1800	1800
45°	1800	1800	1800	1800

COEFFICIENTS OF UTILIZATION - ZONAL CAVITY METHOD																		
Effective Floor Cavity Reflectance 0.20																		
RC	80	70	60	50	40	30	20	10	0	80	70	60	50	40	30	20	10	0
RW	70	50	30	10	70	50	30	10	50	30	10	50	30	10	50	30	10	0
0	121	121	121	121	118	118	118	118	113	113	113	108	108	108	103	103	103	101
1	117	115	113	111	114	113	111	109	109	107	106	105	104	103	101	101	100	98
2	113	110	107	104	111	108	105	103	105	103	101	102	100	99	99	98	97	95
3	110	105	102	99	108	104	101	98	102	99	97	99	97	95	97	95	94	93
4	107	102	98	95	105	100	97	94	99	96	93	97	94	92	95	93	91	90
5	104	98	94	91	102	97	94	91	96	93	90	94	92	89	93	91	89	88
6	101	95	91	88	100	94	91	88	93	90	87	92	89	87	91	88	86	85
7	98	92	88	86	97	92	88	85	91	87	85	90	87	85	89	86	84	83
8	96	90	86	83	95	89	86	83	88	85	83	88	85	83	87	84	82	81
9	94	88	84	81	93	87	84	81	86	83	81	86	83	81	85	82	80	79
10	92	85	82	79	91	85	82	79	84	81	79	84	81	79	83	81	79	78



VIVO M LED

Applications: The VIVO M LED spotlight is designed for attractive illumination of retail spaces and is available with various lumen output levels. It is a very efficient alternative to conventional HD spotlights. For use with EUTRAC™ system. See separate spec sheet.

Type: _____

Project: _____

Online Find It Fast
1160

VIVO MEDIUM

VIVO MEDIUM LED SPOTLIGHT							
VIVOM				90			
FIXTURE	LUMEN OUTPUT	CCT	BEAM SPREAD	CRI	FINISH	ADAPTER	DRIVER
VIVOM Medium Spotlight	1600 lm 2800 lm	K30 3000K	FL Flood SP Spot WF Wide Flood	90 90+ CRI	WH White BK Black	EU11 1 Circuit 120V EU21 2 Circuit 120V EU22 2 Circuit 277V	SW Non-dimming SWITCHED DT Line DIMMING (120V only)
	1800 lm 3200 lm	K40 4000K				EU11C 1 Circuit 120V Control EU21C 2 Circuit 120V Control	DA 1-10V Dimming DD DALI Dimming DH Lutron Hi Lume DS Lutron S-Series Dimming, 5%
	2400 lm	TG TGR*					

VIVO MEDIUM ACCESSORIES

OPTIONS

- 60700343 Soft outline lens (blue lens)
- 60700275 Interchangeable reflector, flood
- 60700274 Interchangeable reflector, spot
- 60700278 Replacement reflector, wide flood
- 60700342 Black Anti-glare ring
- 60700345 Interchangeable reflector with high-contrast aperture
- 60700344 Oval Outline Lens 50°

Dimensional Data

Back : Spotlight Horizontal

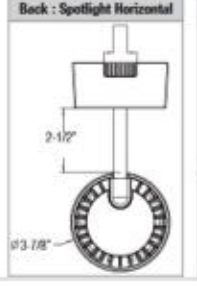

Side : Spotlight Horizontal



Side : Spotlight Vertical



Photometric Data

VIVO M, Spot Beam, 36W, 4000K
VIVOM3200K40SP90WHEU115W
Efficiency = 88 lm/W

FLOOR PLAN

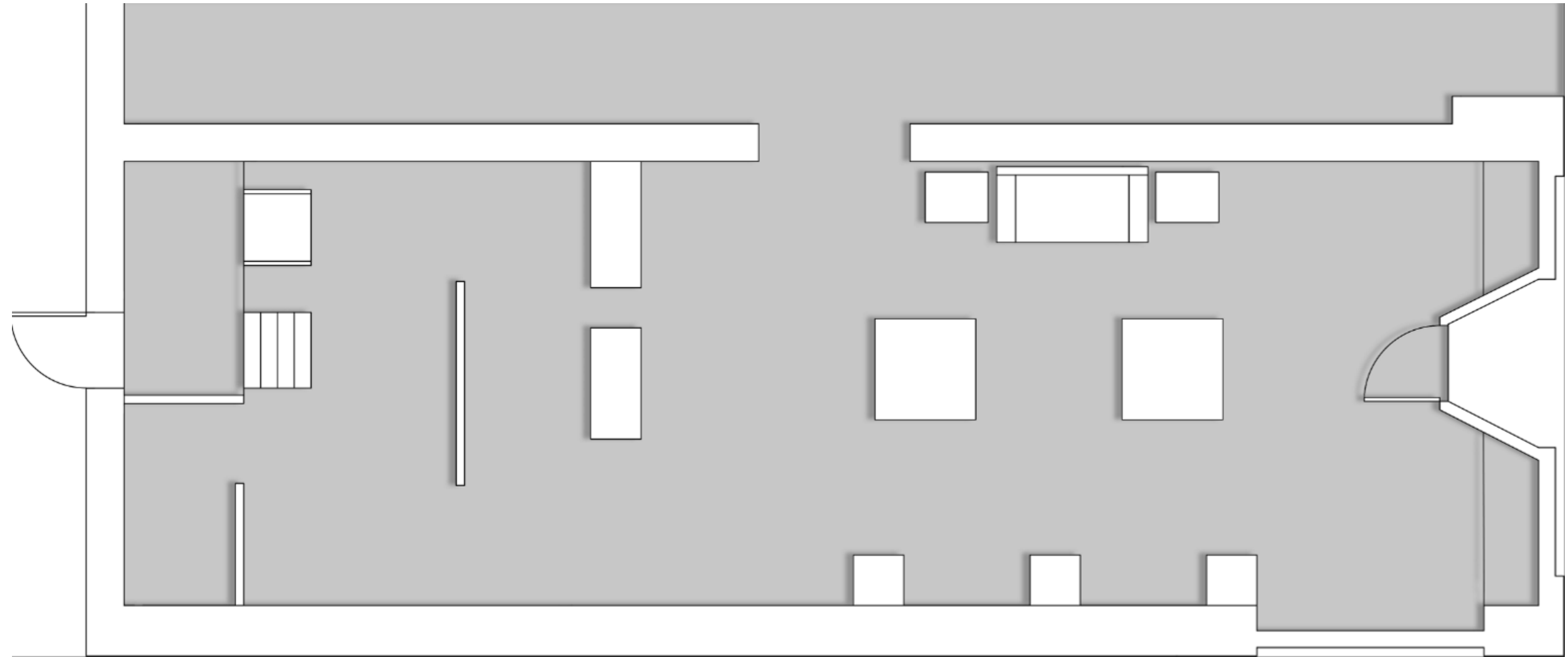

REFLECTED CEILING PLAN

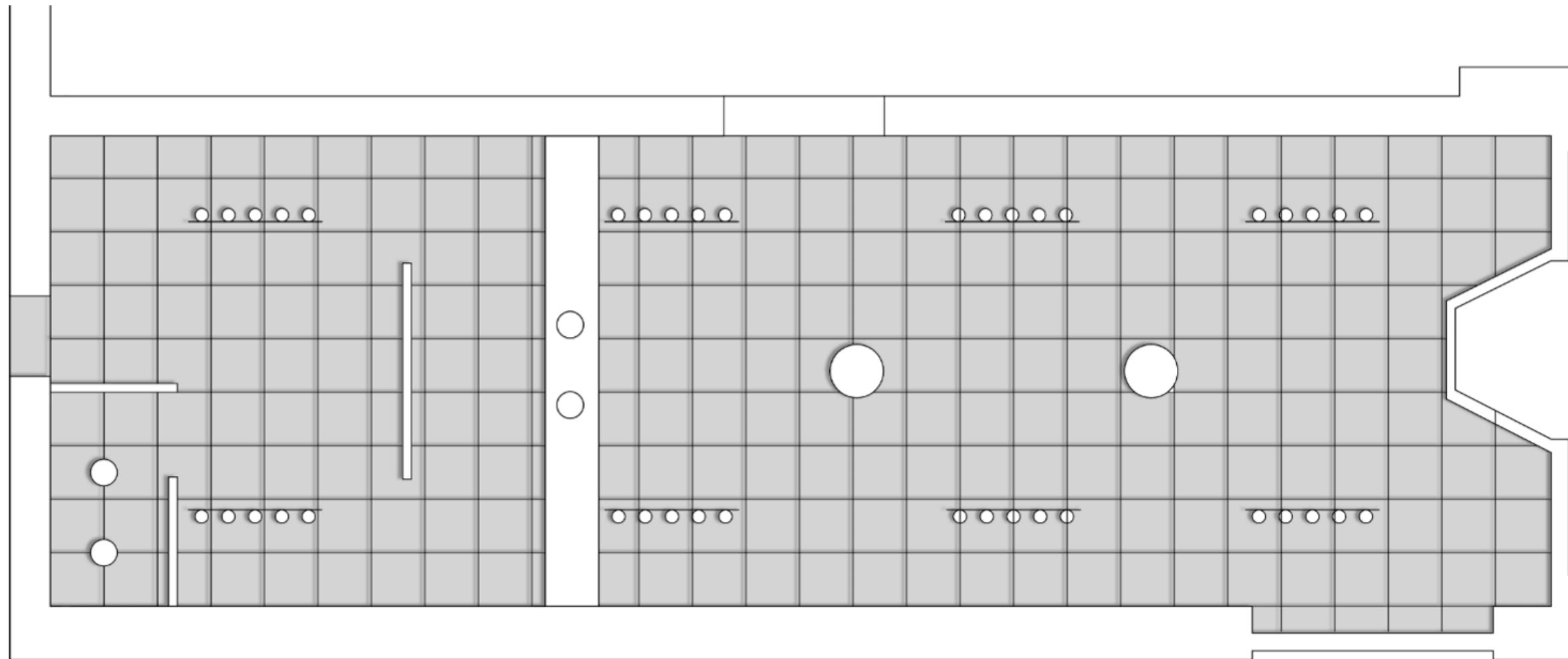

VIEW 1



VIEW 2



VIEW 3



CONCEPT STATEMENT FOR URBAN FITNESS

- ICE – shape, texture, color, appearance.
- This retail space will have clean, crisp lines, and high reflectance surfaces that will pair well with the private label athletic wear being sold in the space.



SPACE PLANNING

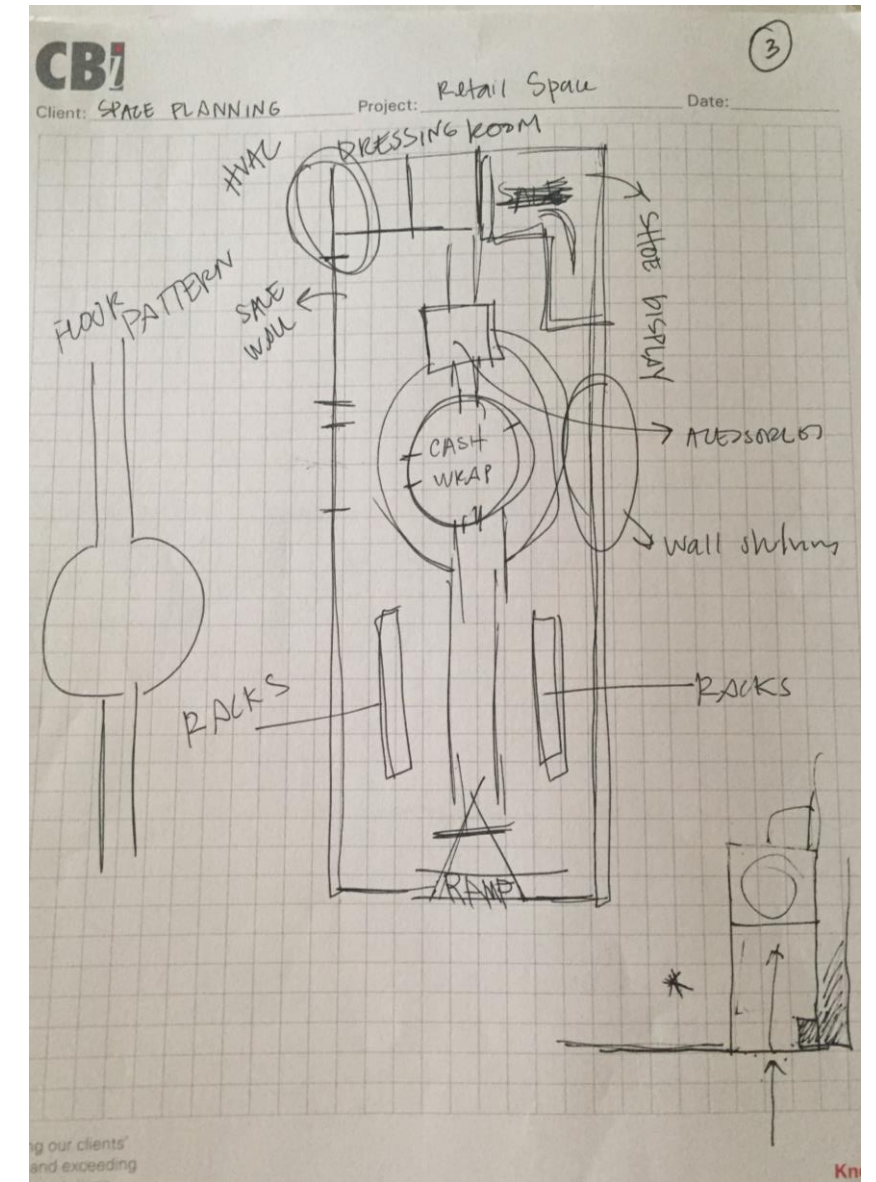
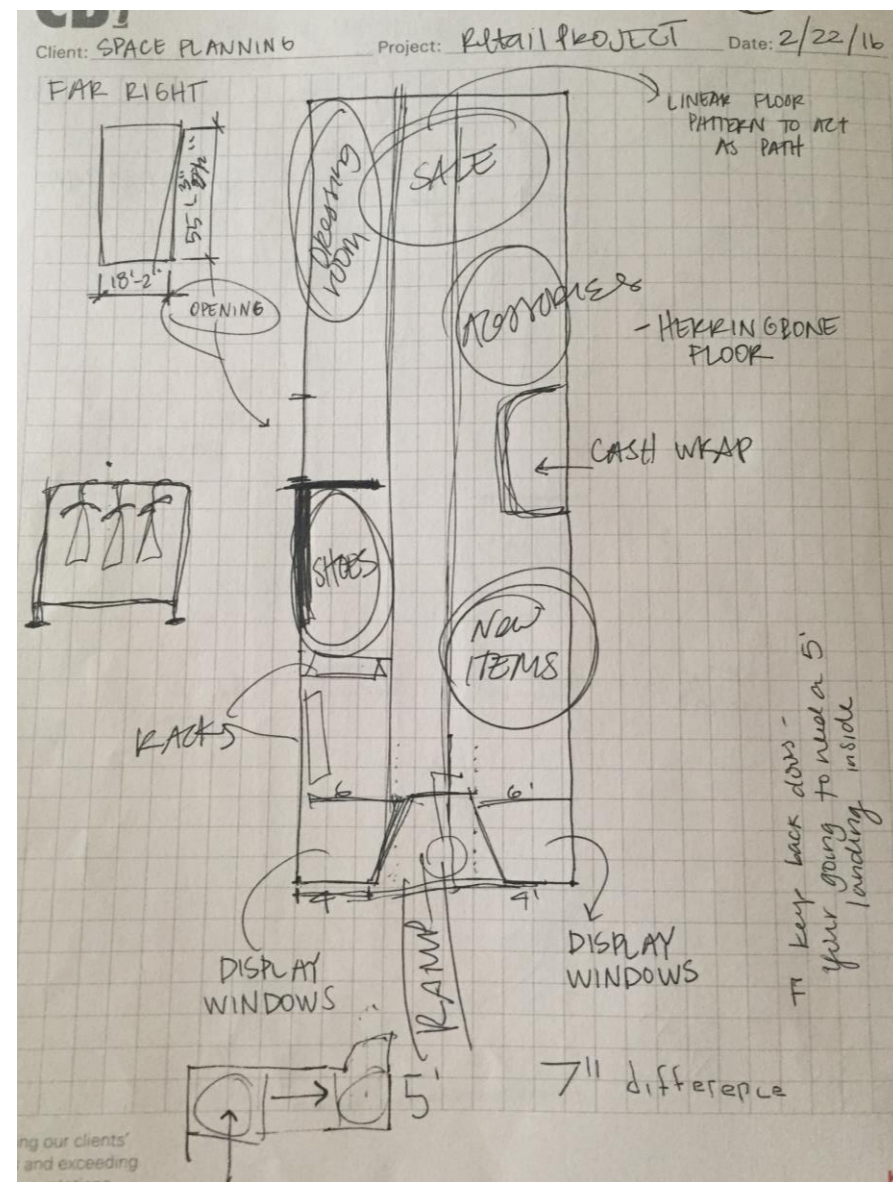

BLOCKING DIAGRAMS

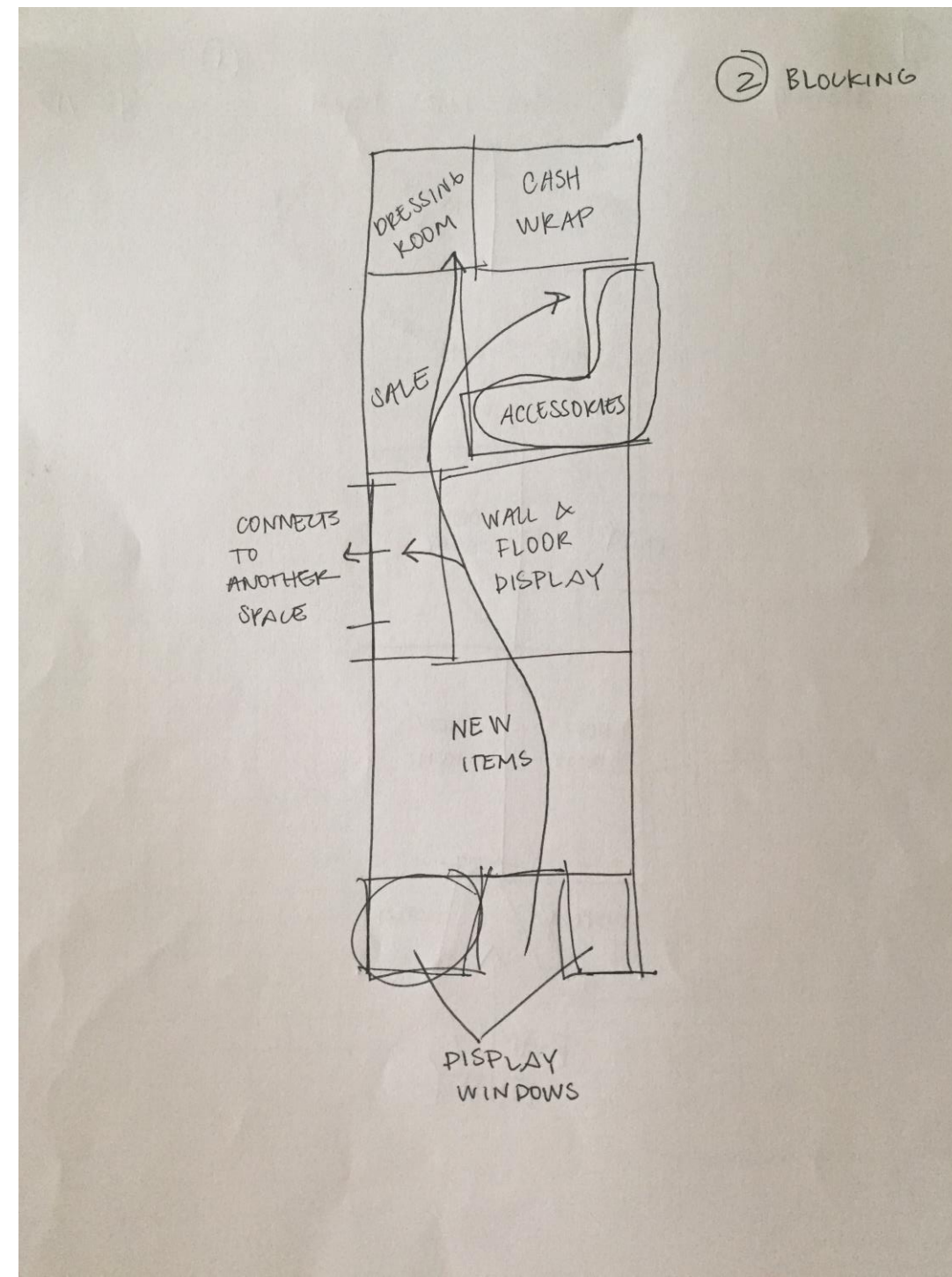
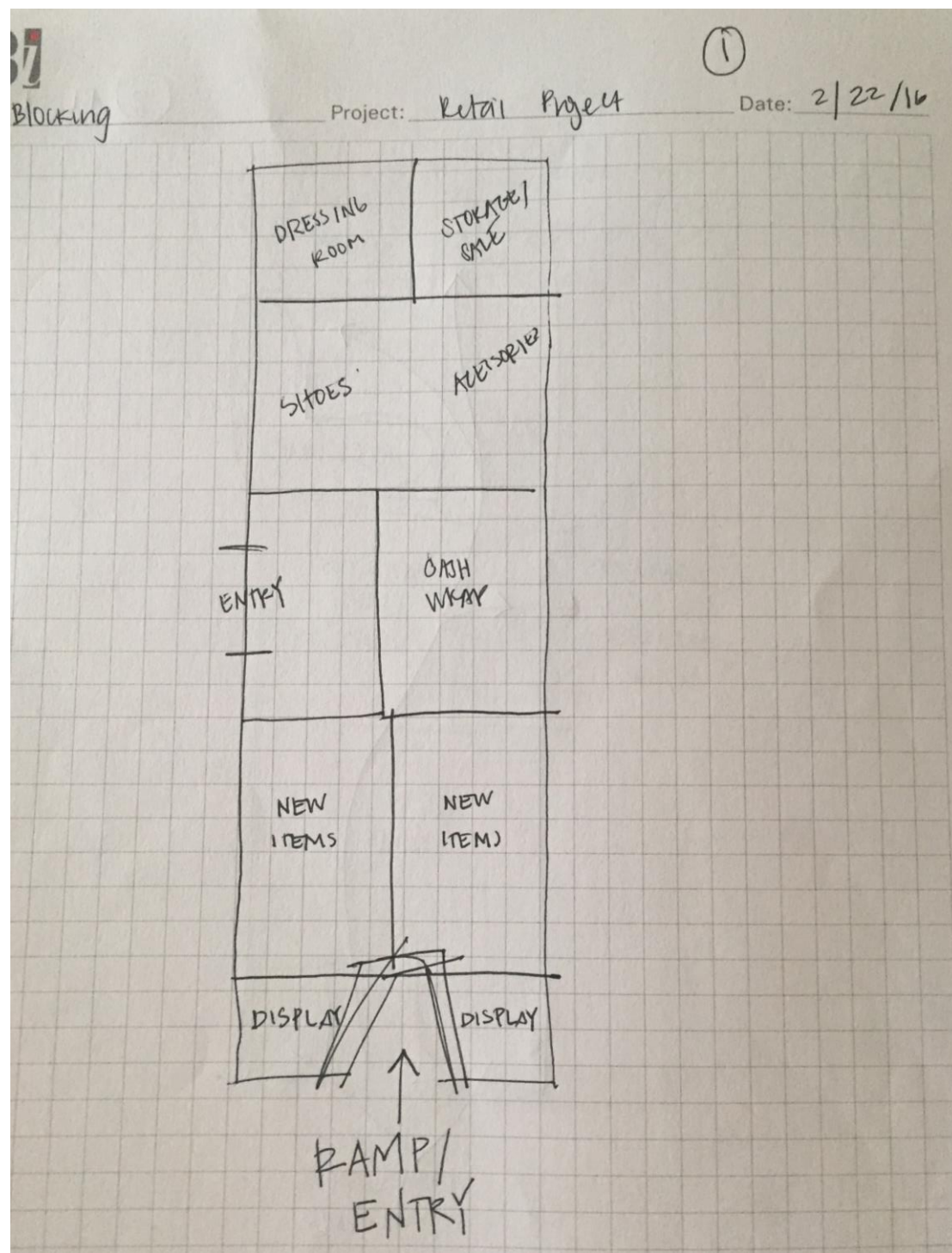

REFLECTED CEILING PLAN

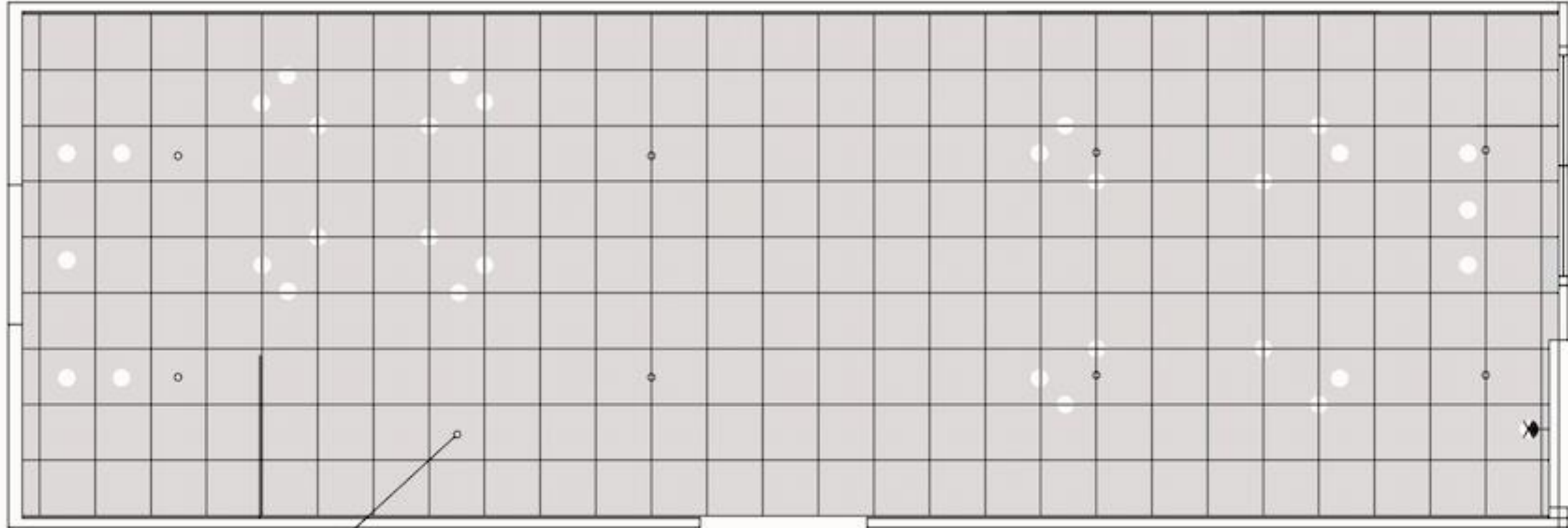

SPRINKLER FOR COVERED LOUNGE AREA



FINISHES & FIXTURES

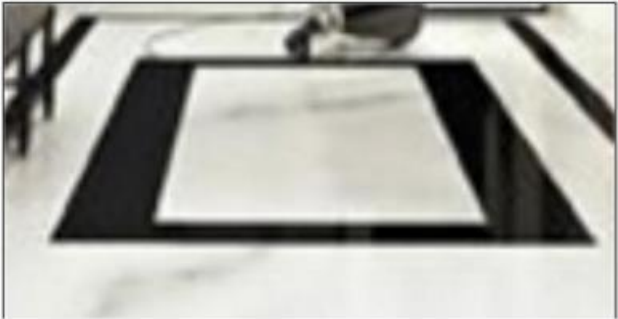
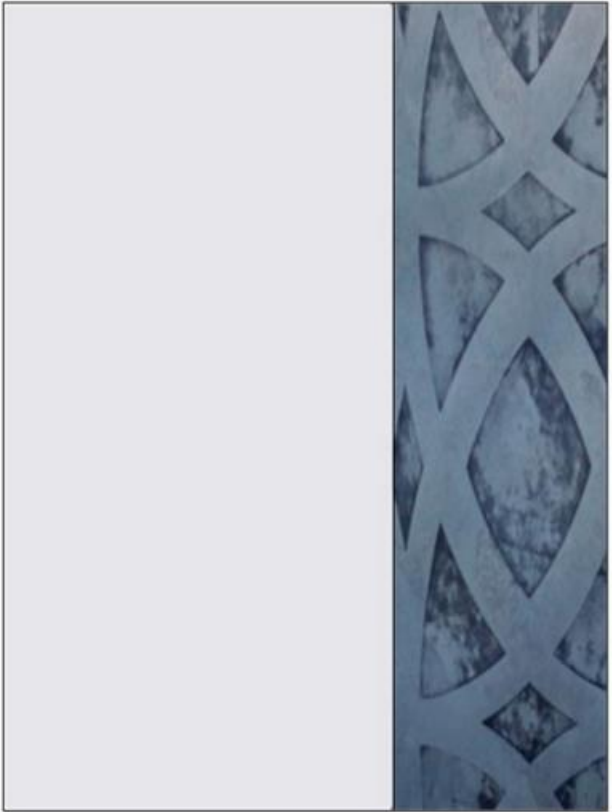

LIGHTING

Specifications

Weights & Dimensions

- 59" H x 7.88" W x 7.88" D Size
 - Fixture: 7.875" W x 7.875" D
 - Overall Product Weight: 4 lbs
 - Shade: 7.875" H x 7.875" W x 7.875" D
- 59" H x 9.88" W x 9.88" D Size
 - Fixture: 9.875" W x 9.875" D
 - Overall Product Weight: 5 lbs
 - Shade: 9.875" H x 9.875" W x 9.875" D
- 59" H x 11.75" W x 11.75" D Size
 - Fixture: 11.75" W x 11.75" D
 - Overall Product Weight: 7 lbs
 - Shade: 11.75" H x 11.75" W x 11.75" D
- Chain or Rod Length: 46"



Material: Metal <ul style="list-style-type: none"> • Material Details: Steel 	Number of Track Heads/Pendants Included: 6
Bulb Wattage: 50 Watts (W)	System Type: Track lighting
Bulb(s) Included: Yes	Product Type: Full track lighting kit
Fixture Voltage Level: Line Voltage (120 V)	Bulb Type: Halogen
Style: Modern	Finish: Chrome; Shiny White
Light Voltage: 120 Volts (V)	Track Fixture Voltage: 120 Volts (V)
Maximum Load Carrying Capacity (Watts): 300 Wattage (W)	Maximum Load Carrying Capacity (Volts): 120 Voltage (V)
Track Head Type: Track head	Track Head Finish: White
Movable Fixtures: Yes	Maximum Number of Heads: 6
Light Direction: Down	Eco-Friendly: Yes
Mounting Hardware Included: Yes	



Specifications

Weights & Dimensions

- Fixture: 23.6" H x 23.6" W x 23.6" D
- Chain or Rod Length: 98"

Features

Shade Material: Metal	Bulb Included: Yes
Fixture Type: Globe pendant	Bulb Type: Halogen
Number of Lights: 1	Shade Shape: Globe
Transformer Required: Yes <ul style="list-style-type: none"> • Transformer Wattage: 40 Watts (W) 	Country of Manufacture: China

LIGHTING

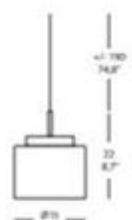

ROUND/50 155
1 x MAX 42W G9 also



SYSTEM 100 A

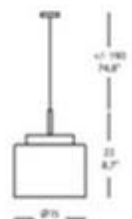

ROUND/50 15
1 x MAX 42W G9 also

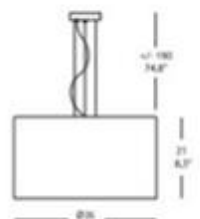

ROUND/50 35
3 x MAX 42W E27 also
or
3 x MAX 11W E27

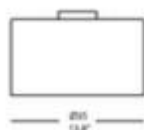

ROUND/PL
3 x MAX 42W E27 also
or
3 x MAX 11W E27

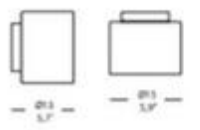

ROUND/PP
1 x MAX 42W G9 also



ROUND/TA
3 x MAX 42W E27 also
or
3 x MAX 11W E27

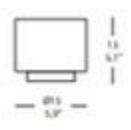

ROUND/CO
1 x MAX 42W G9 also

ROUND

technical
detailed lists

design **Andrea Lazzari**

Collezione di lampade in metallo cromato o nichel satinato, vetro soffiato bianco latte satinato o rosso satinato. Disponibile con lente in vetro satinato.

Collection of lamps in chrome-metal or satin finished nickel, blown glass milk white or red, satin finish. Available with satin finished glass lens.

Collection de lampes en métal chromé ou nickel satiné, verre soufflé blanc lait ou rouge, finition satinée. Disponible avec lentille en verre satiné.

Colección de lámparas en metal cromado o níquel satinado, cristal soplado blanco leche o rojo acabado satinado. Disponible con lente en cristal satinado.

Serie in Crom o Nickel satiniert, mundgeblasenes Glas milchweiß oder rot, satiniert. Auch verfügbar mit Linse aus satiniertem Glas.

Collezione lampi iz kromiranog metala ili satiniranog nichela, izduvano staklo mločno belog ili crvenog o satiniranog stakla. Predstavljeno s linijom iz satiniranog stakla.

ROUND GLASS

Lente in vetro satinata.
Satin finish glass lens.
Lentille en verre satiné.
Lente en cristal satinado.
Schirm aus satiniertem Glas.
Сатинированная стеклянная линза.



EGLOUSALIGHTING

200121A ERIDAN - Track Light

Finish:
Chrome/Shiny White

Shade:

Dimensions:
66 7/8" L x 6 1/4" W x 4 7/8" H

Standard Lamp:
GU10-ESL-LED

Max. Watt:
6 x 50

Ships with:
Bulbs Included



LIGHTING



Catalog No.	Finish		Lamping	Dimensions (Inches)		
	Brushed Nickel	Forged Black		A	B	C
PS118	-09WB	-80WB	1-G9 halogen 60w (included)	6-3/8	10-5/8	77

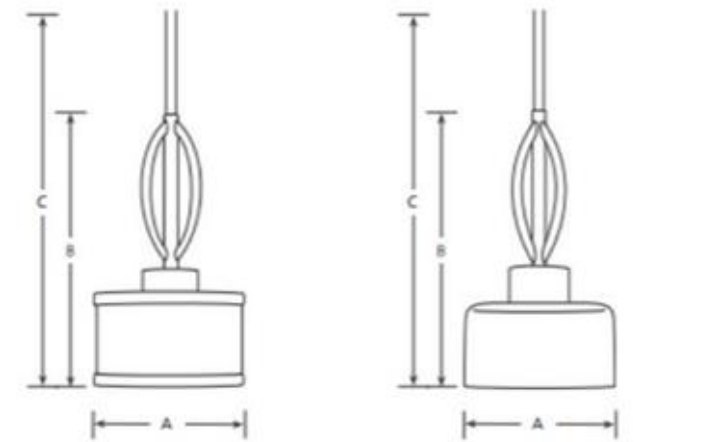

Specifications:

General

- Etched opal glass shade (-09WB)
- Fabric glass shade with etched glass diffuser on bottom (-80WB)
- Clear glass lamp shield (-80WB)
- Plated brushed nickel (-09), Painted forged black (-80) finishes
- Steel construction
- Two 6", one 12", two 15" stems and six links of chain included
- Companion fixtures: Hall and foyer, chandeliers, pendants, wall brackets, close to ceiling, and bath and vanity

Mounting

- Ceiling stem mount with chain
- Covers outlet box
- Canopy covers a standard recessed 4" octagonal outlet box
- Mounting strap for outlet box included

Electrical

- Pre-wired
- 10 feet of wire
- G9 based socket

Labeling

- cCSAus dry location listed

Progress Lighting
701 Millennium Blvd.
Greenville, South Carolina
29607

www.progresslighting.com

Rev. 7/12

VIEW 1



VIEW 2



VIEW 3



CONCEPT STATEMENT

Consignment shops typically are left unorganized, and picked over. However, this shop will have aspects similar to a high end boutique, or clothing store. Clients will easily be drawn to the items in the shop because of the chic interior aspects. Instead of the typical cluttered consignment shop, less clothing items will be on display, and as they are sold, more will be brought out of storage. The circular walking pattern will enable shoppers to walk around the store before exiting into either of the shops next door. Employees will be stationed around the shop assuring shoppers that they are there to help. An electronic iPad and iPhone system, such as Pogo, will allow each employee to help customers check out without having to wait in a specific area. There will be small stations located around the store with bags which is where the employees can go when they are helping a customer. This system takes up less space, is quicker, and more effective for shoppers.

- Black and White color scheme
- Chrome to add extra shine
- Maximum Customer Service
- Prominent circular traffic pattern



SKETCHES

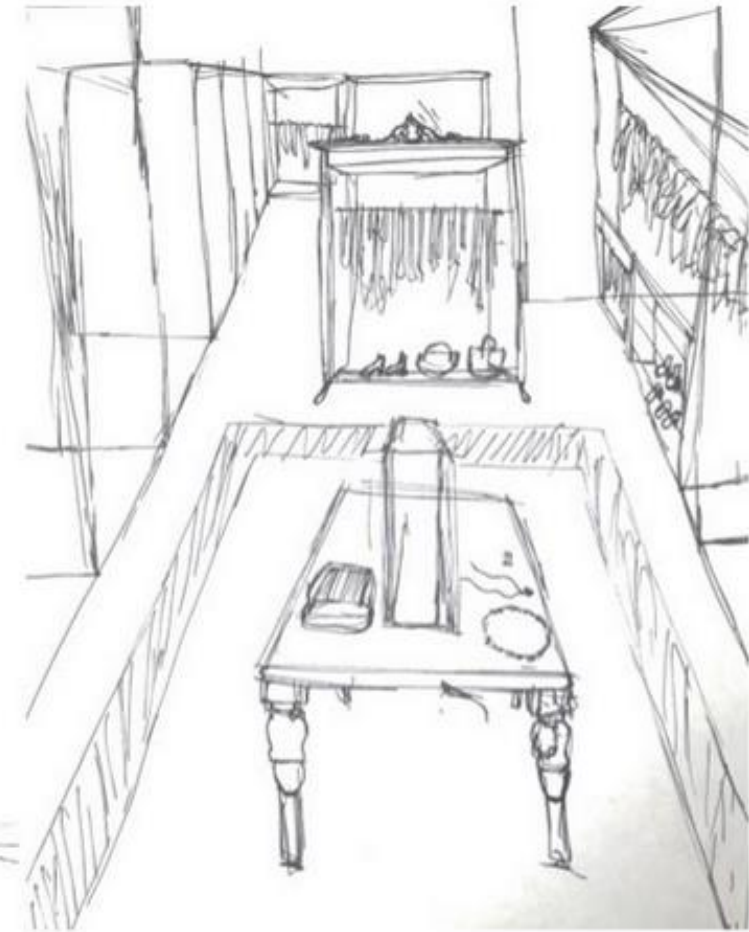
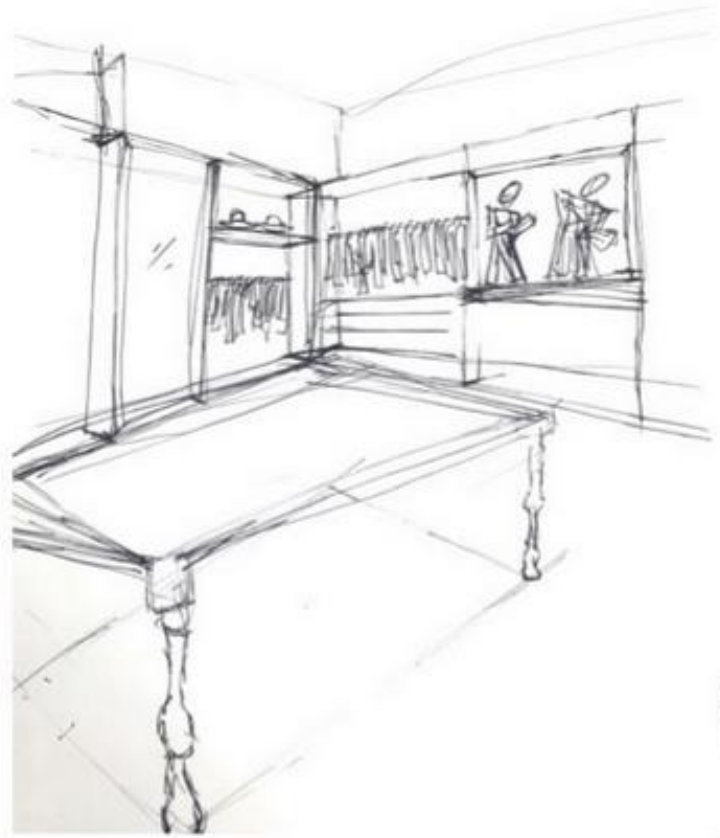

FINISHES & FIXTURES



FLOOR PLAN

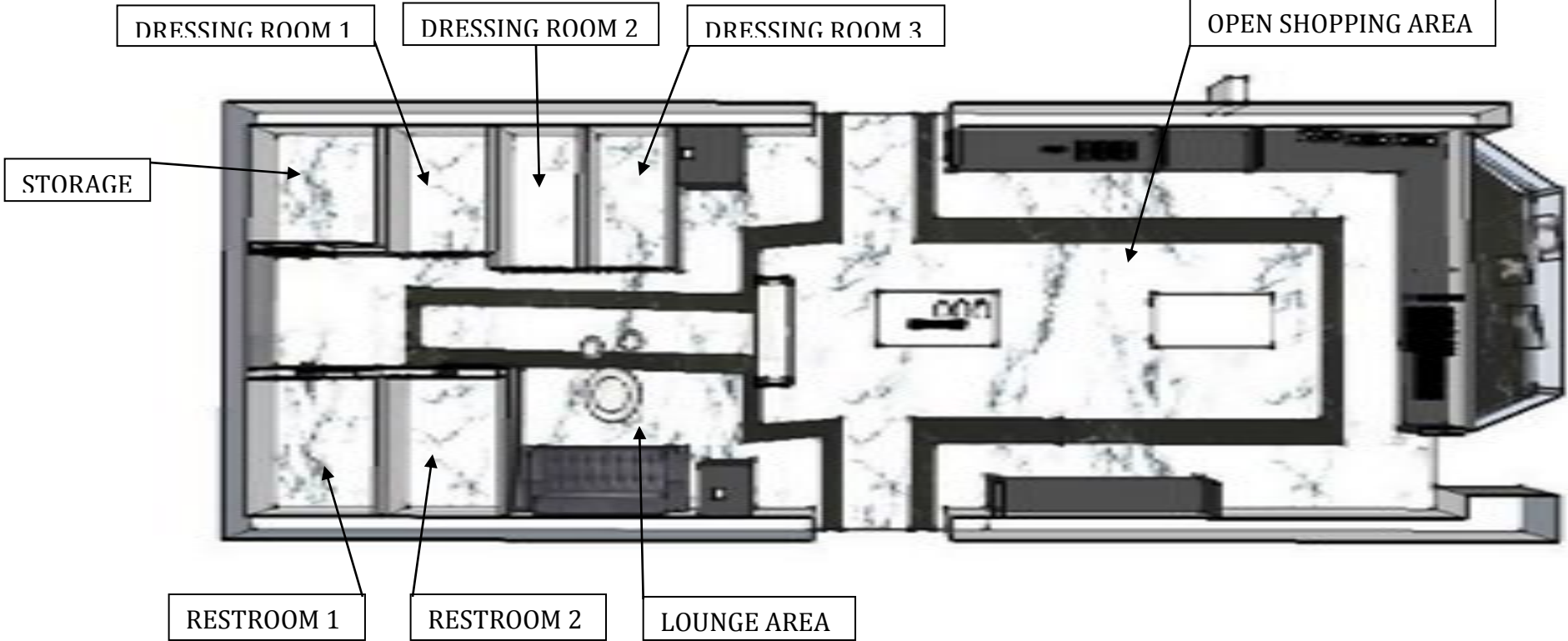

REFLECTED CEILING PLAN

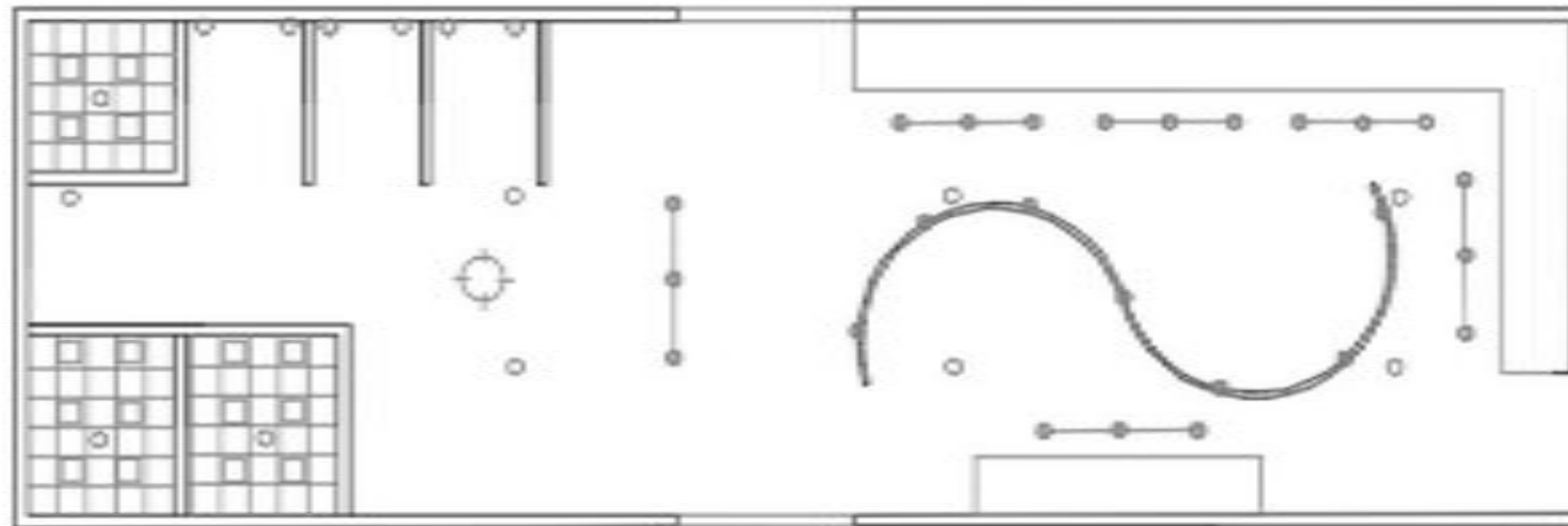

LIGHTING



VIVO M LED

Online Find It Fast
1160

VIVO MEDIUM

Applications: The VIVO M LED spotlight is designed for attractive illumination of retail spaces and is available with various lumen output levels. It is a very efficient alternative to conventional HID spotlights. For use with EUTRAC™ system. See separate spec sheet.

Type: _____

Project: _____

LED

VIVO MEDIUM LED SPOTLIGHT							
VIVOM				90			
FIXTURE	LUMEN OUTPUT	CCT	BEAM SPREAD	CRI	FINISH	ADAPTER	DRIVER
VIVOM Medium Spotlight	1600 lm 2800 lm	K30 3000K	FL Flood SP Spot WF Wide Flood	90 90+ CRI	WH White BK Black	EU11 1-Circuit 120V EU21 2-Circuit 120V EU22 2-Circuit 277V	SW Non-dimming SWITCHED DT Triac DIMMING (120V only)
	1800 lm 3200 lm	K40 4000K				EU11C 1-Circuit 120V Control EU21C 2-Circuit 120V Control	DA_ 1-10V Dimming DD_ DALI Dimming DH_ Lutron Hi-Lume DS_ Lutron 5-Series Dimming, 5%
	2400 lm	TG TGR*					

VIVO MEDIUM ACCESSORIES

OPTIONS

- 60700343 Soft-outline lens (blur lens)
- 60700275 Interchangeable reflector, flood
- 60700274 Interchangeable reflector, spot
- 60700278 Replacement reflector, wide flood
- 60700342 Black Anti-glare ring
- 60700345 Interchangeable reflector with high-contrast aperture
- 60700344 Oval Outline Lens 50°

Dimensional Data

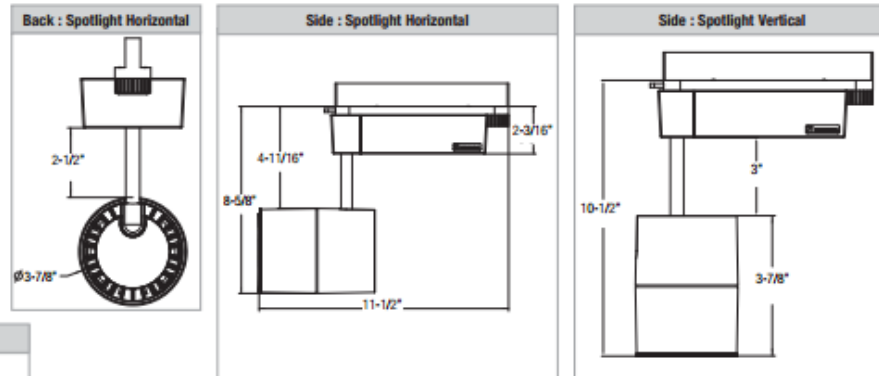

Units shown with EU21 adapter.

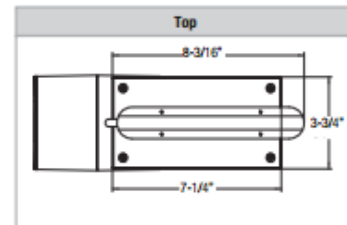

Suitable for
Dry Locations

1. **Track** – VIVO M is compatible with EUTRAC™. For additional information regarding the EUTRAC™ please see spec sheet on the website using RF1176.
2. **Adapter / Driverbox** – Track adapter and injection molded polycarbonate driver box are supplied with the fixture.
3. **Housing** – Die-cast aluminum housing painted white or black.
4. **Rotation and Pivot** – Spotlight head rotates through 360°, pivots through 90°.
5. **Wattage, CCT, CRI** – Unit is available in 20W (1600 lm 3000K or 1800 lm 4000K) or 36W (2800 lm 3000K or 3200 lm 4000K). White LEDs with 90+ color rendering. TGR True Gamut Rendering. 3000K, 90CRI. TGR enables lively color effects particularly with white and colored apparel.
6. **Beam Spread** – Options of Spot, Flood or Wide Flood.
7. **Life** – 50,000 hours rated life. L70.
8. **Optic** – Polycarbonate (PC) aluminum sputtered specular reflector.
9. **Clean Beam** – Symmetric beam pattern, free of striations with smooth transition from center beam to outer edge.
10. **Internal Accessory Holder** – Front cylinder of housing accommodates accessories internally and provides a seamless appearance.
11. **Accessories** – Black Anti-glare ring or Soft-outline lens (blur lens).

Photometric Data

VIVO M, Spot Beam, 36W, 4000K
VIVOM3200K40SP90WHEU11SW

Efficacy = 89 lm/W

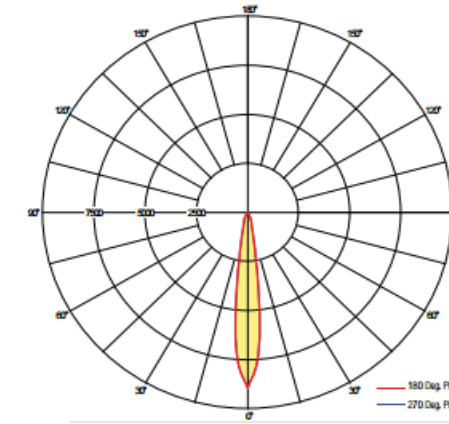

LUMINANCE DATA (cd/sq.m)				
Vertical Angles	Horizontal Angles			
	0	90	180	270
0	8679	8679	8679	8679
5	6638	6638	6638	6638
10	2317	2317	2317	2317
15	957	957	957	957
20	536	536	536	536
25	395	395	395	395
30	278	278	278	278
35	62	62	62	62
40	2	2	2	2
45	0	0	0	0

COEFFICIENTS OF UTILIZATION - ZONAL CAVITY METHOD																		
Effective Floor Cavity Reflectance 0.20																		
RC	80				70				50				30				10	0
RW	70	50	30	10	70	50	30	10	50	30	10	50	30	10	50	30	10	0
0	121	121	121	121	118	118	118	118	113	113	113	108	108	108	103	103	103	101
1	117	115	113	111	114	113	111	109	109	107	106	105	104	103	101	101	100	98
2	113	110	107	104	111	108	105	103	105	103	101	102	100	99	99	98	97	95
3	110	105	102	99	108	104	101	98	102	99	97	99	97	95	97	95	94	93
4	107	102	98	95	105	100	97	94	99	96	93	97	94	92	95	93	91	90
5	104	98	94	91	102	97	94	91	96	93	90	94	92	89	93	91	89	88
6	101	95	91	88	100	94	91	88	93	90	87	92	89	87	91	88	86	85
7	98	92	88	86	97	92	88	85	91	87	85	90	87	85	89	86	84	83
8	96	90	86	83	95	89	86	83	88	85	83	88	85	83	87	84	82	81
9	94	88	84	81	93	87	84	81	86	83	81	86	83	81	85	82	80	79
10	92	85	82	79	91	85	82	79	84	81	79	84	81	79	83	81	79	78

Taken from file: 607135501.doc

All values are rated values. Luminous flux and connected electrical load are subject to an initial tolerance of +/- 10%. Tolerance of color temperature: +/- 150 K. Unless stated otherwise, the values apply to an ambient temperature of 25°C.

VIEW 1



VIEW 2



VIEW 3

