



Portfolio 1

Rebekah Fry

Stakeholder Profile

Owner: Developer

Client: Developer

User: Retirees (55+)

This space will be a 1500 - 3000 square foot model unit, for a Senior Living Residential Condominium development in the city of Greenville, NC.



The Role of Color on Aging Eyes

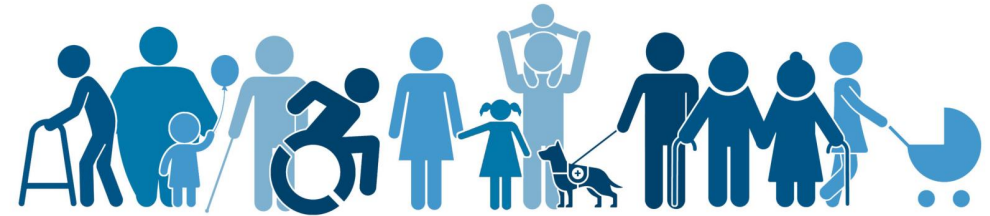

Incorporating universal design principles into design plans, can create environments that are more accessible, usable and safe, not only for older people, but for all generations. While aging eyes see color sheen and light differently, certain colors schemes and finishes can improve functionality in subtle and stylish ways.



- Human's eyes become progressively more yellow over time.
- Due to this filter effect, it makes it easier to see yellows, oranges, and red and harder to distinguish blues and purples.
- The contrast of colors with furniture, floor coverings, fixtures, and other items help elderly people safely navigate throughout the space.
- Having a contrast colors for walls will help highlight features and helps the elderly with depth perception which allows them to get around a space.
- The type of paint finish for walls also influences aging eyes. Older people are more sensitive to glare from light and other reflective surfaces. Due to this a higher sheen can distort colors to aging eyes. So, using flat and eggshell paints are the best choice.
- Light is a very important design principle, and the elders need all different types of light.

Assignment 1

Space Standards

Rooms:	Measurements	Square Footage
Guest Bedroom	20 x 15	300 sqft
Hall Bathroom	12 x 12	144 sqft
Master Bedroom	24 x 20	480 sqft
Master Bathroom	15 x 15	225 sqft
Walkin Closet	11 x 11	121 sqft
Living Room	24 x 24	576 sqft
Dining Room	8 x 14	112 sqft
Laundry/Pantry	10 x 10	100 sqft
Patio/Porch	** Is not included in the overall square footage **	
	Total:	2,058 sqft

Bubble Diagrams

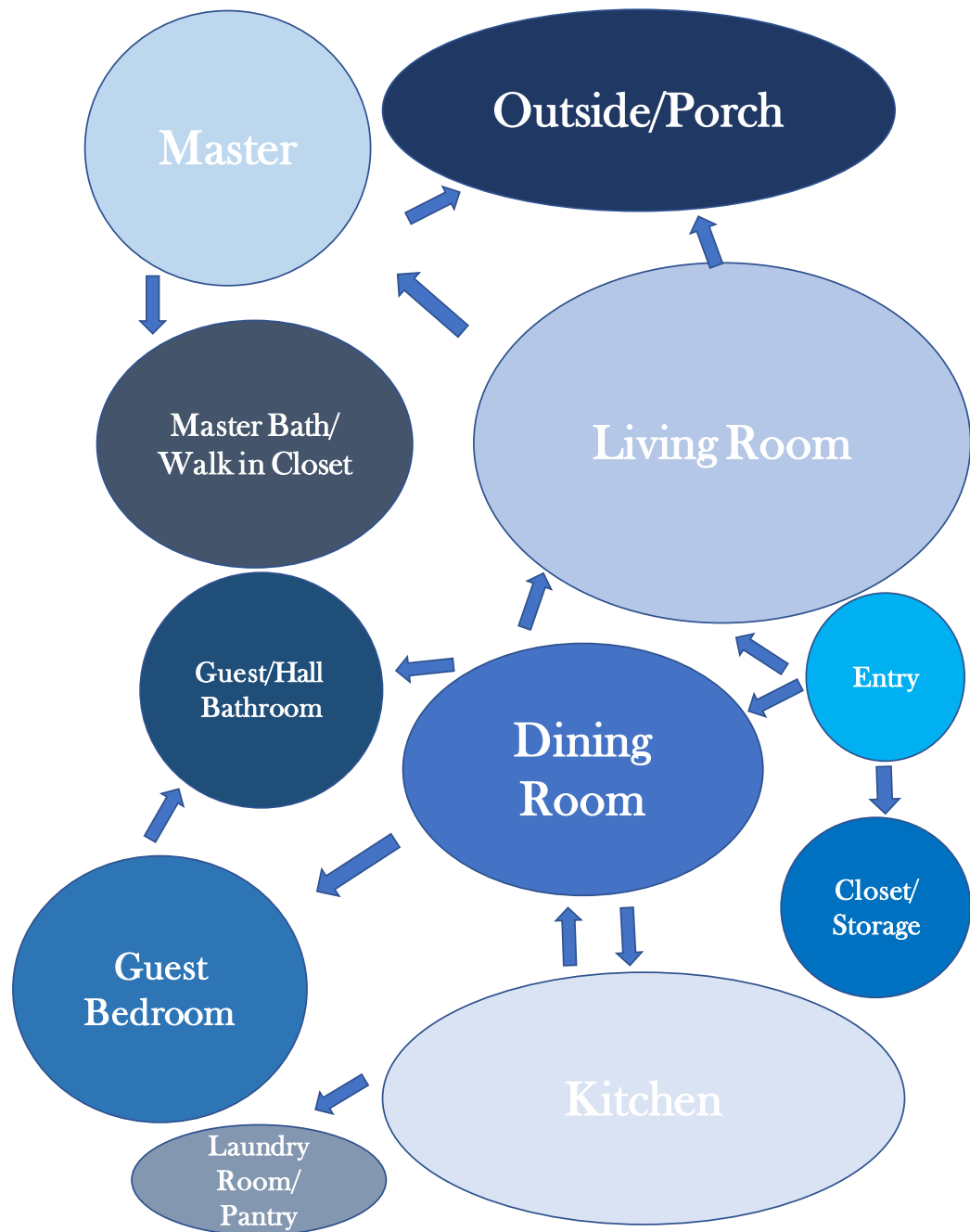
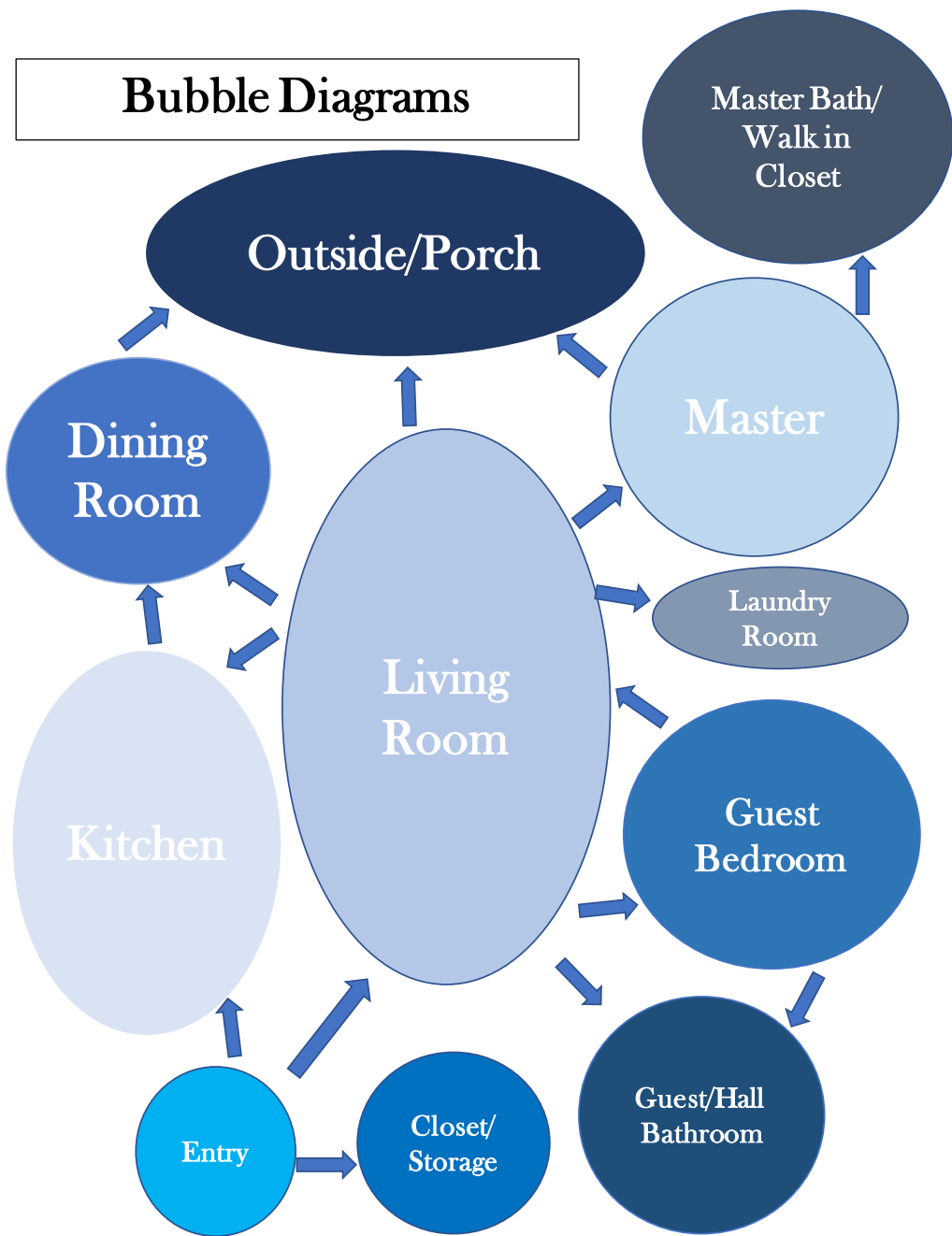

Block Diagrams



Option #1

Option #2



Concept

Youthfulness
is in the
heart!

- High contrasting colors
- A youthful feel
- Open
- Simple
- Warmer tones of colors that is easier to the eye
- Natural Light

