

Steelcase®

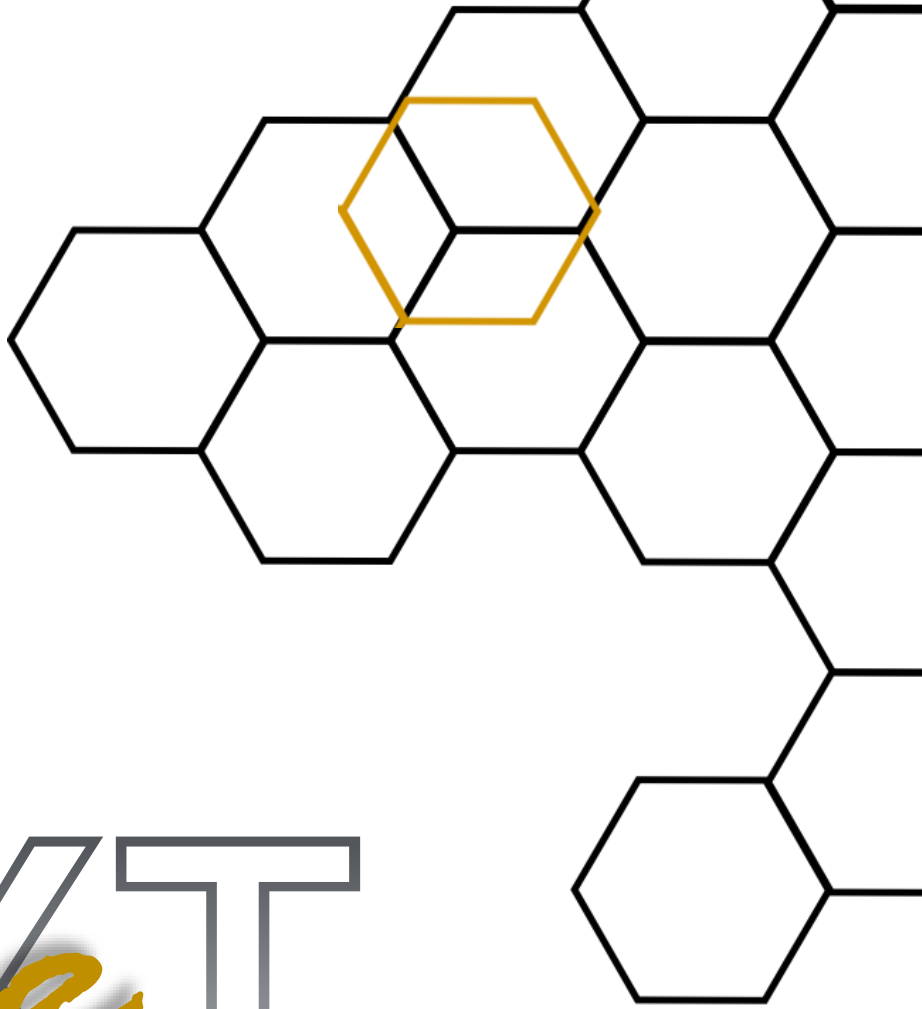

hive  
NEXT

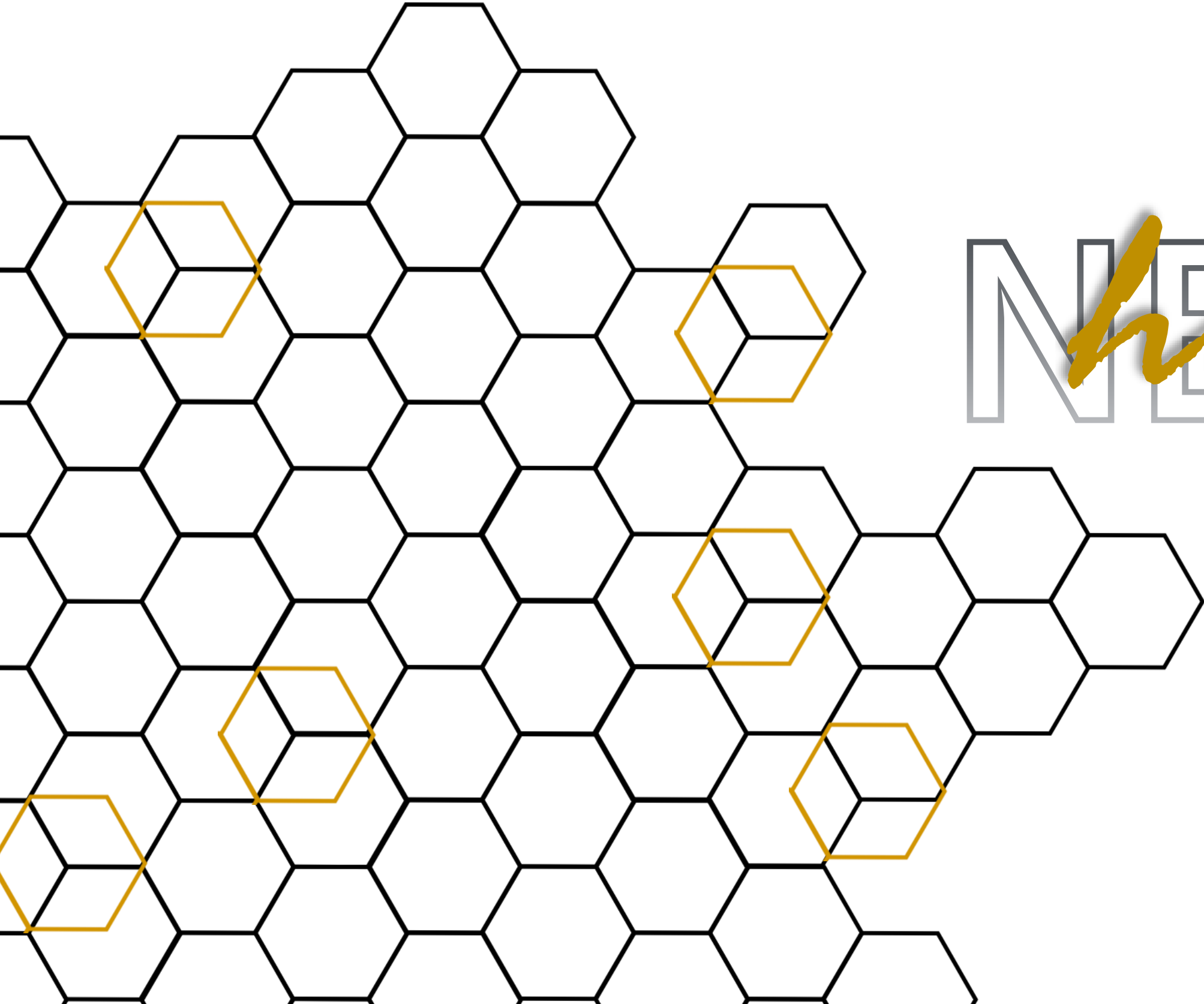
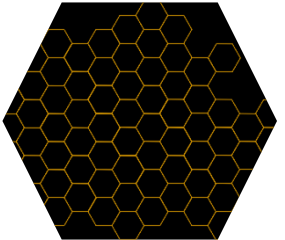

# Hive

HIV/

*NOUN*

1. A BEEHIVE

2. A PLACE IN WHICH PEOPLE ARE BUSILY OCCUPIED

*VERB*

1. PLACE (BEES) IN A HIVE

The hive is where creativity and inspiration flow like honey.

The network of activity is constantly buzzing. People work together and around one another in perfect harmony. The bold design of contrasting colors and geometric patterns reflect both the bee and beehive. The hive also utilizes biomimicry in imitation of a beehive and with its use of natural materials

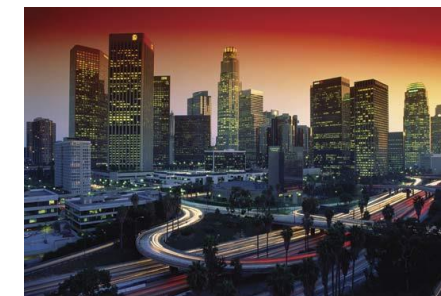

concept

# CULTURE

# OFFICE

# PEOPLE



## *Los Angeles*

- Busy
  - Busy bees flourish best in the hive where creativity, energy and teamwork are valued above all else
- Energetic
  - Is reflected in the bold patterns and colors that can be found in this design
- Fun
  - A yoga studio is available for office yogi's to take a break and really relax

- Inspiration for the hexagonal ceiling fixture came from Steelcase headquarters in Grand Rapids, MI
- Importance of movement
  - This space is designed for convenience and also in a way that people still have to get up and get moving
- Ecosystem of space
  - There is a space designed for every personality and worker type from the most introverted to the most extroverted

- People are happier when they feel like they have a choice and have control over their environment. Flexible designs and light furniture allow for easy space diversification
- Happy employees are 12% more productive
- 69% of employees report work as a significant source of stress
  - A well designed work space better eliminates stress within the workplace



# PALLETTE OF PLACE

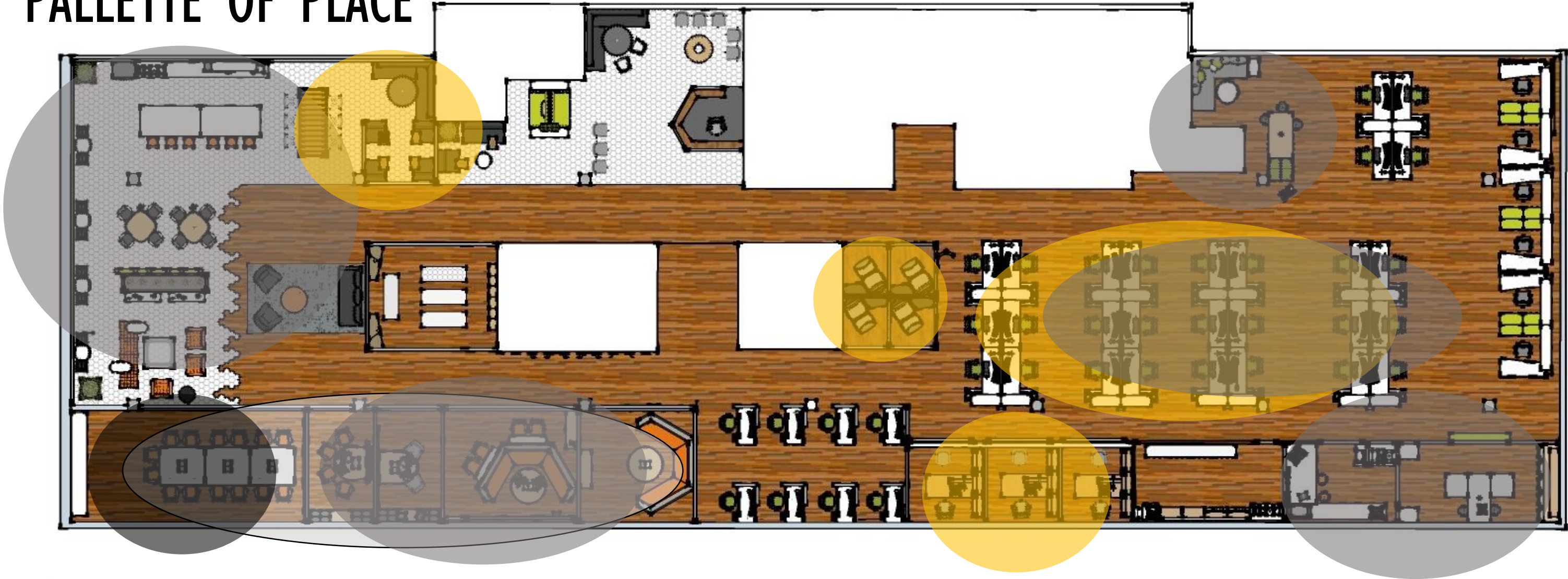

## FOCUS

AREA GOOD FOR PRIVATE WORK



## COLLABORATE

SMALL-MEDIUM GROUP WORK AREAS



## ASSEMBLE

LARGE GATHERINGS, MEETINGS, CONFERENCE



## CONNECT

SPACE FOR VIRTUAL MEETINGS

*research*

# ADJACENCIES + SCHEMATICS

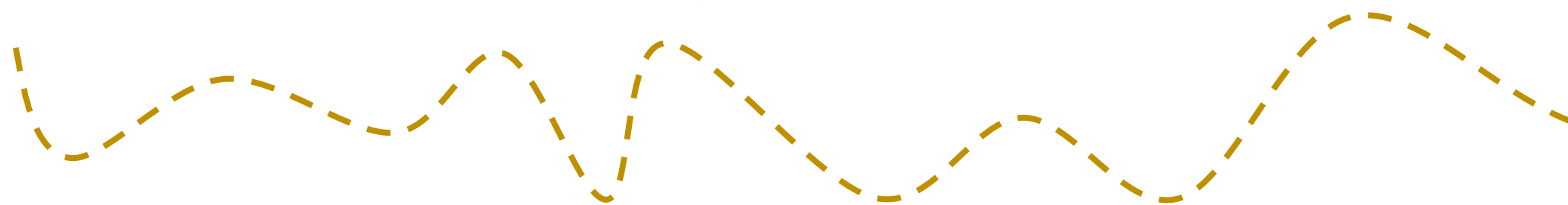
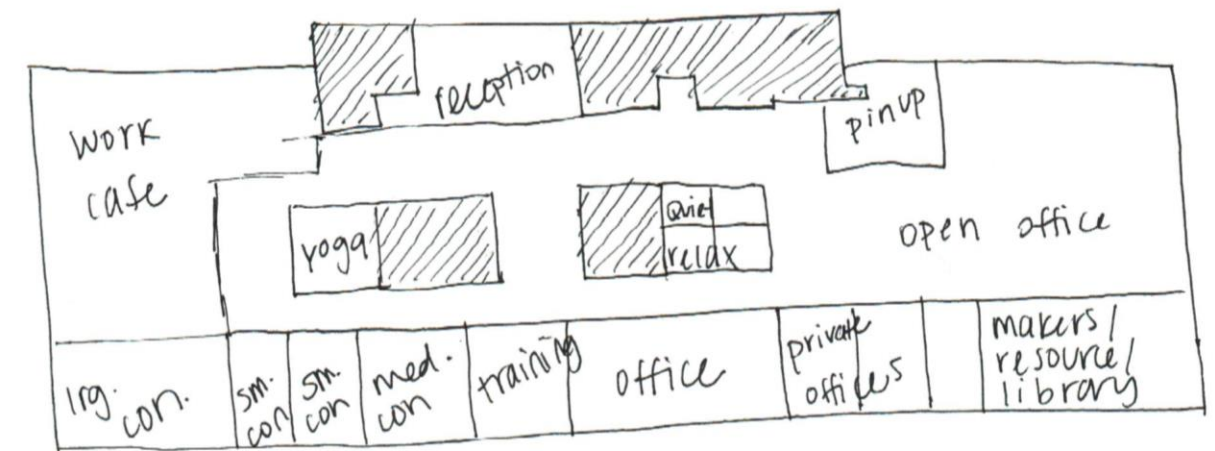
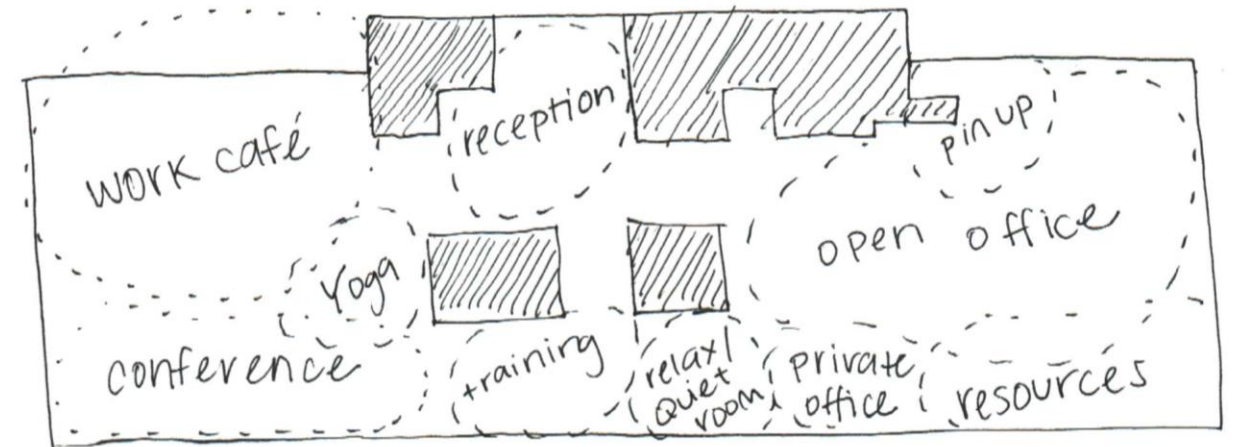
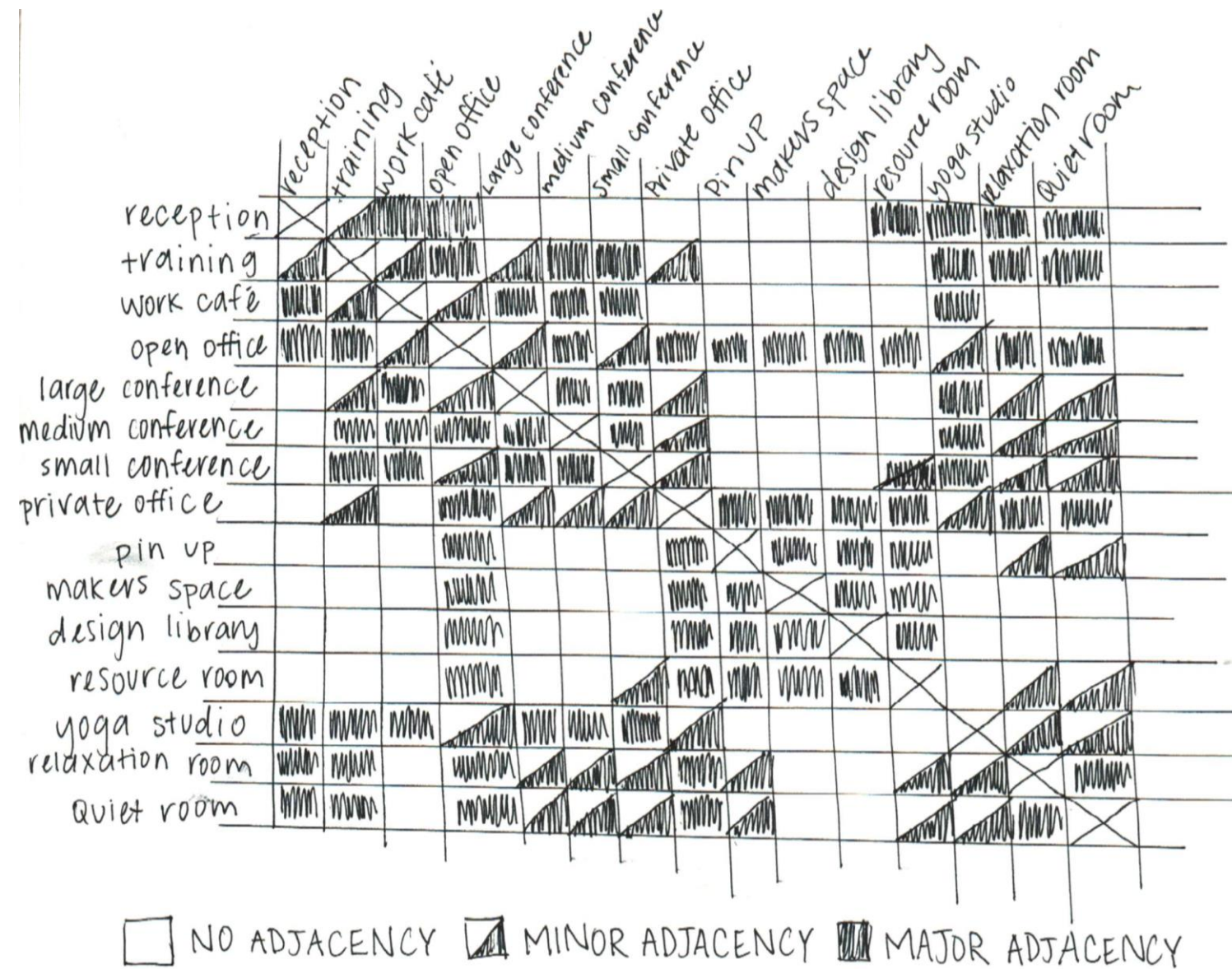

planning

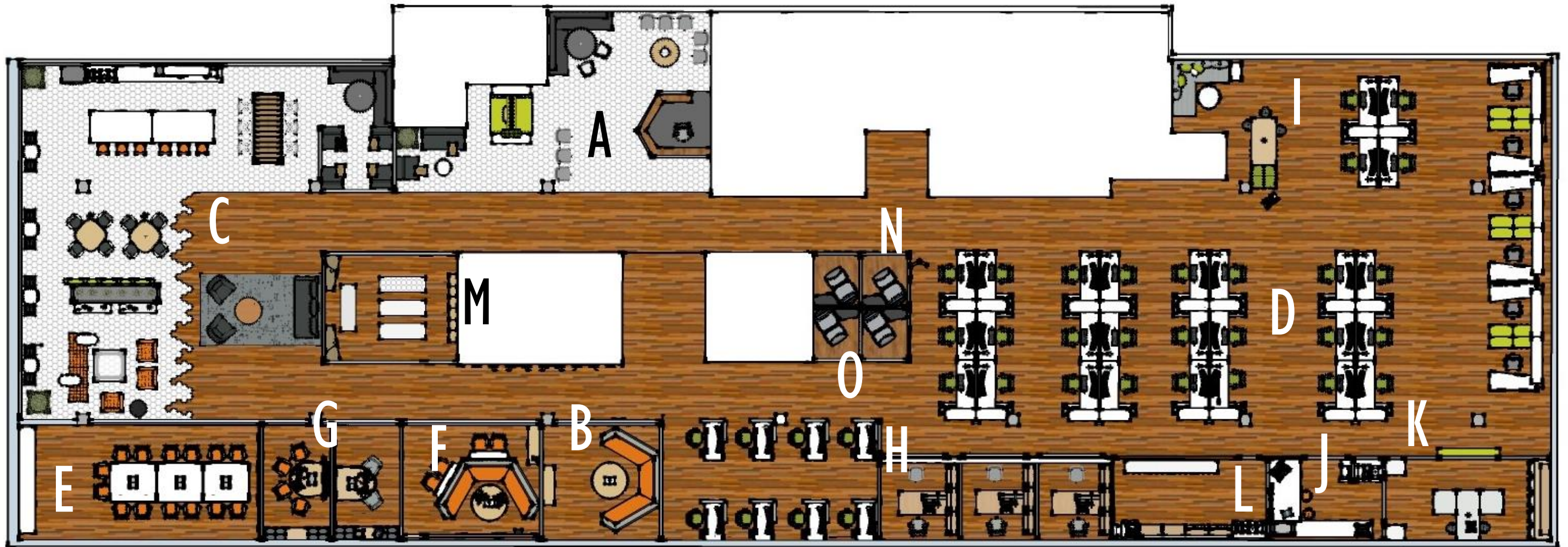

- A. RECEPTION**  
CONVENIENTLY LOCATED ADJACENT TO ELEVATOR, WELCOMING SPACE FOR GUESTS. COFFEE/REFRESHMENTS AVAILABLE.
- B. TRAINING**  
EQUIPPED WITH VR/BIM TECHNOLOGY
- C. WORK CAFÉ**  
ARRANGED WITH FURNITURE FOR ALL MEETING TYPES. PRIVATE LUNCH, GROUP MEETING, SMALL GROUP, ETC.
- D. OPEN OFFICE**  
DESK SYSTEMS CONDUSIVE FOR EASY TRAVEL AND COLLABORATION, CONVENIENTLY LOCATED NEXT TO DESIGN RESOURCES AND PIN UP SPACE
- E. LARGE CONFERENCE**  
ADEQUATE SPACE FOR LARGE GATHERINGS, EQUIPPED WITH CONFERENCE TECHNOLOGY
- F. MEDIUM CONFERENCE**
- G. SMALL CONFERENCE (2)**
- H. PRIVATE OFFICE (3)**  
FLEXIBLE, CUSTOMIZABLE SPACE INTENDED FOR USE OF MULTIPLE PEOPLE
- I. PIN UP (2)**  
WHITE BOARD AND CASUAL SMALL GROUP SEATING
- J. MAKERS SPACE**  
INCLUDES ALL NECESSARY EQUIPMENT
- K. DESIGN LIBRARY**
- L. RESOURCE ROOM**
- M. YOGA STUDIO**  
TO RELAX IN THE L.A. STYLE WHEN A BREAK IS NEEDED
- N. RELAXATION ROOM**
- O. QUIET ROOM**

*floor plan*

# OPEN OFFICE

# WORK CAFE

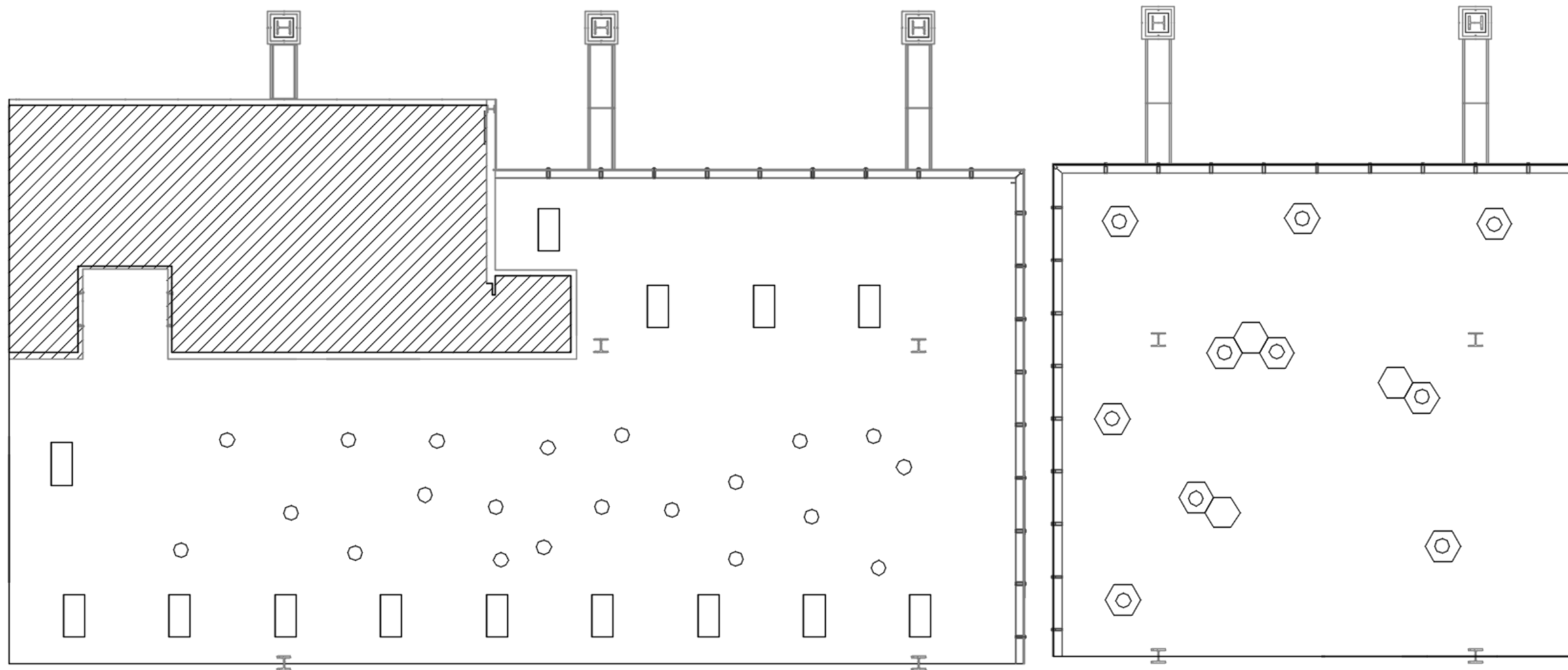

LED TUBE LIGHTS

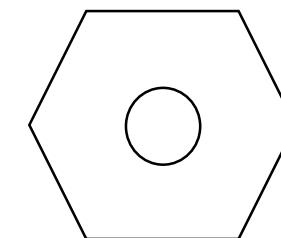

CUSTOM HEXAGON  
FIXTURE WITH  
PENDANT LIGHT

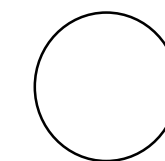

PENDANT LIGHT



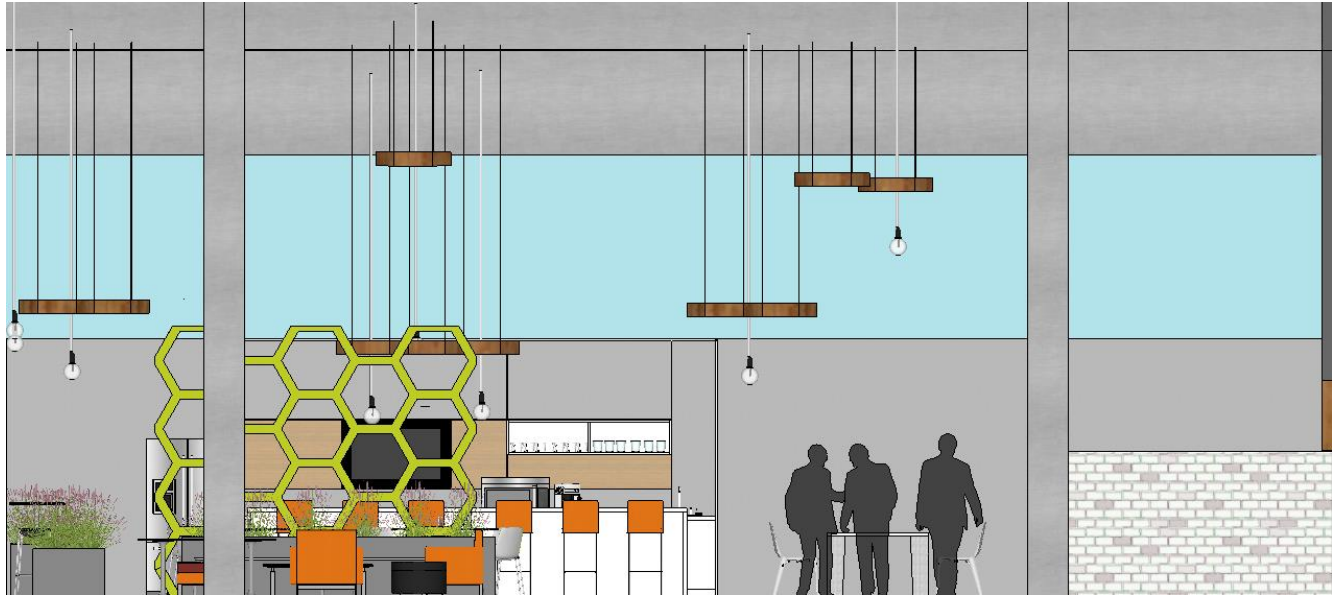

# WORK CAFE

# OPEN OFFICE

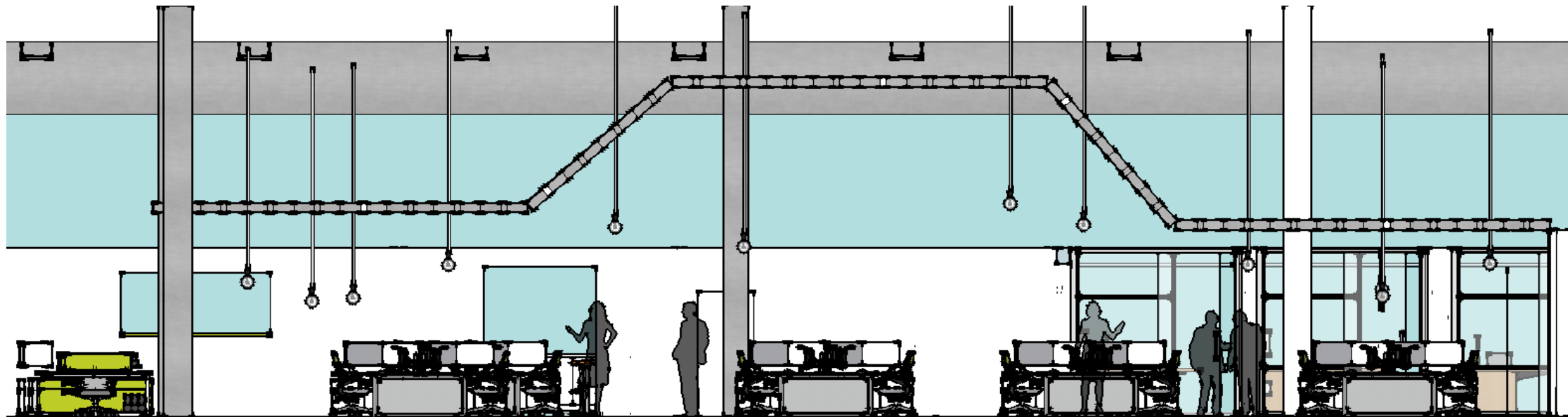
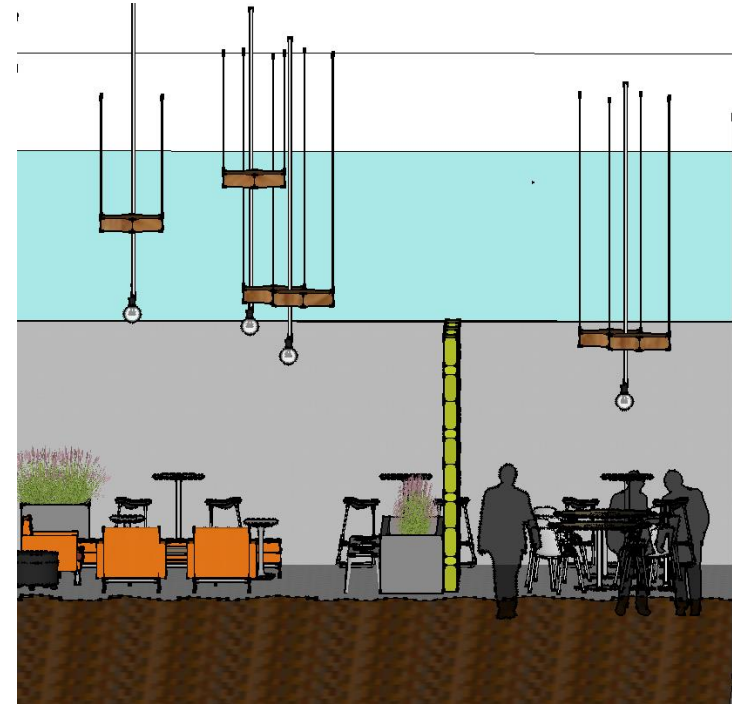

*elevations*





# RECEPTION



A VARIETY OF SEATING  
WELCOMES YOU AT  
RECEPTION AS YOU WALK  
INTO THE NEXT OFFICE

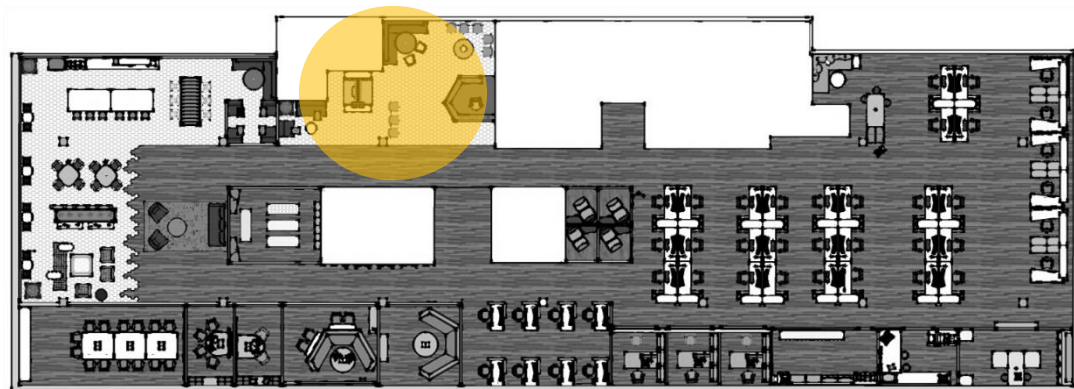

*perspective*

# WORK CAFE



CASUAL CLIENT MEETINGS, A QUICK QUIET LUNCH BREAK, OR AN OFFICE PARTY CAN BE FOUND IN THE WORK CAFE

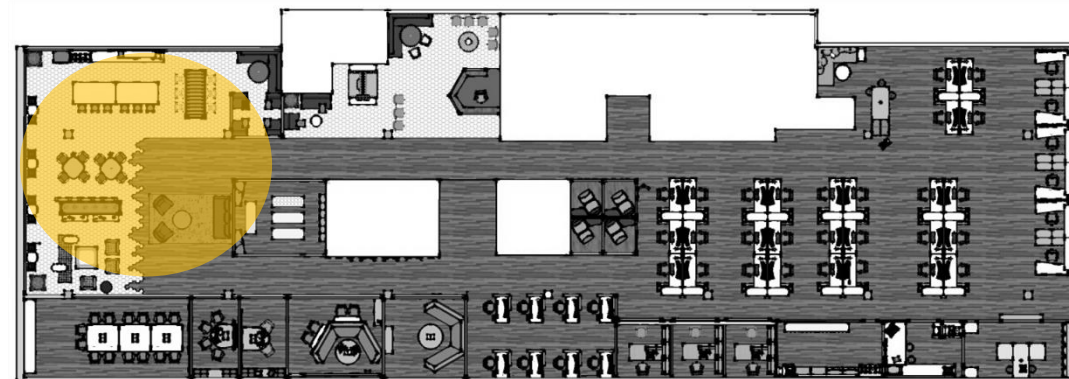

*perspective*

# MEDIUM CONFERENCE



THIS CONFERENCE SPACE IS GOOD FOR SMALL TO MEDIUM MEETINGS AND IS EQUIPPED WITH TECHNOLOGY TO CONNECT WITH OTHER OFFICES

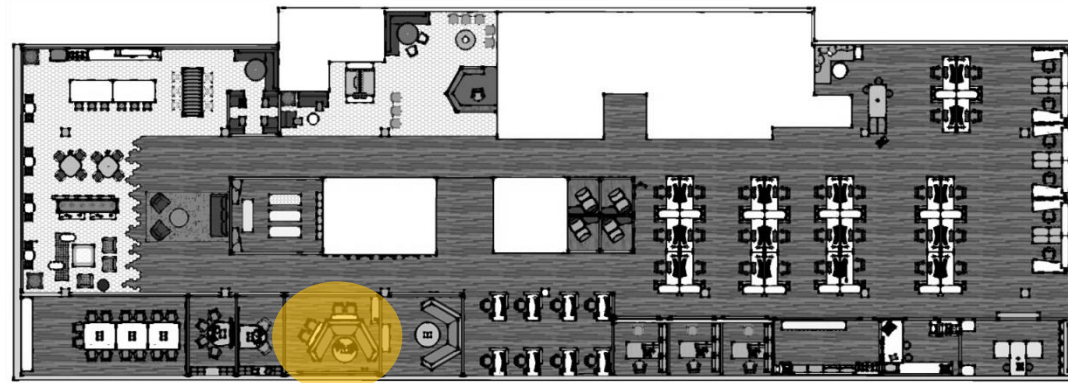

*perspective*

# MAKERS SPACE

THIS MAKERS SPACE IS  
EQUIPPED WITH  
TECHNOLOGY AND TOOLS  
TO CREATE WHATEVER YOU  
IMAGINE

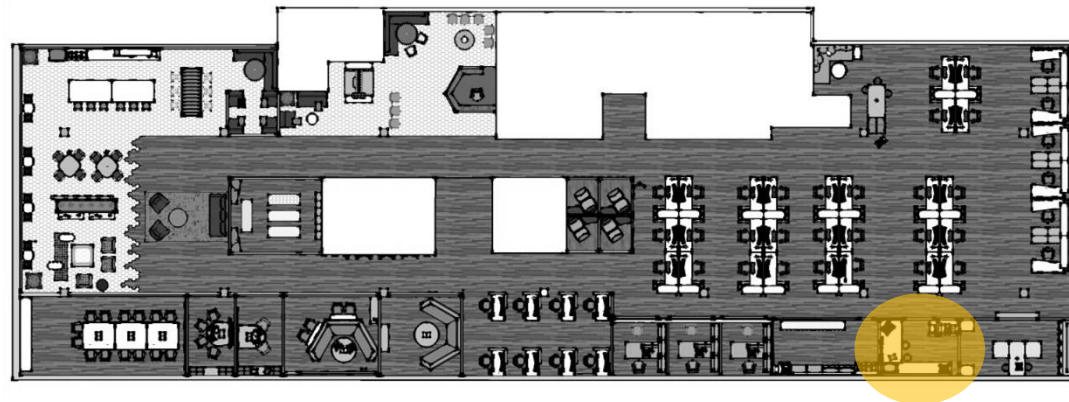

*perspective*

# PIN UP



WALK OVER TO THE PIN UP  
SPACE TO QUICKLY SKETCH  
IDEAS SOLO OR  
COLLABORATE WITH YOUR  
NEXT TEAM

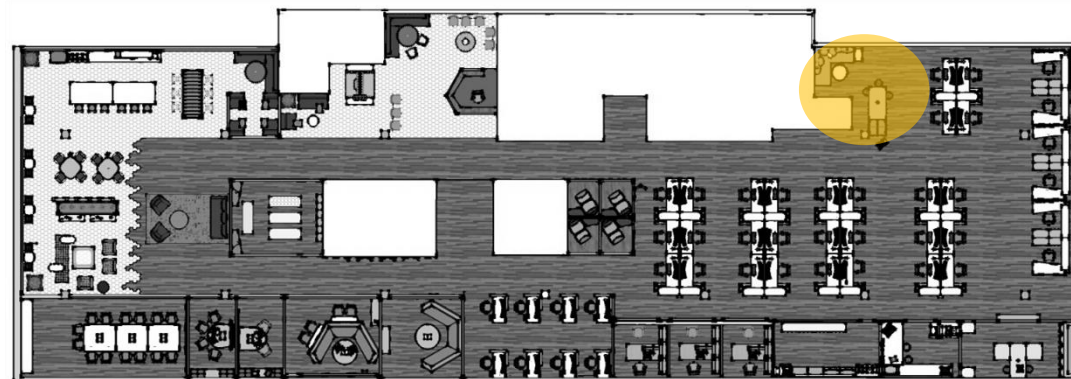

*perspective*

# OPEN OFFICE



THE HEART OF THE OFFICE,  
WHERE EVERYONE GATHERS  
TO WORK

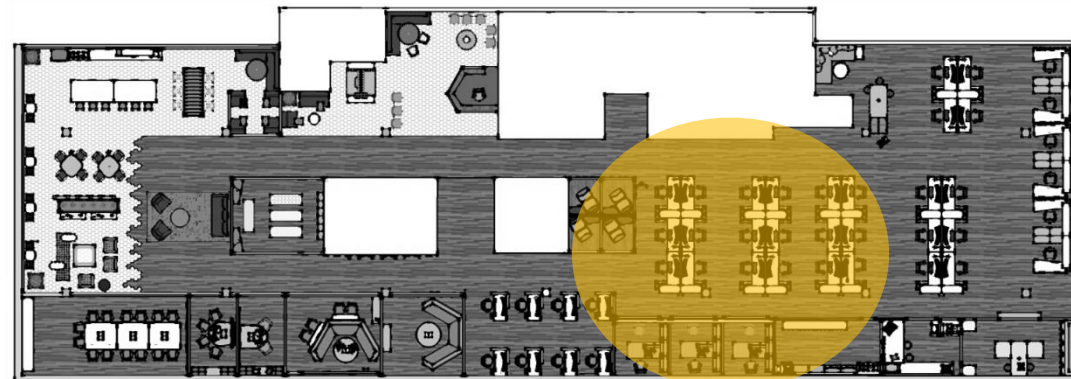

*perspective*

# OPEN OFFICE



CONVENIENTLY LOCATED  
NEAR OFFICES, PIN UP,  
DESIGN LIBRARY, MAKERS  
SPACE AND THE RESOURCE  
ROOM

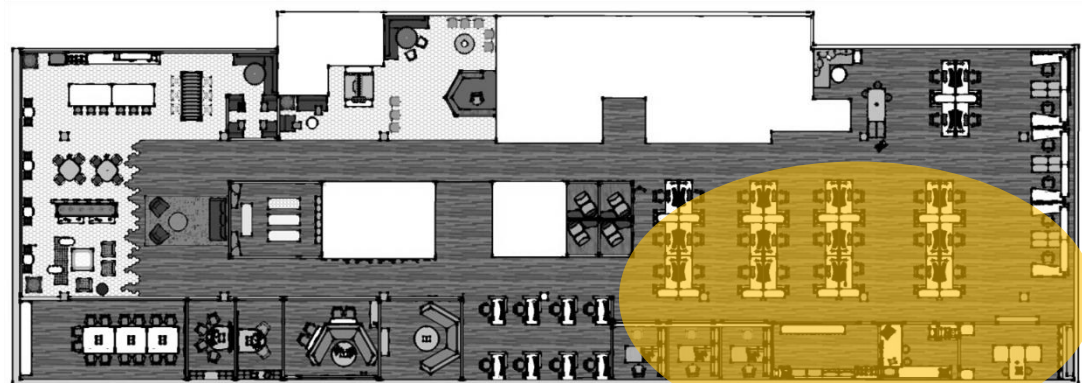

*perspective*

# FLOOR

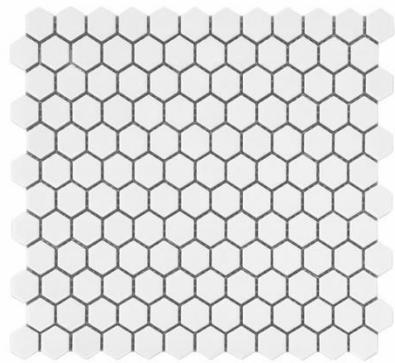

# WALLS

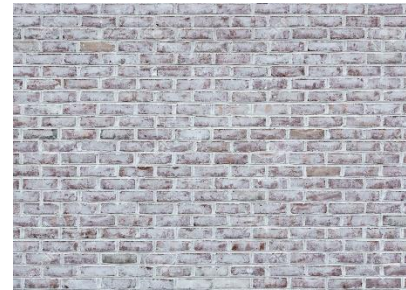

# FURNITURE



# LIGHTING



*Materials & finishes*





hive  
NEXT

